

# Public notice

## Coldharbour Lane Bus priority



*The London Borough of Southwark (Bus priority) (Coldharbour Lane) (No. \*) Traffic Order 201\**  
*The London Borough of Southwark (Waiting and loading restrictions) (Amendment No. \*) Order 201\**

1. Southwark Council hereby GIVES NOTICE that it proposes to make the above orders under powers of the Road Traffic Regulation Act 1984, as amended.
2. The effect of the orders would be:-
  - (a) in COLDHARBOUR LANE on the north-west side (between its junctions with Denmark Road and Valmar Road) to change the operating time of the north-eastbound bus priority lane to operate from Monday - Friday 7 am to 7 pm (the bus lane will remain for the use of buses, pedal cycle and taxis only);
  - (b) to introduce 'at any time' waiting restrictions (double yellow lines) in the following locations:-
    - (i) COLDHARBOUR LANE on the north-west side, across its junction with Crawford Road, and across its junction with Lowth Road and extending south-westward to its junction with Denmark Road; (ii) CRAWFORD ROAD approx. 10 metres on each side, at its junction with Coldharbour Lane; and (iii) LOWTH ROAD approx. 5 metres on each side, at its junction with Coldharbour Lane.
3. For more information contact Lola Olanlokun of the council's Highways – Transport Projects team [Highways@southwark.gov.uk](mailto:Highways@southwark.gov.uk).
4. Copies of this notice, the proposed orders, a statement of the council's reasons for making the orders, and a plan of the proposals may be found online at [www.southwark.gov.uk/trafficorders](http://www.southwark.gov.uk/trafficorders), paper copies may be obtained from or viewed at Highways, Environment and Leisure, 3<sup>rd</sup> floor hub 2, 160 Tooley Street, London SE1 2QH. Email [traffic.orders@southwark.gov.uk](mailto:traffic.orders@southwark.gov.uk) (or call 020 7525 3497) for details.
5. Anyone wishing to object to or make any other representations regarding the proposal, may use the form labelled '*Parking - Road traffic and highway schemes - responding to statutory consultation notices*' at [www.southwark.gov.uk/statutoryconsultationnotices](http://www.southwark.gov.uk/statutoryconsultationnotices) or send a statement in writing to: the Traffic Orders Officer, Highways, Southwark Council, Environment and Leisure, P.O. Box 64529, London SE1P 5LX or by e-mail to [traffic.orders@southwark.gov.uk](mailto:traffic.orders@southwark.gov.uk) quoting reference '*TMO1920-015 Coldharbour Lane bus*' by 1 August 2019. Please note that if you wish to object to this proposal you must state the grounds on which your objection is made.
6. When making an objection or representation, please be aware that this may be communicated to other people who may be affected. Information provided in response to this consultation, including in some circumstances personal information, may also be subject to publication or disclosure under the requirements of current access to information legislation.

Dated 11 July 2019

**Nicky Costin** - Parking and Network Management Business Unit Manager, Regulatory Services

# Statement of reasons

## Coldharbour Lane Bus priority

*The London Borough of Southwark (Bus priority) (Coldharbour Lane) (No. \*) Traffic Order 201\**  
*The London Borough of Southwark (Waiting and loading restrictions) (Amendment No. \*)*  
*Order 201\**

As part of their Road Modernisation Plan, Transport for London (TfL) has identified locations where improvements to the highway would reduce bus journey times.

In COLDHARBOUR LANE - on the north-west side (between its junctions with Denmark Road and Valmar Road) within the London Borough of Southwark it is recommended to change the operating time of the north-eastbound bus priority lane to operate from Monday Friday 7 am to 7 pm (the bus lane will remain for the use of buses, pedal cycle and taxis only); and to introduce 'at any time' waiting restrictions (double yellow lines) in the following locations:-

COLDHARBOUR LANE on the north-west side, across its junction with Crawford Road, and across its junction with Lowth Road and extending south-westward to its junction with Denmark Road;

CRAWFORD ROAD approx. 10 metres on each side, at its junction with Coldharbour Lane; and

LOWTH ROAD approx. 5 metres on each side, at its junction with Coldharbour Lane.

Dated 11 July 2019

For more information contact:

**Lola Olanlokun**  
Transport Projects  
Highways

[Highways@southwark.gov.uk](mailto:Highways@southwark.gov.uk)

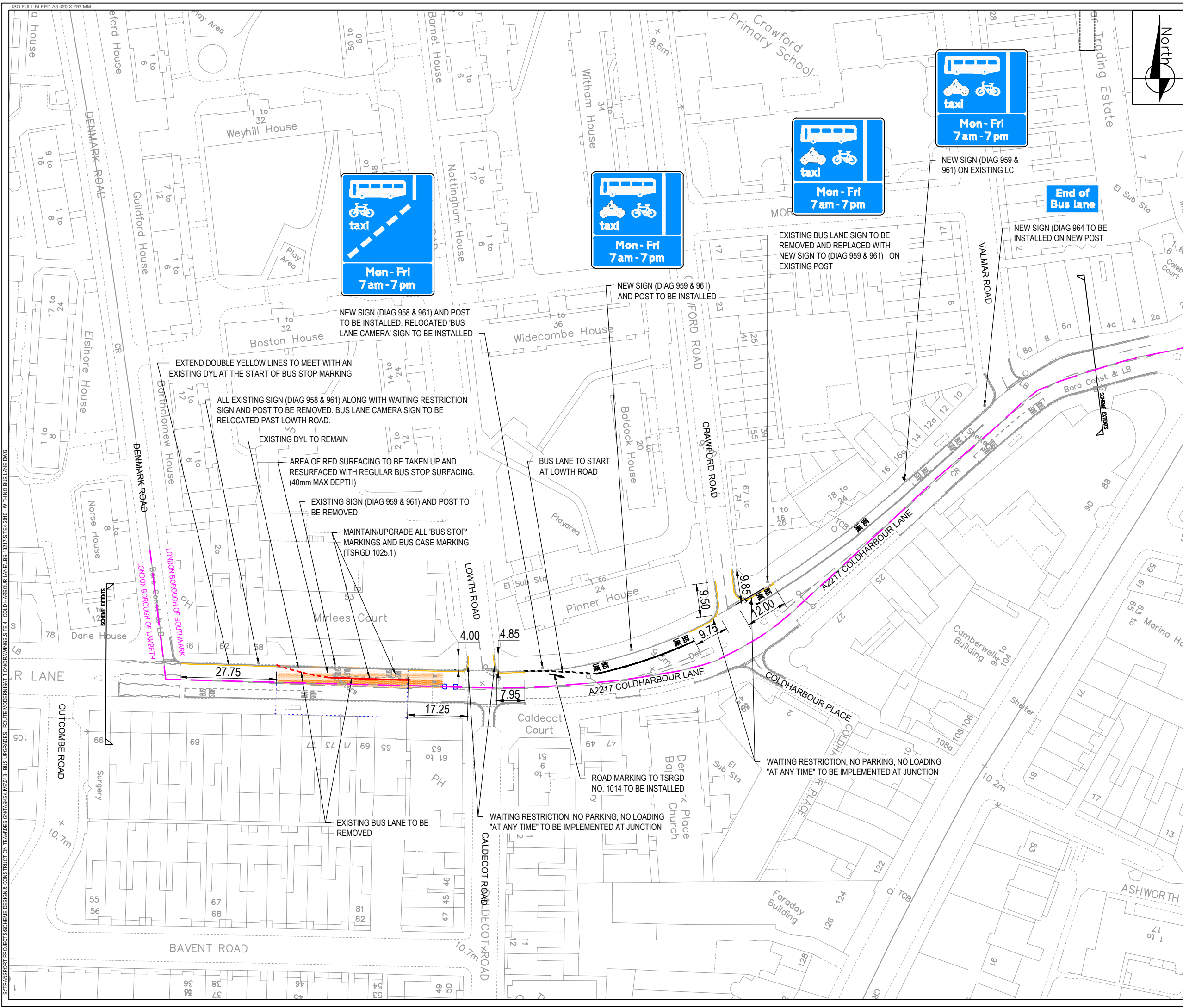

**NOTES**

- NOTES:**
1. All dimensions in metres, unless otherwise stated.
  2. All measurements shown on drawing to be confirmed on site by contractor prior to construction.
  3. Existing road markings are indicative and setting out dimensions are approximate.
  4. All lining and signing to be in accordance with Traffic Signs Regulations and General Directions 2016.
  5. All existing signs and lines to be retained unless otherwise stated.

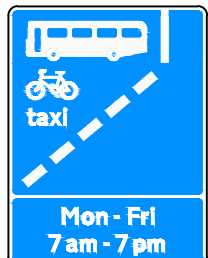

Scheme Ref.	Clayton Road / Peckham	x-height	50.0
Sign Ref.	Sign 1 (TSRGD 958 & 961)	Sign Face	
Letter colour	WHITE	Width	825mm
Background	BLUE	Height	1080mm
Border	WHITE	Area	0.89m <sup>2</sup>
Material	Class R38 Microprismatic		

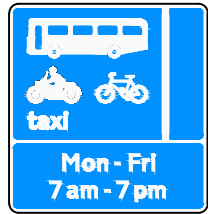

Scheme Ref.	Route Modernisation Programme	x-height	50.0
Sign Ref.	Sign 2 (TSRGD 958 & 961)	Sign Face	
Letter colour	WHITE	Width	825mm
Background	BLUE	Height	1080mm
Border	WHITE	Area	0.89m <sup>2</sup>
Material	Class R32 (L2999-1:2007)		



Scheme Ref.	Cold Harbour Lane	x-height	50.0
Sign Ref.	Sign 3 (TSRGD 964)	Sign Face	
Letter colour	WHITE	Width	510mm
Background	BLUE	Height	290mm
Border	WHITE	Area	0.15m <sup>2</sup>
Material	Class R38 Microprismatic		

REV	DATE	REVISION DESCRIPTION / DETAILS	DRN BY	CHKD BY	APRVD BY



PROJECT: ROUTE MODERNISATION PLAN COLD HARBOUR LANE					
TITLE: RMP 476 - COLD HARBOUR LANE SITE 4 DETAIL DESIGN					
STATUS:	FINAL (CONSTRUCTION)	DRAWN:	SC	DESIGNED:	SC
SCALE:	1:500	CHECKED:	SK	APPROVED:	RB
DRAWING NO.:	LBS/18217/SITE4/01	REV.:	A		
DATE DRAWN:	SEPT 2018	DATE ISSUED:	JAN 2019		



THE COUNCIL OF THE LONDON BOROUGH OF SOUTHWARK

# TRAFFIC MANAGEMENT ORDER

201\* No. 0xx

---

The London Borough of Southwark (Waiting and loading restrictions)  
(Amendment No. \*) Order 201\*

Made: xx xxxxxx 201\*

Coming into force: xx xxxxxx 201\*

---

The council of the London Borough of Southwark, after consulting the Commissioner of Police of the Metropolis, in exercise of the powers conferred by sections 6 and 124 of the Road Traffic Regulation Act 1984<sup>a</sup>, as amended, and of all other powers thereunto enabling, hereby make the following Order:

## Citation and commencement

- 1.1 This Order may be cited as the London Borough of Southwark (Waiting and loading restrictions) (Amendment No. \*) Order 201\* and shall come into force on xx xxxxxx 201\*.

## Interpretation

- 2.1 In this Order:-

"council" means the council of the London Borough of Southwark;

"enactment" means any enactment, whether public general or local, and includes any order, bye-law, rule, regulation, scheme or other instrument having effect by virtue of an enactment; and

"the Order of 2015" means the London Borough of Southwark (Waiting and loading restrictions) Consolidation Order 2015<sup>b</sup> - as amended.

- 2.2 Any reference in this Order to any enactment shall be construed as a reference to that enactment as amended, applied, consolidated, re-enacted by or as having effect by virtue of any subsequent enactment.
- 2.3 Unless the context otherwise requires, any expression used in this Order which is also used in the Order of 2015 shall have the same meaning as in that Order.

---

<sup>a</sup> 1984 c.27

<sup>b</sup> LBS 2015/082

Amendment of the Order of 2015

- 3.1 Without prejudice to the validity of anything done, or to any liability incurred in respect of any act or omission before the coming into force of this Order, the Order of 2015 shall have effect as though:-
- (a) for the item numbered 246 in Schedule 1 to that Order there were substituted the item similarly numbered and set out in columns 1, 2 and 3 of the Schedule to this Order; and
  - (b) for the items numbered 1095 and 1098 in Schedule 2 to the London Borough of Southwark (Waiting and loading restrictions) (Amendment No. 4) Order 2015<sup>c</sup> there were substituted the items similarly numbered and set out in columns 1, 2 and 3 of the Schedule to this Order.

Dated this xxxxxxxx day of xxxxxxxx 201\*

[signature here]

NICKY COSTIN  
Parking and Road Network Business Unit Manager  
Regulatory Services

---

<sup>c</sup> LBS 2015/101

SCHEDULE – WAITING RESTRICTIONS (SUBSTITUTION)

<i>Item No. (1)</i>	<i>Street (2)</i>	<i>Prescribed hours (3)</i>
1095.	COLDHARBOUR LANE	
	the north-west side	
(i)	between its junction with Denmark Hill and the common boundary of Nos. 10 and 12 Coldharbour Lane;	At any time
(ii)	between the common boundary of Nos. 10 and 12 Coldharbour Lane and a point 12 metres north-east of the north-eastern kerb-line of Crawford Road;	7 am to 7 pm Monday to Friday
(iii)	a point 12 metres north-east of the north-eastern kerb-line of Crawford Road and a point 10 metres south-west of the south-western kerb-line of Crawford Road;	At any time
(iv)	between a point 10 metres south-west of the south-western kerb-line of Crawford Road and a point 8 metres north-east of the north-eastern kerb-line of Lowth Road;	7 am to 7 pm Monday to Friday
(v)	between a point 8 metres north-east of the north-eastern kerb-line of Lowth Road and the north-eastern kerb-line of Denmark Road.	At any time
246.	CRAWFORD ROAD	
(a)	the north-east side	
(i)	between the south-eastern kerb-line of Warner Road and a point 5 metres south-east of that kerb-line;	At any time
(ii)	between a point 23 metres north-west of the north-western kerb-line of Morna Road and a point 6 metres south-east of the south-eastern kerb-line of Morna Road;	At any time
(iii)	between the north-western kerb-line of Coldharbour Lane and a point 10 metres north-west of that kerb-line;	At any time
(b)	the south-west side	
(i)	between the south-eastern kerb-line of Warner Road and a point 28 metres south-east of that kerb-line;	At any time
(ii)	between a point 8.5 metres north-west of the south-eastern wall of Nos. 1-20 Mitcham House, Crawford Road and a point 9 metres south-east of that wall;	At any time
(iii)	between a point 10 metres north-west of the south-eastern wall of Nos. 1-34 Witham House, Crawford Road and a point 11 metres south-east of that wall;	At any time
(iv)	between the north-western kerb-line of Coldharbour Lane and a point 9.5 metres north-west of that kerb-line;	At any time

SCHEDULE – WAITING RESTRICTIONS (SUBSTITUTION)

<i>Item No. (1)</i>	<i>Street (2)</i>	<i>Prescribed hours (3)</i>
	(c) so much else as does not lie within those lengths of street specified in sub-paragraphs (a) and (b) above.	8.30 am to 6.30 pm Monday to Friday
1098.	LOWTH ROAD	
	(a) the north-east side	
	(i) between the south-eastern kerb-line of Warner Road and a point 5 metres south-east of that kerb-line;	At any time
	(ii) between the north-western kerb-line of Coldharbour Lane and a point 5 metres north-west of that kerb-line;	At any time
	(b) the south-west side	
	(i) between the south-eastern kerb-line of Warner Road and a point 15 metres south-east of that kerb-line;	At any time
	(ii) between the north-western kerb-line of Coldharbour Lane and a point 4 metres north-west of that kerb-line;	At any time
	(c) so much else as does not lie within those lengths of street specified in sub-paragraphs (a) and (b) above.	8.30 am to 6.30 pm Monday to Friday

EXPLANATORY NOTE

*(This note is not part of the Order)*

This Order, amends existing lengths of 'at any time' waiting restrictions in Coldharbour Lane, Crawford Road and Lowth Road, in the London Borough of Southwark.





THE COUNCIL OF THE LONDON BOROUGH OF SOUTHWARK

# TRAFFIC MANAGEMENT ORDER

201\* No. \*

---

The London Borough of Southwark (Bus priority) (Coldharbour Lane) (No. \*)  
Traffic Order 201\*

Made: xx xxxxxxx 201\*

Coming into force: xx xxxxxxx 201\*

---

The council of the London Borough of Southwark, after consulting the Commissioner of Police of the Metropolis, in exercise of the powers conferred by sections 6 and 124 of and Part IV of Schedule 9 to the Road Traffic Regulation Act 1984<sup>a</sup>, as amended, and of all other powers thereunto enabling, hereby make the following Order:

## Citation and commencement

- 1.1 This Order may be cited as the London Borough of Southwark (Bus priority) (Coldharbour Lane) (No. \*) Traffic Order 201\*, and shall come into force on xx xxxxxxx 201\*.

## Interpretation

- 2.1 In this Order-

causing includes permitting;

"carriageway" has the same meaning as in section 329(1) of the Highways Act 1980<sup>b</sup>;

"vehicle" includes part of a vehicle;

"bus", "local bus", "pedal cycle", "taxi", "traffic lane", "contra-flow" and "with-flow lane" have the meanings given in the Traffic Signs Regulations and General Directions 2002<sup>c</sup>;

"bus lane" means a traffic lane on a length of road which is specified in column (2) in the table in the Schedule to this Order and in respect of which traffic signs are in place indicating the controls specified in this Order;

"times of operation" means in relation to a bus lane specified in an item in column (2) of the table the Schedule to this Order and the times specified in column (3) of that item.

- 2.2 The Interpretation Act 1978<sup>d</sup> applies to this Order as if it were an enactment.

---

<sup>a</sup> 1984 c.27

<sup>b</sup> 1980 c.66

<sup>c</sup> S.I. 2002 No. 3113

<sup>d</sup> 1978 c.30

### Bus priority controls

- 3.1 Except as provided in Articles 4 and 5, no person shall cause a vehicle to be in a bus lane in a length of road specified in an item in column (2) of the table in the Schedule to this Order during the times specified in that item in column (3) of that item unless that vehicle is proceeding in the direction specified in column (4) of that item and is of a type specified in column (5) of that item.

### Exemptions - bus lanes

- 4.1 The controls specified in Article 3.1 do not apply so as to prevent a vehicle being in a bus lane if and for as long as necessary-
- (a) to enable a person to get on or off the vehicle; or
  - (b) to enable goods to be loaded on to or unloaded from the vehicle;
- if and in so far as the activity is not prohibited by the provisions of any other Order.
- 4.2 The controls specified in Article 3.1 do not apply in respect of a vehicle which is being used for a purpose which is within an exemption to a restriction or prohibition imposed by any other Order or which is permitted by any other Order.
- 4.3 The controls specified in Article 3.1 do not apply in respect of a vehicle crossing a bus lane to get to or from any road adjacent to the bus lane or any vehicular access to premises adjacent to the bus lane.

### Exemptions - bus lanes and bus-only routes

- 5.1 The controls specified in Article 3.1 do not apply in respect of a vehicle being in a bus lane if the vehicle is being used:-
- (a) in the service of a local authority for the purpose of collecting refuse;
  - (b) for the purposes of the provision of a universal postal service (as defined in the Postal Services Act 2000<sup>e</sup>) provided the vehicle bears the livery of a universal postal service provider;
  - (c) in connection with the removal of any obstruction to traffic;
  - (d) in connection with the maintenance, improvement or reconstruction of any road;
  - (e) in connection with the maintenance, improvement or construction of any street furniture including bus stop infrastructure;
  - (f) in connection with any building operation or demolition;
  - (g) in connection with the laying, erection, alteration or repair in or near the bus lane of any sewer or of any main, pipe or apparatus for the supply of gas, water or electricity, or of any communications network (within the meaning of the Communications Act 2003<sup>f</sup>), providing the vehicle cannot be used for that purpose without being in the bus lane or the bus-only route and in so far as the activity is not prohibited by the provisions of any other Order.
- 5.2 The controls specified in Article 3.1 do not apply in respect of a vehicle being in a bus lane:
- (a) so as to avoid an accident;
  - (b) to allow a person to get or give help in consequence of an accident or emergency or otherwise take action for public safety;
  - (c) to such an extent and for such a time as is needed to comply with any requirement resulting from works or an emergency in any part of the road adjoining the bus lane or bus-only route;
  - (d) if it is being used for ambulance, fire brigade or police purposes.

---

<sup>e</sup> 2000 c.26

<sup>f</sup> 2003 c.21

5.3 The controls specified in Articles 3.1 and 3.2 do not apply in respect of anything done with the permission or at the direction of a police constable in uniform or a civil enforcement officer.

Revocation

6.1 Without prejudice to the validity of anything done, or to any liability incurred in respect of any act or omission before the coming into force of this Order, the London Borough of Southwark (Bus priority) (Coldharbour Lane) (No. 1) Traffic Order 2015<sup>9</sup> is hereby revoked.

Dated this xxxxxxxx day of xxxxxxxx 201\*

[signature here]

NICKY COSTIN  
Parking and Road Network Business Unit Manager  
Regulatory Services

---

<sup>9</sup> LBS 2015/102

SCHEDULE - BUS LANES

<i>(1) Item</i>	<i>(2) Lengths of road</i>	<i>(3) Times of operation</i>	<i>(4) Direction of travel and type of bus lane</i>	<i>(5) Type of permitted vehicle</i>
1.	COLDHARBOUR LANE the north-west side, from a point 25 metres north-east of the north-eastern wall of No. 58 Coldharbour Lane to the common boundary of Nos. 10 and 12 Coldharbour Lane.	7 am to 7 pm Monday to Friday	North- eastbound with-flow lane	Bus Pedal cycle Taxi

EXPLANATORY NOTE

*(This note is not part of the Order)*

This Order amends the operating times of an existing bus priority lane in Coldharbour Lane, in the London Borough of Southwark.