

Victory Community Park Project

August/September 2021

Final design consultation survey report



Summary

1. Dates

This public engagement took place from Wednesday 18 August to Monday 27 September 2021 with an online survey open for responses and a paper survey available upon request. A public drop-in consultation meeting was held in the park on Saturday 11 September from 12pm to 4pm, with the Project Manager and Landscape Architect.

2. Promotion

The consultation was promoted through a poster (appendix 3) displayed in and around the park.

The two previous consultation exercises provided a project mailing list who were informed by email.

Local stakeholder groups including schools, community and residents groups were also asked if they could promote the consultation, and were sent posters if requested.

The Friends of Victory Community Park were extremely helpful in assisting with delivering paper surveys to local residents who could not access the online survey.

The consultation was also promoted via Southwark Council's social media accounts.

3. Survey

The design has been influenced by previous consultations. This was the final chance to comment on the design before a planning application is submitted.

The designs are shown in appendix 1 at the end of this report.

4. Executive Summary

The design presented for consultation was well received with positive comments about it, and residents pleased that previous consultation feedback has been taken into account.

The most frequent comments were asking for changes to small individual elements of the design rather than asking for major amendments. These are as follows:



- ***Some respondents felt that the proposed 1.2 metre high fencing is too low to prevent people getting into the park at night. Some also requested specific heights, usually of 2 metres or higher.***

- The current fencing does not prevent entry to the park at night, as people in the park have been reported and many respondents in previous consultations have expressed the view that the fencing should be much lower than it is now to make the park feel more welcoming. We have agreed to raise the height of the fencing to around 1.4 metres.

- ***The ball-court needs football goals at both ends***
 - The final design set out a ball-court with basketball hoops at both ends and a football goal only at one end to allow for informal football kick-about and basketball pickup games which can be played using only one hoop. We have decided to keep the design the same. This is because basketball was observed to be more often played than football and we want the new design to ensure a space for basketball only is always available. The new large flat lawn will be suitable for football but cannot be used for basketball. The local Black, Asian and Minority Ethnic population has not been well represented during the consultation and basketball is proven to be more popular with people from Black, Asian and Minority Ethnic communities. Advice from representatives of a local basketball team supports our decision.
- ***Concerns raised about three new picnic tables all grouped together next to the play area which would allow larger groups of 10 people or more to congregate and this could lead to anti-social behaviour.***
 - We feel it is important to increase seating of all types around the park but understand the concerns about anti-social behaviour and large groups gathering. Therefore we will keep 3 picnic tables, but will spread them out across the park with one in the play area itself for parents and carers and others elsewhere in the park.
- ***Residents requested we retain the Victory Place entrance and close the Balfour Street entrance rather than create a new entrance on the corner of the two because of concerns about the levels of traffic on Balfour Street and that the Victory Place entrance is currently the busiest.***

- We consider that a new wider entrance on the corner of both streets will encourage more visitors into the park from all directions, and will still be convenient for those coming from Balfour Street. The entrance here will be set back from the road side allowing more space on the pavement, increasing the distance from traffic.

5. Results

There were 34 surveys returned (including both online and paper) alongside comments at the drop-in event and from the Friends group.

Question: Now you have looked at the design do you have any comments?

The comments have been grouped according to common themes to indicate how frequently each view was expressed. These common themes are shown in full in Appendix 2. Each response usually contained more than one theme.

1) The **most common suggestion (17 comments or 50%)** was that the 1.2 metre high perimeter fence is too low.

The height of the fence

Some residents would prefer higher fencing than the proposed 1.2 metres, but there was also support for a low fence, or no fence at all. In the previous consultation we asked if the high fencing should be replaced with lower railings and 51% of respondents liked lower fencing, while 28% disliked it. Considering the feedback from all of the consultations it is clear that many residents want lower and more attractive fencing than is currently in place. The current high fencing does not prevent some people entering the park at night. Therefore we are proposing new fencing at a height of around 1.4 metres. The fencing style will also be similar in style as shown in the image.

Football and basketball

It was mentioned that the ball-court needs two football goals (12 comments). The design proposed two basketball hoops and one football goal to allow for informal kick-about. This was in response to local surveys which showed basketball use as high in this park. Multiple groups were observed using the current ball-court at the same time, playing both football and basketball using half of the court each. Having one end of the court available for basketball at all times would allow a football kick-about and a basketball pick-up game to be played at the same time. As evidenced by Sport England's Sport For All survey, basketball is popular with Black communities, who were under represented in the responses to this survey. A group representing a local basketball team in Southwark advised that a stand-alone basket hoop is always preferable, rather than a combined basket hoop and football goal, to provide maximum opportunities for basketball. As a result of this we will keep the design the same with two basketball hoops and one football goal.

Seating and Picnic tables

Some were concerned that more picnic tables will encourage people to stay longer and eat and drink more. It was noted there were no public toilets on or very near the park. Some respondents have observed people using the world border as a toilet and some felt that this situation would get worse (8 comments). However the council aims to encourage people to spend time in the park and

enjoy it. Public toilets are available 12 minutes walk away at the Castle Leisure Centre and these will be signposted. CCTV is being considered as a way of discouraging antisocial behaviour, if it can be afforded within budgets.

Other comments about seating include that the picnic tables are too close to the playground with people possibly smoking and swearing (6) and that three picnic tables close to each other would encourage bigger groups to congregate (6) increasing the potential for antisocial behaviour.

The three picnic tables will be separated with one placed in the play area itself for use by families. Adults without children are not permitted in the play area. We will not reduce the number, as previous consultations and surveys have shown a need for more picnic tables. The enjoyment of people who use the park responsibly should not be spoiled by the few who commit antisocial behaviour. Issues of anti-social behaviour are tackled by the park liaison officers. Improving the quality of parks has proven to reduce antisocial behaviour by instilling pride in the local area.

Further consultation

Residents also asked us to continue consultation with local groups when we choose the species of plants and flowers, playground equipment and World Border enhancements, which will include some infill plants which will be agreed with the Friends Group. We commit to continuing to talk to the Friends Group and local children and parents as we progress.

Entrances

We had 6 comments about the changes to the entrance(s) on the corners of Victory Place and Balfour Street. They were concerned that the new entrance created on this corner leads onto Balfour Street where traffic is reported to have become busier recently due to changes to the road layouts. It is argued that a safer access would be to retain the Victory Place entrance.

The new entrance on the corner of the park will be wider and set back from the road with clear visibility and a wider pavement area, increasing the distance from the road. One large visible entrance on this corner will attract more visitors and allow easy access from both directions, including from Balfour Street.

Equalities information and the profile of respondents

Full results are shown at the end of this report, along with statistics for the local area.

There is an over-representation of white people (78%) compared with the local population who are 48% white. Black people were the most under-represented, forming 30.5% of the local population but only 5.5% of respondents.

Respondents aged 45-54 represented the highest proportion (18%) while they represent 12.2% of the local population. Within the Borough, Bankside and Walworth Community profile data, the East Walworth profile (shown on page 8) has a young demographic. 21% of respondents were under 16 and 18.5 % of the local population is under 15 so children were well represented, However, 16.9% of the local population were aged 16-24 and we had no respondents in this age group. This shows that young adults were under-represented.

The gender of respondents is representative of the local population.

More residents in Southwark live with a disability than the London average. Only 6% of respondents stated that they have a disability and this is lower than the estimated 17.5% of Southwark residents. It is important that we ensure the design meets the needs of visitors with disabilities who have been underrepresented in the consultation responses. An Equalities Impact Assessment (EQIA) has been undertaken, which reviewed the design and made suggestions about how it could be improved for those with protected characteristics (including disability) under the Equality Act 2010. This includes ensuring the scheme enables easy access for people with disabilities and/or limited mobility. Key comments were about the benefits of raising the ball-court to ground level, and including wide entrances, paths and clear signage. It was also recommended as good practice to have gates which once opened can be locked in an open position, and are a minimum 1,000mm wide. The play area will also be designed so that children with disabilities can play alongside all of their friends.

Next Steps

Feedback has shaped the design during the three public consultation exercises. We will now apply for planning permission.

Construction work is currently estimated to start in the autumn 2022 and expected to take around six months. Please visit the website below for updates on project progress.

www.southwark.gov.uk/victory-community-park

Equalities Information Results

Gender of respondents	number	%	% of those who responded to this question
Male	8	23.5%	47 %
Female	9	26.5%	53 %
Not answered	17	50%	n/a

Ethnicity of respondents	number	%	% of those who responded to this question
Any other Asian	1	3%	5.5%
Black British	1	3%	5.5%
Mixed White Black African	0	0%	5.5% of answered
Mixed White Asian	0	0%	
Other Mixed	1	3%	
Other Ethnic	1	3%3%	5.5%
Other European	5	15%	78% of those who answered
Other White	1	3%	
White British	7	21%	
White English	1	3%	
White Scottish	0	0%	
White Irish	0	0%	
Not answered	16	46%	
Total	34		

Age of respondents	Number	%	% of those who responded to this question
Under 16	4	12%	21%
17 – 24	0	0%	0%
25 - 34	2	6%	11%
35 - 44	3	9%	16%
45 - 54	6	18%	32%
55 - 64	2	6%	11%
65 – 74	2	6%	11%
75 plus	0	0%	0%
Not answered	15	44%	n/a
Total	34		

Local community profile data for East Walworth

Gender	Male	49.7%
	Female	50.3%

Age	Under 15	18.5%
	16-24	16.9%
	25-29	12.0%
	30-34	9.7%
	35-39	7.8%
	40-44	7.7%
	45-49	6.9%
	50-54	5.3%
	55-59	3.8%
	60-64	3.3%
	65+	8.3%

Ethnic Group	White	48.2%
	Mixed/Multiple Ethnic Groups	6.7%
	Asian/Asian British	10.3%
	Black/African/Caribbean/ Black British	30.5%
	Other Ethnic Group	4.4%

Appendix 1. Proposed Design shown during consultation: View from north east of park

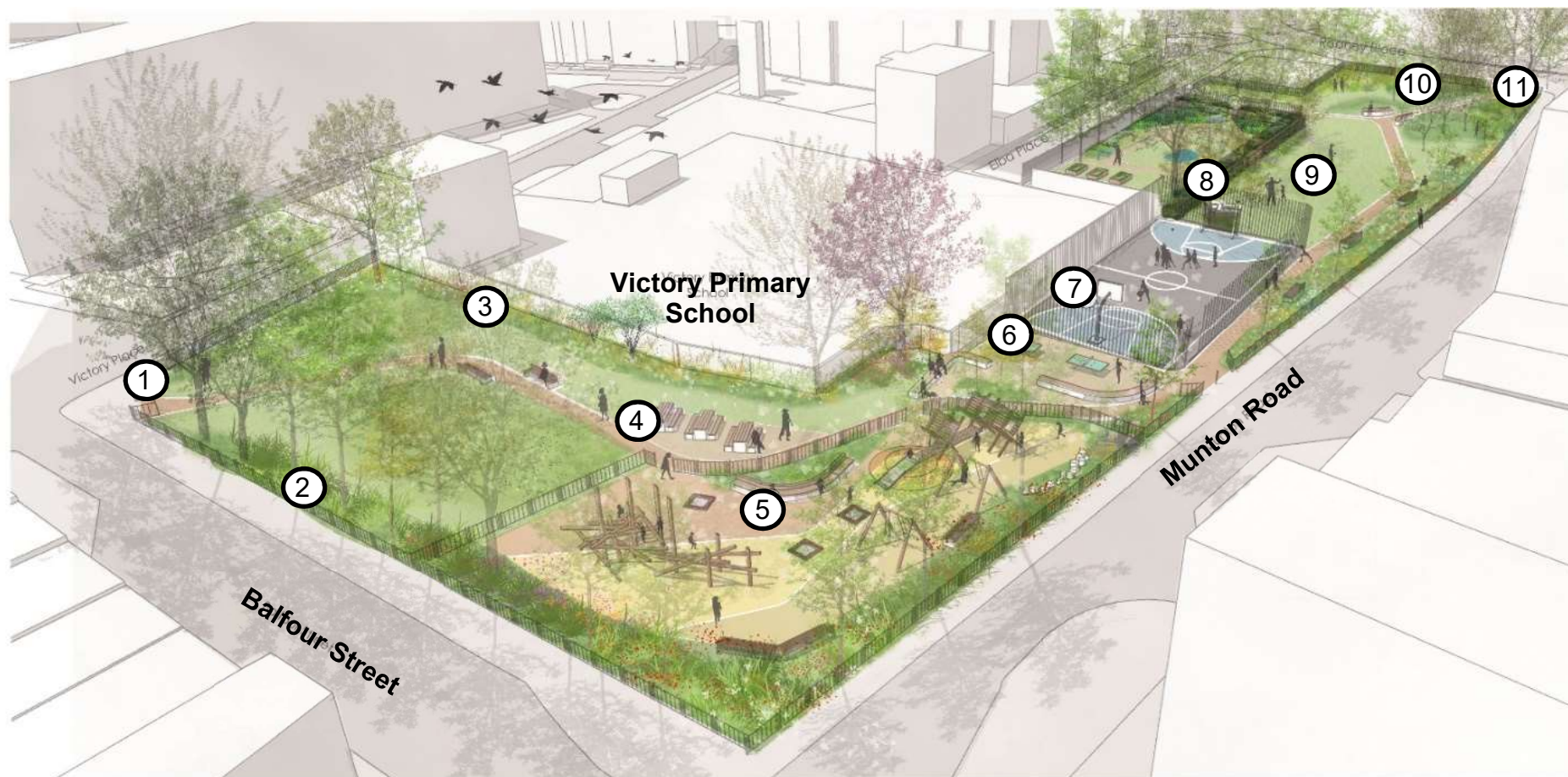

- | | | | |
|------------------------|--|----------------------------------|----------------------------------|
| 1) Single new entrance | 2) Improve fencing at 1.2 metres high. | 3) Keep and improve World Garden | 4) Expand picnic area |
| 5) Improved play space | 6) Table tennis and seating | 7) Refurbished ball court | 8) New entrance to nature garden |
| 9) New flat grass lawn | 10) New plants and biodiversity area | 11) New entrance to park | |

Appendix 1 continued. Proposed Design shown during consultation: View from south west of park



Appendix 2; Table of all collated comments from the consultation. See separate document

Appendix 3. Promotional poster (below)

Have your say on the final plans for Victory Community Park

Consultation meeting

Saturday 11 September – 12pm to 4pm



SCAN ME

We are holding a public consultation meeting in Victory Park on Saturday 11 September between 12pm to 4pm.

Please come along to talk to the design team.

If you have any questions or would like a paper copy of the plans, please email parks@southwark.gov.uk.

Please send us your views by **Monday 27 September 2021**.

For more info visit:

www.southwark.gov.uk/victorycommunitypark

(or scan the QR code above).

 @lb_southwark  facebook.com/southwarkcouncil

Southwark
Council
southwark.gov.uk