

# Public notice

## Steedman Street - walking and cycling improvements

*The London Borough of Southwark (Parking places) (CPZ 'E') (Amendment No. \*) Order 201\**

*The London Borough of Southwark (Waiting and loading restrictions) (Amendment No. \*) Order 201\**

1. Southwark Council hereby GIVES NOTICE that it proposes to make the above orders under the powers of the Road Traffic Regulation Act 1984<sup>1</sup>, as amended.
2. The effect of the orders would be, in controlled parking zone 'E':-  
in STEEDMAN STREET, (i) to convert the existing lengths of single yellow line waiting restrictions on the north-east and north-west sides to operate 'at any time' (double yellow lines), and (ii) to replace an existing permit holders' parking place on the north-west side, with a new 'shared-use' parking place and increases the length by 3.5 metres (total length of bay 13.5 metres); and  
in HAMPTON STREET on the north-west side, (i) to revoke a redundant permit holders' parking place; and (ii) to re-define an existing 'shared-use' parking place so as to reflect more closely the location in the street.
3. Southwark Council hereby GIVES FURTHER NOTICE under sections 90A to 90I of the Highways Act 1980<sup>2</sup> and in accordance with the provisions of the Highways (Road humps) Regulations 1999<sup>3</sup> and the Highways (Traffic calming) Regulations 1999<sup>4</sup>, propose to:-  
(a) construct speed tables of flat-top construction having a maximum height of 100 millimetres and covering the entire width of the carriageway, at the following locations:-  
HAMPTON STREET and WOLLASTON CLOSE junction, extending from a point 21 metres south-west of the western kerb-line of Spare Street south-westward for a distance of 25.5 metres, and (ii) extending from the north-western kerb-line of Hampton Street into WOLLASTON CLOSE northward for a distance of 13.5 metres; and  
STEEDMAN STREET, extending from the south-eastern kerb-line of Hampton Street south-eastward for a distance of 7 metres; and  
(b) to place a road hump of sinusoidal cross-section construction approximately 3.7 metres in length, having a maximum height of 100 millimetres and covering the greater width of the carriageway, centred upon the following location: at a point 9 metres south-west of the western kerb-line of Spare Street.
4. For more information about these proposals please contact the council's Highways – Transport Projects team by e-mail [Highways@southwark.gov.uk](mailto:Highways@southwark.gov.uk).
5. Copies of this notice, the proposed orders, a statement of the council's reasons for making this change and plans may be found online at [www.southwark.gov.uk/trafficorders](http://www.southwark.gov.uk/trafficorders), paper copies may be obtained from or viewed at Highways, 3rd floor hub 2, 160 Tooley Street, London SE1 2QH. Please email [traffic.orders@southwark.gov.uk](mailto:traffic.orders@southwark.gov.uk) or call 020 7525 3497 for details.
6. Anyone wishing to object to or make any other representations regarding the proposal, may use the form labelled '*Parking - Road traffic and highway schemes - responding to statutory consultation notices*' at [www.southwark.gov.uk/statutoryconsultationnotices](http://www.southwark.gov.uk/statutoryconsultationnotices) or send a statement in writing to: Traffic Order Consultations, Highways, Southwark Council, Environment and Leisure, P.O. Box 64529, London SE1P 5LX or by e-mail to [traffic.orders@southwark.gov.uk](mailto:traffic.orders@southwark.gov.uk) quoting reference '*TMO1819-034 Steedman Street*' by 7 February 2019. Please note that if you wish to object to this proposal you must state the grounds on which your objection is made.
7. When making an objection or representation, please be aware that this may be communicated to other people who may be affected. Information provided in response to this consultation, including in some circumstances personal information, may also be subject to publication or disclosure under the requirements of current access to information legislation.

Dated 17 January 2019

**Nicky Costin** - Parking and Network Management Business Unit Manager, Regulatory Services

---

<sup>1</sup> 1984 c.27

<sup>2</sup> 1980 c.66

<sup>3</sup> S.I. 1999/1065

<sup>4</sup> S.I. 1999/1026

# Statement of reasons

## Steedman Street - walking and cycling improvements

*The London Borough of Southwark (Parking places) (CPZ 'E') (Amendment No. \*) Order 201\**  
*The London Borough of Southwark (Waiting and loading restrictions) (Amendment No. \*) Order 201\**

The project is part of a wider regeneration programme for the Elephant and Castle area and seeks to improve the public realm in the local area as well as improve the walking and cycling links from Walworth Road to the Newington Estate.

The changes to parking underneath the railway bridge on Steedman Street are made to provide 'shared-use' parking for ticket holders, blue badge holders, and permit holders.

Double yellow lines have been provided to complement widened footways and ensure the safe passage of vehicles on Steedman Street.

The introduction of raised features are for the purposes of slowing vehicle speeds and providing more accessible crossing points for pedestrians.

Link to the decision:

<http://modern.gov.southwark.gov.uk/ieDecisionDetails.aspx?ID=6548>

Dated 17 January 2019

For more information contact:-  
Highways – Transport Projects  
[Highways@southwark.gov.uk](mailto:Highways@southwark.gov.uk)

1507 FULL BLEED AT 150MM X 106MM  
S:\PROJECTS\TRAFFIC - SOUTHWARK HWYS 2016\HWY LOTC PROFESSIONAL SERVICES\PROJECTS\0405 HAMPTON & STEEDMAN (1000) CAD\03 SHEETS\0405\DRS\100A.DWG

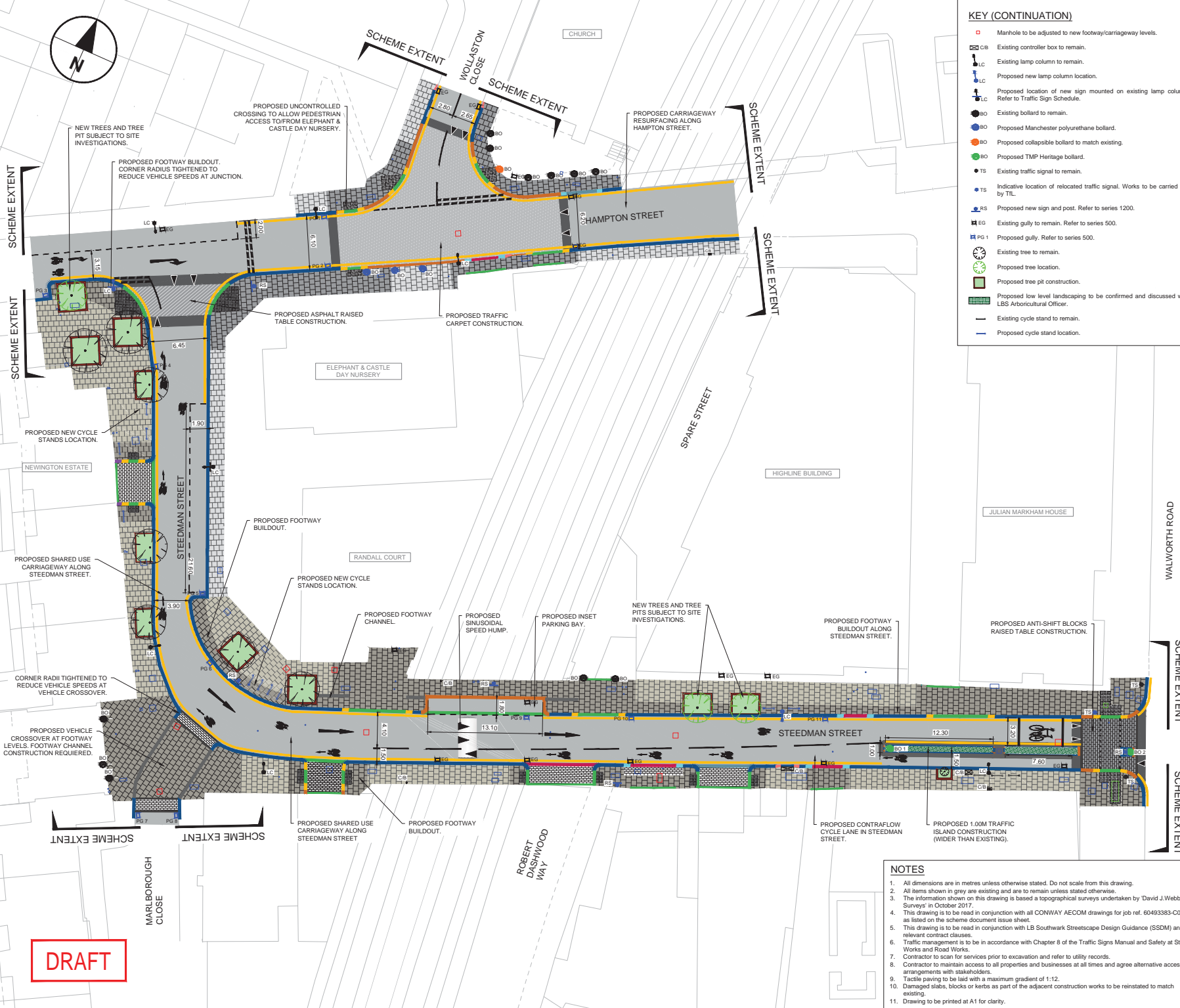

DRAFT

**KEY (CONTINUATION)**

- Manhole to be adjusted to new footway/c carriageway levels.
- Existing controller box to remain.
- Existing lamp column to remain.
- Proposed new lamp column location.
- Proposed location of new sign mounted on existing lamp column. Refer to Traffic Sign Schedule.
- Existing bollard to remain.
- Proposed Manchester polyurethane bollard.
- Proposed collapsible bollard to match existing.
- Proposed TMP Heritage bollard.
- Existing traffic signal to remain.
- Indicative location of relocated traffic signal. Works to be carried out by TfL.
- Proposed new sign and post. Refer to series 1200.
- Existing gully to remain. Refer to series 500.
- Proposed gully. Refer to series 500.
- Existing tree to remain.
- Proposed tree location.
- Proposed tree pit construction.
- Proposed low level landscaping to be confirmed and discussed with LBS Arboricultural Officer.
- Existing cycle stand to remain.
- Proposed cycle stand location.

**KEY**

- Carriageway resurfacing.
- Carriageway reinstatement.
- Unbound footway construction (granite natural stone paving slab).
- Bound footway construction (granite natural stone paving slab).
- Unbound footway construction (precast concrete paving flags).
- Bound footway construction (precast concrete paving flags).
- Controlled blister tactile paving construction (precast concrete paving flags).
- Uncontrolled blister tactile paving construction (granite natural stone paving slab).
- Anti-silt blocks raised table construction.
- Asphalt traffic carpet construction.
- Asphalt raised table construction.
- Vehicle crossover construction (imitation granite sett precast concrete blocks).
- Sinusoidal speed hump construction.
- Footway channel (sections of cut granite natural stone paving slabs).
- Proposed granite full height kerb.
- Proposed granite transition kerb (dropper).
- Proposed granite kerb (150mm wide into 300mm wide).
- Proposed granite dropped kerb.
- Proposed granite kerb (60mm upstand).
- Proposed granite battered kerb (50mm between top of kerb and base of battered face of kerb).
- Proposed granite battered kerb (25mm between top of kerb and base of battered face of kerb).
- Proposed granite transition kerb (type 1 into type 2 profile).
- Proposed double step carriageway edge kerb.
- Proposed quadrant kerb.
- Proposed road markings - Refer to series 1200.
- Utility covers to be adjusted to new footway/c carriageway levels and recessed.
- Recessed utility covers and frame within areas of tactile paving.

**LEGEND**

**LOCATION PLAN**



Not To Scale

**NOTES**

1. All dimensions are in metres unless otherwise stated. Do not scale from this drawing.
2. All items shown in grey are existing and are to remain unless stated otherwise.
3. The information shown on this drawing is based on topographical surveys undertaken by David J. Webb Surveys in October 2017.
4. This drawing is to be read in conjunction with all CONWAY AECOM drawings for job ref. 60493383-C0453 as listed on the scheme document issue sheet.
5. This drawing is to be read in conjunction with LB Southwark Streetscape Design Guidance (SSDM) and all relevant contract clauses.
6. Traffic management is to be in accordance with Chapter 8 of the Traffic Signs Manual and Safety at Street Works and Road Works.
7. Contractor to scan for services prior to excavation and refer to utility records.
8. Contractor to maintain access to all properties and businesses at all times and agree alternative access arrangements with stakeholders.
9. Tactile paving to be laid with a maximum gradient of 1:12.
10. Damaged slabs, blocks or kerbs as part of the adjacent construction works to be reinstated to match existing.
11. Drawing to be printed at A1 for clarity.

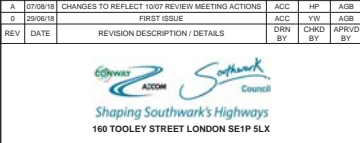

**HAMPTON STREET & STEEDMAN STREET DETAILED DESIGN**

**TITLE:**  
SERIES 100  
GENERAL ARRANGEMENT  
SHEET 1 OF 1

CONTRACT NO:	60493383-C0453	DRAWN ACC	ACC
SCALE:	1:200 @ A1	PURPOSE:	FOR COMMENT
DRAWING NO:	60493383-C0453-100-01	CHECKED HP	APPROVED AGB
DATE DRAWN:	JUNE 2018	REV:	A
DATE ISSUED:			07 AUGUST 2018



THE COUNCIL OF THE LONDON BOROUGH OF SOUTHWARK

# TRAFFIC MANAGEMENT ORDER

201\* No. \*\*\*

---

The London Borough of Southwark (Parking places) (CPZ 'E') (No. \*) Order 201\*

Made: xx xxxx 201\*

Coming into force: xx xxxx 201\*

---

The council of the London Borough of Southwark, after consulting the Commissioner of Police of the Metropolis, in exercise of the powers conferred by sections 45, 46, 49 and 124 of and Part IV of Schedule 9 to the Road Traffic Regulation Act 1984<sup>a</sup>, as amended, and of all other powers thereunto enabling, hereby make the following Order:

## Citation and commencement

- 1.1 This Order may be cited as the London Borough of Southwark (Parking places) (CPZ 'E') (No. \*) Order 201\* and shall come into force on xx xxxx 201\*.

## Interpretation

- 2.1 In this Order:

“council” means the council of the London Borough of Southwark;

“enactment” means any enactment, whether public general or local, and includes any order, bye-law, rule, regulation, scheme or other instrument having effect by virtue of an enactment; and

“the Order of 2010” means The London Borough of Southwark (Parking places) (CPZ 'E') (No. 1) Order 2010<sup>b</sup>.

- 2.2 Any reference in this Order to any enactment shall be construed as a reference to that enactment as amended, applied, consolidated, re-enacted by or as having effect by virtue of any subsequent enactment.
- 2.3 Unless the context otherwise requires, any expression used in this Order which is also used in the Order of 2014 shall have the same meaning as in that Order.

---

<sup>a</sup> 1984 c.27

<sup>b</sup> LBS 2010/065

### Revocation

- 3.1 Without prejudice to the validity of anything done, or to any liability incurred in respect of any act or omission before the coming into force of this Order, the Order of 2010 shall have effect as though:-
- (a) the items numbered 87 and 164 in Schedule 1 therein were revoked; and
  - (b) the item numbered 1 in Schedule 2 therein was revoked.

### Designation of parking places and application of the Order of 2010 thereto

- 4.1 Each area on a highway comprising the length of carriageway of a street specified in column 2 of a Schedule to this Order and bounded on one side of that length by the edge of the carriageway, is designated as a parking place.
- 4.2 The provisions of the Order of 2010 (other than Articles 3 and 15) shall apply to the areas described in each Schedule to this Order as if in those provisions any reference to a designated parking place or to a parking place shall include a reference to an area designated as a parking place by this Order and as if any reference to Schedule 2 to the Order of 2010 included a reference to the Schedule to this Order.

### Placing of traffic signs, etc.

- 5.1 The council shall:-
- (a) place and maintain traffic signs indicating the limits of each parking place referred to in the Schedules to this Order;
  - (b) place and maintain in or in the vicinity of each parking place referred to in a Schedule to this Order traffic signs indicating that such parking places may be used during the permitted hours for the leaving only of the vehicles specified in Articles 4.1 and 4.3, as the case may be, of the Order of 2010;
  - (c) carry out such other works as is reasonably required for the purposes of the satisfactory operation of a parking place.

Dated this xxx day of xxx 201\*

[signature here]

NICKY COSTIN  
Parking and Network Management Business Unit Manager  
Regulatory Services

SCHEDULE – ‘SHARED-USE’ PARKING PLACES

<i>No. of parking place (1)</i>	<i>Designated parking place (2)</i>	<i>Permitted hours (3)</i>	<i>Maximum parking period (4)</i>	<i>Minimum return interval (5)</i>
***	HAMPTON STREET the north-east to south-west arm, the north-west side, from a point 15.5 metres south-west of the western kerb-line of the vehicular access to Wollaston Close south-westward for a distance of 60 metres.	8.30 am to 6.30 pm Monday to Friday	4 hours	2 hours
***	STEEDMAN STREET the north-west side, from a point 68.7 metres south-west of the south-western kerb-line of Walworth Road south-west for a distance of 13.5 metres.	8.30 am to 6.30 pm Monday to Friday	4 hours	2 hours

## EXPLANATORY NOTE

*(This note is not part of the Order)*

This Order:-

- i) revokes a redundant permit holders' parking place in Hampton Street;
- ii) revokes and re-defines a 'shared-use' parking place in Hampton Street, so as to reflect more closely the location in the street; and
- iii) replaces an existing permit holders' parking place with a 'shared-use' parking place in Steedman Street (also lengthening the bay by 3.5 metres),

in the London Borough of Southwark.



THE COUNCIL OF THE LONDON BOROUGH OF SOUTHWARK

# TRAFFIC MANAGEMENT ORDER

2019 No. \*\*\*

---

London Borough of Southwark (Waiting and loading restrictions)  
(Amendment No. \*\*) Order 201\*

Made: xx xxxx 201\*

Coming into force: xx xxxx 201\*

---

The council of the London Borough of Southwark, after consulting the Commissioner of Police of the Metropolis, in exercise of the powers conferred by sections 6 and 124 of and Part IV of Schedule 9 to the Road Traffic Regulation Act 1984<sup>a</sup>, as amended, and of all other powers thereunto enabling, hereby make the following Order:

## Citation and commencement

- 1.1 This Order may be cited as The London Borough of Southwark (Waiting and loading restrictions) (Amendment No. \*) Order 201\* and shall come into force on xx xxxx 201\*.

## Interpretation

- 2.1 In this Order:-

"council" means the council of the London Borough of Southwark;

"enactment" means any enactment, whether public general or local, and includes any order, bye-law, rule, regulation, scheme or other instrument having effect by virtue of an enactment; and

"the Order of 2015" means the London Borough of Southwark (Waiting and loading restrictions) Consolidation Order 2015<sup>b</sup>, as amended;

- 2.2 Any reference in this Order to any enactment shall be construed as a reference to that enactment as amended, applied, consolidated, re-enacted by or as having effect by virtue of any subsequent enactment.
- 2.3 Unless the context otherwise requires, any expression used in this Order which is also used in the Order of 2015 shall have the same meaning as in that Order.

---

<sup>a</sup> 1984 c.27

<sup>b</sup> LBS 2015/082



Amendment of the Order of 2015

- 3.1 Without prejudice to the validity of anything done, or to any liability incurred in respect of any act or omission before the coming into force of this Order, the Order of 2015 shall have effect as though the item numbered 925 in Schedule 1 to that Order is substituted the item similarly numbered and set out in columns 1, 2 and 3 of Schedule 1 to this Order.

Dated this xxxx day of xxxx 201\*

[signature here]

NICKY COSTIN  
Parking and Road Network Business Unit Manager  
Regulatory Services

SCHEDULE – WAITING RESTRICTIONS (SUBSTITUTION)

<i>Item No. (1)</i>	<i>Street (2)</i>	<i>Prescribed hours (3)</i>
925.	STEEDMAN STREET	
	(a) the north-west and north-east side	
	(i) between the south-western kerb-line of Walworth Road and a point 68.5 metres south-west of that kerb-line;	At any time
	(ii) between a point 82 metres south-west of the south-western kerb-line of Walworth Road and a point 36.6 metres south-east of the south-eastern kerb-line of Hampton Street;	At any time
	(iii) between the south-eastern kerb-line of Hampton Street and a point 11.5 metres south-east of that kerb-line;	At any time
	(b) the south-east and south-west side.	At any time

EXPLANATORY NOTE

*(This note is not part of the Order)*

This Order amends lengths of 'at any time' waiting restrictions in Steedman Street, in the London Borough of Southwark.