

Public notice

John Keats Primary School perimeter improvements



*The London Borough of Southwark (Parking places) (Car club) (No. *) Order 201**

*The London Borough of Southwark (Loading bays) (No. *) Order 201**

*The London Borough of Southwark (Prescribed Route) (Verney Road) (No. *) Traffic Order 201**

*The London Borough of Southwark (Free parking places) (Buses) (No. *) Order 201**

*The London Borough of Southwark (Waiting and loading restrictions) (Amendment No. *) Order 201**

1. Southwark Council hereby GIVES NOTICE that it proposes to make the above orders under the powers of the Road Traffic Regulation Act 1984¹, as amended.
2. The effect of the orders would be: -
 - (a) in VERNEY ROAD, on the north-west side (i) to introduce a new 'coaches only' bus parking place and formalise one other (both 10 metres in length), (ii) to formalise an existing car club bay (5.6 metres in length), and (iii) to formalise an existing loading bay (6 metres in length); and (iv) to re-define an existing 'no entry' for vehicles (except pedal-cycles) restriction between the junction of its north-west to south-east arm with its north-east to south-west arm and a point 19.5 metres north-east of that junction in which vehicles (except pedal cycles) would be prohibited from proceeding in a south-westerly direction; and
 - (b) to amend and extend existing 'at any time' waiting restrictions (double yellow lines) between St James's Road and Verney Way, in Rotherhithe New Road, Verney Road and Verney Way so as to accommodate the above implementations, and the new traffic calming measures as described below.
3. Southwark Council hereby GIVES FURTHER NOTICE that it has approved under section 23 of the Road Traffic Regulation Act 1984, the provision of new raised 'zebra' pedestrian crossings at the following locations:- ST JAMES'S ROAD, the centre of which would be located 13 metres north-east of the north-eastern kerb-line build-out of Verney Road; zig-zag markings, on which vehicles would be prohibited from stopping at all times would be laid for a distance of 5 metres south-west of this crossing; and on the north-east of this crossing (i) 4.5 metres on the north-western side and (ii) 8 metres on the south-eastern side; and ROTHERHITHE NEW ROAD, the centre of which would be located 39 metres south-west of the south-western kerb-line of Verney Way; zig-zag markings, on which vehicles would be prohibited from stopping at all times would be laid for a distance of 7.8 metres south-west of this crossing; and on the north-east of this crossing (i) 4.5 metres on the north-western side and (ii) 8.8 metres on the south-eastern side.
4. Southwark Council hereby GIVES FURTHER NOTICE under sections 90A to 90I of the Highways Act 1980² and in accordance with the provisions of the Highways (Road humps) Regulations 1999³ and the Highways (Traffic calming) Regulations 1999⁴, propose to construct speed tables of flat-top construction having a maximum height of 100 millimetres and covering the entire width of the carriageway, at the following locations:-
ST JAMES'S ROAD, extending 8.5 metres north-east of the north-eastern kerb-line build-out of Verney Road north-eastward for a distance of 9 metres;
ST JAMES'S ROAD, extending from its junction with the north-western kerb-line of Rotherhithe New Road north-westward for a distance of 9.5 metres;
ROTHERHITHE NEW ROAD, extending from a point 34.5 metres south-west of the south-western kerb-line of Verney Way south-westward for a distance of 9 metres;
ROTHERHITHE NEW ROAD, extending from a point 123 metres south-west of the south-western kerb-line of Verney Way south-westward for a distance of 8.8 metres; and
VERNEY ROAD, extending from its junction with the south-eastern kerb-line of Rotherhithe New Road south-eastward for a distance of 8 metres.
5. For more information about these proposals please contact the council's Highways – Transport Projects team Highways@southwark.gov.uk .
6. Copies of this notice, the proposed orders, a statement of the council's reasons for making this change and plans may be found online at www.southwark.gov.uk/trafficorders, paper copies may be obtained from or viewed at Highways, 3rd floor hub 2, 160 Tooley Street, London SE1 2QH. Please call 020 7525 3497 for details.
7. Anyone wishing to object to or make any other representations regarding the proposal, may use the form labelled '*Parking - Road traffic and highway schemes - responding to statutory consultation notices*' at

¹ 1984 c.27

² 1980 c.66

³ S.I. 1999/1065

⁴ S.I. 1999/1026

www.southwark.gov.uk/statutoryconsultationnotices or send a statement in writing to: Traffic Order Consultations, Highways, Southwark Council, Environment and Leisure, P.O. Box 64529, London SE1P 5LX or by e-mail to traffic.orders@southwark.gov.uk quoting reference '*John Keats Primary School*' by 29 November 2018. Please note that if you wish to object to this proposal you must state the grounds on which your objection is made.

8. Under the requirements of current access to information legislation, any letter or e-mail sent to the Council in response to this Notice may be subject to publication or disclosure, or both, including communication to other persons affected.

Dated 8 November 2018

Nicky Costin - Parking and Network Management Business Unit Manager, Regulatory Services

Statement of reasons

John Keats Primary School perimeter - walking and cycling improvements

*The London Borough of Southwark (Parking places) (Car club) (No. *) Order 201**

*The London Borough of Southwark (Loading bays) (No. *) Order 201**

*The London Borough of Southwark (Prescribed Route) (Verney Road) (No. *) Traffic Order 201**

*The London Borough of Southwark (Free parking places) (Buses) (No. *) Order 201**

*The London Borough of Southwark (Waiting and loading restrictions) (Amendment No. *) Order 201**

The London Borough of Southwark is proposing to introduce traffic calming measures and implement changes to the highway, as described below, within the areas surrounding the John Keats Primary School: located in Old Kent Road ward, in the London Borough of Southwark.

Proposed measures in: Rotherhithe New Road, St James's Road, Verney Road and Verney Way.

The changes are proposed alongside the recent re-development of the parcel of land bounded by Verney Road, Verney Way, St James Road and Rotherhithe New Road under planning application 13/AP/0065, which has introduced two new educational facilities and residential dwellings above.

As part of the aforementioned development, the following infrastructure improvements have been proposed in line with those listed in the section 106 agreement attached to the planning application:-

- enhancing pedestrian crossing facilities with a new raised zebra crossing and the relocation of existing facilities in Rotherhithe New Road and St James's Road;
- existing traffic calming features in Rotherhithe New Road are being relocated and upgraded to promote safe driving speeds and improved visibility for vehicle drivers;
- footways and parking places are being widened throughout the perimeter of the school site to improve the quality of the streets and to encourage safe driving;
- 'at any time' waiting restrictions are being introduced on Rotherhithe New Road to improve bus journey times and accessibility, and visibility around the new zebra crossing;
- 'at any time' waiting restrictions are being introduced on Verney Way to accommodate the widened footways;
- a new parking place designated for coaches (during school pick up and drop off times) is being introduced to Verney Road;
- the point at which an existing one-way north-eastbound traffic restriction and south-westbound contraflow mandatory cycle-lane begins is being amended to allow for the new above-mentioned 'coach only' parking place; and
- existing parking places: designated coach 'bus stopping area' (during school pick up and drop off times); a vehicle loading and unloading bay; and a car club members' bay in Verney Road, are being formalised.

Dated 8 November 2018

For more information contact:-

Highways – Transport Projects

Highways@southwark.gov.uk

ISO FALL BREEZAS 400 X 2071 MM

UKGRID EPNV0100001P0001V11PROJECTSTRAFIC - SOUTHWARK HPS 20141006.LOT C PROFESSIONAL SERVICESPROJECTS/C0424.ROTHERHITHE NEW ROAD/02/C0424 SHEETS/C0424-02-01.DWG

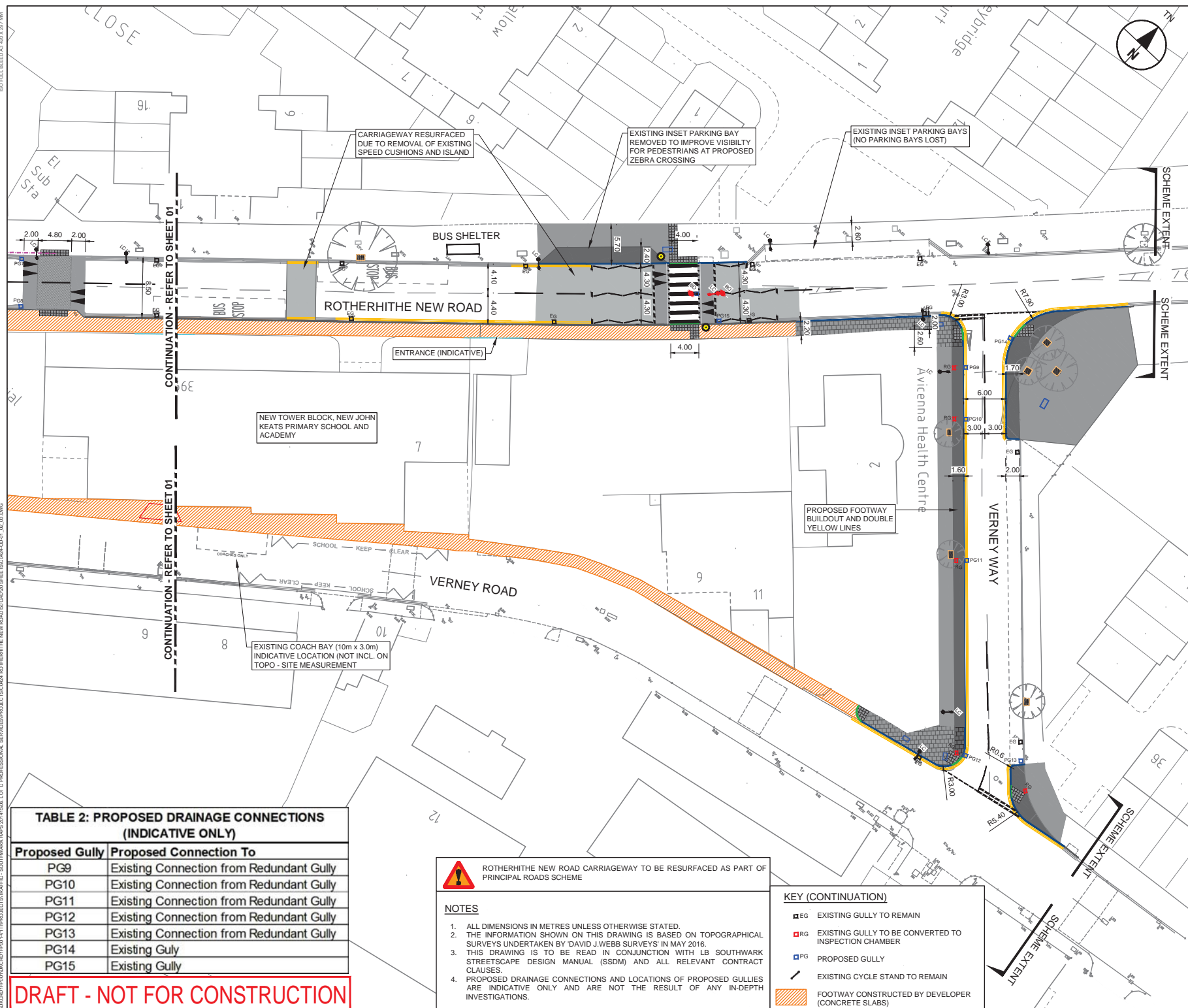

KEY

- ASPHALT CARRIAGEWAY RESURFACING
- FOOTWAY (CONCRETE SLABS)
- FOOTWAY (ASPHALT)
- PROPOSED FOOTWAY BUILDOUT (CONCRETE SLABS)
- PROPOSED FOOTWAY BUILDOUT (ASPHALT)
- BLISTER TACTILE PAVING
- PROPOSED RAISED TABLE (ASPHALT)
- UTILITY COVERS TO BE RESET TO NEW FOOTWAY / CARRIAGEWAY LEVEL
- UTILITIES UNAFFECTED (MANHOLES, CABLE TV, BT)
- EXISTING LAMP COLUMN
- EXISTING LAMP COLUMN TO BE REMOVED
- PROPOSED LAMP COLUMN WITH BELISHA BEACON
- EXISTING BOLLARD TO REMAIN
- EXISTING BOLLARD TO BE REMOVED
- NEW BOLLARD LOCATION
- PROPOSED BELISHA BEACON
- EXISTING GUARDRAIL TO BE REMOVED
- EXISTING DRAINAGE CHANNEL
- EXISTING KERB
- PROPOSED FULL HEIGHT KERB
- PROPOSED DROPPED KERB
- PROPOSED DOUBLE YELLOW LINES
- PROPOSED ROAD MARKINGS
- EXISTING TREE
- EXISTING TREE PIT

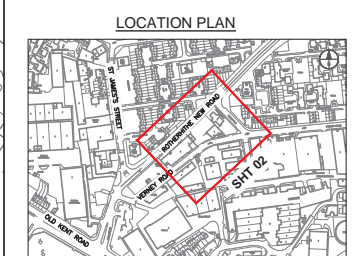

C	03/04/18	NO CHANGES	OS	NP	AGB
B	12/02/18	VERNEY WAY CARRIAGEWAY WIDTH REDUCED TO 6m	YV	JR	AGB
A	02/02/18	DESIGN REVISIONS FOLLOWING DOW	IF	YV	AGB
REV	DATE	REVISION DESCRIPTION / DETAILS	DRN	CHKD	APRVD
			BY	BY	BY

TABLE 2: PROPOSED DRAINAGE CONNECTIONS (INDICATIVE ONLY)

Proposed Gully	Proposed Connection To
PG9	Existing Connection from Redundant Gully
PG10	Existing Connection from Redundant Gully
PG11	Existing Connection from Redundant Gully
PG12	Existing Connection from Redundant Gully
PG13	Existing Connection from Redundant Gully
PG14	Existing Gully
PG15	Existing Gully

ROTHERHITHE NEW ROAD CARRIAGEWAY TO BE RESURFACED AS PART OF PRINCIPAL ROADS SCHEME

- NOTES**
- ALL DIMENSIONS IN METRES UNLESS OTHERWISE STATED.
 - THE INFORMATION SHOWN ON THIS DRAWING IS BASED ON TOPOGRAPHICAL SURVEYS UNDERTAKEN BY DAVID J. WEBB SURVEYS IN MAY 2016.
 - THIS DRAWING IS TO BE READ IN CONJUNCTION WITH LB SOUTHWARK STREETScape DESIGN MANUAL (SSDM) AND ALL RELEVANT CONTRACT CLAUSES.
 - PROPOSED DRAINAGE CONNECTIONS AND LOCATIONS OF PROPOSED GULLIES ARE INDICATIVE ONLY AND ARE NOT THE RESULT OF ANY IN-DEPTH INVESTIGATIONS.

KEY (CONTINUATION)

- EXISTING GULLY TO REMAIN
- EXISTING GULLY TO BE CONVERTED TO INSPECTION CHAMBER
- PROPOSED GULLY
- EXISTING CYCLE STAND TO REMAIN
- FOOTWAY CONSTRUCTED BY DEVELOPER (CONCRETE SLABS)

DRAFT - NOT FOR CONSTRUCTION

Southwark Council
Shaping Southwark's Highways
160 TOOLEY STREET LONDON SE1P 5LX

PROJECT: ROTHERHITHE NEW ROAD

TITLE: OUTLINE DESIGN - SHEET 2 OF 2

CONTRACT NO:	60493382-C0424	DRAWN:	BAB
SCALE:	1 : 500 @ A3	DESIGNED:	YV
		PURPOSE:	FOR APPROVAL
DRAWING NO:	60493382-C0424-OD-02	CHECKED:	AMC
		APPROVED:	JE
DATE DRAWN:	DECEMBER 2017	REV:	C
		DATE ISSUED:	19 DECEMBER 2017



THE COUNCIL OF THE LONDON BOROUGH OF SOUTHWARK

TRAFFIC MANAGEMENT ORDER

201* No. xxx

The London Borough of Southwark (Loading bays) (No. *) Order 201*

Made: 201*

Coming into force: 201*

The council of the London Borough of Southwark, after consulting the Commissioner of Police of the Metropolis, in exercise of the powers conferred by sections 6 and 124 to the Road Traffic Regulation Act 1984^a, as amended, and of all other powers thereunto enabling, hereby make the following Order:

Citation and commencement

- 1.1 This Order may be cited as The London Borough of Southwark (Loading bays) (No. *) Order 201* and shall come into force on xx xxxxxxxx 201*.

Interpretation

- 2.1 In this Order:-

"council" means the council of the London Borough of Southwark;

"enactment" means any enactment, whether public general or local, and includes any order, bye-law, rule, regulation, scheme or other instrument having effect by virtue of an enactment; and

"the Order of 2016" means the London Borough of Southwark (Loading bays) (No. 1) Order 2016^b.

- 2.2 Any reference in this Order to any enactment shall be construed as a reference to that enactment as amended, applied, consolidated, re-enacted by or as having effect by virtue of any subsequent enactment.
- 2.3 Unless the context otherwise requires, any expression used in this Order which is also used in the Order of 2016 shall have the same meaning as in that Order.

^a 1984 c.27

^b LBS 2016/005

Designation of loading bays and application of the Order of 2016 thereto

- 3.1 Each area on a highway comprising the length of carriageway of a street specified in column 2 of the Schedule to this Order and bounded on one side of that length by the edge of the carriageway, is designated as a loading bay.
- 3.2 The provisions of the Order of 2016 (other than Articles 3.1 and 12.1) shall apply to each area designated as a loading bay by this Order as if in those provisions any reference to a loading bay shall include a reference to each area designated as a loading bay by this Order and as if any reference to Schedule 1 to the Order of 2016 included a reference to the Schedule to this Order.

Placing of traffic signs etc.

- 4.1 The council shall:-
- (a) place and maintain traffic signs indicating the limits of each loading bay referred to in the Schedule to this Order;
 - (b) place and maintain in or in the vicinity of each loading bay referred to in the Schedule to this Order, traffic signs indicating that such a loading bay may be used during the permitted hours for the leaving only of the vehicles referred to in Article 4.1 of the Order of 2016; and
 - (c) carry out such other work as is reasonably required for the purposes of the satisfactory operation of a loading bay.

Dated this xxxxx day of xxxxxxxx 201*

[signature here]

NICKY COSTIN
Parking and Network Management Business Unit Manager
Regulatory Services

SCHEDULE - LOADING BAYS

<i>No. of loading bay</i> (1)	<i>Designated loading bay</i> (2)	<i>Permitted hours</i> (3)	<i>Maximum loading period</i> (4)	<i>Minimum return interval</i> (5)
***.	<p>VERNEY ROAD</p> <p>the north-west side of the main arm, from a point 37 metres north-east of its junction with the north-west to south-east arm of Verney Road north-eastward for a distance of 6 metres.</p>	At any time	1 hour	2 hours

DRAFT

EXPLANATORY NOTE

(This note is not part of the Order)

This Order formalises the designation of an existing loading bay in Verney Road, in the London Borough of Southwark.

DRAFT



THE COUNCIL OF THE LONDON BOROUGH OF SOUTHWARK

TRAFFIC MANAGEMENT ORDER

201* No. xxx

The London Borough of Southwark (Free parking places) (Buses) (No. *) Order 201*

Made: xx xxxxx 201*

Coming into force: xx xxxxx 201*

The council of the London Borough of Southwark, after consulting the Commissioner of Police of the Metropolis, in exercise of the powers conferred by sections 6 and 124 of and Part IV of Schedule 9 to the Road Traffic Regulation Act 1984^a, and of all other powers thereunto enabling, hereby make the following Order:-

Citation and commencement

- 1.1 This Order may be cited as the London Borough of Southwark (Free parking places) (Buses) (No. *) Order 201* and shall come into force on xx xxxxx 201*.

Interpretation

- 2.1 In this Order:-

"council" means the council of the London Borough of Southwark;

"enactment" means any enactment, whether public general or local, and includes any order, bye-law, rule, regulation, scheme or other instrument having effect by virtue of an enactment; and

"the Order of 2012" means the London Borough of Southwark (Free parking places) (Buses) (No. 1) Order 2012^b.

- 2.2 Any reference in this Order to any enactment shall be construed as a reference to that enactment as amended, applied, consolidated, re-enacted by or as having effect by virtue of any subsequent enactment.
- 2.3 Unless the context otherwise requires, any expression used in this Order which is also used in the Order of 2012 shall have the same meaning as in that Order.

^a 1984 c.27

^b LBS 2012/056

Designation of parking place and application of the Order of 2012 thereto

- 3.1 Each area on a highway comprising the length of carriageway of a street specified in column 2 of the Schedule to this Order and bounded on one side of that length by the edge of the carriageway, and having a width throughout of 3 metres, is designated as a parking place.
- 3.2 The provisions of the Order of 2012 (other than Articles 3.1 and 13.1) shall apply to each area described in the Schedule to this Order as if in those provisions any reference to a parking place shall include a reference to the area designated as a parking place by this Order and as if any reference to the Schedule to the Order of 2012 included a reference to the Schedule to this Order.

Placing of traffic signs etc.

- 4.1 The council shall:-
- (a) place and maintain traffic signs indicating the limits of each parking place referred to in the Schedule to this Order;
 - (b) place and maintain in or in the vicinity of each parking place referred to in the Schedule to this Order traffic signs indicating that such a parking place may be used during the permitted hours for the leaving only of the vehicles specified in Article 4.1 of the Order of 2012; and
 - (c) carry out such other works as is reasonably required for the purposes of the satisfactory operation of the parking place.

Dated this xxxxxxxx day of xxxxxxxx 201*

[signature here]

NICKY COSTIN
Parking and Network Management Business Unit Manager
Regulatory Services

SCHEDULE - FREE BUS PARKING PLACES

<i>No. of parking place</i> (1)	<i>Designated parking place</i> (2)	<i>Permitted hours</i> (3)	<i>Maximum parking period</i> (4)	<i>Minimum return interval</i> (5)
**.	<p>VERNEY ROAD</p> <p>the north-west side of the main arm, from a point 27 metres north-east of its junction with the north-west to south-east arm of Verney Road north-eastward for a distance of 10 metres.</p>	<p>8 am to 10 am</p> <p>3 pm to 5 pm</p> <p>Monday to Friday</p>	-	-
**.	<p>VERNEY ROAD</p> <p>the north-west side of the main arm, from a point 98 metres north-east of its junction with the north-west to south-east arm of Verney Road north-eastward for a distance of 10 metres.</p>	<p>8 am to 10 am</p> <p>3 pm to 5 pm</p> <p>Monday to Friday</p>	-	-

EXPLANATORY NOTE

(This note is not part of the Order)

This Order introduces two free bus parking places for the services of John Keats Primary School in Verney Road, in the London Borough of Southwark.



THE COUNCIL OF THE LONDON BOROUGH OF SOUTHWARK

TRAFFIC MANAGEMENT ORDER

201* No. 0**

The London Borough of Southwark (Parking places) (Car club) (No. **) Order 201*

Made: 201*

Coming into force: 201*

The council of the London Borough of Southwark, after consulting the Commissioner of Police of the Metropolis, in exercise of the powers conferred by sections 6 and 124 to the Road Traffic Regulation Act 1984^a, as amended, and of all other powers thereunto enabling, hereby make the following Order:

Citation and commencement

- 1.1 This Order may be cited as the London Borough of Southwark (Parking places) (Car club) (No. **) Order 201* and shall come into force on 201*.

Interpretation

- 2.1 In this Order:-

“car club” means an organisation operating a car sharing scheme approved by the Council to operate within its boundaries and which supports the planning and sustainable transport policy objectives of the Council;

“car club permit” means a permit issued by the Council to a car club, under the provisions of Article 16.4 of the Order of 2011;

“council” means the council of the London Borough of Southwark;

“enactment” means any enactment, whether public general or local, and includes any order, byelaw, rule, regulation, scheme or other instrument having effect by virtue of an enactment;

“parking bay” means an area within a parking place that is indicated by road markings as being provided for the leaving of one vehicle only;

“parking place” means an area on a highway designated as a parking place by this Order; and

“the Order of 2011” means The London Borough of Southwark (Parking Places) (Car Club) (No. 1) Order 2011^b

^a 1984 c.27

^b LBS 2011/071

- 2.2 Any reference in this Order to any enactment shall be construed as a reference to that enactment as amended, applied, consolidated, re-enacted by or as having effect by virtue of any subsequent enactment.
- 2.3 Unless the context otherwise requires, any expression used in this Order which is also used in the Order of 2011 shall have the same meaning as in that Order.

Designation of parking places and application of the Order of 2011 thereto

- 3.1 Each area on a highway comprising the length of carriageway of a street specified in columns (2) and (3) of the Schedule to this Order and bounded on one side of that length by the edge of the carriageway, and having a width throughout of 2 metres, is designated as a parking place.
- 3.2 The provisions of the Order of 2011 (other than Articles 3 and 15) shall apply to each area designated as a parking place by this Order as if in those provisions any reference to a designated parking place or to a parking place shall include a reference to each area designated as a parking place by this Order and as if any reference to the Schedule to the Order of 2011 included a reference to the Schedule to this Order.

Placing of traffic signs etc.

- 4.1 The council shall:-
- (a) place and maintain traffic signs indicating the limits of each parking place referred to in the Schedule to this Order;
 - (b) place and maintain in or in the vicinity of each parking place referred to in the Schedule to this Order traffic signs indicating that such a parking place may be used during the permitted hours for the leaving only of the vehicles specified in Article 4.1 of the Order of 2011; and
 - (c) carry out such other works as is reasonably required for the purposes of the satisfactory operation of a parking place.

Dated this xxxxxxxx day of xxxxxxxx 201*

[signature here]

NICKY COSTIN
Parking and Network Management Business Unit Manager
Regulatory Services

SCHEDULE - CAR CLUB PARKING PLACES

Parking places (referred to in column 2 below) in which a vehicle may be left at any time provided the vehicle displays a valid car club permit bearing the parking place number specified in relation to that parking place in column 1 below.

<i>Parking place number (1)</i>	<i>Designated parking place (2)</i>	<i>Number of vehicles within a parking place (3)</i>	<i>Special manner of standing (4)</i>
S-**. .	<p>VERNEY ROAD</p> <p>the north-west side of the main arm, from a point 50 metres north-east of its junction with the north-west to south-east arm of Verney Road north-eastward for a distance of 5.6 metres.</p>	1	-

EXPLANATORY NOTE

(This note is not part of the Order)

This Order designates new car club parking place in Verney Road in the London Borough of Southwark.



THE COUNCIL OF THE LONDON BOROUGH OF SOUTHWARK

TRAFFIC MANAGEMENT ORDER

201* No. xxx

The London Borough of Southwark (Prescribed routes)
(Verney Road) (No. 2) Traffic Order 201*

Made: xx xxxxx 201*

Coming into force: xx xxxxx 201*

The council of the London Borough of Southwark, after consulting the Commissioner of Police of the Metropolis, in exercise of the powers conferred by sections 6 and 124 of the Road Traffic Regulation Act 1984^a, as amended, and of all other powers thereunto enabling, hereby make the following Order:

Citation and commencement

- 1.1 This Order may be cited as the London Borough of Southwark (Prescribed routes) (Verney Road) (No. 2) Traffic Order 2018 and shall come into force on xx xxxxx 201*.

Interpretation

- 2.1 In this Order:-

causing includes permitting;

"enactment" means any enactment, whether public general or local, and includes any order, bye-law, rule, regulation, scheme or other instrument having effect by virtue of an enactment;

"kerb-line" means the imaginary line which is the projection of the line formed by the edge of the carriageway of a street;

"pedal cycle" and "taxi" have the same meaning as in the Traffic Signs Regulations and General Directions 2002^b; and

"Verney Road mandatory contraflow cycle lane" means that area of Verney Road in the London Borough of Southwark specified in item 1 of the Schedule to this Order and which is bounded (a) on the south-east by the south-eastern edge of the carriageway, and (b) on the north-west by a traffic sign consisting of a longitudinal single white line and which area has marked thereon traffic signs of the size, type and colour shown in diagram 1057 of the Traffic Signs Regulations and General Directions 2002.

- 2.2 Any reference in this Order to any enactment shall be construed as a reference to that enactment as amended, applied, consolidated, re-enacted by or as having effect by virtue of any subsequent enactment.

^a 1984 c.27

^b SI 2002/3113

Prescribed routes

- 3.1 No person shall cause any vehicle to enter or proceed or wait in the Verney Road mandatory contraflow cycle lane, provided that nothing in this paragraph of this Article shall apply in relation to a pedal cycle entering the Verney Road mandatory contraflow cycle lane at a point 42.5 metres south-west of the south-westernmost wall of Nos. 6-8 Verney Road and proceeding in a south-westerly direction.
- 3.2 No person shall cause any vehicle to enter or proceed in that length of the north-east to south-west arm of Verney Road which lies between the junction of its north-west to south-east arm with its north-east to south-west arm and a point 19.5 metres north-east of that junction, in a direction other than from south-west to north-east. Provided that nothing in this paragraph of this Article shall apply to a pedal cycle proceeding in a south-westerly direction in the Verney Road mandatory contraflow cycle lane.

Exemptions

- 4.1 Nothing in Articles 3.1 and 3.2 above shall apply in relation to:-
- (a) anything done with the permission or at the direction of a police constable in uniform; or
 - (b) any vehicle being used for ambulance, fire brigade or police purposes in an emergency; or
 - (c) any person who causes any vehicle to proceed in accordance with any restriction or requirement indicated by traffic signs placed on the highway pursuant to section 66 or section 67 of the Road Traffic Regulation Act 1984.

Amendment of existing Orders

- 5.1 Without prejudice to the validity of anything done or to any liability incurred in respect of any act or omission before the coming into force of this Order, the London Borough of Southwark (Prescribed Routes) (Verney Road) (No. 1) Traffic Order 2007^c shall be revoked in its entirety.

Dated this xxxxxxxx day of xxxxxxxx 201*

[signature here]

NICKY COSTIN
Parking and Network Management Business Unit Manager
Regulatory Services

^c LBS 2007/079

EXPLANATORY NOTE

(This note is not part of the Order)

This Order amends the location of an existing designated one-way north-eastbound traffic working with a mandatory south-westbound contraflow cycle-lane in part of Verney Road, in the London Borough of Southwark. So as to accommodate new parking places for coaches.

DRAFT



THE COUNCIL OF THE LONDON BOROUGH OF SOUTHWARK

TRAFFIC MANAGEMENT ORDER

201* No. xxx

The London Borough of Southwark (Waiting and loading restrictions)
(Amendment No. *) Order 201*

Made: xx xxxxxxx 201*

Coming into force: xx xxxxxxx 201*

The council of the London Borough of Southwark, after consulting the Commissioner of Police of the Metropolis, in exercise of the powers conferred by sections 6 and 124 of the Road Traffic Regulation Act 1984^a, as amended, and of all other powers thereunto enabling, hereby make the following Order:

Citation and commencement

- 1.1 This Order may be cited as the London Borough of Southwark (Waiting and loading restrictions) (Amendment No. *) Order 201* and shall come into force on xx xxxxxxx 201*..

Interpretation

- 2.1 In this Order:-

"council" means the council of the London Borough of Southwark;

"enactment" means any enactment, whether public general or local, and includes any order, bye-law, rule, regulation, scheme or other instrument having effect by virtue of an enactment; and

"the Order of 2015" means the London Borough of Southwark (Waiting and loading restrictions) Consolidation Order 2015^b - as amended by the London Borough of Southwark (Waiting and loading restrictions) (Amendment No. 34) Order 2017^c.

^a 1984 c.27

^b LBS 2015/082

^c LBS 2017/072

- 2.2 Any reference in this Order to any enactment shall be construed as a reference to that enactment as amended, applied, consolidated, re-enacted by or as having effect by virtue of any subsequent enactment.
- 2.3 Unless the context otherwise requires, any expression used in this Order which is also used in the Order of 2015 shall have the same meaning as in that Order.

Amendment of the Order of 2015

- 3.1 Without prejudice to the validity of anything done, or to any liability incurred in respect of any act or omission before the coming into force of this Order, the Order of 2015 shall have effect as though for the items numbered 837, 1024 and 1025 in Schedule 1 to that Order there were substituted the items similarly numbered and set out in columns 1, 2 and 3 of Schedule 1 to this Order.

Dated this xxxxxxxx day of xxxxxxxx 201*

[signature here]

NICKY COSTIN
Parking and Network Management Business Unit Manager
Regulatory Services

SCHEDULE – WAITING RESTRICTIONS (SUBSTITUTION)

<i>Item No. (1)</i>	<i>Street (2)</i>	<i>Prescribed hours (3)</i>
837.	ROTHERHITHE NEW ROAD	
	(a) the north-west and north side	
	(i) between its junction with St James's Road and a point 27.5 metres south-west of a point opposite the south-western kerb-line of Verney Way;	At any time
	(ii) between a point 2 metres south-west of a point opposite the south-western kerb-line of Verney Way and a point 61.5 metres north-east of the north-eastern kerb-line of Catlin Street;	At any time
	(iii) between a point 6 metres north-east of the south-western wall of Nos. 128-150 Rembrandt Court, Stubbs Drive and a point 3.5 metres south-west of a point opposite the south-western kerb-line of Ilderton Road;	8 am to 6.30 pm Monday to Saturday
	(iv) between a point 3.5 metres south-west of a point opposite the south-western kerb-line of Ilderton Road and a point 5 metres north-east of the north-eastern kerb-line of the vehicular access to Rotherhithe Business Estate, No. 216 Rotherhithe New Road;	At any time
	(v) between a point 5 metres north-east of the north-eastern kerb-line of the vehicular access to Rotherhithe Business Estate, No. 216 Rotherhithe New Road and the south-western wall of No. 212 Rotherhithe New Road;	8 am to 6.30 pm Monday to Saturday
	(vi) between the south-western wall of No. 212 Rotherhithe New Road and a point 3 metres east of a point opposite the western kerb-line of Warndon Street;	At any time
	(vii) between a point 3 metres east of a point opposite the western kerb-line of Warndon Street and a point 28.5 metres west of the western kerb-line of Rotherhithe Old Road;	8 am to 6.30 pm Monday to Saturday
	(viii) between a point 28.5 metres west of the western kerb-line of Rotherhithe Old Road and the south-western kerb-line of Lower Road;	At any time
	(b) the south-east and south side	
	(i) between its junction with St James's Road and a point 15 metres north-east of a point opposite the north-eastern kerb-line of Catlin Street;	At any time
	(ii) between a point 5.5 metres south-west of a point opposite the south-western wall of Nos. 128-150 Rembrandt Court, Stubbs Drive and the south-western kerb-line of the vehicular access to Units 1-9 Bermondsey Trading Estate, Rotherhithe New Road;	8 am to 6.30 pm Monday to Saturday

SCHEDULE – WAITING RESTRICTIONS (SUBSTITUTION)

<i>Item No. (1)</i>	<i>Street (2)</i>	<i>Prescribed hours (3)</i>
	(iii) between the north-eastern kerb-line of the vehicular access to Units 1-9 Bermondsey Trading Estate, Rotherhithe New Road and a point 42 metres east of the eastern kerb-line of Warndon Street;	At any time
	(iv) between a point 42 metres east of the eastern kerb-line of Warndon Street and the western kerb-line of Oldfield Grove	8 am to 6.30 pm Monday to Saturday
	(v) between the eastern kerb-line of Oldfield Grove and a point 23 metres west of the western wall of No. 198 Lower Road;	At any time
	(vi) between a point 23 metres west of the western wall of No. 198 Lower Road and a point 2.5 metres east of that wall;	8 am to 6.30 pm Monday to Saturday
	(vii) between a point 2.5 metres east of the western wall of No. 198 Lower Road and the south-western kerb-line of Lower Road;	At any time
	(c) all sides of the triangular island site located at its junction with Lower Road;	At any time
	(d) all sides of the roundabout island site located at its junctions with Abbeyfield Road and Hawkstone Road.	At any time
1024.	VERNEY ROAD	
	1. the north-west to south-east arm, on both sides between the south-eastern kerb-line of St James's Road and its south-eastern extremity;	At any time
	2. the main arm (which extends between its junction with the north-west to south-east arm of Verney Road in the West and its junction with Ilderton Road in the East);	
	(a) the north and north-western sides	
	(i) from its junction with the north-west to south-east arm of Verney Road and a point 27 metres north-east of that junction;	At any time
	(ii) from a point 43 metres north-east of its junction with the north-west to south-east arm of Verney Road and a point 50 metres north-east of that junction;	At any time
	(iii) from a point 55.6 metres north-east of its junction with the north-west to south-east arm of Verney Road and a point 98 metres north-east of that junction;	At any time

SCHEDULE – WAITING RESTRICTIONS (SUBSTITUTION)

<i>Item No. (1)</i>	<i>Street (2)</i>	<i>Prescribed hours (3)</i>
	(iv) between a point 108 metres north-east of its junction with the north-west to south-east arm of Verney Road and a point 52.5 metres east of the north-eastern kerb-line of Verney Way;	At any time
	(v) between a point 32 metres east of a point opposite the common boundary of Nos. 32 and 34-36 Verney Road and a point 9 metres east of a point opposite the eastern wall of Nos. 38-40 Verney Road;	At any time
	(vi) between a point 4.5 metres west of a point opposite the eastern wall of Nos. 52-56 Verney Road and a point 12 metres west of a point opposite the western wall of No. 70 Verney Road;	At any time
	(vii) between a point 19.5 metres west of the western kerb-line build-out of Credon Road and a point 18.5 metres east of the eastern kerb-line build-out of Credon Road;	At any time
	(viii) between the western kerb-line of Ilderton Road and a point 32.5 metres west of that kerb-line;	At any time
(b)	the south and south-eastern sides	
	(i) from its junction with the north-west to south-east arm of Verney Road and a point 12 metres east of the eastern kerb-line of the vehicular access to No. 16 Verney Road;	At any time
	(ii) between a point 25.5 metres east of the eastern kerb-line of the vehicular access to No. 16 Verney Road and a point 59 metres east of the eastern kerb-line of the vehicular access to No. 16 Verney Road;	At any time
	(iii) between a point 56 metres west of the common boundary of Nos. 24-26 and 28 Verney Road and a point 31.5 metres east of the common boundary of Nos. 24-26 and 28 Verney Road;	At any time
	(iv) between a point 3 metres east of the eastern wall of No. 30 Verney Road and a point 2 metres west of the western wall of No. 32 Verney Road;	At any time
	(v) between a point 6.5 metres east of the common boundary of Nos. 32 and 34-36 Verney Road and a point 31.5 metres west of the western kerb-line build-out of Credon Road;	At any time
	(vi) between a point 15 metres west of the western kerb-line build-out of Credon Road and a point 18.5 metres east of the eastern kerb-line build-out of Credon Road;	At any time

SCHEDULE – WAITING RESTRICTIONS (SUBSTITUTION)

<i>Item No. (1)</i>	<i>Street (2)</i>	<i>Prescribed hours (3)</i>
	(vii) between the western kerb-line of Ilderton Road and the eastern kerb-line of Varcoe Road.	At any time
1025.	VERNEY WAY	
	(a) the north-east side	
	(i) between the south-eastern kerb-line of Rotherhithe New Road and a point 19 metres south-east of that kerb-line;	At any time
	(ii) between the northern kerb-line of Verney Road and a point 13 metres north-west of that kerb-line;	At any time
	(b) the south-west side.	At any time

EXPLANATORY NOTE

(This note is not part of the Order)

This Order introduces new or extends existing lengths of 'at any time' waiting restrictions in Rotherhithe New Road, Verney Road, and Verney Way, in the London Borough of Southwark.