

The authority must publish a notice in a local newspaper and in the vicinity of the affected area notifying the public of the works

**DIVERSION A:**  
Druid Street, Tower Bridge Road

**SP1**  
Tanner Street  
CLOSED  
No Through Route  
Follow  
Diversion

**STOP & GO BOARDS TO BE USED TO ASSIST ACCESS AND EGRESS OF SITE TRAFFIC OR WHEN WORKS DICTATE**

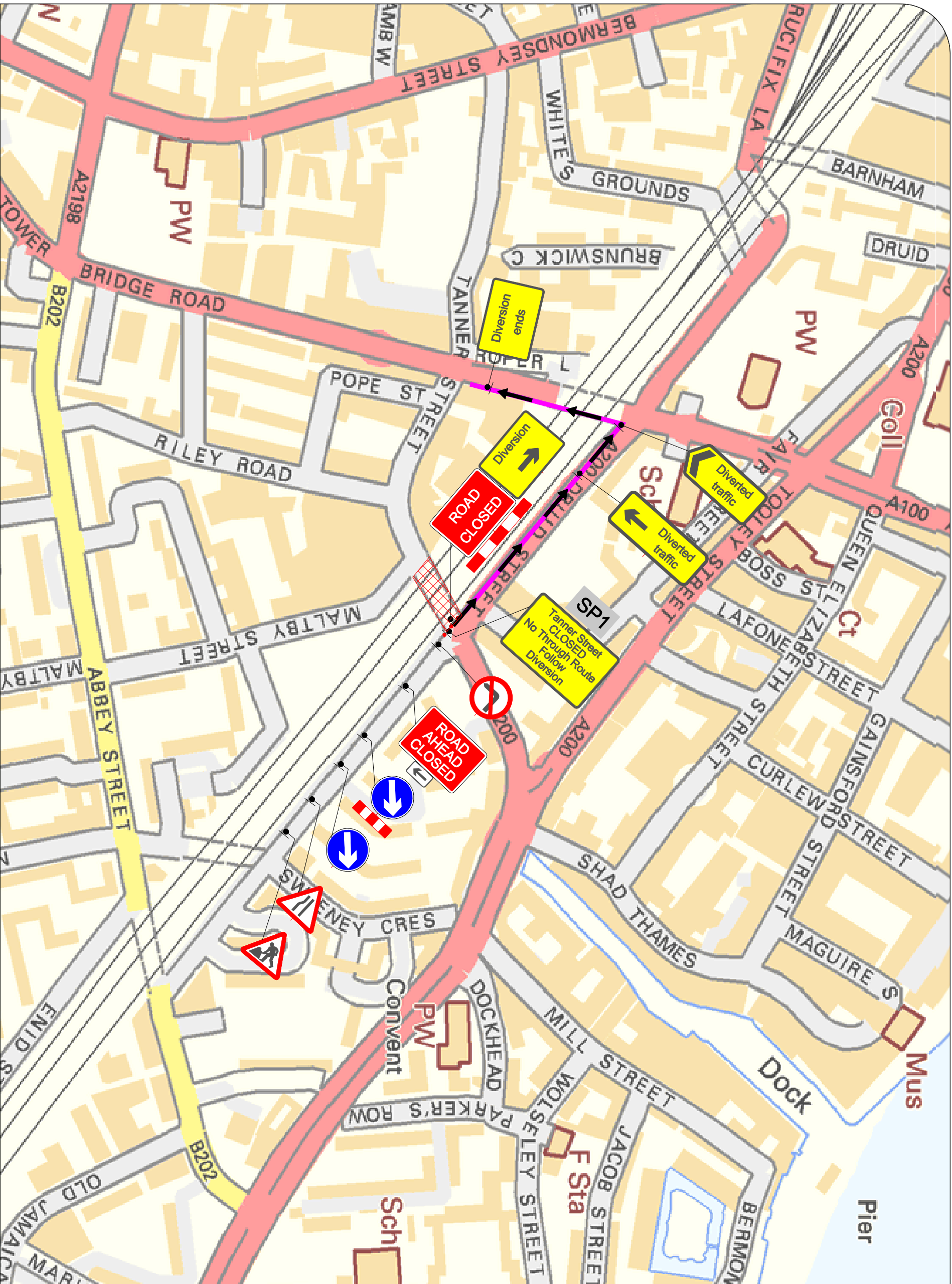
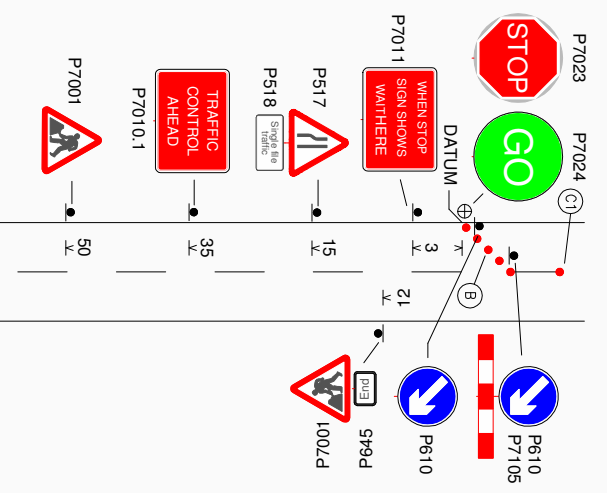

CLIENT

ADDRESS

TANNER STREET

PROJECT

TERM MAINTENANCE

KEY

PEDESTRIAN BARRIER

DIVERSION A

TRAFFIC CONE

SAFETY ZONE

WORKS AREA

TAPER

DRAWING

FMC/2251/PM/01

DATE

09/04/2018

REVISION

APPROVED

JW

CHECKED

PM

NOTES

1. All dimensions are in metres unless otherwise stated.
2. All traffic management to comply with Chapter 8 Safety at Street Works and Roadworks (A code of practice)
3. All road markings and signs to be as per the Traffic Signs Regulations and General Directions 2016.
4. The traffic management illustrated above shall only be used and implemented with approval from the relevant highway authority or similar authorising body.
5. This Drawing is not to be reproduced, copied or distributed without permission from Fm Conway Traffic Management Department.
6. © Crown copyright and database right 2016 OS Licence 100055409

