

Public notice

North and West Bermondsey improvements

*The London Borough of Southwark (Parking places) (CPZ 'F') (No. *) Order 201**

*The London Borough of Southwark (Parking places) (CPZ 'G') (No. *) Order 201**

*The London Borough of Southwark (Waiting and loading restrictions) (Amendment No. *) Order 201**

1. Southwark Council hereby GIVES NOTICE that it proposes to make the above orders under the powers of the Road Traffic Regulation Act 1984¹, as amended.
2. The effect of the orders would be:-
 - (a) in DRUMMOND ROAD, on the south-west side (i) to split an existing permit holders' parking place within CPZ 'G' (a reduction of 12.5 metres of permit holders' parking); and (ii) to introduce double yellow line 'at any time' waiting restrictions to accommodate the introduction of a new vehicular crossover providing access to the 'Biscuit Factory' development opposite the southwestern wall of New Place Estate, Marden Square;
 - (b) in WESTON STREET, on the east side (i) to relocate an existing permit holders' parking place within CPZ 'F' northward by 5 metres; and (ii) to amend existing double yellow line 'at any time' waiting restrictions, to accommodate the introduction of a new vehicular crossover providing access to the residential building development on Nos. 175-179 Long Lane.
3. For more information about these proposals please contact Ioannis Lampropoulos of the council's Highways – Network Development team by telephone on 020 7525 4566 or by e-mail: Highways@southwark.gov.uk
4. Copies of this notice, the proposed orders, a statement of the council's reasons for making the orders and a plan of the proposals may be found online at www.southwark.gov.uk/trafficorders or by scanning the QR code below, paper copies may be obtained from or viewed at Highways, Environment and Leisure, 3rd floor hub 2, 160 Tooley Street, London SE1 2QH. Please call 020 7525 3497 for details.
5. Anyone wishing to object to or make any other representations regarding the proposal, may use the form labelled '*Parking - Road traffic and highway schemes - responding to statutory consultation notices*' at www.southwark.gov.uk/statutoryconsultationnotices or send a statement in writing to: Traffic Order consultations, Highways, Southwark Council, Environment and Leisure, P.O. Box 64529, London SE1P 5LX or by e-mail to traffic.orders@southwark.gov.uk quoting reference '*TMO1819-017 Bermondsey improvements*' by 27 September 2018. Please note that if you wish to object to this proposal you must state the grounds on which your objection is made.
6. When making an objection or representation, please be aware that this may be communicated to other people who may be affected. Information provided in response to this consultation, including in some circumstances personal information, may also be subject to publication or disclosure under the requirements of current access to information legislation.

Dated 6 September 2018

Nicky Costin

Parking and Network Management Business Unit Manager, Regulatory Services



¹ 1984 c.27

Statement of reasons

North and West Bermondsey improvements

*The London Borough of Southwark (Parking places) (CPZ 'F') (No. *) Order 201**

*The London Borough of Southwark (Parking places) (CPZ 'G') (No. *) Order 201**

*The London Borough of Southwark (Waiting and loading restrictions) (Amendment No. *) Order 201**

DRUMMOND ROAD in North Bermondsey ward

The proposal relates to The Biscuit Factory redevelopment which was given planning permission (15/AP/3729) on 22nd March 2016 and allows for the demolition of the existing and the erection of a new building plus associated highway works, vehicle access, cycle parking and landscaping including all related ancillary facilities. The proposal includes provision for a new vehicle access and to accommodate that there is a need for 12.5 metres of permit holders' parking to be revoked.

WESTON STREET in London Bridge & West Bermondsey ward

The proposal relates to the redevelopment of Nos. 175 - 179 Long Lane, given planning permission (15/AP/4072) in August 2017, which allows a redevelopment of the site to provide a mixed-use group of buildings comprising of commercial and residential units.

This planning includes the provision of a vehicular crossover on Weston Street for vehicular access to the new development.

Dated 6 September 2018

For more information contact:-

Ioannis Lampropoulos

Engineer

Highways – Network Development

020 7525 4566

Highways@southwark.gov.uk

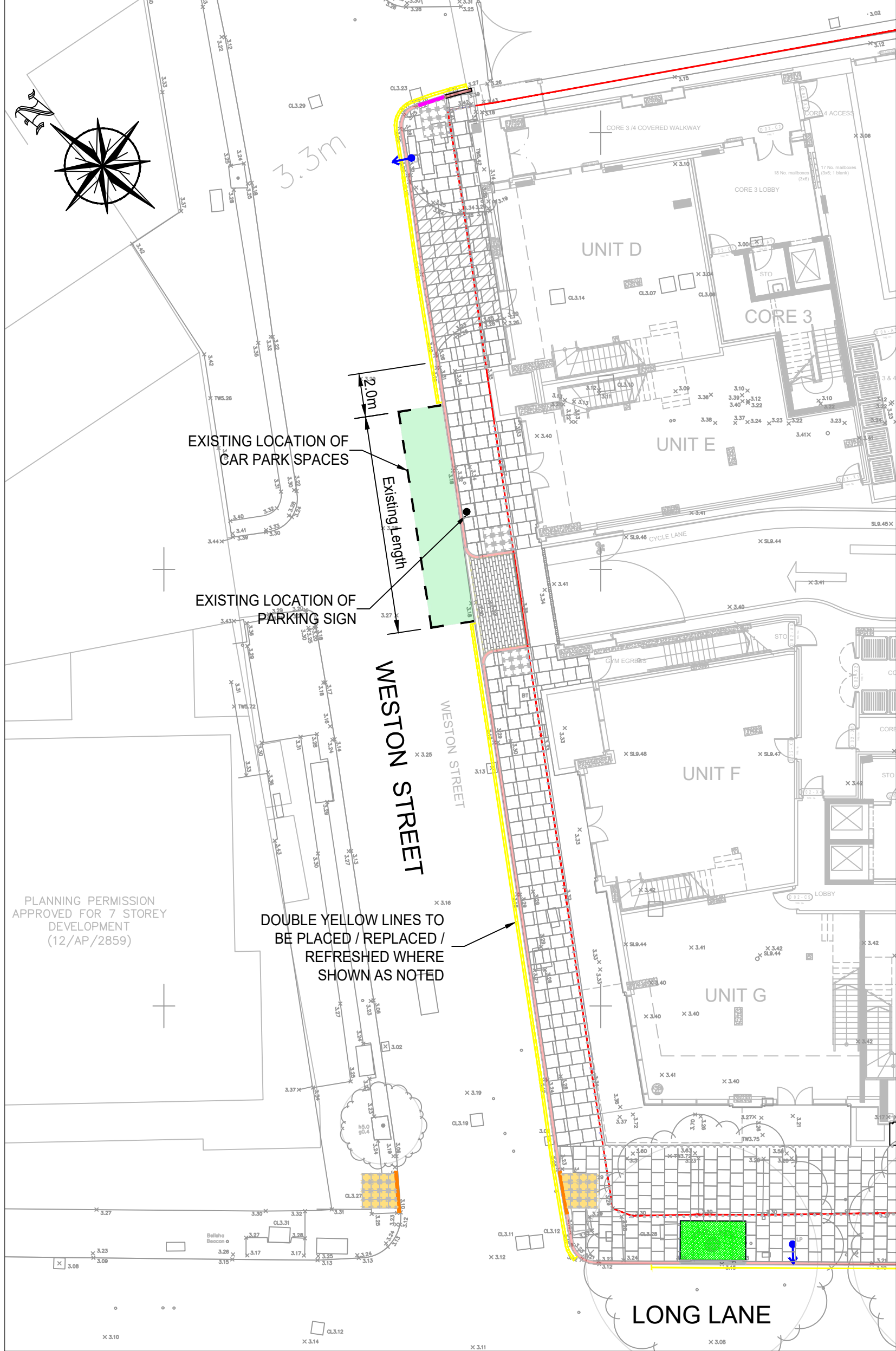

EXISTING PARKING LAYOUT
SCALE 1:200

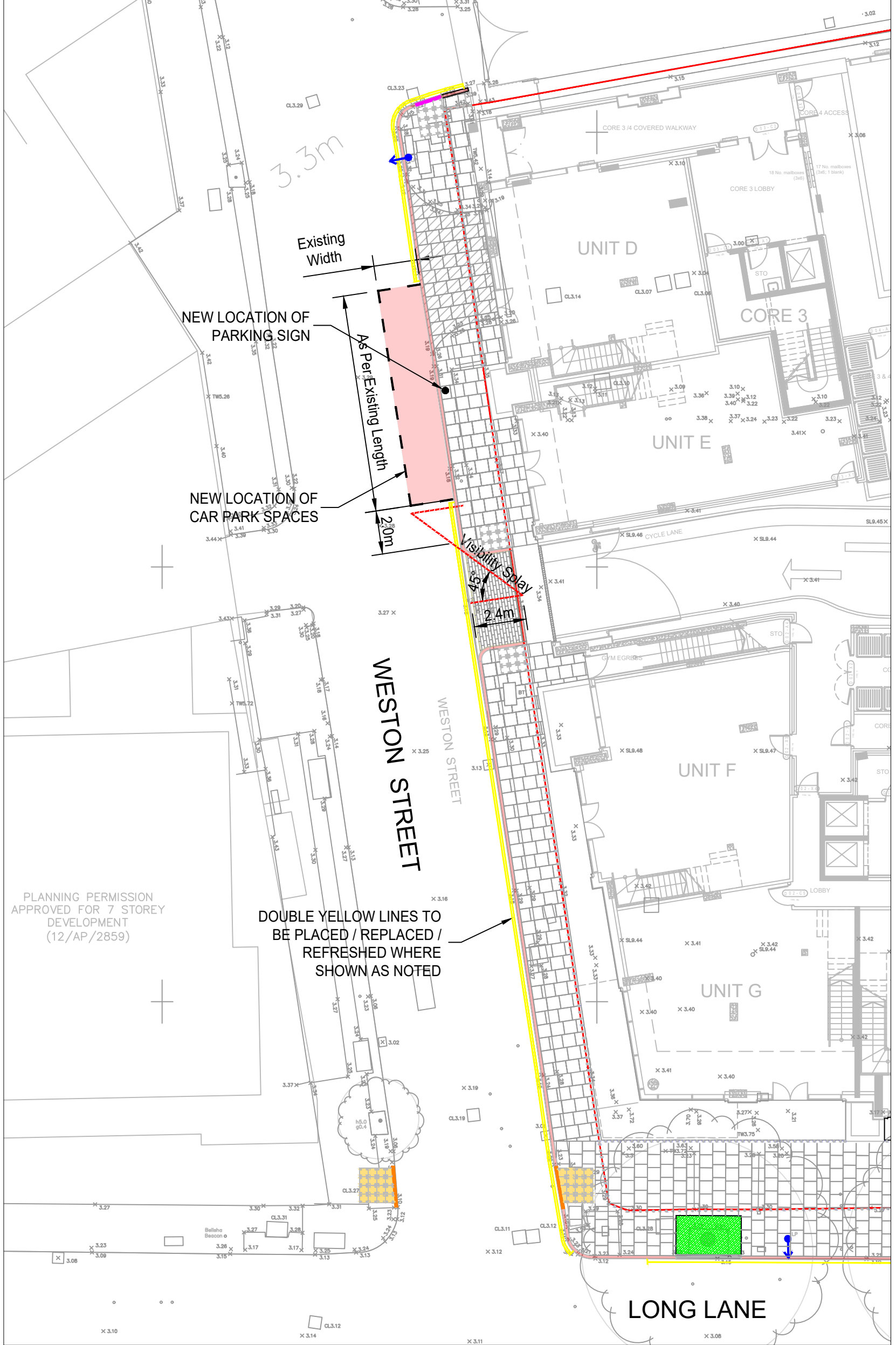

NEW PARKING LAYOUT
SCALE 1:200

LEGEND

- BASIC PRECAST CONCRETE BLOCKS WITH FACE DIVISION (200x100x80). MID GREY. TO BS EN 1338:2003
- BRITISH STANDARD PRECAST CONCRETE PAVING FLAGS, PIMPLE FINISH (600x600x63/65). GREY. TO BS EN 1339:2003
- BLISTER TACTILE PRECAST CONCRETE PAVING FLAGS. DARK GREY. TO BS EN 1339:2003
- PARKING SIGN
- SITE BOUNDARY

NOTE: ROAD MARKINGS TO TSRGD TRAFFIC SIGNS MANUAL

NOTES

- For setting out refer to Architect's drawings.
- This drawing to be read in conjunction with all other Architectural and Engineering drawings and all other relevant drawings and Specifications.
- DO NOT SCALE THIS DRAWING. Use figured dimensions only.
- No part of this document may be reproduced or transmitted in any form or stored in any retrieval system of any nature without the written permission as copyright holder except as agreed for use on the project for which the document was originally issued.

Rev. No.	Date	REVISION NOTE	Drn. By	Chkd. By

Client	Peveril Securities (Long Lane) Ltd.			
Project	Residential Development, 175-179 Long Lane, London SE1 4PN			
Title	SECTION 278 AGREEMENT PARKING LAYOUT			
Drn. by	Chkd. by	Aprvd. by	Dwg. No.	Revision
G.S.	L.G.	R.T.	T002U-308	
Date	Scale	1:200 @ A2		
DEC 2016				

CS Consulting Engineers
Centralpoint, 45 Beech Street, London, EC2Y 8AD
E: info@csoconsultinguk.com
W: www.csoconsultinguk.com
T: +44 (0) 207 070 3660

Quality I.S. EN ISO 9001:2008
Environment I.S. EN ISO 14001:2004
Energy I.S. EN ISO 50001:2011
Health & Safety OHSAS 18001:2007



Notes

1. Refer to Diag. No. BF-ARP-P5-XX-DR-C-1000 for general notes.
2. Figures marked * have been agreed between McLaren and London Borough of Southwark (LBS). Based on email correspondence from LBS to McLaren dated 27.06.18. Arup understands that junction visibility and swept path analysis have been assessed by LBS and deemed to be acceptable.
3. Drawing not to scale.

Legend

Planning application boundary

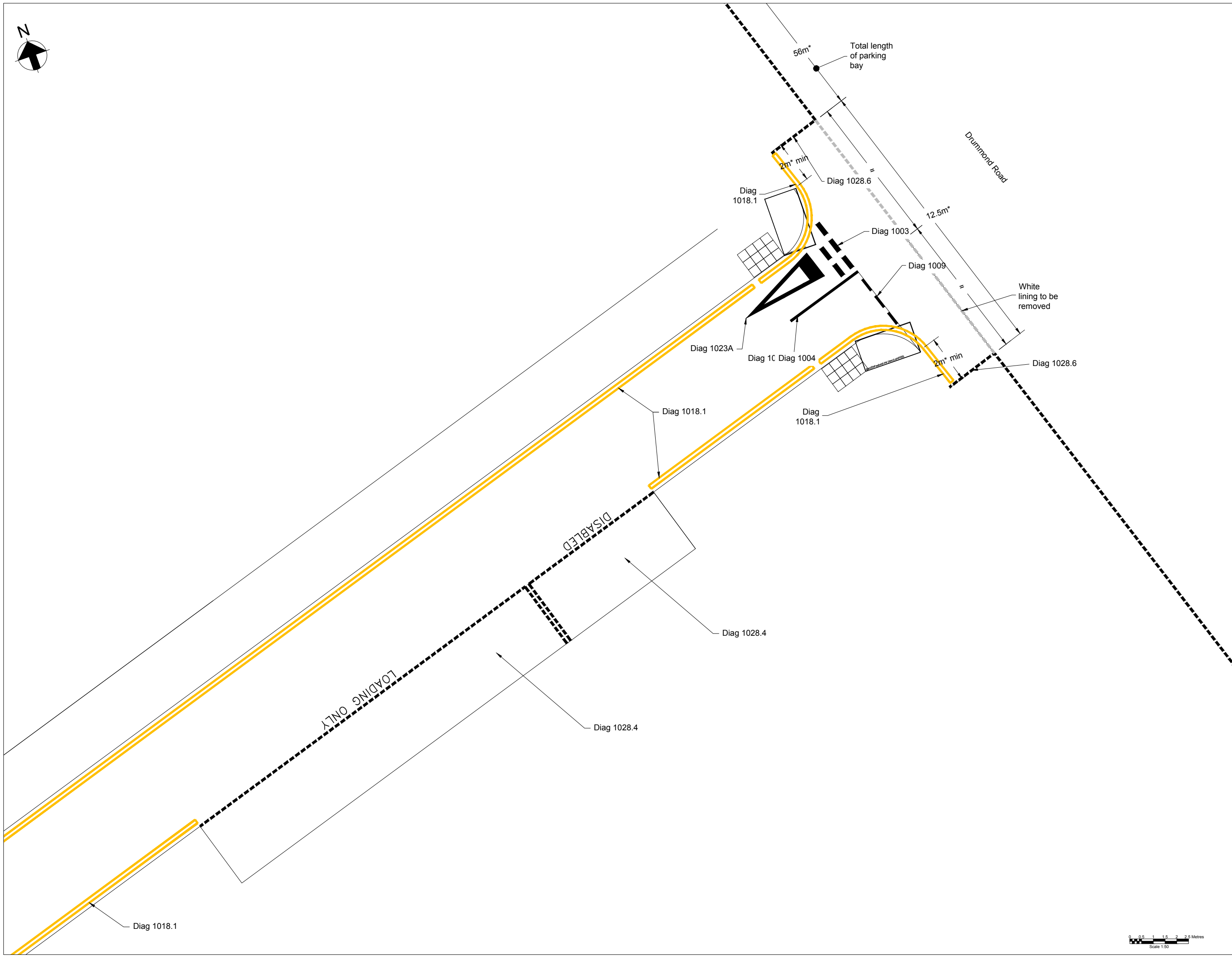

Issue	Date	By	Check	Appd

ARUP

13 Finsbury Street
London EC2A 3DU
Tel +44(0)20 7556 1531 Fax +44(0)20 7556 3024
www.arup.com

Client
Grosvenor Britain & Ireland
70 Grosvenor St.
London W1K 3JP
Client Line 4

Job Title
Biscuit Factory Plot 5
Clements Road, London SE19 4DG

North Road
Signs and linemarking

Scale at A0 1:50

Discipline Civil

Job No 240389 Drawing Status As Designed

Drawing No BF-ARP-P5-XX-DR-C-7410 Issue AD



THE COUNCIL OF THE LONDON BOROUGH OF SOUTHWARK

TRAFFIC MANAGEMENT ORDER

201* No. xxx

The London Borough of Southwark (Parking places) (CPZ 'F') (No. *) Order 201*

Made: xx xxxxxx 201*

Coming into force: xx xxxxxx 201*

The council of the London Borough of Southwark, after consulting the Commissioner of Police of the Metropolis, in exercise of the powers conferred by sections 45, 46, 49 and 124 of and Part IV of Schedule 9 to the Road Traffic Regulation Act 1984^a, as amended, and of all other powers thereunto enabling, hereby make the following Order:

Citation and commencement

- 1.1 This Order may be cited as the London Borough of Southwark (Parking places) (No. *) Order 201* and shall come into force on xx xxxxxx 201*.

Interpretation

- 2.1 In this Order:

“council” means the council of the London Borough of Southwark;

“enactment” means any enactment, whether public general or local, and includes any order, bye-law, rule, regulation, scheme or other instrument having effect by virtue of an enactment; and

“the Order of 2011” means The London Borough of Southwark (Parking places) (CPZ 'F') (No. 1) Order 2011^b.

- 2.2 Any reference in this Order to any enactment shall be construed as a reference to that enactment as amended, applied, consolidated, re-enacted by or as having effect by virtue of any subsequent enactment.
- 2.3 Unless the context otherwise requires, any expression used in this Order which is also used in the Order of 2011 shall have the same meaning as in that Order.

^a 1984 c.27

^b LBS 2011/052

Revocation

- 3.1 Without prejudice to the validity of anything done, or to any liability incurred in respect of any act or omission before the coming into force of this Order the designation by the Order of 2011 of the parking places numbered 57 therein, is hereby revoked.

Designation of parking places and application of the Order of 2011 thereto

- 4.1 Each area on a highway comprising the length of carriageway of a street specified in column 2 of a Schedule to this Order and bounded on one side of that length by the edge of the carriageway, is designated as a parking place.
- 4.2 The provisions of the Order of 2011 (other than Articles 3 and 15) shall apply to the areas described in each Schedule to this Order as if in those provisions any reference to a designated parking place or to a parking place shall include a reference to an area designated as a parking place by this Order and as if any reference to Schedule 1 to the Order of 2011 included a reference to Schedule 1 to this Order.

Placing of traffic signs, etc.

- 5.1 The council shall:-
- (a) place and maintain traffic signs indicating the limits of each parking place referred to in Schedule 1 or 2 to this Order;
 - (b) place and maintain in or in the vicinity of each parking place referred to in the Schedule 1 or 2 to this Order traffic signs indicating that such parking places may be used during the permitted hours for the leaving only of the vehicles specified in Articles 4.1 and 4.3 or 4.4, as the case may be, of the Order of 2011;
 - (c) carry out such other works as is reasonably required for the purposes of the satisfactory operation of a parking place.

Dated this xxxxxx day of xxxxxxxxxxxx 201*



NICKY COSTIN
Parking and Network Management Business Unit Manager
Regulatory Services

SCHEDULE – PERMIT HOLDERS' PARKING PLACES

<i>No. of parking place (1)</i>	<i>Designated parking place (2)</i>	<i>Permitted hours (3)</i>
**.	<p>WESTON STREET the east side, from a point 31 metres north of the north-eastern kerb-line of Long Lane northward for a distance of 13 metres.</p>	<p>8.00am to 6.30pm Monday - Saturday</p>

DRAFT

EXPLANATORY NOTE

(This note is not part of the Order)

This order revokes and re-enacts the designation of an existing permit holders' parking place in Weston Street, in the London Borough of Southwark. So as to accommodate the access route to the residential development on Long Lane.

DRAFT



THE COUNCIL OF THE LONDON BOROUGH OF SOUTHWARK

TRAFFIC MANAGEMENT ORDER

201* No. xxx

The London Borough of Southwark (Parking places) (CPZ 'G') (No. *) Order 201*

Made: xx xxxxxx 201*

Coming into force: xx xxxxxx 201*

The council of the London Borough of Southwark, after consulting the Commissioner of Police of the Metropolis, in exercise of the powers conferred by sections 45, 46, 49 and 124 of and Part IV of Schedule 9 to the Road Traffic Regulation Act 1984^a, as amended, and of all other powers thereunto enabling, hereby make the following Order:

Citation and commencement

- 1.1 This Order may be cited as the London Borough of Southwark (Parking Places) (CPZ 'G') (No. *) Order 201* and shall come into force on xx xxxxxx 201*.

Interpretation

- 2.1 In this Order:-

“council” means the council of the London Borough of Southwark;

“enactment” means any enactment, whether public general or local, and includes any order, bye-law, rule, regulation, scheme or other instrument having effect by virtue of an enactment; and

“the Order of 2011” means The London Borough of Southwark (Parking Places) (CPZ 'G') (No. 1) Order 2011^b.

- 2.2 Any reference in this Order to any enactment shall be construed as a reference to that enactment as amended, applied, consolidated, re-enacted by or as having effect by virtue of any subsequent enactment.
- 2.3 Unless the context otherwise requires, any expression used in this Order which is also used in the Order of 2011 shall have the same meaning as in that Order.

Revocation

- 3.1 Without prejudice to the validity of anything done or to any liability incurred in respect of any act or omission before the coming into force of this Order, the designation by the London Borough of Southwark (Parking Places) (CPZ 'G') (No. 8) Order 2014^c. of the parking place numbered 248 in Schedule 1 therein, is hereby revoked.

^a 1984 c.27

^b LBS 2011/041

^c LBS 2014/004

Designation of parking places and application of the Order of 2011 thereto

- 4.1 Each area on a highway comprising the length of carriageway of a street specified in column 2 of a Schedule to this Order and bounded on one side of that length by the edge of the carriageway, and having a width throughout of 2 metres, is designated as a parking place.
- 4.2 The provisions of the Order of 2011 (other than Articles 3 and 15) shall apply to each area designated as a parking place by this Order as if in those provisions any reference to a designated parking place or to a parking place shall include a reference to the area designated as a parking place by this Order and as if any reference to Schedule 1 to the Order of 2011 included a reference to the Schedule to this Order.

Placing of traffic signs etc.

- 5.1 The council shall:-
- (a) place and maintain traffic signs indicating the limits of each parking place referred to in the Schedule to this Order;
 - (b) place and maintain in or in the vicinity of each parking place referred to in the Schedule to this Order traffic signs indicating that such a parking place may be used during the permitted hours for the leaving only of the vehicles specified in Articles 4.1 and 4.2 of the Order of 2011; and
 - (c) carry out such other works as is reasonably required for the purposes of the satisfactory operation of a parking place.

Dated this xxx day of xxxx 201*

[signature here]

NICKY COSTIN
Parking and Network Management Business Unit Manager
Regulatory Services

SCHEDULE - PERMIT HOLDERS' PARKING PLACES

<i>No. of parking place (1)</i>	<i>Designated parking place (2)</i>	<i>Permitted hours (3)</i>
***.	<p>DRUMMOND ROAD</p> <p>the south-west side, from a point 4.5 metres south-east of the south-eastern kerb-line of Clement's Road south-eastward for a distance of 56 metres.</p>	<p>8.30 am to 6.30 pm</p> <p>Monday to Friday</p>
***.	<p>DRUMMOND ROAD</p> <p>the south-west side, from a point 73 metres south-east of the south-eastern kerb-line of Clement's Road south-eastward for a distance of 119 metres.</p>	<p>8.30 am to 6.30 pm</p> <p>Monday to Friday</p>

EXPLANATORY NOTE

(This note is not part of the Order)

This Order splits an existing permit holders' parking place in Drummond Road in the London Borough of Southwark.



THE COUNCIL OF THE LONDON BOROUGH OF SOUTHWARK

TRAFFIC MANAGEMENT ORDER

201* No. xxx

The London Borough of Southwark (Waiting and loading restrictions)
(Amendment No. xx) Order 201*

Made: xx xxxxxx 201*

Coming into force: xx xxxxxx 201*

The council of the London Borough of Southwark, after consulting the Commissioner of Police of the Metropolis, in exercise of the powers conferred by sections 6 and 124 of the Road Traffic Regulation Act 1984^a, as amended, and of all other powers thereunto enabling, hereby make the following Order:

Citation and commencement

- 1.1 This Order may be cited as the London Borough of Southwark (Waiting and loading restrictions) (Amendment No. xx) Order 201* and shall come into force on xx xxxxxx 201*.

Interpretation

- 2.1 In this Order:-

"council" means the council of the London Borough of Southwark;

"enactment" means any enactment, whether public general or local, and includes any order, bye-law, rule, regulation, scheme or other instrument having effect by virtue of an enactment; and

"the Order of 2015" means the London Borough of Southwark (Waiting and loading restrictions) Consolidation Order 2015^b - as amended by the London Borough of Southwark (Waiting and loading restrictions) (Amendment No. 34) Order 2017^c, and the London Borough of Southwark (Waiting and loading restrictions) (Amendment No. 45) Order 2018^d.

^a 1984 c.27

^b LBS 2015/082

^c LBS 2017/072

^d LBS 2018/130

- 2.2 Any reference in this Order to any enactment shall be construed as a reference to that enactment as amended, applied, consolidated, re-enacted by or as having effect by virtue of any subsequent enactment.
- 2.3 Unless the context otherwise requires, any expression used in this Order which is also used in the Order of 2015 shall have the same meaning as in that Order.

Amendment of the Order of 2015

- 3.1 Without prejudice to the validity of anything done, or to any liability incurred in respect of any act or omission before the coming into force of this Order, the Order of 2015 shall have effect as though for the items numbered 315 and 1058 in Schedule 1 to that Order there were substituted the items similarly numbered and set out in columns 1, 2 and 3 of the Schedule to this Order.

Dated this xxx day of xxxxxx 201*

[signature here]

NICKY COSTIN
Parking and Network Management Business Unit Manager
Regulatory Services

SCHEDULE – WAITING RESTRICTIONS (SUBSTITUTION)

<i>Item No. (1)</i>	<i>Street (2)</i>	<i>Prescribed hours (3)</i>
315.	DRUMMOND ROAD	
	(a) the north-east side	
	(i) between a point 7 metres south-east of the south-eastern kerb-line of Perryn Road and a point 0.5 metres north-west of the south-eastern kerb-line of Tranton Road;	8.30 am to 6.30 pm Monday to Friday
	(ii) between a point 0.5 metres north-west of the south-eastern kerb-line of Tranton Road and a point 5 metres south-east of that kerb-line;	At any time
	(iii) between a point 5 metres south-east of the south-eastern kerb-line of Tranton Road and a point 10 metres north-west of the north-western kerb-line of Clement's Road;	8.30 am to 6.30 pm Monday to Friday
	(iv) between a point 10 metres north-west of the north-western kerb-line of Clement's Road and a point 20 metres south-east of the south-eastern kerb-line of Clement's Road;	At any time
	(v) between a point 20 metres south-east of the south-eastern kerb-line of Clement's Road and a point 17 metres north-west of the north-western kerb-line of Southwark Park Road;	8.30 am to 6.30 pm Monday to Friday
	(vi) between a point 17 metres north-west of the north-western kerb-line of Southwark Park Road and that kerb-line;	At any time
	(b) the south-west side	
	(i) between the south-eastern kerb-line of Perryn Road and a point 7.5 metres south-east of that kerb-line;	At any time
	(ii) between a point 7.5 metres south-east of the south-eastern kerb-line of Perryn Road and a point 7 metres north-west of the north-western kerb-line of Tranton Road;	8.30 am to 6.30 pm Monday to Friday
	(iii) between a point 7 metres north-west of the north-western kerb-line of Tranton Road and a point 10 metres south-east of the south-eastern kerb-line of Tranton Road;	At any time
	(iv) between and a point 10 metres south-east of the south-eastern kerb-line of Tranton Road and a point 9.5 metres north-west of the north-western kerb-line of Clement's Road;	8.30 am to 6.30 pm Monday to Friday
	(v) between a point 9.5 metres north-west of the north-western kerb-line of Clement's Road and a point 4.5 metres south-east of the south-eastern kerb-line of Clement's Road;	At any time

SCHEDULE – WAITING RESTRICTIONS (SUBSTITUTION)

<i>Item No. (1)</i>	<i>Street (2)</i>	<i>Prescribed hours (3)</i>
	(vi) between a point 4.5 metres south-east of the south-eastern kerb-line of Clement's Road and a point 56 metres south-east of that kerb-line;	8.30 am to 6.30 pm Monday to Friday
	(vii) between a point 56 metres south-east of the south-eastern kerb-line of Clement's Road and a point 68.5 metres south-east of that kerb-line;	At any time
	(viii) between a point 68.5 metres south-east of the south-eastern kerb-line of Clement's Road and a point 20 metres north-west of the north-western kerb-line of Southwark Park Road;	8.30 am to 6.30 pm Monday to Friday
	(ix) between a point 20 metres north-west of the north-western kerb-line of Southwark Park Road and that kerb-line.	At any time
1058.	WESTON STREET	
	(a) the east, north-east and south-east side	
	(i) between a point 6 metres south of the south-western kerb-line of Tooley Street and a point 3 metres north of the north-eastern kerb-line of St Thomas Street;	At any time
	(ii) between a point 5 metres south of the south-western kerb-line of St Thomas Street and a point 9 metres south of the common boundary of Nos. 62 and 64 Weston Street;	8 am to 6.30 pm Monday to Saturday
	(iii) between a point 9 metres south of the common boundary of Nos. 62 and 64 Weston Street and a point 21 metres south of the southern kerb-line of Snowfields;	At any time
	(iv) between a point 21 metres south of the southern kerb-line of Snowfields and a point 16 metres north-west of the south-eastern wall of Bridgewalk Heights, No. 80 Weston Street;	8 am to 6.30 pm Monday to Saturday
	(v) between a point 16 metres north-west of the south-eastern wall of Bridgewalk Heights, No. 80 Weston Street and a point 10 metres south-west of the south-western kerb-line of the northern vehicular access to The Leathermarket, Weston Street;	At any time
	(vi) between a point 10 metres south-west of the south-western kerb-line of the northern vehicular access to The Leathermarket, Weston Street and a point 31 metres north of the north-eastern kerb-line of Long Lane;	8 am to 6.30 pm Monday to Saturday
	(vii) between the north-eastern kerb-line of Long Lane and a point 31 metres north of that kerb-line;	At any time

SCHEDULE – WAITING RESTRICTIONS (SUBSTITUTION)

<i>Item No. (1)</i>	<i>Street (2)</i>	<i>Prescribed hours (3)</i>
	(viii) between the south-western kerb-line of Long Lane and a point 17 metres south-east of the south-eastern wall of Nos. 1-12 Elim Estate, Weston Street;	8 am to 6.30 pm Monday to Saturday
	(ix) between a point 17 metres south-east of the south-eastern wall of Nos. 1-12 Elim Estate, Weston Street and its junction with Wild's Rents;	At any time
(b)	the west, south-west and north-west side	
	(i) between a point 6 metres south of the south-western kerb-line of Tooley Street and a point 3 metres north of the north-eastern kerb-line of St Thomas Street;	At any time
	(ii) between a point 8 metres south of the south-western kerb-line of St Thomas Street and a point 20 metres south of that kerb-line;	At any time
	(iii) between a point 20 metres south of the south-western kerb-line of St Thomas Street and a point 17 metres north of the northern kerb-line of Snowsfields;	8 am to 6.30 pm Monday to Saturday
	(iv) between a point 17 metres north of the northern kerb-line of Snowsfields and a point 21 metres south of the southern kerb-line of Snowsfields;	At any time
	(v) between a point 21 metres south of the southern kerb-line of Snowsfields and a point 6.5 metres north-west of the northern kerb-line of Guy Street;	8 am to 6.30 pm Monday to Saturday
	(vi) between a point 6.5 metres north-west of the northern kerb-line of Guy Street and a point 34 metres south-east of the southern kerb-line of Guy Street;	At any time
	(vii) between a point 34 metres south-east of the southern kerb-line of Guy Street and a point 9 metres north of the northern kerb-line of the northern vehicular access to Burwash House and Simla House, Kipling Estate, Weston Street;	8 am to 6.30 pm Monday to Saturday
	(viii) between a point 9 metres north of the northern kerb-line of the northern vehicular access to Burwash House and Simla House, Kipling Estate, Weston Street and a point 3.5 metres south of the southern kerb-line of the northern vehicular access to Burwash House and Simla House, Kipling Estate, Weston Street;	At any time
	(ix) between a point 3.5 metres south of the southern kerb-line of the northern vehicular access to Burwash House and Simla House, Kipling Estate, Weston Street and a point 9 metres north-west of the north-	8 am to 6.30 pm Monday to Saturday

SCHEDULE – WAITING RESTRICTIONS (SUBSTITUTION)

<i>Item No. (1)</i>	<i>Street (2)</i>	<i>Prescribed hours (3)</i>
	western kerb-line of the southern vehicular access to Burwash House and Simla House, Kipling Estate, Weston Street;	
(x)	between a point 9 metres north-west of the north-western kerb-line of the southern vehicular access to Burwash House and Simla House, Kipling Estate, Weston Street and a point 29.5 metres north of the south-eastern wall of Nos. 8/18 Helder Court, Dunsterville Way;	At any time
(xi)	between a point 29.5 metres north of the south-eastern wall of Nos. 8/18 Helder Court, Dunsterville Way and a point 0.5 metres north of that south-eastern wall;	8 am to 6.30 pm Monday to Saturday
(xii)	between a point 0.5 metres north of the south-eastern wall of Nos. 8/18 Helder Court, Dunsterville Way and the north-eastern kerb-line of Long Lane;	At any time
(xiii)	between the south-western kerb-line of Long Lane and a point 4.5 metres south-east of the south-eastern wall of Nos. 1-33 Chartham House, Weston Street;	8 am to 6.30 pm Monday to Saturday
(xiv)	between a point 4.5 metres south-east of the south-eastern wall of Nos. 1-33 Chartham House, Weston Street and the north-western kerb-line of Law Street.	At any time

EXPLANATORY NOTE

(This note is not part of the Order)

This Order introduces new or extends existing lengths of 'at any time' waiting restrictions in Drummond Road and Weston Street, in the London Borough of Southwark. So as to accommodate the introduction of new vehicular cross-overs to access new developments.