

Public notice

Library Street redevelopments

*The London Borough of Southwark (Parking places) (CPZ 'C2') (No. *) Order 201**

*The London Borough of Southwark (Loading bays) (No. *) Order 201**

*The London Borough of Southwark (Waiting and loading restrictions) (Amendment No. *) Order 201**

1. Southwark Council hereby GIVES NOTICE that it proposes to make the above orders under sections 6, 45, 46 and 124 of and Part IV of Schedule 9 to the Road Traffic Regulation Act 1984¹, as amended.
2. These orders have previously been advertised in *The London Gazette*, on 2 August 2018, with an error in part 2 whereby the incorrect restrictions were listed for the proposed loading bay. This notice corrects that error and extends the consultation period. The effect of the orders would be, in LIBRARY STREET:-
 - (i) to relocate existing pay parking places from the south-west to the north-east side and increase in length by 3.4 metres, so that the pay parking bay is 35.4 metres in length;
 - (ii) on the south-west side, to introduce a new inset loading bay of 18.7 metres in length in which loading would be permitted between the hours of 7am and 7pm Monday – Saturday (maximum stay 40 minutes, no return within 2 hours); and
 - (iii) on both sides, between Borough Road and Davidge Street - to convert all existing single yellow line waiting restrictions to double yellow line 'at any time' waiting restrictions and to amend the waiting restrictions to accommodate the above changes.
3. Southwark Council hereby GIVES FURTHER NOTICE under sections 90A to 90I of the Highways Act 1980² and in accordance with the provisions of the Highways (Road humps) Regulations 1999³ and the Highways (Traffic calming) Regulations 1999⁴, that will introduce a new speed table of flat-top construction, having a maximum height of 100 millimetres and covering the entire width of the carriageway in MILCOTE STREET: - at its north-eastern extremity, from a point 5.2 metres north-west of the north-western kerb-line build-out of Library Street north-westward, for all that is public highway.
Note: these measures would replace any existing speed tables, speed cushions or road humps at or in the immediate vicinity of the above location.
4. For more information about these proposals please contact Ioannis Lampropoulos of the council's Highways – Transport Projects team by telephone on 020 7525 4566 or by e-mail Highways@southwark.gov.uk.
5. Copies of this notice, the proposed orders, a statement of the council's reasons for making the orders and a plan of the proposal may be found online at www.southwark.gov.uk/trafficorders or by scanning the QR code below, paper copies may be obtained from or viewed at Highways, Environment and Social Regeneration, 3rd floor hub 2, 160 Tooley Street, London SE1 2QH. Please call 020 7525 3497 for details.
6. Anyone wishing to object to or make any other representations regarding the proposal, may use the form labelled '*Parking - Road traffic and highway schemes - responding to statutory consultation notices*' at www.southwark.gov.uk/statutoryconsultationnotices or send a statement in writing to: Traffic Order consultations, Highways, Southwark Council, Environment and Social Regeneration, P.O. Box 64529, London SE1P 5LX or by e-mail to traffic.orders@southwark.gov.uk quoting reference '*TMO1819-Library St*' by 14 September 2018. Please note that if you wish to object to this proposal you must state the grounds on which your objection is made.
7. Under the requirements of current access to information legislation, any letter or e-mail sent to the Council in response to this Notice may be subject to publication or disclosure, or both, including communication to other persons affected.

Dated 23 August 2018

Nicky Costin

Parking and Network Management Business Unit Manager, Regulatory Services



¹ 1984 c.27

² 1980 c.66

³ SI 1999/1065

⁴ SI 1999/1026

Statement of reasons

Library Street redevelopments

*The London Borough of Southwark (Parking places) (CPZ 'C2') (No. *) Order 201**

*The London Borough of Southwark (Loading bays) (No. *) Order 201**

*The London Borough of Southwark (Waiting and loading restrictions) (Amendment No. *) Order 201**

Library Street – St. George's ward

Planning permission (14/AP/1862) was granted on 11 March 2015 for the redevelopment of 128-150 Blackfriars Road, in the London Borough of Southwark. The premises provide a mixed use scheme comprised of 336 residential units (Class C3), 2,502sqm of office (Class B1), 1,200sqm of retail (Class A1-A4), 528sqm of office or retail (Class B1 or Class A1-A4) and 154sqm of ancillary residential floor space (residents gym), 79 basement car parking spaces together with access, hard and soft landscaping and other associated works incidental to the development.

A new inset loading bay will be introduced on the west-side of Library Street, in which vehicles may load or unload between these times: Monday – Saturday between the hours of 7 am and 7 pm (max 40 minutes stay, and no return within 2 hours).

To accommodate the new inset loading bay, the existing 'pay' parking bays (approx. space for 6 vehicles) require relocation from the western side of Library Street to the eastern side.

Alongside the change to parking bay locations, the existing single yellow lines are to be replaced by double yellow lines restricting waiting 'at any time'.

This arrangement will prevent traffic back-up, providing a smoother route for vehicles to travel along Library Street with reduced risk of vehicle conflict between north and southbound traffic; and with no loss of parking bays.

Dated 2 August 2018

For more information contact:-

Ioannis Lampropoulos

Engineer

Highways - Network Development

020 7525 4566

Highways@southwark.gov.uk

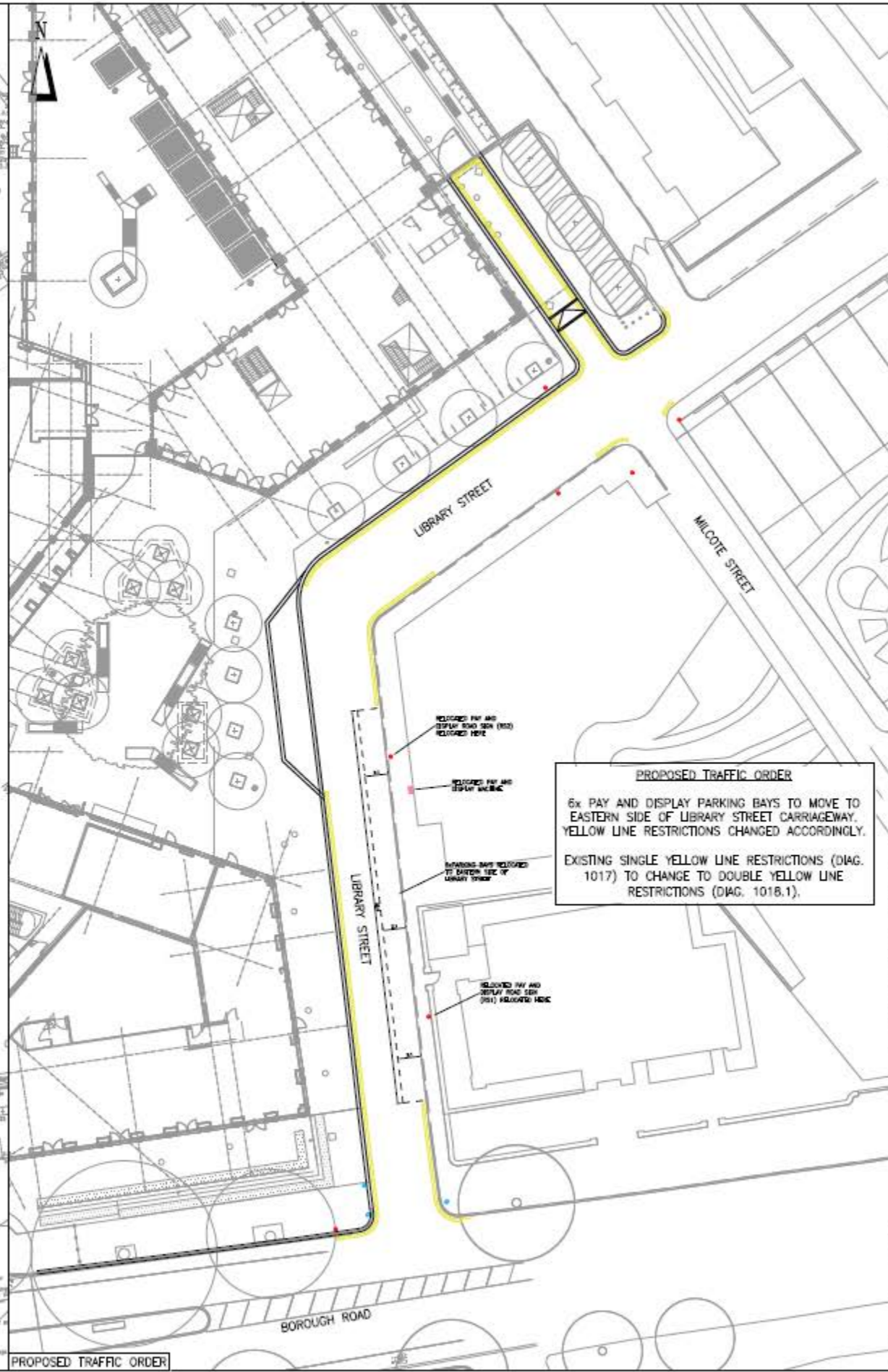

PROPOSED TRAFFIC ORDER

6x PAY AND DISPLAY PARKING BAYS TO MOVE TO EASTERN SIDE OF LIBRARY STREET CARRIAGEWAY. YELLOW LINE RESTRICTIONS CHANGED ACCORDINGLY.

EXISTING SINGLE YELLOW LINE RESTRICTIONS (DIAG. 1017) TO CHANGE TO DOUBLE YELLOW LINE RESTRICTIONS (DIAG. 1018.1).

NO.	DESCRIPTION	DATE	BY
1	ISSUED FOR APPROVAL	18/10/2018	URS
2	FOR APPROVAL	18/10/2018	URS
3	FOR APPROVAL	18/10/2018	URS
4	FOR APPROVAL	18/10/2018	URS
5	FOR APPROVAL	18/10/2018	URS
6	FOR APPROVAL	18/10/2018	URS
7	FOR APPROVAL	18/10/2018	URS
8	FOR APPROVAL	18/10/2018	URS
9	FOR APPROVAL	18/10/2018	URS
10	FOR APPROVAL	18/10/2018	URS
11	FOR APPROVAL	18/10/2018	URS
12	FOR APPROVAL	18/10/2018	URS
13	FOR APPROVAL	18/10/2018	URS
14	FOR APPROVAL	18/10/2018	URS
15	FOR APPROVAL	18/10/2018	URS
16	FOR APPROVAL	18/10/2018	URS
17	FOR APPROVAL	18/10/2018	URS
18	FOR APPROVAL	18/10/2018	URS
19	FOR APPROVAL	18/10/2018	URS
20	FOR APPROVAL	18/10/2018	URS
21	FOR APPROVAL	18/10/2018	URS
22	FOR APPROVAL	18/10/2018	URS
23	FOR APPROVAL	18/10/2018	URS
24	FOR APPROVAL	18/10/2018	URS
25	FOR APPROVAL	18/10/2018	URS
26	FOR APPROVAL	18/10/2018	URS
27	FOR APPROVAL	18/10/2018	URS
28	FOR APPROVAL	18/10/2018	URS
29	FOR APPROVAL	18/10/2018	URS
30	FOR APPROVAL	18/10/2018	URS
31	FOR APPROVAL	18/10/2018	URS
32	FOR APPROVAL	18/10/2018	URS
33	FOR APPROVAL	18/10/2018	URS
34	FOR APPROVAL	18/10/2018	URS
35	FOR APPROVAL	18/10/2018	URS
36	FOR APPROVAL	18/10/2018	URS
37	FOR APPROVAL	18/10/2018	URS
38	FOR APPROVAL	18/10/2018	URS
39	FOR APPROVAL	18/10/2018	URS
40	FOR APPROVAL	18/10/2018	URS
41	FOR APPROVAL	18/10/2018	URS
42	FOR APPROVAL	18/10/2018	URS
43	FOR APPROVAL	18/10/2018	URS
44	FOR APPROVAL	18/10/2018	URS
45	FOR APPROVAL	18/10/2018	URS
46	FOR APPROVAL	18/10/2018	URS
47	FOR APPROVAL	18/10/2018	URS
48	FOR APPROVAL	18/10/2018	URS
49	FOR APPROVAL	18/10/2018	URS
50	FOR APPROVAL	18/10/2018	URS
51	FOR APPROVAL	18/10/2018	URS
52	FOR APPROVAL	18/10/2018	URS
53	FOR APPROVAL	18/10/2018	URS
54	FOR APPROVAL	18/10/2018	URS
55	FOR APPROVAL	18/10/2018	URS
56	FOR APPROVAL	18/10/2018	URS
57	FOR APPROVAL	18/10/2018	URS
58	FOR APPROVAL	18/10/2018	URS
59	FOR APPROVAL	18/10/2018	URS
60	FOR APPROVAL	18/10/2018	URS
61	FOR APPROVAL	18/10/2018	URS
62	FOR APPROVAL	18/10/2018	URS
63	FOR APPROVAL	18/10/2018	URS
64	FOR APPROVAL	18/10/2018	URS
65	FOR APPROVAL	18/10/2018	URS
66	FOR APPROVAL	18/10/2018	URS
67	FOR APPROVAL	18/10/2018	URS
68	FOR APPROVAL	18/10/2018	URS
69	FOR APPROVAL	18/10/2018	URS
70	FOR APPROVAL	18/10/2018	URS
71	FOR APPROVAL	18/10/2018	URS
72	FOR APPROVAL	18/10/2018	URS
73	FOR APPROVAL	18/10/2018	URS
74	FOR APPROVAL	18/10/2018	URS
75	FOR APPROVAL	18/10/2018	URS
76	FOR APPROVAL	18/10/2018	URS
77	FOR APPROVAL	18/10/2018	URS
78	FOR APPROVAL	18/10/2018	URS
79	FOR APPROVAL	18/10/2018	URS
80	FOR APPROVAL	18/10/2018	URS
81	FOR APPROVAL	18/10/2018	URS
82	FOR APPROVAL	18/10/2018	URS
83	FOR APPROVAL	18/10/2018	URS
84	FOR APPROVAL	18/10/2018	URS
85	FOR APPROVAL	18/10/2018	URS
86	FOR APPROVAL	18/10/2018	URS
87	FOR APPROVAL	18/10/2018	URS
88	FOR APPROVAL	18/10/2018	URS
89	FOR APPROVAL	18/10/2018	URS
90	FOR APPROVAL	18/10/2018	URS
91	FOR APPROVAL	18/10/2018	URS
92	FOR APPROVAL	18/10/2018	URS
93	FOR APPROVAL	18/10/2018	URS
94	FOR APPROVAL	18/10/2018	URS
95	FOR APPROVAL	18/10/2018	URS
96	FOR APPROVAL	18/10/2018	URS
97	FOR APPROVAL	18/10/2018	URS
98	FOR APPROVAL	18/10/2018	URS
99	FOR APPROVAL	18/10/2018	URS
100	FOR APPROVAL	18/10/2018	URS

FOR APPROVAL

BARRATT LONDON (STRATFORD)

BLACKFRIARS ROAD

SECTION 276 TRAFFIC MANAGEMENT ORDER

47071168 / 1315

URS



THE COUNCIL OF THE LONDON BOROUGH OF SOUTHWARK

TRAFFIC MANAGEMENT ORDER

2017 No. xxx

The London Borough of Southwark (Parking places) (CPZ 'C2') (No. *) Order 201*

Made: xx xxxx 2018

Coming into force: xx xxxx 2018

The Council of the London Borough of Southwark, after consulting the Commissioner of Police of the Metropolis, in exercise of the powers conferred by sections 45, 46, 49 and 124 of and Part IV of Schedule 9 to the Road Traffic Regulation Act 1984^a, as amended, and of all other powers thereunto enabling, hereby make the following Order:

Citation and commencement

- 1.1 This Order may be cited as the London Borough of Southwark (Parking places) (CPZ 'C2') (No. *) Order 201* and shall come into force on xx xxxxx 201*.

Interpretation

- 2.1 In this Order:-

“council” means the council of the London Borough of Southwark;

“enactment” means any enactment, whether public general or local, and includes any order, bye-law, rule, regulation, scheme or other instrument having effect by virtue of an enactment; and

“the Order of 2009” means The London Borough of Southwark (Parking Places) (CPZ 'C2') (No. 1) Order 2009^b.

- 2.2 Any reference in this Order to any enactment shall be construed as a reference to that enactment as amended, applied, consolidated, re-enacted by or as having effect by virtue of any subsequent enactment.
- 2.3 Unless the context otherwise requires, any expression used in this Order which is also used in the Order of 2009 shall have the same meaning as in that Order.

Revocation

- 3.1 Without prejudice to the validity of anything done or to any liability incurred in respect of any act or omission before the coming into force of this Order, the designation by the Order of 2009 of the parking place numbered 22 in Schedule 3 therein is hereby revoked.

^a 1984 c.27

^b LBS 2009/073

Designation of parking places and application of the Order of 2009 thereto

- 4.1 Each area on a highway comprising the length of carriageway of a street specified in columns (2) and (3) of a Schedule to this Order and bounded on one side of that length by the edge of the carriageway, and having a width throughout of 2 metres, is designated as a parking place.
- 4.2 The provisions of the Order of 2009 (other than Articles 3, 15 and 16) shall apply to each area described in the Schedules to this Order as if in those provisions any reference to a parking place shall include a reference to each area designated as a parking place by this Order and as if any reference to Schedule 3 to the Order of 2009 included a reference to the Schedule to this Order.

Placing of traffic signs, etc.

- 5.1 The council shall:-
- (a) place and maintain traffic signs indicating the limits of each parking place referred to in the Schedule to this Order;
 - (b) place and maintain in or in the vicinity of each parking place referred to in the Schedule to this Order traffic signs indicating that such a parking place may be used during the permitted hours for the leaving only of the vehicles specified in Article 4.1 and 4.3 of the Order of 2007;
 - (c) carry out such other works as is reasonably required for the purposes of the satisfactory operation of a parking place.

Dated this xx day of xxxx 201*

[signature here]

NICKY COSTIN
Road Network and Parking Business Unit Manager
Public Realm

SCHEDULE - 'PAY' PARKING PLACES

<i>No. of parking place (1)</i>	<i>Designated parking place (2)</i>	<i>Permitted hours (3)</i>	<i>Maximum parking period (4)</i>	<i>Minimum return interval (5)</i>
**.	LIBRARY STREET the north-east side, from a point 10.7 metres north of the northern kerb-line of Borough Road northward for a distance of 35.4 metres.	8.30 am to 6.30 pm Monday to Friday	4 hours	2 hours

DRAFT

EXPLANATORY NOTE

(This Note is not part of the Order)

This Order relocates an existing 'pay' parking place in Library Street Road, in the London Borough of Southwark, so as to accommodate the redevelopments in this area.

DRAFT



THE COUNCIL OF THE LONDON BOROUGH OF SOUTHWARK

TRAFFIC MANAGEMENT ORDER

2018 No. xxx

The London Borough of Southwark (Loading bays) (No. **) Order 201*

Made: xx xxxx 201*

Coming into force: xx xxx 201*

The council of the London Borough of Southwark, after consulting the Commissioner of Police of the Metropolis, in exercise of the powers conferred by sections 6 and 124 of and Part IV of Schedule 9 to the Road Traffic Regulation Act 1984^a, as amended, and of all other powers thereunto enabling, hereby make the following Order:

Citation and commencement

- 1.1 This Order may be cited as The London Borough of Southwark (Loading bays) (No. 14) Order 2018 and shall come into force on 4 June 2018.

Interpretation

- 2.1 In this Order:-

"council" means the council of the London Borough of Southwark;

"enactment" means any enactment, whether public general or local, and includes any order, bye-law, rule, regulation, scheme or other instrument having effect by virtue of an enactment; and

"the Order of 2016" means the London Borough of Southwark (Loading bays) (No. 1) Order 2016^b.

- 2.2 Any reference in this Order to any enactment shall be construed as a reference to that enactment as amended, applied, consolidated, re-enacted by or as having effect by virtue of any subsequent enactment.
- 2.3 Unless the context otherwise requires, any expression used in this Order which is also used in the Order of 2016 shall have the same meaning as in that Order.

^a 1984 c.27

^b LBS 2016/005

Designation of loading bays and application of the Order of 2016 thereto

- 3.1 Each area on a highway comprising the length of carriageway of a street specified in column 2 of the Schedule to this Order and bounded on one side of that length by the edge of the carriageway, is designated as a loading bay.
- 3.2 The provisions of the Order of 2016 (other than Articles 3.1 and 12.1) shall apply to each area designated as a loading bay by this Order as if in those provisions any reference to a loading bay shall include a reference to each area designated as a loading bay by this Order and as if any reference to Schedule 1 to the Order of 2016 included a reference to the Schedule to this Order.

Placing of traffic signs etc.

4.1 The council shall:-

- (a) place and maintain traffic signs indicating the limits of each loading bay referred to in the Schedule to this Order;
- (b) place and maintain in or in the vicinity of each loading bay referred to in the Schedule to this Order, traffic signs indicating that such a loading bay may be used during the permitted hours for the leaving only of the vehicles referred to in Article 4.1 of the Order of 2016; and
- (c) carry out such other work as is reasonably required for the purposes of the satisfactory operation of a loading bay.

Dated this xxx day of xx 201*

[signature here]

NICKY COSTIN
Parking and Network Management Business Unit Manager
Regulatory Services

SCHEDULE - LOADING BAYS

<i>No. of loading bay (1)</i>	<i>Designated loading bay (2)</i>	<i>Permitted hours (3)</i>	<i>Maximum loading period (4)</i>	<i>Minimum return interval (5)</i>
***.	LIBRARY STREET the south-west side, from a point 39.6 metres north-west of the north-western kerb-line of Borough Road north-westward for a distance of 18.7 metres.	7 am to 7 pm Monday - Saturday	40 minutes	2 hours

EXPLANATORY NOTE

(This note is not part of the Order)

This Order introduces a new inset loading bay in Library Street, in London Borough of Southwark.



THE COUNCIL OF THE LONDON BOROUGH OF SOUTHWARK

TRAFFIC MANAGEMENT ORDER

201* No. 0**

The London Borough of Southwark (Waiting and loading restrictions)
(Amendment No. **) Order 201*

Made: 201*

Coming into force: 201*

The council of the London Borough of Southwark, after consulting the Commissioner of Police of the Metropolis, in exercise of the powers conferred by sections 6 and 124 of the Road Traffic Regulation Act 1984^a, as amended, and of all other powers thereunto enabling, hereby make the following Order:

Citation and commencement

- 1.1 This Order may be cited as the London Borough of Southwark (Waiting and loading restrictions) (Amendment No. **) Order 201* and shall come into force on 201*.

Interpretation

- 2.1 In this Order:-

"council" means the council of the London Borough of Southwark;

"enactment" means any enactment, whether public general or local, and includes any order, bye-law, rule, regulation, scheme or other instrument having effect by virtue of an enactment; and

"the Order of 2015" means the London Borough of Southwark (Waiting and loading restrictions) Consolidation Order 2015^b - as amended.

- 2.2 Any reference in this Order to any enactment shall be construed as a reference to that enactment as amended, applied, consolidated, re-enacted by or as having effect by virtue of any subsequent enactment.
- 2.3 Unless the context otherwise requires, any expression used in this Order which is also used in the Order of 2015 shall have the same meaning as in that Order.

^a 1984 c.27

^b LBS 2015/082

Amendment of the Order of 2015

- 3.1 Without prejudice to the validity of anything done, or to any liability incurred in respect of any act or omission before the coming into force of this Order, the Order of 2015 shall have effect as though for the items numbered 578 and 668 in Schedule 1 to that Order there were substituted the items similarly numbered and set out in columns 1, 2 and 3 of the Schedule to this Order.

Dated this day of 201*

[signature here]

NICKY COSTIN
Parking and Network Management Business Unit Manager
Regulatory Services

SCHEDULE 1 – WAITING RESTRICTIONS (SUBSTITUTION)

<i>Item No. (1)</i>	<i>Street (2)</i>	<i>Prescribed hours (3)</i>
578.	LIBRARY STREET	
	(a) the north-west and west side	
	(i) between the south-western kerb-line of Lancaster Street and a point 3 metres south-west of that kerb-line;	At any time
	(ii) between a point 9.5 metres north-east of the north-eastern kerb-line of Davidge Street and a point 3.5 metres south-west of the south-western kerb-line of Davidge Street;	At any time
	(iii) between a point 19 metres south-west of the south-western kerb-line of Davidge Street and a point 58.3 metres north of the northern kerb-line of Borough Road;	At any time
	(iv) between the northern kerb-line of Borough Road and a point 39.6 metres north of that kerb-line;	At any time
	(b) the south-east and east side	
	(i) between the south-western kerb-line of Lancaster Street and a point 5 metres south-west of the south-western kerb-line of Milcote Street;	At any time
	(ii) between a point 21 metres south-west of the south-western kerb-line of Milcote Street and a point 46.4 metres north of the northern kerb-line of Borough Road;	At any time
	(iii) between the northern kerb-line of Borough Road and a point 10.7 metres north of that kerb-line;	At any time
	(c) so much else as does not lie within those lengths of street specified in sub-paragraphs (a) and (b) above.	8.30 am to 6.30 pm Monday to Friday
668.	MILCOTE STREET	At any time

EXPLANATORY NOTE

(This note is not part of the Order)

This Order amends waiting restriction definitions in Library Street and Milcote Street, so as to accommodate the nearby redevelopments, in the London Borough of Southwark.