

Public notice

Nelson Square improvements

*The London Borough of Southwark (Parking places) (CPZ 'C1') (No. *) Order 201**

*The London Borough of Southwark (Free parking places) (Disabled persons) (No. *) Order 201**

*The London Borough of Southwark (Waiting and loading restrictions) (Amendment No. *) Order 201**

1. Southwark Council hereby GIVES NOTICE that it proposes to make the above orders under sections 6, 45, 46, 49 and 124 of and Part IV of Schedule 9 to the Road Traffic Regulation Act 1984¹, as amended.
2. The effect of the orders would be in NELSON SQUARE:-
 - (a) the northern arm outside Nos. 52-156 Rowland Hill House, Nelson Square, to:
 - (i) formalise lengths of existing single yellow line waiting restrictions on the north, north-west, south, south-east and southwest sides; (ii) formalise lengths of existing 'at any time' waiting restrictions on the north and south sides; (iii) to remove 5 metres of existing 'at any time' waiting restrictions on the north side to reduce the net loss of 'C1' permit holders' parking places, and (iv) to reduce overall in length by 8 metres an existing 'C1' permit holders' parking place on the north side, so as to accommodate a raised speed table;
 - (b) the eastern arm outside Nos. 157-209 Applegarth House, Nelson Square, to:
 - (i) formalise lengths of existing single yellow line waiting restrictions on the east and west sides; (ii) formalise lengths of existing 'at any time' waiting restrictions on the east and west sides; (iii) to remove 4 metres of existing 'at any time' waiting restrictions on the east side to reduce the net loss of 'C1' permit holders' parking places, and (iv) to reduce overall in length by 1.1 metres an existing 'C1' permit holders' parking place on the east side, so as to accommodate a raised speed table;
 - (c) the southern arm outside Nos. 222-269 Helen Gladstone House, Nelson Square, to formalise:
 - (i) lengths of existing single yellow line waiting restrictions on the north and south sides; (ii) lengths of 'at any time' waiting restrictions on the north and south sides; (iii) the reduction in length by 15.2 metres of the existing 'C1' permit holders' parking place on the south side; and (iv) the increase in length, to 6.6 metres, and relocation eastwards (by a distance of 14.5 metres) the existing 'unlimited stay' disabled persons' (blue badge-holders') parking place, so as to accommodate a raised speed table; and
 - (d) the western arm outside Nos. 1-51 Vaughan House, Nelson Square, to:
 - (i) formalise lengths of existing single yellow line waiting restrictions on the east and west sides; (ii) formalise lengths of 'at any time' waiting restrictions on the east and west sides; (iii) to remove 4 metres of existing 'at any time' waiting restrictions on the west side to reduce the net loss of 'C1' permit holders' parking places, and (iv) to reduce overall in length by 10 metres an existing 'C1' permit holders' parking place on the west side, so as to accommodate a raised speed table.
3. Southwark Council hereby GIVES FURTHER NOTICE under sections 90A to 90I of the Highways Act 1980² and in accordance with the provisions of the Highways (Road humps) Regulations 1999³ and the Highways (Traffic calming) Regulations 1999⁴, that it formalises existing speed tables of flat-top construction, having a maximum height of 100 millimetres and covering the entire width of the carriageway in NELSON SQUARE:-
 - (a) the northern arm, extending from a point 16.5 metres west of the common boundary of Nos. 52-156 Rowland Hill House, Nelson Square and The Lord Nelson PH, Union Street westwards for a distance of 9.7 metres;
 - (b) the eastern arm, extending from a point 11 metres north of the southern wall of Nos. 157-209 Applegarth House, Nelson Square northwards for a distance of 7.2 metres;
 - (c) the southern arm, extending from a point 7.7 metres east of the eastern kerb-line of vehicular access to Nos. 222-269 Helen Gladstone House, Nelson Square eastwards for a distance of 7.2 metres; and
 - (d) the western arm, extending from a point 7.6 metres south of the northern wall of Nos. 1-51 Vaughan House, Nelson Square southwards for a distance of 7.2 metres.

Note: these measures would replace any existing speed tables, speed cushions or road humps at or in the immediate vicinity of the above locations.
4. For more information about these proposals please contact Ryan Britton of the council's Highways – Transport Projects team by telephone on 020 7525 4296 or by e-mail Highways@southwark.gov.uk .

5. Copies of this notice, the proposed orders, a statement of the council's reasons for making the orders and a plan of the proposal may be found online at www.southwark.gov.uk/trafficorders or by scanning the QR code below, paper copies may be obtained from or viewed at Highways, Environment and Social Regeneration, 3rd floor hub 2, 160 Tooley Street, London SE1 2QH. Please call 020 7525 3497 for details.
6. Anyone wishing to object to or make any other representations regarding the proposal, may use the form labelled '*Parking - Road traffic and highway schemes - responding to statutory consultation notices*' at www.southwark.gov.uk/statutoryconsultationnotices or send a statement in writing to: Traffic Order consultations, Highways, Southwark Council, Environment and Social Regeneration, P.O. Box 64529, London SE1P 5LX or by e-mail to traffic.orders@southwark.gov.uk quoting reference '*TMO1819-012 Nelson Square*' by 23 August 2018. Please note that if you wish to object to this proposal you must state the grounds on which your objection is made.
7. When making an objection or representation, please be aware that this may be communicated to other people who may be affected. Information provided in response to this consultation, including in some circumstances personal information, may also be subject to publication or disclosure under the requirements of current access to information legislation.

Dated 2 August 2018

Nicky Costin

Parking and Network Management Business Unit Manager, Regulatory Services



¹ 1984 c.27

² 1980 c.66

³ SI 1999/1065

⁴ SI 1999/1026

Statement of reasons

Nelson Square improvements

*The London Borough of Southwark (Parking places) (CPZ 'C1') (No. *) Order 201**

*The London Borough of Southwark (Free parking places) (Disabled persons) (No. *) Order 201**

*The London Borough of Southwark (Waiting and loading restrictions) (Amendment No. *) Order 201**

Nelson Square is located in the Borough & Bankside ward of the London Borough of Southwark.

Nelson Square completely surrounds Nelson Square Garden, which is a popular public play area for residents and visitors. This scheme aims to make the best use of carriageway by i) formalising measures set in place to improve the safety and accessibility for pedestrians as well as, ii) maximising the amount of on-street permit parking places made available to the surrounding housing.

This scheme proposes to:

- formalise existing raised (flat-topped design) speed tables, which reduce vehicle speeds and provide level-access to and from Nelson Square Garden;
- formalise and amend existing parking bays, to increase the amount of permit holder's parking places in zone 'C1' to provide a net parking increase in length of approx. 13 metres, a figure that was reduced overall by the recent changes to the pedestrian access; and
- amend existing waiting restrictions, to accommodate the above changes.

For more information contact:-

Ryan Britton

Principal Engineer

Highways – Transport Projects

c/o: traffic.orders@southwark.gov.uk

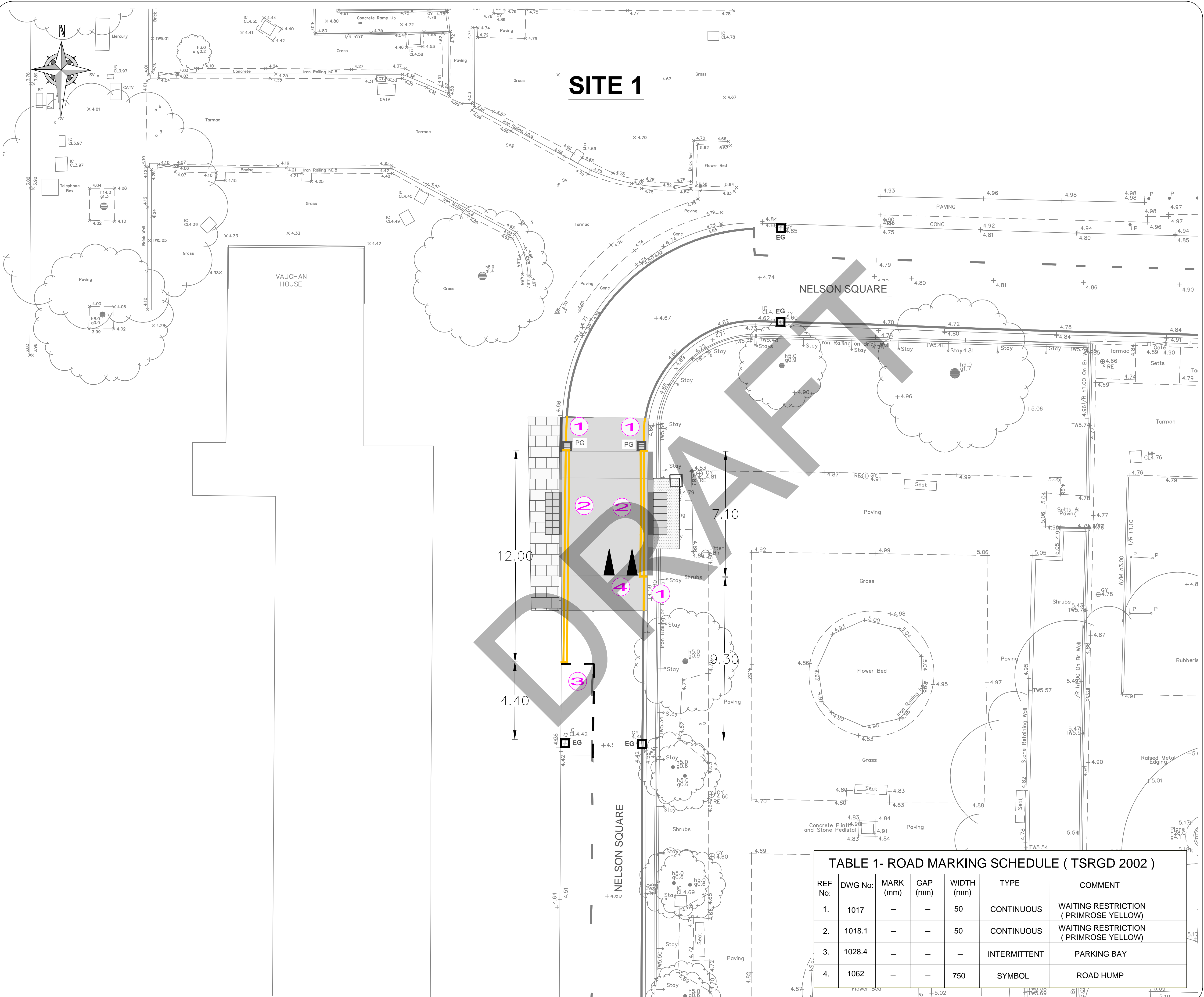

SITE 1

LEGEND / NOTES

NOTES
 1. ALL ROAD MARKINGS ARE TO BE IN ACCORDANCE WITH THE TRAFFIC SIGNS REGULATIONS AND GENERAL DIRECTIONS 2002 & CHAPTER 5 OF THE TRAFFIC SIGNS MANUAL

 CARRIAGEWAY MARKING REFERENCE

Revision	Date	Amendment	Drawn	Design	Checked	Approved
A	MAR 16	AMENDMENT OF ROAD MARKING SCHEDULE	SD	SD	AB	AGB



TABLE 1- ROAD MARKING SCHEDULE (TSRGD 2002)

REF No:	DWG No:	MARK (mm)	GAP (mm)	WIDTH (mm)	TYPE	COMMENT
1.	1017	-	-	50	CONTINUOUS	WAITING RESTRICTION (PRIMROSE YELLOW)
2.	1018.1	-	-	50	CONTINUOUS	WAITING RESTRICTION (PRIMROSE YELLOW)
3.	1028.4	-	-	-	INTERMITTENT	PARKING BAY
4.	1062	-	-	750	SYMBOL	ROAD HUMP

Project
NELSON SQUARE

Title
1200 SERIES - ROAD MARKING AND SIGNS SHEET 1 OF 4

Contract No. **60343287-C0204**

Scale **1:100@A1** Purpose **CONSTRUCTION**

Drawing No. **60343287-C0204-1200-01** Rev. **A**

Date Drawn **JULY 2015** Date Issued **FEB 2016**

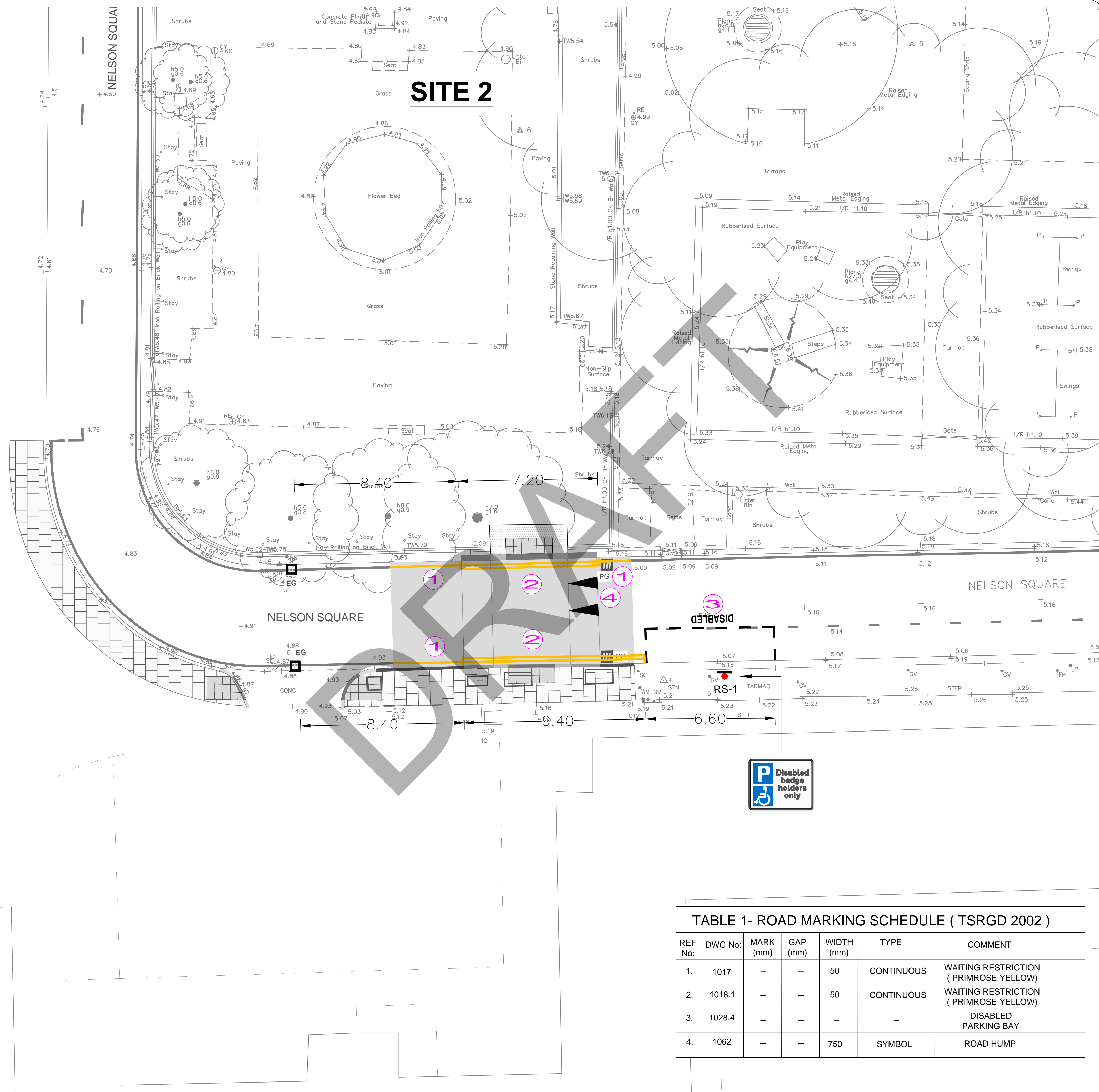
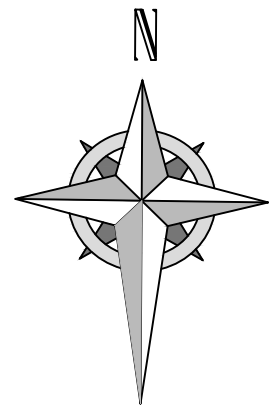

LEGEND / NOTES

RS-1 TAKE FROM STORE AND INSTALL 'DISABLED BADGE HOLDERS' SIGN PLATE ON A NEW POST (TSRGD661A)

2 CARRIAGEWAY MARKING REFERENCE

NOTES

1. ALL ROAD MARKINGS ARE TO BE IN ACCORDANCE WITH THE TRAFFIC SIGNS REGULATIONS AND GENERAL DIRECTIONS 2002 & CHAPTER 5 OF THE TRAFFIC SIGNS MANUAL

Revision	Date	Amendment	Drawn	Design	Checked	Approved
A	MAR 16	AMENDMENT OF ROAD MARKING SCHEDULE	SD	SD	AB	AGB



Shaping Southwark's Highways
PUBLIC REALM PROJECTS TEAM 160 TOOLEY STREET SE1P 5LX

Project		NELSON SQUARE	
Title		1200 SERIES - ROAD MARKING AND SIGNS SHEET 2 OF 4	
Contract No.	60343287-C0204	Drawn	SD
Scale	1:100@A1 CONSTRUCTION	Designed	SD
Drawing No.	60343287-C0204-1200-02	Checked	AB
Date Drawn	JULY 2015	Approved	AGB
Date Issued	FEB 2016	Rev.	A

TABLE 1- ROAD MARKING SCHEDULE (TSRGD 2002)

REF No:	DWG No:	MARK (mm)	GAP (mm)	WIDTH (mm)	TYPE	COMMENT
1.	1017	-	-	50	CONTINUOUS	WAITING RESTRICTION (PRIMROSE YELLOW)
2.	1018.1	-	-	50	CONTINUOUS	WAITING RESTRICTION (PRIMROSE YELLOW)
3.	1028.4	-	-	-	-	DISABLED PARKING BAY
4.	1062	-	-	750	SYMBOL	ROAD HUMP

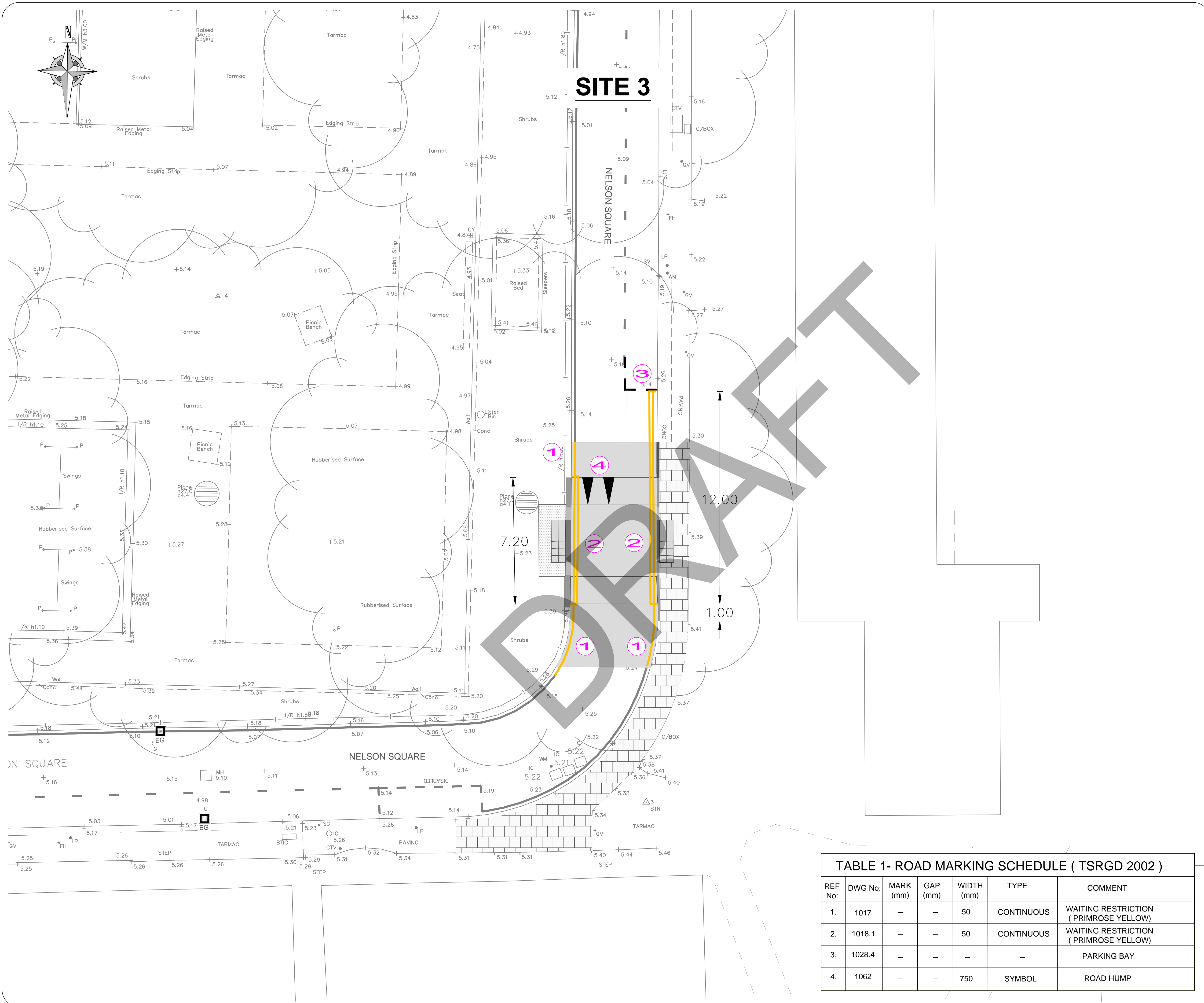

LEGEND / NOTES

NOTES
 1. ALL ROAD MARKINGS ARE TO BE IN ACCORDANCE WITH THE TRAFFIC SIGNS REGULATIONS AND GENERAL DIRECTIONS 2002 & CHAPTER 5 OF THE TRAFFIC SIGNS MANUAL

CARRIAGEWAY MARKING REFERENCE

Revision	Date	Amendment	Drawn	Design	Checked	Approved
A	MAR 16	AMENDMENT OF ROAD MARKING SCHEDULE	SD	SD	AB	AGB



TABLE 1- ROAD MARKING SCHEDULE (TSRGD 2002)

REF No:	DWG No:	MARK (mm)	GAP (mm)	WIDTH (mm)	TYPE	COMMENT
1.	1017	-	-	50	CONTINUOUS	WAITING RESTRICTION (PRIMROSE YELLOW)
2.	1018.1	-	-	50	CONTINUOUS	WAITING RESTRICTION (PRIMROSE YELLOW)
3.	1028.4	-	-	-	-	PARKING BAY
4.	1062	-	-	750	SYMBOL	ROAD HUMPS

Project
NELSON SQUARE

Title
1200 SERIES - ROAD MARKING AND SIGNS SHEET 3 OF 4

Contract No.	60343287-C0204	Drawn	SD
Scale	1:100@A1	Purpose	CONSTRUCTION
		Checked	AB
Drawing No.	60343287-C0204-1200-03	Approved	AGB
Date Drawn	JULY 2015	Rev.	A
Date Issued	FEB 2016		

SITE 4

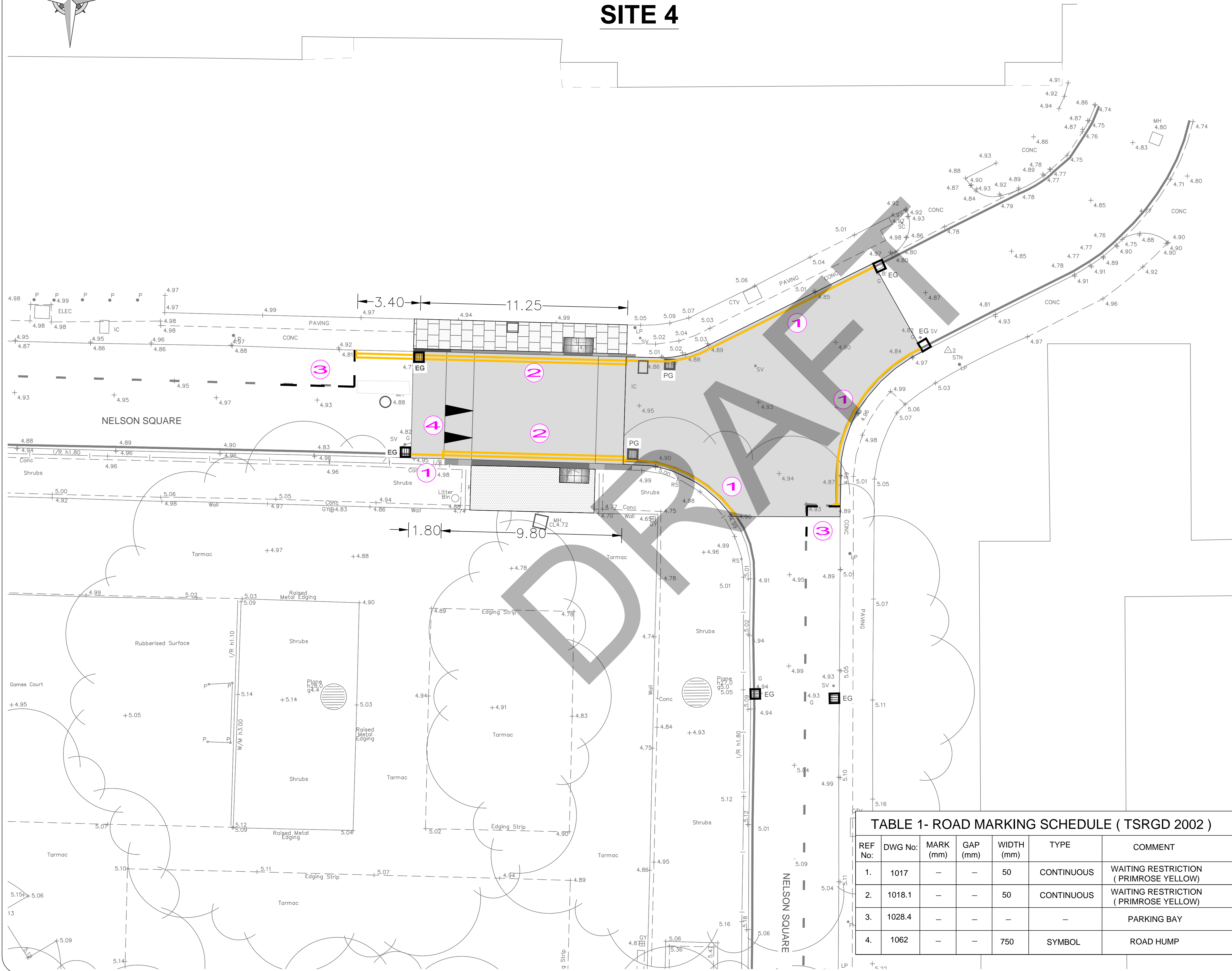
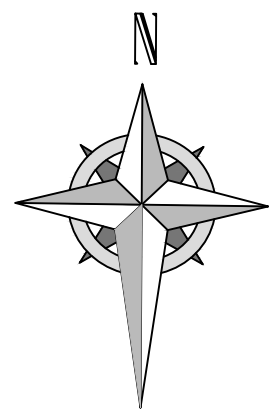

TABLE 1- ROAD MARKING SCHEDULE (TSRGD 2002)

REF No:	DWG No:	MARK (mm)	GAP (mm)	WIDTH (mm)	TYPE	COMMENT
1.	1017	-	-	50	CONTINUOUS	WAITING RESTRICTION (PRIMROSE YELLOW)
2.	1018.1	-	-	50	CONTINUOUS	WAITING RESTRICTION (PRIMROSE YELLOW)
3.	1028.4	-	-	-	-	PARKING BAY
4.	1062	-	-	750	SYMBOL	ROAD HUMPS

LEGEND / NOTES

NOTES

1. ALL ROAD MARKINGS ARE TO BE IN ACCORDANCE WITH THE TRAFFIC SIGNS REGULATIONS AND GENERAL DIRECTIONS 2002 & CHAPTER 5 OF THE TRAFFIC SIGNS MANUAL

2 CARRIAGEWAY MARKING REFERENCE

Revision	Date	Amendment	Drawn	Design	Checked	Approved
A	MAR 16	AMENDMENT OF ROAD MARKING SCHEDULE	SD	SD	AB	AGB



Project		NELSON SQUARE			
Title		1200 SERIES - ROAD MARKING AND SIGNS SHEET 4 OF 4			
Contract No.	60343287-C0204	Drawn	SD	Design	SD
Scale	1:100@A1	Purpose	CONSTRUCTION	Checked	AB
Drawing No.	60343287-C0204-1200-04	Approved	AGB	Rev.	A
Date Drawn	JULY 2015	Date Issued	FEB 2016		



THE COUNCIL OF THE LONDON BOROUGH OF SOUTHWARK

TRAFFIC MANAGEMENT ORDER

2018 No. xxx

The London Borough of Southwark (Parking places) (CPZ 'C1') (No. xx) Order 2018

Made: xxx 2018

Coming into force: xxx 2018

The council of the London Borough of Southwark, after consulting the Commissioner of Police of the Metropolis, in exercise of the powers conferred by sections 45, 46, 49 and 124 of and Part IV of Schedule 9 to the Road Traffic Regulation Act 1984^a, as amended, and of all other powers thereunto enabling, hereby make the following Order:

Citation and commencement

- 1.1 This Order may be cited as the London Borough of Southwark (Parking places) (CPZ 'C1') (No. xx) Order 2018 and shall come into force on xxxx 2018.

Interpretation

- 2.1 In this Order:

“council” means the council of the London Borough of Southwark;

“enactment” means any enactment, whether public general or local, and includes any order, bye-law, rule, regulation, scheme or other instrument having effect by virtue of an enactment; and

“the Order of 2012” means The London Borough of Southwark (Parking places) (CPZ 'C1') (No. 1) Order 2012^b.

- 2.2 Any reference in this Order to any enactment shall be construed as a reference to that enactment as amended, applied, consolidated, re-enacted by or as having effect by virtue of any subsequent enactment.
- 2.3 Unless the context otherwise requires, any expression used in this Order which is also used in the Order of 2012 shall have the same meaning as in that Order.

^a 1984 c.27

^b LBS 2012/055

Revocation

- 3.1 Without prejudice to the validity of anything done, or to any liability incurred in respect of any act or omission before the coming into force of this Order the designation by the Order of 2012 of the parking places numbered 34, 35, 36 and 37 in Schedule 1 therein, is hereby revoked.

Designation of parking places and application of the Order of 2012 thereto

- 4.1 Each area on a highway comprising the length of carriageway of a street specified in columns (2) and (3) of a Schedule to this Order and bounded on one side of that length by the edge of the carriageway, is designated as a parking place.
- 4.2 The provisions of the Order of 2012 (other than Articles 3 and 15) shall apply to the areas described in each Schedule to this Order as if in those provisions any reference to a designated parking place or to a parking place shall include a reference to an area designated as a parking place by this Order and as if any reference to Schedule 1 to the Order of 2012 included a reference to Schedule 1 to this Order.

Placing of traffic signs, etc.

- 5.1 The council shall:-
- (a) place and maintain traffic signs indicating the limits of each parking place referred to in Schedule 1 or 2 to this Order;
 - (b) place and maintain in or in the vicinity of each parking place referred to in the Schedule 1 or 2 to this Order traffic signs indicating that such parking places may be used during the permitted hours for the leaving only of the vehicles specified in Articles 4.1 and 4.3 or 4.4, as the case may be, of the Order of 2012;
 - (c) carry out such other works as is reasonably required for the purposes of the satisfactory operation of a parking place.

Dated this xxxx day of xxxx 201*

[signature here]

NICKY COSTIN
Parking and Network Management Business Unit Manager
Regulatory Services

SCHEDULE 1 – PERMIT HOLDERS' PARKING PLACES

<i>No. of parking place</i> (1)	<i>Designated parking place</i> (2)	<i>Permitted hours</i> (3)
***.	NELSON SQUARE the northern arm, the north side, from a point 32 metres west of the common boundary of Nos. 52-156 Rowland Hill House, Nelson Square and The Lord Nelson PH, Union Street westward for a distance of 48.5 metres.	8 am to 11 pm
***.	NELSON SQUARE the eastern arm, the east side, from a point 10 metres south of the northern wall of Nos. 157-209 Applegarth House, Nelson Square southwards for a distance of 34.9 metres.	8 am to 11 pm
***.	NELSON SQUARE the southern arm, the south side, from a point 16.5 metres west of the eastern wall of Nos. 44-47, Nelson Square westward for a distance of 30.8 metres.	8 am to 11 pm
***.	NELSON SQUARE the western arm, the west side, from a point 9 metres north of the southern wall of Nos. 1-51 Vaughan House, Nelson Square northwards for a distance of 31.2 metres.	8 am to 11 pm

EXPLANATORY NOTE

(This note is not part of the Order)

This order revokes and re-enacts the designation of existing permit holders' parking places in Nelson Square, so as to accommodate four new raised speed tables in the part of Nelson Square that surrounds the Nelson Square Garden, in the London Borough of Southwark.

DRAFT



THE COUNCIL OF THE LONDON BOROUGH OF SOUTHWARK

TRAFFIC MANAGEMENT ORDER

2018 No. xxx

The London Borough of Southwark (Free parking places) (Disabled persons) (No. xx) Order 2018

Made: xx xxxx 2018

Coming into force: xx xxxx 2018

The council of the London Borough of Southwark, after consulting the Commissioner of Police of the Metropolis, in exercise of the powers conferred by sections 6 and 124 of and Part IV of Schedule 9 to the Road Traffic Regulation Act 1984^a, as amended, and of all other powers thereunto enabling, hereby make the following Order:

Citation and commencement

- 1.1 This Order may be cited as the Southwark (Free parking places) (Disabled persons) (No. xx) Order 2018 and shall come into force on xx xxxx 2018.

Interpretation

- 2.1 In this Order:-

"council" means the council of the London Borough of Southwark;

"enactment" means any enactment, whether public general or local, and includes any order, byelaw, rule, regulation, scheme or other instrument having effect by virtue of an enactment;

"the Order of 2013" means The London Borough of Southwark (Free parking places) (Disabled persons) (No. 1) Order 2013^b, as amended.

- 2.2 Any reference in this Order to any enactment shall be construed as a reference to that enactment as amended, applied, consolidated, re-enacted by or as having effect by virtue of any subsequent enactment.
- 2.3 Unless the context otherwise requires, any expression used in this Order which is also used in the Order of 2013 shall have the same meaning as in that Order.

Revocation

- 3.1 Without prejudice to the validity of anything done or to any liability incurred in respect of any act or omission before the coming into force of this Order, the designation by the Order of 2013 of the parking place numbered 692 in Schedule 1 therein is hereby revoked.

^a 1984 c.27

^b LBS 2013/059

Designation of parking places and application of the Order of 2013 thereto

- 4.1 Each area on a highway comprising the length of carriageway of a street specified in column 2 of the Schedule to this Order is designated as a parking place.
- 4.2 The provisions of the Order of 2013 (other than Articles 3.1 and 14.1) shall apply to each area described in the Schedule to this Order as if in those provisions any reference to a parking place shall include a reference to each area designated as a parking place by this Order and as if any reference to Schedule 1 to the Order of 2013 included a reference to the Schedule to this Order.

Placing of traffic signs, etc.

- 5.1 The council shall:-
- (a) place and maintain traffic signs indicating the limits of each parking place referred to in the Schedule to this Order;
 - (b) place and maintain in or in the vicinity of each parking place referred to in the Schedule to this Order traffic signs indicating that such parking places may be used during the permitted hours for the leaving only of the vehicles specified in Article 4.1 of the Order of 2013; and
 - (c) carry out such other works as is reasonably required for the purposes of the satisfactory operation of a parking place.

Dated this xx day of xxxx 201*

[signature here]

NICKY COSTIN
Parking and Network Management Business Unit Manager
Regulatory Services

SCHEDULE - UNLIMITED STAY DISABLED PERSONS PARKING PLACES

<i>No. of parking place (1)</i>	<i>Designated parking place (2)</i>	<i>Permitted hours (3)</i>
xxxx.	NELSON SQUARE the southern arm, the south side, from a point 17.1 metres east of the eastern kerb-line of vehicular access to Nos. 222-269 Helen Gladstone House, Nelson Square eastward for a distance of 6.6 metres.	At any time

EXPLANATORY NOTE

(This note is not part of the Order)

This order revokes and re-enacts, in a new location, an existing 'unlimited stay' disabled persons parking place in Nelson Square, so as to accommodate four new raised speed tables in the part of Nelson Square that surrounds the Nelson Square Garden, in the London Borough of Southwark.



THE COUNCIL OF THE LONDON BOROUGH OF SOUTHWARK

TRAFFIC MANAGEMENT ORDER

2018 No. xxx

The London Borough of Southwark (Waiting and loading restrictions)
(Amendment No. xx) Order 2018

Made: xx xxx 2018

Coming into force: xx xxx 2018

The council of the London Borough of Southwark, after consulting the Commissioner of Police of the Metropolis, in exercise of the powers conferred by sections 6 and 124 of and Part IV of Schedule 9 to the Road Traffic Regulation Act 1984^a, as amended, and of all other powers thereunto enabling, hereby make the following Order:

Citation and commencement

- 1.1 This Order may be cited as the London Borough of Southwark (Waiting and loading restrictions) (Amendment No. xx) Order 2018 and shall come into force on xx xxx 2018.

Interpretation

- 2.1 In this Order:-
 - "council" means the council of the London Borough of Southwark;
 - "enactment" means any enactment, whether public general or local, and includes any order, bye-law, rule, regulation, scheme or other instrument having effect by virtue of an enactment; and
 - "the Order of 2015" means the London Borough of Southwark (Waiting and loading restrictions) Consolidation Order 2015^b - as amended.
- 2.2 Any reference in this Order to any enactment shall be construed as a reference to that enactment as amended, applied, consolidated, re-enacted by or as having effect by virtue of any subsequent enactment.
- 2.3 Unless the context otherwise requires, any expression used in this Order which is also used in the Order of 2015 shall have the same meaning as in that Order.

^a 1984 c.27

^b LBS 2015/082

Amendment of the Order of 2015

- 3.1 Without prejudice to the validity of anything done, or to any liability incurred in respect of any act or omission before the coming into force of this Order, the Order of 2015 shall have effect as though for the item numbered 697 in Schedule 1 to that Order there was substituted the item similarly numbered and set out in columns 1, 2 and 3 of the Schedule to this Order.

Dated this xxxx day of xxxx 201*

[signature here]

NICKY COSTIN
Parking and Network Management Business Unit Manager
Regulatory Services

SCHEDULE – WAITING RESTRICTIONS (SUBSTITUTION)

<i>Item No. (1)</i>	<i>Street (2)</i>	<i>Prescribed hours (3)</i>
697.	NELSON SQUARE	
	(a) the east and south-east side	
	(i) between the southern kerb-line of Union Street and a point 11.5 metres south of that kerb-line;	At any time
	(ii) between a point 11.5 metres south of the southern kerb-line of Union Street and a point, on the eastern arm of Nelson Square, 10 metres south of the northern wall of Nos. 157-209 Applegarth House, Nelson Square;	8 am to 6.30 pm Monday to Friday 9.30 am to 12.30 pm Saturday
	(b) the eastern arm	
	(i) on the east side, between a point 22.7 metres north of the southern wall of Nos. 157-209 Applegarth House, Nelson Square and a point 11 metres north of that kerb-line;	At any time
	(ii) on the east side, between a point 11 metres north of the southern wall of Nos. 157-209 Applegarth House, Nelson Square and a point 10 metres north of that kerb-line;	8 am to 6.30 pm Monday to Friday 9.30 am to 12.30 pm Saturday
	(i) on the east side, between a point 22.7 metres north of the southern wall of Nos. 157-209 Applegarth House, Nelson Square and a point 11 metres north of that kerb-line;	At any time
	(ii) on the east side, between a point 11 metres north of the southern wall of Nos. 157-209 Applegarth House, Nelson Square and a point 10 metres north of that kerb-line;	8 am to 6.30 pm Monday to Friday 9.30 am to 12.30 pm Saturday
	(c) the west and north-west side	
	(i) between the southern kerb-line of union Street and a point 4 metres south of that kerb-line;	At any time
	(ii) between a point 11.5 metres south of the southern kerb-line of Union Street and a point;	8 am to 6.30 pm Monday to Friday 9.30 am to 12.30 pm Saturday
	(b) the west side,	At any time

(c) so much else as does not lie within those lengths of street specified in sub-paragraphs (a) and (b) above.

8 am to 6.30 pm
Monday to Friday
9.30 am to 12.30 pm
Saturday

(i) between the south-eastern kerb-line of Rotherhithe Street and a point 9 metres south-east of that kerb-line;

At any time

EXPLANATORY NOTE

(This note is not part of the Order)

This Order: -

(a) amends the definitions of existing 'single yellow line' and 'at any time' waiting restrictions in Nelson Square; and

(b) adds new lengths of 'single yellow line' and 'at any time' waiting restrictions in Nelson Square,

so as to accommodate four new raised speed tables in the part of Nelson Square that surrounds the Nelson Square Garden, in the London Borough of Southwark.