

Public notice

Great Guildford Street Improvements

*The London Borough of Southwark (Loading bays) (No. *) Order 201**

*The London Borough of Southwark (Parking places) (CPZ 'C1') (No. *) Order 201**

*The London Borough of Southwark (Waiting and loading restrictions) (Amendment No. *) Order 201**

1. Southwark Council hereby GIVES NOTICE that it proposes to make the above orders under sections 6, 45, 46, 49 and 124 of and Part IV of Schedule 9 to the Road Traffic Regulation Act 1984¹, as amended.
2. The effect of the orders would be, in GREAT GUILDFORD STREET:-
 - (a) to provide a new loading bay, 14.5 metres in length, on the north-east side opposite The Grove, in which vehicles may load or unload Monday – Saturday between the hours of 7 am and 7 pm (max 40 mins stay, no return within 2 hours);
 - (b) on the north-east side, to replace an existing pay parking place with a loading bay (as described above), and to relocate north-westward, and increase in length to 23 metres, an existing pay parking place - *net loss of a pay parking place for approximately one vehicle in Great Guildford Street*; and
 - (c) to amend double yellow line 'at any time' and single yellow line waiting restrictions on the north-east side, between its junction with Southwark Street and its junction with Southwark Bridge Road.
3. Southwark Council hereby GIVES FURTHER NOTICE under sections 90A to 90I of the Highways Act 1980² and in accordance with the provisions of the Highways (Road humps) Regulations 1999³ and the Highways (Traffic calming) Regulations 1999⁴, the installation of a speed table of flat-top construction, having a maximum height of 100 millimetres and covering the entire width of the carriageway in GREAT GUILDFORD STREET, extending from a point 20 metres north-west of the northern kerb-line of America Street, north-westwards for a distance of 6.5 metres.
Note: these measures would replace any existing speed tables, speed cushions or road humps at or in the immediate vicinity of the above locations.
4. For more information about these proposals please contact Ioannis Lampropoulos of the council's Highways – Network Development team by telephone on 020 7525 4566 or by e-mail: Highways@southwark.gov.uk
5. Copies of this notice, the proposed orders, a statement of the council's reasons for making the orders and a plan of the proposals may be found online at www.southwark.gov.uk/trafficorders or by scanning the QR code below, paper copies may be obtained from or viewed at Highways, Environment and Social Regeneration, 3rd floor hub 2, 160 Tooley Street, London SE1 2QH. Please call 020 7525 3497 for details.
6. Anyone wishing to object to or make any other representations regarding the proposal, may use the form labelled 'Parking - Road traffic and highway schemes - responding to statutory consultation notices' at www.southwark.gov.uk/statutoryconsultationnotices or send a statement in writing to: Traffic Order consultations, Highways, Southwark Council, Environment and Social Regeneration, P.O. Box 64529, London SE1P 5LX or by e-mail to traffic.orders@southwark.gov.uk quoting reference 'TMO1819-007 Great Guildford St' by 15 June 2018. Please note that if you wish to object to this proposal you must state the grounds on which your objection is made.
7. When making an objection or representation, please be aware that this may be communicated to other people who may be affected. Information provided in response to this consultation, including in some circumstances personal information, may also be subject to publication or disclosure under the requirements of current access to information legislation.

Dated 24 May 2018

Nicky Costin

Parking and Network Management Business Unit Manager, Regulatory Services

¹ 1984 c.27

² 1980 c.66

³ SI 1999/1065

⁴ SI 1999/1026



Statement of reasons

Great Guildford Street Improvements

*The London Borough of Southwark (Loading bays) (No. *) Order 201**

*The London Borough of Southwark (Parking places) (CPZ'C1') (No. *) Order 201**

*The London Borough of Southwark (Waiting and loading restrictions) (Amendment No. *) Order 201**

Council officers of the Highways Division have been working closely with the Regeneration Division officers, to make improvements to the areas of Cathedrals Ward – in Great Guildford Street and Keppel Row (between Southwark Street and America Street).

To improve the areas accessibility, safety and aesthetics for residents and visitors to the area; the following improvements are proposed:

- to install a new raised speed table of flat-top design, across the full width of the carriageway in Great Guildford Street at its junction with Keppel Row;
- to remove and replace an existing pay parking place with a new loading bay; and
- to relocate and increase in length an existing pay parking place, so as to reduce the loss of pay parking places.

Net loss of parking of a pay parking place for approximately one vehicle in Great Guildford Street.

Dated 24 May 2018

For more information on the design of the scheme, contact:-

Ioannis Lampropoulos

Engineer – Network Development

Highways

020 7525 4566

Highways@southwark.gov.uk

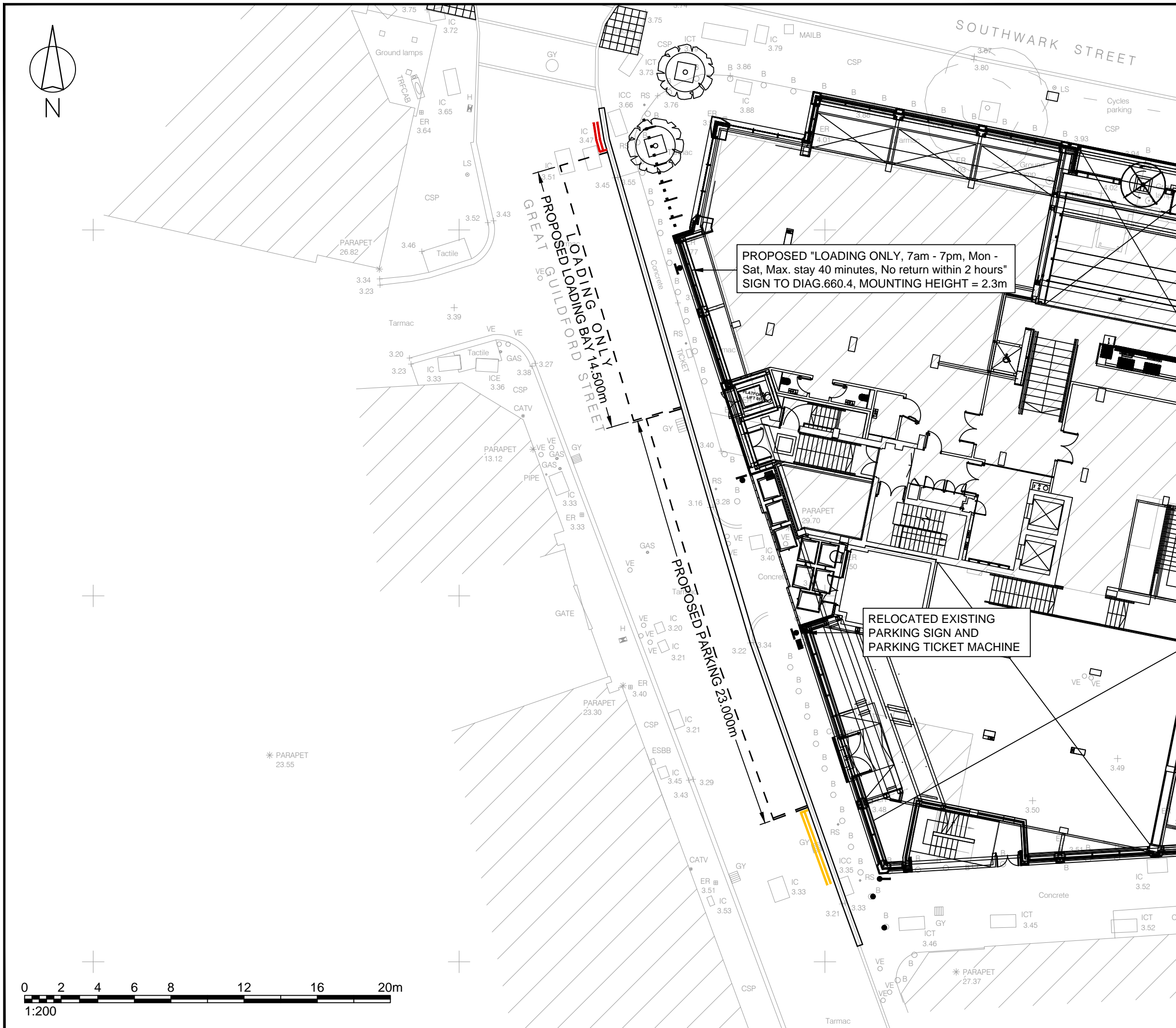
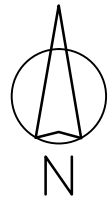

Rev	Details	Drawn	Checked	Date
A	Revised to Southwark LB design review of 13.01.2016	DW	BS	18.01.2016
B	Revised to Southwark LB comments of 04.04.2016	DW	BS	16.05.2016
C	Proposed ground floor layout added	DW	-	13.12.2016
D	As built issue	DW	AM	17.04.2018
E	Length of proposed parking reduced to 23m	DW	AM	25.04.2018
F	Yellow lines amended	DW	AM	04.05.2018

NOTES :

GENERAL

1. Do not scale from this drawing.
2. All dimensions are in metres, unless stated otherwise.
3. All coordinates are based on the topographical survey stations information.
4. This drawing to be read in conjunction with other contract drawings.
5. This drawing to be read & printed in colour.

DISCLAIMERS

1. The topographical survey has been provided by Murphy Surveys (drawing No. MSL10160-T), and TTP shall not be liable for any inaccuracies or deficiencies.

Client
Aberdeen Asset

Project
61 Southwark Street

Drawing Title
**Great Guildford Street
S278 Highway Works
Proposed Traffic
Management Plan**

Scale **1:200** Size **A3**

Drawn **DW** 21.09.2015
Checked **BS** 21.09.2015



111 - 113 Great Portland Street
London
W1W 6QQ
Tel. No. 0207 1000 753

Drawing Number **2014-1789-DD-211** Rev **F**

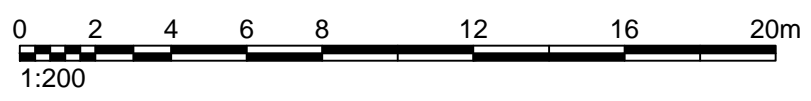

C:\USERS\CADSOFT SERVICES\LT\DESKTOP\NEW FOLDER\NEW FOLDER\2014-1789-DD-211_F - GREAT GUILDFORD STREET, PROPOSED TRAFFIC MANAGEMENT PLAN.DWG



THE COUNCIL OF THE LONDON BOROUGH OF SOUTHWARK

TRAFFIC MANAGEMENT ORDER

2018 No. XXX

The London Borough of Southwark (Parking places) (CPZ 'C1') (No. **) Order 201*

Made: XXXX

Coming into force: XXXX

The council of the London Borough of Southwark, after consulting the Commissioner of Police of the Metropolis, in exercise of the powers conferred by sections 45, 46, 49 and 124 of and Part IV of Schedule 9 to the Road Traffic Regulation Act 1984^a, as amended, and of all other powers thereunto enabling, hereby make the following Order:

Citation and commencement

- 1.1 This Order may be cited as the London Borough of Southwark (Parking places) (CPZ 'C1') (No. **) Order 201* and shall come into force on xxxx.

Interpretation

- 2.1 In this Order:

“council” means the council of the London Borough of Southwark;

“enactment” means any enactment, whether public general or local, and includes any order, bye-law, rule, regulation, scheme or other instrument having effect by virtue of an enactment; and

“the Order of 2012” means The London Borough of Southwark (Parking places) (CPZ 'C1') (No. 1) Order 2012^b.

- 2.2 Any reference in this Order to any enactment shall be construed as a reference to that enactment as amended, applied, consolidated, re-enacted by or as having effect by virtue of any subsequent enactment.
- 2.3 Unless the context otherwise requires, any expression used in this Order which is also used in the Order of 2012 shall have the same meaning as in that Order.

^a 1984 c.27

^b LBS 2012/055

Revocation

- 3.1 Without prejudice to the validity of anything done, or to any liability incurred in respect of any act or omission before the coming into force of this Order, the designation by the Order of 2012 of the parking places numbered 7 and 8 in Schedule 2 therein, is hereby revoked.

Designation of parking places and application of the Order of 2012 thereto

- 4.1 Each area on a highway comprising the length of carriageway of a street specified in columns (2) and (3) of a Schedule to this Order and bounded on one side of that length by the edge of the carriageway, is designated as a parking place.
- 4.2 The provisions of the Order of 2012 (other than Articles 3 and 15) shall apply to the areas described in each Schedule to this Order as if in those provisions any reference to a designated parking place or to a parking place shall include a reference to an area designated as a parking place by this Order and as if any reference to Schedule 2 to the Order of 2012 included a reference to the Schedule to this Order.

Placing of traffic signs, etc.

- 5.1 The council shall:-
- (a) place and maintain traffic signs indicating the limits of each parking place referred to in Schedule 1 or 2 to this Order;
 - (b) place and maintain in or in the vicinity of each parking place referred to in the Schedule 1 or 2 to this Order traffic signs indicating that such parking places may be used during the permitted hours for the leaving only of the vehicles specified in Articles 4.1 and 4.3 or 4.4, as the case may be, of the Order of 2012;
 - (c) carry out such other works as is reasonably required for the purposes of the satisfactory operation of a parking place.

Dated this xx day of xxxx 2018



NICKY COSTIN
Parking and Network Management Business Unit Manager
Regulatory Services

SCHEDULE – PAY PARKING PLACES

<i>No. of parking place (1)</i>	<i>Designated parking place (2)</i>	<i>Permitted hours (3)</i>	<i>Maximum parking period (4)</i>	<i>Minimum return interval (5)</i>
**.	GREAT GUILDFORD STREET the north-east side, from a point 24.7 metres south-east of the southern kerb-line of Southwark Street south-eastward for a distance of 23 metres.	8 am to 6.30 pm Monday to Friday 9.30 am to 12.30 pm Saturday	2 hours	-

EXPLANATORY NOTE

(This note is not part of the Order)

This order revokes and re-enacts the designation of existing pay parking places (increasing the length of one pay parking place), in Great Guildford Street in the London Borough of Southwark so as to accommodate the provision of a new loading bay and replace as much as possible the loss of pay parking places.



THE COUNCIL OF THE LONDON BOROUGH OF SOUTHWARK

TRAFFIC MANAGEMENT ORDER

2018 No. xxx

The London Borough of Southwark (Loading bays) (No. **) Order 201*

Made: xx xx 2018

Coming into force: xx xx 2018

The council of the London Borough of Southwark, after consulting the Commissioner of Police of the Metropolis, in exercise of the powers conferred by sections 6 and 124 of and Part IV of Schedule 9 to the Road Traffic Regulation Act 1984^a, as amended, and of all other powers thereunto enabling, hereby make the following Order:

Citation and commencement

- 1.1 This Order may be cited as The London Borough of Southwark (Loading bays) (No. **) Order 2018 and shall come into force on xx x xxx 2018.

Interpretation

- 2.1 In this Order:-

"council" means the council of the London Borough of Southwark;

"enactment" means any enactment, whether public general or local, and includes any order, bye-law, rule, regulation, scheme or other instrument having effect by virtue of an enactment; and

"the Order of 2016" means the London Borough of Southwark (Loading bays) (No. 1) Order 2016^b.

- 2.2 Any reference in this Order to any enactment shall be construed as a reference to that enactment as amended, applied, consolidated, re-enacted by or as having effect by virtue of any subsequent enactment.
- 2.3 Unless the context otherwise requires, any expression used in this Order which is also used in the Order of 2016 shall have the same meaning as in that Order.

^a 1984 c.27

^b LBS 2016/005

Designation of loading bay and application of the Order of 2016 thereto

- 3.1 Each area on a highway comprising the length of carriageway of a street specified in column 2 of the Schedule to this Order and bounded on one side of that length by the edge of the carriageway, is designated as a loading bay.
- 3.2 The provisions of the Order of 2016 (other than Articles 3.1 and 12.1) shall apply to each area designated as a loading bay by this Order as if in those provisions any reference to a loading bay shall include a reference to each area designated as a loading bay by this Order and as if any reference to Schedule 1 to the Order of 2016 included a reference to the Schedule to this Order.

Placing of traffic signs etc.

- 4.1 The council shall:-
- (a) place and maintain traffic signs indicating the limits of each loading bay referred to in the Schedule to this Order;
 - (b) place and maintain in or in the vicinity of each loading bay referred to in the Schedule to this Order, traffic signs indicating that such a loading bay may be used during the permitted hours for the leaving only of the vehicles referred to in Article 4.1 of the Order of 2016; and
 - (c) carry out such other work as is reasonably required for the purposes of the satisfactory operation of a loading bay.

Dated this xx day of xxx 2018



NICKY COSTIN
Parking and Network Management Business Unit Manager
Regulatory Services

SCHEDULE - LOADING BAYS

<i>No. of loading bay (1)</i>	<i>Designated loading bay (2)</i>	<i>Permitted hours (3)</i>	<i>Maximum loading period (4)</i>	<i>Minimum return interval (5)</i>
***.	GREAT GUILDFORD STREET the north-east side, from a point 10.2 metres south-east of the southern kerb- line of Southwark Street south-eastward for a distance of 14.5 metres.	7 am to 7 pm Monday - Saturday	40 minutes	2 hours

EXPLANATORY NOTE

(This note is not part of the Order)

This Order designates a new loading bay in Great Guildford Street in the London Borough of Southwark.



THE COUNCIL OF THE LONDON BOROUGH OF SOUTHWARK

TRAFFIC MANAGEMENT ORDER

2018 No. xxx

The London Borough of Southwark (Waiting and loading restrictions)
(Amendment No. xx) Order 2018

Made: xx

Coming into force: xx

The council of the London Borough of Southwark, after consulting the Commissioner of Police of the Metropolis, in exercise of the powers conferred by sections 6 and 124 of the Road Traffic Regulation Act 1984^a, as amended, and of all other powers thereunto enabling, hereby make the following Order:

Citation and commencement

- 1.1 This Order may be cited as the London Borough of Southwark (Waiting and loading restrictions) (Amendment No. xx) Order 2018 and shall come into force on xxxx.

Interpretation

- 2.1 In this Order:-

"council" means the council of the London Borough of Southwark;

"enactment" means any enactment, whether public general or local, and includes any order, bye-law, rule, regulation, scheme or other instrument having effect by virtue of an enactment; and

"the Order of 2015" means the London Borough of Southwark (Waiting and loading restrictions) Consolidation Order 2015^b.

- 2.2 Any reference in this Order to any enactment shall be construed as a reference to that enactment as amended, applied, consolidated, re-enacted by or as having effect by virtue of any subsequent enactment.
- 2.3 Unless the context otherwise requires, any expression used in this Order which is also used in the Order of 2015 shall have the same meaning as in that Order.

^a 1984 c.27

^b LBS 2015/082

Amendment of the Order of 2015

- 3.1 Without prejudice to the validity of anything done, or to any liability incurred in respect of any act or omission before the coming into force of this Order, the Order of 2015 shall have effect as though for the items numbered 435 in Schedule 1 to that Order there were substituted the items similarly numbered and set out in columns 1, 2 and 3 of the Schedule to this Order.

Dated this xx day of xx 2018

A handwritten signature in black ink, appearing to read "Nicky Costin". The signature is written in a cursive, slightly slanted style.

NICKY COSTIN
Parking and Network Management Business Unit Manager
Regulatory Services

SCHEDULE – WAITING RESTRICTIONS (SUBSTITUTION)

<i>Item No. (1)</i>	<i>Street (2)</i>	<i>Prescribed hours (3)</i>
435.	GREAT GUILDFORD STREET	
	(a) the north-east and east side	
	(i) between the southern kerb-line of Sumner Street and a point 8.5 metres south-east of that kerb-line;	At any time
	(ii) between a point 8.5 metres south-east of the southern kerb-line of Sumner Street and a point 47 metres south-east of that kerb-line;	8 am to 6.30 pm Monday to Friday 9.30 am to 12.30 pm Saturday
	(iii) between a point 47 metres south-east of the southern kerb-line of Sumner Street and a point 49 metres north-west of the northern kerb-line of Southwark Street;	At any time
	(iv) between a point 49 metres north-west of the northern kerb-line of Southwark Street and a point 12.6 metres north-west of that kerb-line;	8 am to 6.30 pm Monday to Friday 9.30 am to 12.30 pm Saturday
	(v) between a point 9.2 metres south-east of the southern kerb-line of Southwark Street and a point 10.2 metres south of that kerb-line;	At any time
	(vi) between a point 47.8 metres south-east of the southern kerb-line of Southwark Street and a point 17 metres south of the southern kerb-line build-out of Union Street;	At any time
	(vii) between a point 17 metres south of the southern kerb-line build-out of Union Street and the north-western kerb-line of Southwark Bridge Road;	8 am to 6.30 pm Monday to Friday 9.30 am to 12.30 pm Saturday
	(b) the south-west and west side	
	(i) between the southern kerb-line of Sumner Street and a point 9.6 metres north-west of the northern kerb-line of Southwark Street;	At any time
	(ii) between a point 8.8 metres south-east of the southern kerb-line of Southwark Street and a point 16.5 metres south of the southern kerb-line build-out of Union Street;	At any time
	(iii) between a point 16.5 metres south of the southern kerb-line build-out of Union Street and the north-western kerb-line of Southwark Bridge Road.	8 am to 6.30 pm Monday to Friday 9.30 am to 12.30 pm Saturday

EXPLANATORY NOTE

(This note is not part of the Order)

This Order amends existing lengths of 'at any time' waiting restrictions in Great Guildford Street, in the London Borough of Southwark, so as to accommodate the provision of a new loading bay and the relocation and increase in length of an existing pay parking place.