

# Public notice

## Balfour Street redevelopment

*The London Borough of Southwark (Cycle Hangars) (Amendment (No. \*) Order 201\**

*The London Borough of Southwark (Free parking places) (No. \*) Order 201\**

*The London Borough of Southwark (Free Parking Places) (Disabled Persons) (No. \*) Order 201\**

*The London Borough of Southwark (Parking places) (Car club) (No. \*) Order 201\**

*The London Borough of Southwark (Parking places) (CPZ 'M1') (No. \*) Order 201\**

*The London Borough of Southwark (Free parking places) (No. \*) Order 201\**

*The London Borough of Southwark (Parking Places) (London Cycle Hire Scheme) (Amendment No. \*) Order 201\**

*The London Borough of Southwark (Prescribed Route) (Victory Place) (No. \*) Order 201\**

*The London Borough of Southwark (Prohibition of stopping on entrance markings) (Amendment No. \*) Traffic Order 201\**

*The London Borough of Southwark (Waiting and loading restrictions) (Amendment (No. \*) Order 201\**

1. Southwark Council hereby GIVES NOTICE that it proposes to make the above orders under sections 6, 45, 46, 49 and 124 of and Part IV of Schedule 9 to the Road Traffic Regulation Act 1984<sup>1</sup>, as amended.

2. The effect of the orders would be:-

- (a) in BALFOUR STREET: (i) to remove existing 'M1' permit-holders parking bays on the north-east side: outside Nos. 71 and 73, outside No. 77, outside Nos. 85 to 89 and between Henshaw Street and Chatham Street; and on the south-west side, opposite Nos. 85 to 89, and opposite Nos. 93 to 95 Balfour Street; (ii) to remove an existing 'short stay' parking bay on the east side, outside No. 85 Balfour Street; (iii) to split an existing 'M1' permit-holders parking bay on the north-east side between Chatham Street and Rodney Road, creating two permit parking bays each of 11 metres in length, separated by 8.3 metres of 'at any time' waiting restrictions; (iv) to reduce in length an existing 'M1' permit-holders parking bay, to 34 metres, on the south-west side between the private road New Paragon Walk and Rodney Road; (v) to re-locate an existing 'unlimited stay' disabled persons' parking place from the north-east side, outside No. 75 Balfour Street, to the south-west side, from a point 14.6 metres south of the southern kerb-line of Munton Road southward for a distance of 6.6 metres; (vi) to introduce 'at any time' waiting restrictions on any parts in Balfour Street that were previously permit parking spaces; (vii) to redefine existing lengths of 'at any time' waiting restrictions in Balfour Street to accommodate new kerb-line buildouts; and (viii) to provide a new cycle hangar in the footway of Balfour Street, on the south-west side at its junction with Victory Place;
- (b) in CHATHAM STREET: (i) to redefine the existing length of 'at any time' waiting restrictions on the north-west side; and (ii) to redefine the existing 'M1' permit-holders parking bay on the north-west side at its junction with Balfour Street to accommodate the new kerb-line buildouts in Balfour Street;
- (c) in HENSHAW STREET: (i) to redefine the existing lengths of 'at any time' waiting restrictions on both sides; and (ii) to redefine the existing 'M1' permit-holders parking bay on both sides at its junction with Balfour Street to accommodate the new kerb-line buildouts in Balfour Street;
- (d) in JOHN MAURICE CLOSE, to redefine the existing lengths of 'at any time' waiting restrictions on both sides at its junction with Balfour Street to accommodate the new kerb-line buildouts in Balfour Street;
- (e) in RODNEY ROAD: (i) to redefine the existing car club parking bay on the north-east side to accommodate the new kerb-line buildouts in Balfour Street; (ii) to re-locate an existing 'limited stay' disabled persons' parking place on the south-west side, from outside No. 98 Rodney Road south-eastward to a location *outside* No. 100 Rodney Road; and (iii) to reduce in length by 9.6 metres, an existing 'short stay' parking place on the south-west side to accommodate the new 'zebra' pedestrian crossing;
- (f) in STEAD STREET, to redefine the existing length of 'at any time' waiting restrictions on the north-west side at its junction with Rodney Road to accommodate the new kerb-line buildouts in Rodney Road;
- (g) in VICTORY PLACE: (i) to formalise an existing London cycle hire scheme docking station in the carriageway on the north-west side (of which only pedal cycles are permitted to enter and proceed); (ii) to redefine an existing length of 'school keep clear' restrictions on the north-west side to accommodate the new kerb-line buildouts in Balfour Street; (iii) to formally prohibit all vehicles except pedal cycles from entering into that part of Victory Place, from its junction with Rodney Road to a point 12.8 metres south-west of the south-western wall of No. 4 Victory Place south-westward for a distance of 29 metres (*this measure is physically enforced with removable bollards*); and (iv) to formalise a length of 'at any time'

---

<sup>1</sup> 1984 c.27

waiting restrictions on the south-east side' - to restrict waiting 'at any time' in Victory Place on both sides; and

(h) in WADDING STREET, to redefine the existing lengths of 'at any time' waiting restrictions on both sides at its junction with Rodney Road to accommodate the new kerb-line buildouts in Rodney Road.

3. Southwark Council hereby GIVES FURTHER NOTICE that it has approved under section 23 of the Road Traffic Regulation Act 1984, the provision of a raised 'zebra' pedestrian crossing at the following location:- RODNEY ROAD, the centre of which would be located 6 metres south-eastwards of the south-eastern kerb-line of Stead Street;

Zig-zag markings, on which vehicles would be prohibited from stopping at all times would be laid; (i) on the north-east side of the road for a distance of 9 metres north-west of and 13 metres south-east of this crossing, and (ii) on the south-west side of the road for a distance of 9 metres north-west of and 13 metres south-east of this crossing.

4. Southwark Council hereby GIVES FURTHER NOTICE under sections 90A to 90I of the Highways Act 1980<sup>2</sup> and in accordance with the provisions of the Highways (Road humps) Regulations 1999<sup>3</sup> and the Highways (Traffic calming) Regulations 1999<sup>4</sup>, propose to construct speed tables of flat-top construction having a maximum height of 100 millimetres and covering the entire width of the carriageway, at the following locations:-

BALFOUR STREET across its junction with JOHN MAURICE CLOSE and VICTORY PLACE – extending from a point 1 metre south-east of the common boundary of Nos. 81 and 83 Balfour Street southwards to a point 9.2 metres north-west of the common boundary of Nos. 85 and 87 Balfour Street; from the north-eastern kerb-line buildout of Balfour Street the raised table extends into JOHN MAURICE CLOSE north-eastwards for a distance of 10 metres; the raised table extends into VICTORY PLACE south-westwards for a distance of 33 metres from a point directly opposite where the raised table ramp ends in John Maurice Close;

BALFOUR STREET across its junction with HENSHAW STREET – extending from a point 1.7 metres south-east of the common boundary of Nos. 89 and 91 Balfour Street south-eastwards to a point 6.2 metres south-east of the south-eastern kerb-line buildout of Henshaw Street; from the north-eastern kerb-line buildout of Balfour Street the raised table extends into HENSHAW STREET north-eastwards for a distance of 5.5 metres;

BALFOUR STREET across its junction with CHATHAM STREET – extending from a point 6.7 metres north-west of the north-western kerb-line buildout of Chatham Street south-eastwards to a point 17.5 metres; from the north-eastern kerb-line buildout of Balfour Street the raised table extends into CHATHAM STREET north-eastwards for a distance of 6.8 metres;

MUNTON ROAD – extending from a point 2.3 metres north-east of the eastern-most wall of Nos. 1-20 Edison House, Rockingham Estate, New Kent Road south-westwards for a distance of 5.3 metres;

ORB STREET – extending from a point 2.1 metres south-east of the south-eastern kerb-line of Stead Street south-eastwards for a distance of 5.5 metres; and

RODNEY ROAD across its junction with BALFOUR STREET, STEAD STREET and WADDING STREET – at the 'zebra' pedestrian crossing location referred to within item 3 preceding, extending from a point 12.3 metres south-east of the south-eastern kerb-line buildout of Stead Street north-westwards for a distance of 49 metres; from the north-eastern kerb-line buildout of Rodney Road the raised table extends into BALFOUR STREET north-eastwards then north-westwards for a distance of 13.5 metres; from the south-western kerb-line buildout of Rodney Road the raised table extends into STEAD STREET south-westwards for a distance of 7 metres; and from the south-western kerb-line buildout of Rodney Road the raised table extends into WADDING STREET south-westwards for a distance of 7 metres.

*Note: these measures would replace any existing speed tables, speed cushions or road humps at or in the immediate vicinity of the above locations.*

5. For more information about these proposals please contact Alexander Rozema of the council's Highways – Transport Projects team by telephone on 020 7525 0963, or by e-mail [Highways@southwark.gov.uk](mailto:Highways@southwark.gov.uk) .

---

<sup>2</sup> 1980 c.66

<sup>3</sup> S.I. 1999/1065

<sup>4</sup> S.I. 1999/1026

6. Copies of this notice, the proposed orders, a statement of the council's reasons for making this change and plans may be found online at [www.southwark.gov.uk/trafficorders](http://www.southwark.gov.uk/trafficorders) or by scanning the QR code below, paper copies may be obtained from or viewed at Highways, 3rd floor hub 2, 160 Tooley Street, London SE1 2QH. Please call 020 7525 3497 for details.
7. Anyone wishing to object to or make any other representations regarding the proposal, may use the form labelled '*Parking - Road traffic and highway schemes - responding to statutory consultation notices*' at [www.southwark.gov.uk/statutoryconsultationnotices](http://www.southwark.gov.uk/statutoryconsultationnotices) or send a statement in writing to: Traffic Order Consultations, Highways, Southwark Council, Environment and Social Regeneration, P.O. Box 64529, London SE1P 5LX or by e-mail to [traffic.orders@southwark.gov.uk](mailto:traffic.orders@southwark.gov.uk) quoting reference '*Balfour Street*' by 8 June 2018. Please note that if you wish to object to this proposal you must state the grounds on which your objection is made.
8. When making an objection or representation, please be aware that this may be communicated to other people who may be affected. Information provided in response to this consultation, including in some circumstances personal information, may also be subject to publication or disclosure under the requirements of current access to information legislation.

Dated 17 May 2018

**Nicky Costin**

Parking and Network Management Business Unit Manager, Regulatory Services



# Statement of reasons

## Balfour Street redevelopment



*The London Borough of Southwark (Cycle Hangars) (Amendment (No. \*) Order 201\**  
*The London Borough of Southwark (Free parking places) (No. \*) Order 201\**  
*The London Borough of Southwark (Free Parking Places) (Disabled Persons) (No. \*) Order 201\**  
*The London Borough of Southwark (Parking places) (Car club) (No. \*) Order 201\**  
*The London Borough of Southwark (Parking places) (CPZ 'M1') (No. \*) Order 201\**  
*The London Borough of Southwark (Free parking places) (No. \*) Order 201\**  
*The London Borough of Southwark (Parking Places) (London Cycle Hire Scheme) (Amendment No. \*) Order 201\**  
*The London Borough of Southwark (Prescribed Route) (Victory Place) (No. \*) Order 201\**  
*The London Borough of Southwark (Prohibition of stopping on entrance markings) (Amendment No. \*) Traffic Order 201\**  
*The London Borough of Southwark (Waiting and loading restrictions) (Amendment (No. \*) Order 201\**

In line with Southwark Council's commitment to make its streets safer and more accessible to all; local residents and businesses were consulted (between early June 2017 through to 24 July 2017) on their views about changes to improve Balfour Street, located in the East Walworth Ward of the London Borough of Southwark.

The redevelopments will cover the full length of Balfour Street from its junction with New Kent Road and will include improvements to the Rodney Road junction. The aim is to create a public space that is inviting and both pedestrian and cycle friendly; and improve road-safety for all by reducing vehicle traffic speeds. Recent redevelopments to Victory Place are also being formalised, the existing features being amended and formalised are: the prohibition of motor vehicles into part of Victory Place ('cycle only' signs and removable bollards are in place); a London Cycle Hire scheme docking bay; 'at any time' waiting restrictions on both sides at its junction with Balfour Street; and a 'school keep clear' restriction.

The improvements to Balfour Street area would include:

- Resurfacing the footway with high quality paving in the area.
- Widening the footways throughout Balfour Street and at Rodney Road junction. Widening of the footway results in net reduction of 27 resident parking places. These permit-holder and 'short stay' parking places are under-used and there is sufficient spare capacity remaining in Balfour Street and in surrounding roads for residents and visitors to park.
- Install indented parking bays to provide more protection for parked vehicles in Balfour Street.
- Enhance street lighting and include electric car charging posts in Balfour Street.
- Install a secure bicycle storage hangar on the footway of Balfour Street, near its junction with Victory Place. Residents and local business owners were particularly supportive of efforts to make this area safer for cyclists.
- Provide new trees and improve conditions for existing trees in the area.
- Install traffic calming measures (raised speed tables) in Balfour Street at its junctions with John Maurice Close, Henshaw Street, and Chatham Street; in Munton Road; and at Rodney Road junction.
- Transform the junction with Balfour Street and Rodney Road to reduce vehicle speeds, shorten pedestrian crossing distances and improve road safety for all users. The existing 'zebra' pedestrian crossing in Rodney Road will be moved to provide a more direct link to Nursery Row Park and re-installed as a raised 'zebra' pedestrian crossing.

For more information contact:-

**Alexander Rozema**  
Principal Project Manager  
Highways – Transport Projects  
020 7525 0963  
[highways@southwark.gov.uk](mailto:highways@southwark.gov.uk)

**KEY MAP:**

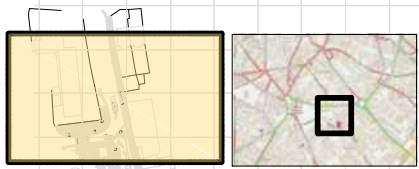

**NOTES:**

1. Dimensions in meters, unless otherwise stated.
2. This drawing should be read in conjunction with other relevant engineering details, drawings & specifications.
3. In case of any discrepancy, the bounded prevails over what is drawn.
4. Any discrepancies should be reported to the design engineer immediately, so that clarification can be sought prior to the commencement of works.
5. The dimensions must be rectified on site before construction.
6. All works are to be in accordance with Southwark borough council specification and standards.

**EXISTING**

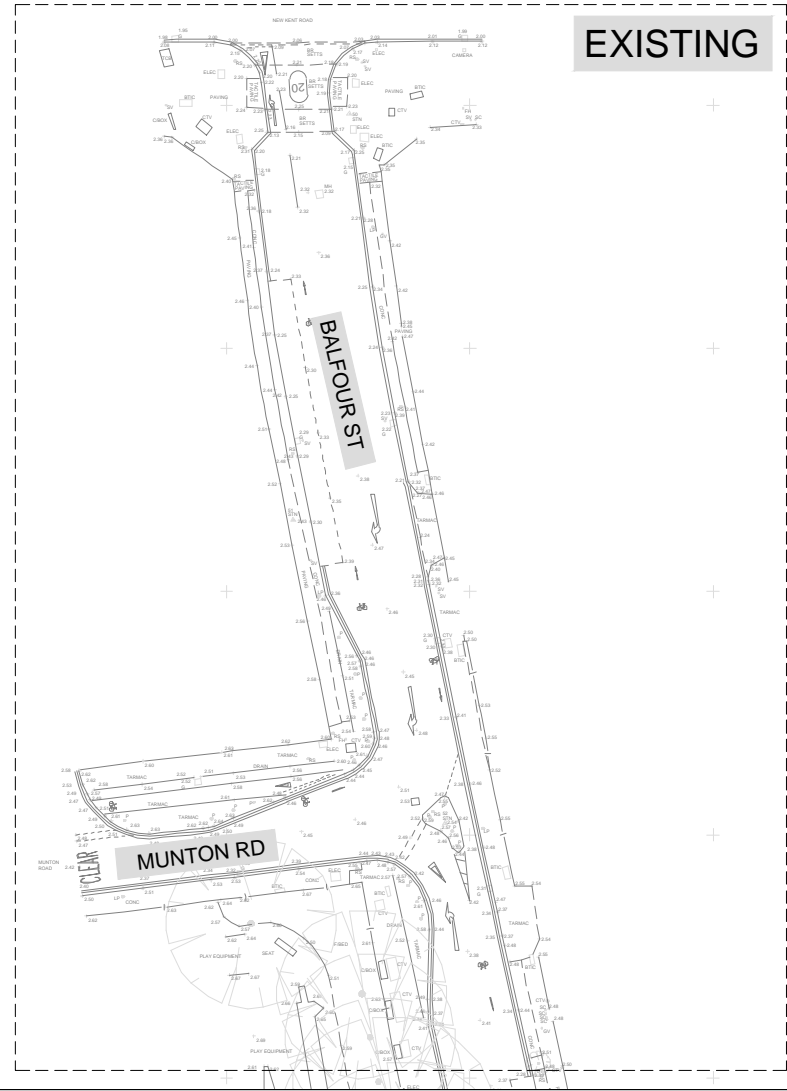

**PROPOSED**



Rev	Date	Description	Drn	Chk	App
00	16/05/18	Draft	IG	AR	RW

Project		Community council SOUTHWARK - BERMONDSEY & OLD SOUTHWARK				
Drawing Title		Ward(s) EAST WALWORTH				
MUNTON RD JUNCTION		Date	Scale	Drn	Rev	App
		16/05/18	N/A	IG	AR	RW
		Drawing number	Status			
		BS-s5	00			



**Highways Division  
Transport projects  
Minor Works**

Environment and Social  
Regeneration  
Floor 3, Hub 2  
160 Tooley Street  
PO Box 64529  
London SE1P 5LX

**KEY MAP:**



**NOTES:**

1. Dimensions in meters, unless otherwise stated.
2. This drawing should be read in conjunction with other relevant engineering details, drawings & specifications.
3. In case of any discrepancy, the bounded prevails over what is drawn.
4. Any discrepancies should be reported to the design engineer immediately, so that clarification can be sought prior to the commencement of works.
5. The dimensions must be rectified on site before construction.
6. All works are to be in accordance with Southwark borough council specification and standards.

**EXISTING**

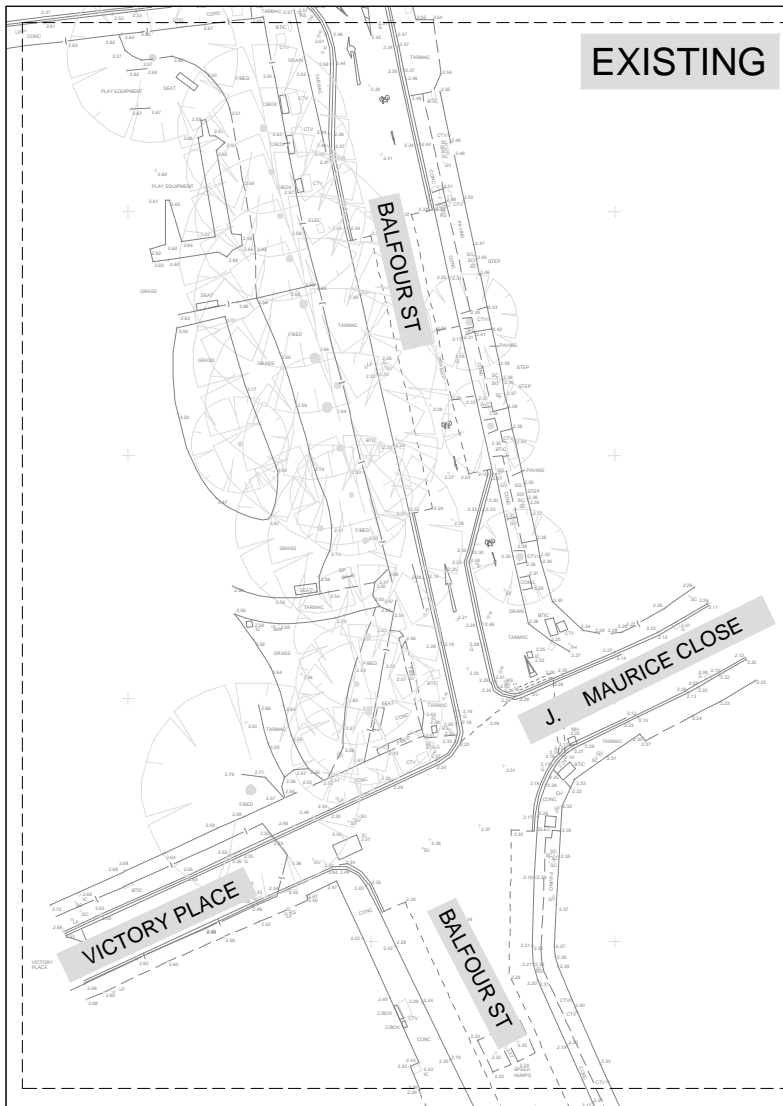

**PROPOSED**

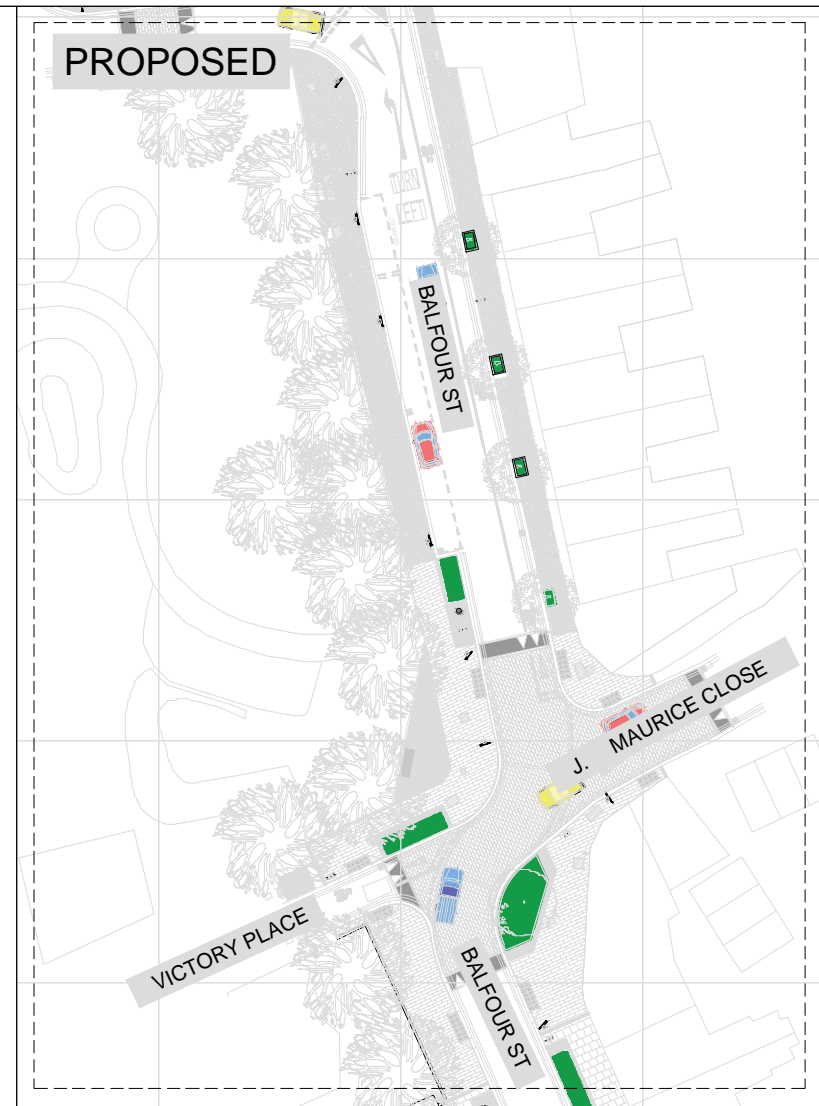

Rev	Date	Description	Drm	Chk	App
00	16/05/18	Draft	IG	AR	RW

Project						Community council SOUTHWARK - BERMONDSEY & OLD SOUTHWARK							
BALFOUR STREET SCHEME						Ward(s) EAST WALWORTH							
						Date	Scale	Drm	Rev	App			
Drawing Title J MAURICE CLOSE JUNCTION						16/05/18	N/A	IG	AR	RW			
						Drawing number BS-s4			Status 00				



**Highways Division  
Transport projects  
Minor Works**

Environment and Social  
Regeneration  
Floor 3, Hub 2  
160 Tooley Street  
PO Box 64529  
London SE1P 5LX

**KEY MAP:**



**NOTES:**

1. Dimensions in meters, unless otherwise stated.
2. This drawing should be read in conjunction with other relevant engineering details, drawings & specifications.
3. In case of any discrepancy, the bounded prevails over what is drawn.
4. Any discrepancies should be reported to the design engineer immediately, so that clarification can be sought prior to the commencement of works.
5. The dimensions must be rectified on site before construction.
6. All works are to be in accordance with Southwark borough council specification and standards.

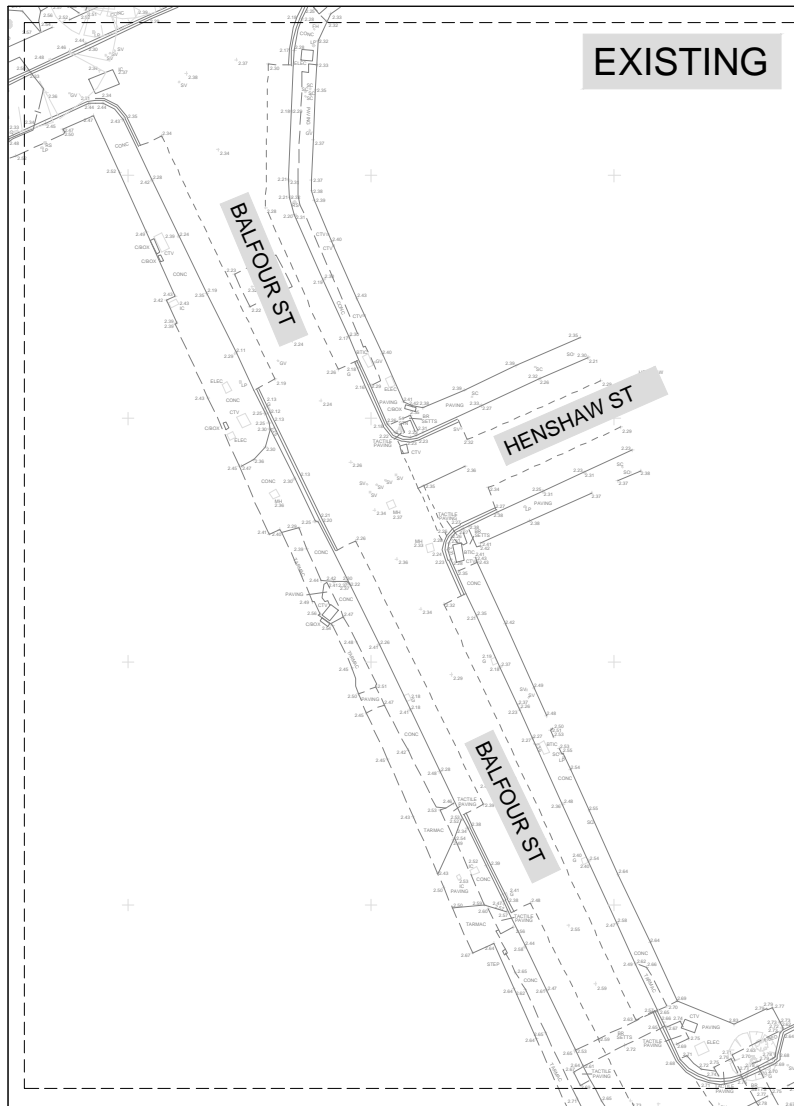

Rev	Date	Description	Drm	Chk	App
00	16/05/18	Draft	IG	AR	RW

Project		Community council SOUTHWARK - BERMONDSEY & OLD SOUTHWARK				
Drawing Title		Ward(s) EAST WALWORTH				
BALFOUR STREET SCHEME		Date	Scale	Drm	Rev	App
HENSHAW ST JUNCTION		16/05/18	N/A	IG	AR	RW
Drawing number		Status				
BS-s3		00				



**Highways Division  
Transport projects  
Minor Works**

Environment and Social  
Regeneration  
Floor 3, Hub 2  
160 Tooley Street  
PO Box 64529  
London SE1P 5LX

**KEY MAP:**



**NOTES:**

1. Dimensions in meters, unless otherwise stated.
2. This drawing should be read in conjunction with other relevant engineering details, drawings & specifications.
3. In case of any discrepancy, the bounded prevails over what is drawn.
4. Any discrepancies should be reported to the design engineer immediately, so that clarification can be sought prior to the commencement of works.
5. The dimensions must be rectified on site before construction.
6. All works are to be in accordance with Southwark borough council specification and standards.

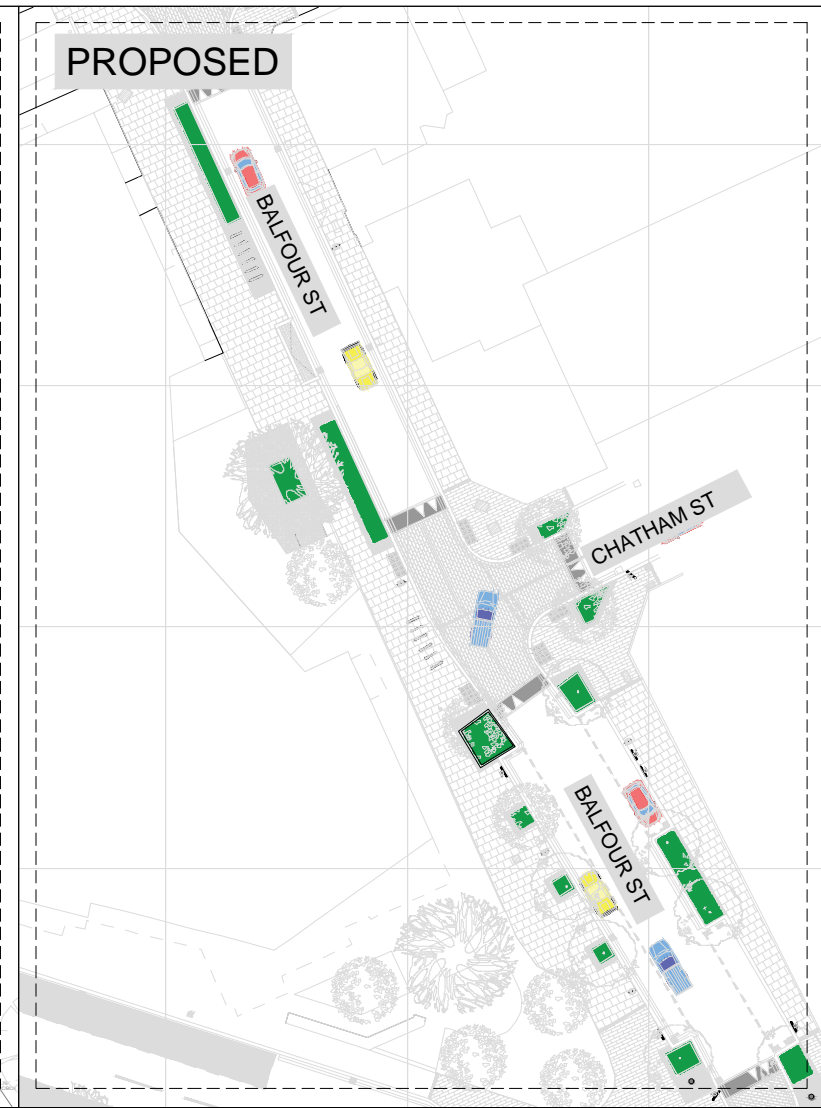
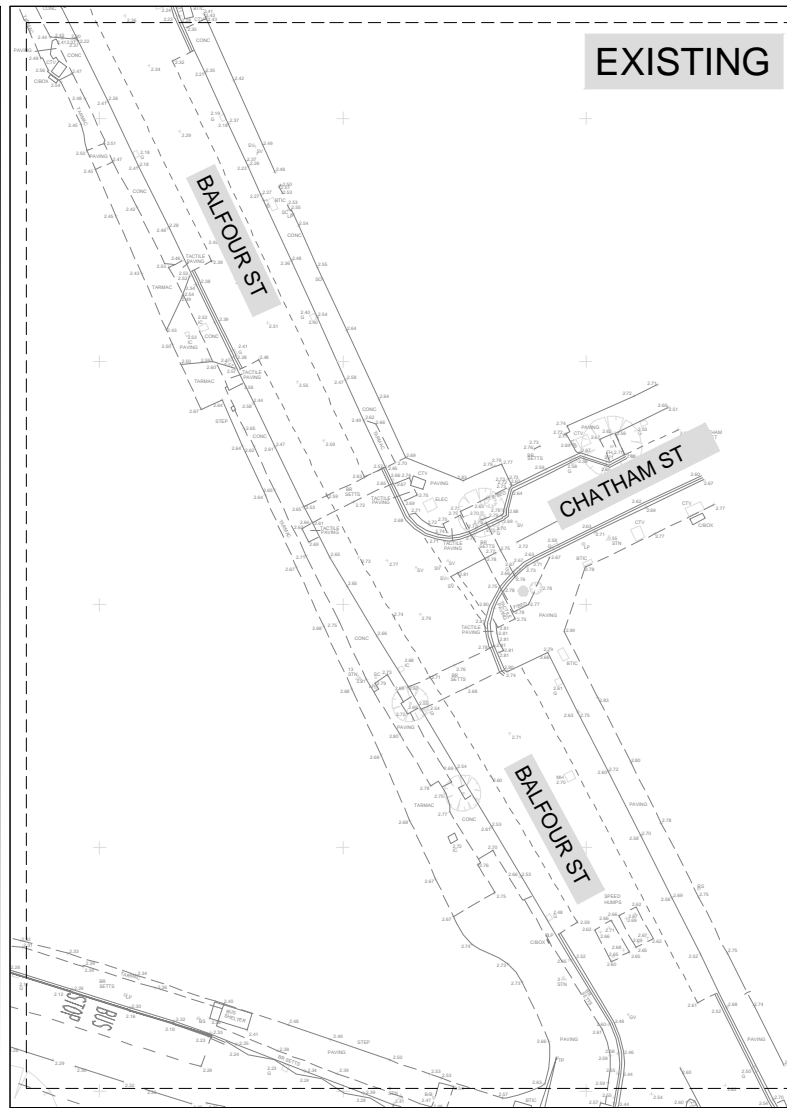

Rev	Date	Description	Drm	Chk	App
00	16/05/18	Draft	IG	AR	RW

Project		Community council SOUTHWARK - BERMONDSEY & OLD SOUTHWARK				
Description		BALFOUR STREET SCHEME				
Ward(s)		EAST WALWORTH				
Drawing Title		Date	Scale	Drm	Rev	App
CHATHAM ST JUNCTION		16/05/18	N/A	IG	AR	RW
Drawing number		Status				
BS-s2		00				



**Highways Division  
Transport projects  
Minor Works**

Environment and Social  
Regeneration  
Floor 3, Hub 2  
160 Tooley Street  
PO Box 64529  
London SE1P 5LX



**KEY MAP:**



**NOTES:**

1. Dimensions in meters, unless otherwise stated.
2. This drawing should be read in conjunction with other relevant engineering details, drawings & specifications.
3. In case of any discrepancy, the bounded prevails over what is drawn.
4. Any discrepancies should be reported to the design engineer immediately, so that clarification can be sought prior to the commencement of works.
5. The dimensions must be rectified on site before construction.
6. All works are to be in accordance with Southwark borough council specification and standards.

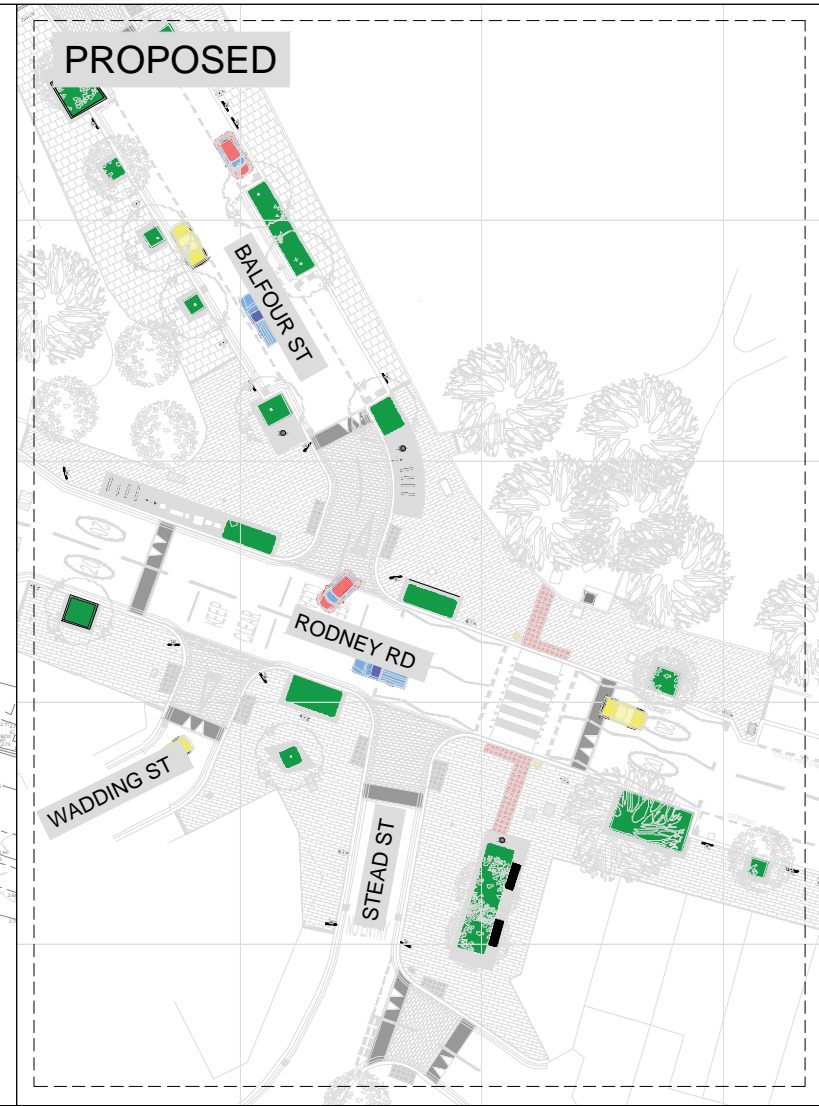
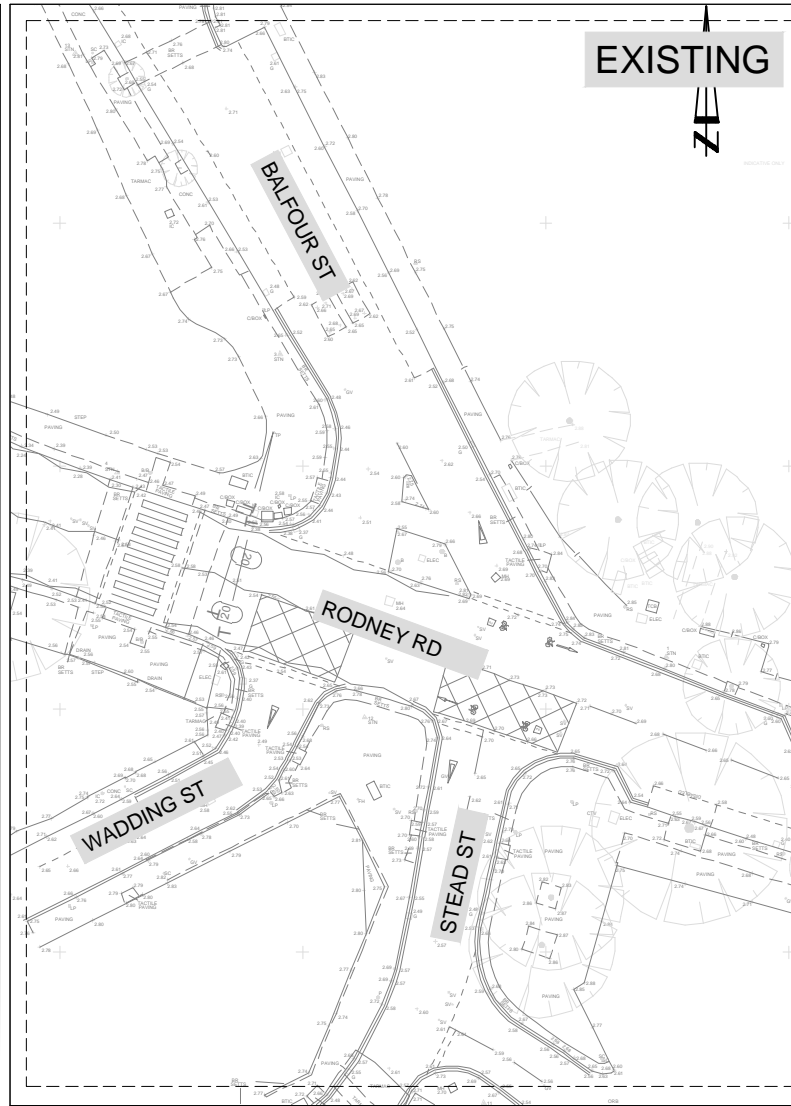

Rev	Date	Description	Drm	Chk	App
00	16/05/18	Draft	IG	AR	RW

Project	Community council SOUTHWARK - BERMONDSEY & OLD SOUTHWARK				
	Ward(s) EAST WALWORTH				
Drawing Title	Date	Scale	Drm	Rev	App
<b>BALFOUR STREET SCHEME</b>	16/05/18	N/A	IG	AR	RW
<b>RODNEY RD JUNCTION</b>	Drawing number	Status			
	<b>BS-s1</b>	<b>00</b>			

Community council SOUTHWARK - BERMONDSEY & OLD SOUTHWARK					
Ward(s) EAST WALWORTH					
Date	Scale	Drm	Rev	App	
16/05/18	N/A	IG	AR	RW	
Drawing number	Status				
<b>BS-s1</b>	<b>00</b>				



**Highways Division  
Transport projects  
Minor Works**

Environment and Social  
Regeneration  
Floor 3, Hub 2  
160 Tooley Street  
PO Box 64529  
London SE1P 5LX

**KEY MAP:**



**NOTES:**

1. Dimensions in meters, unless otherwise stated.
2. This drawing should be read in conjunction with other relevant engineering details, drawings & specifications.
3. In case of any discrepancy, the bounded prevails over what is drawn.
4. Any discrepancies should be reported to the design engineer immediately, so that clarification can be sought prior to the commencement of works.
5. The dimensions must be rectified on site before construction.
6. All works are to be in accordance with Southwark borough council specification and standards.

**EXISTING**

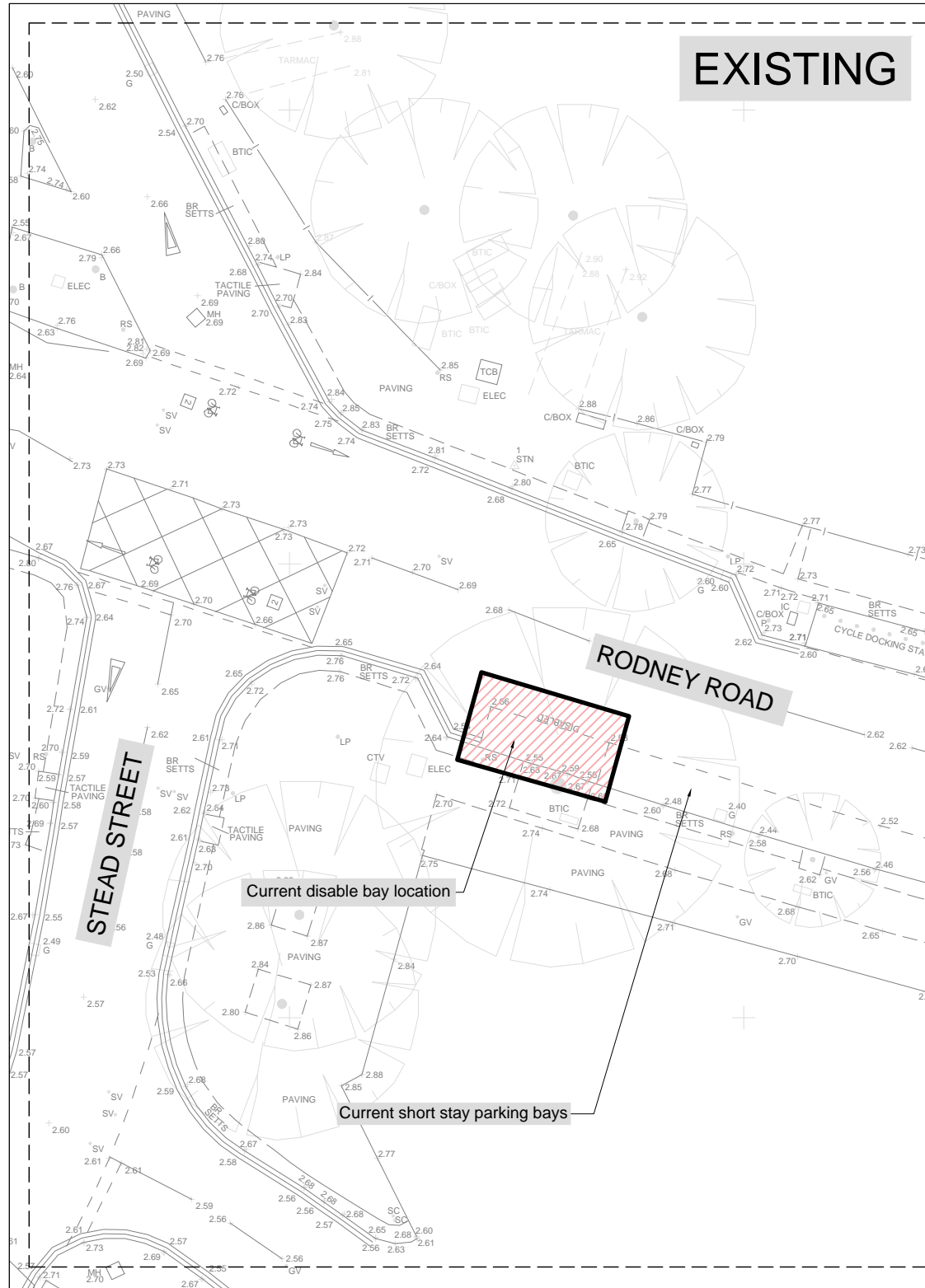

**PROPOSED**

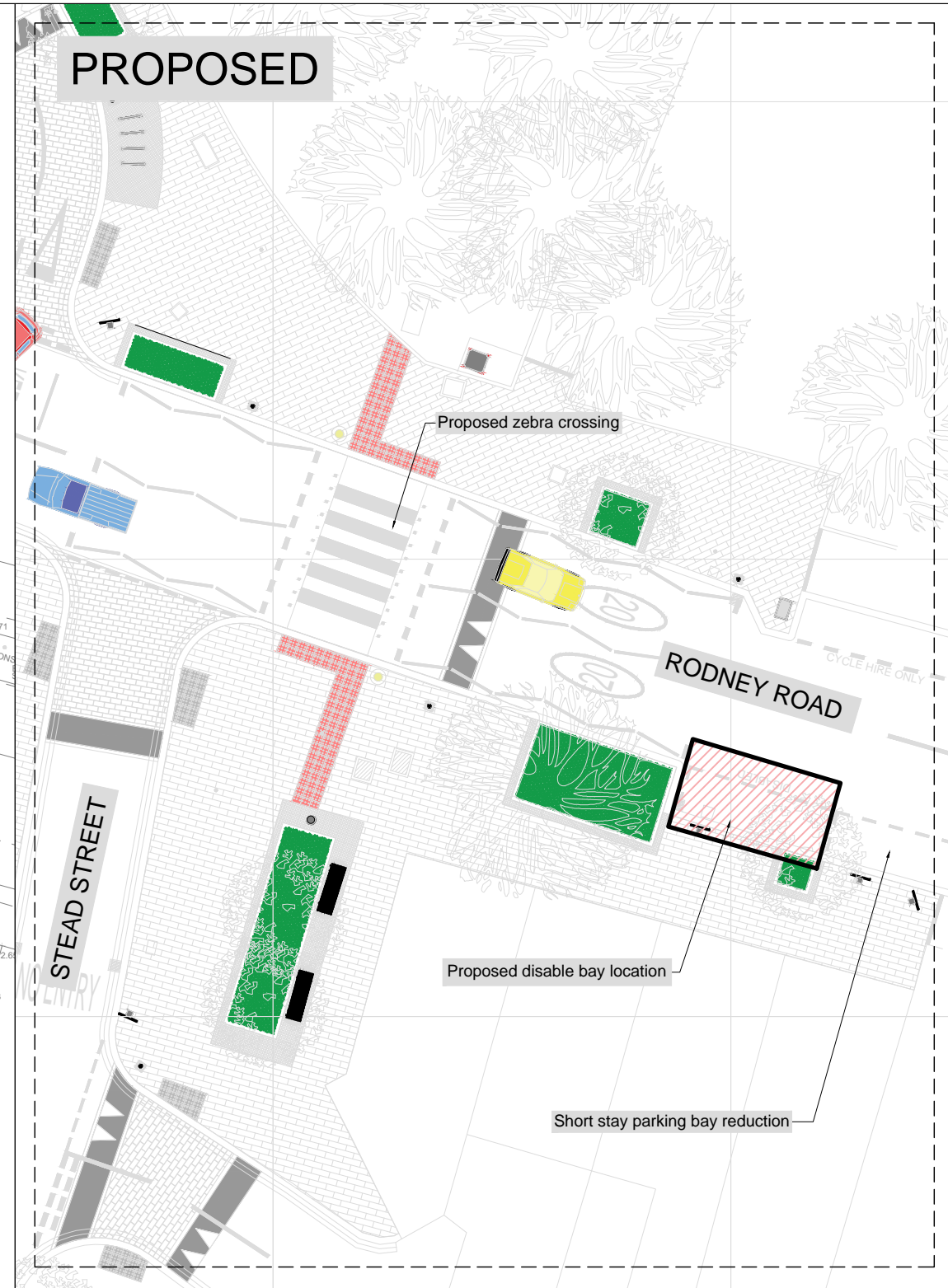

Rev	Date	Description	Drn	Chk	App
00	16/05/18	Draft	IG	AR	RW

Project  
**BALFOUR STREET SCHEME**

Drawing Title  
**RODNEY RD JUNCTION**

Community council <b>SOUTHWARK - BERMONDSEY &amp; OLD SOUTHWARK</b>				
Ward(s) <b>EAST WALWORTH</b>				
Date	Scale	Drn	Rev	App
16/05/18	N/A	IG	AR	RW
Drawing number		Status		
<b>BS</b>		<b>00</b>		



**Highways Division  
Transport projects  
Minor Works**

Environment and Social  
Regeneration  
Floor 3, Hub 2  
160 Tooley Street  
PO Box 64529  
London SE1P 5LX



THE COUNCIL OF THE LONDON BOROUGH OF SOUTHWARK

# TRAFFIC MANAGEMENT ORDER

2016 No. 0xx

---

The London Borough of Southwark (Parking places) (CPZ 'M1') (No. xx) Order 201x

Made:

Coming into force:

---

The council of the London Borough of Southwark, after consulting the Commissioner of Police of the Metropolis, in exercise of the powers conferred by sections 45, 46, 49 and 124 of and Part IV of Schedule 9 to the Road Traffic Regulation Act 1984<sup>a</sup>, as amended, and of all other powers thereunto enabling, hereby make the following Order:

## Citation and commencement

- 1.1 This Order may be cited as the London Borough of Southwark (Parking places) (CPZ 'M1') (No. x) Order 201x and shall come into force on xx xx 201x.

## Interpretation

- 2.1 In this Order:-

“council” means the council of the London Borough of Southwark;

“enactment” means any enactment, whether public general or local, and includes any order, bye-law, rule, regulation, scheme or other instrument having effect by virtue of an enactment;

“the Order of 2014” means The London Borough of Southwark (Parking Places) (CPZ 'M1') (No. 1) Order 2014<sup>b</sup>; and

“the Order of 2016” means The London Borough of Southwark (Parking Places) (CPZ 'M1') (No. 5) Order 2016<sup>c</sup>.

- 2.2 Any reference in this Order to any enactment shall be construed as a reference to that enactment as amended, applied, consolidated, re-enacted by or as having effect by virtue of any subsequent enactment.

- 2.3 Unless the context otherwise requires, any expression used in this Order which is also used in the Order of 2014 shall have the same meaning as in that Order.

## Revocation

- 3.1 Without prejudice to the validity of anything done or to any liability incurred in respect of any act or omission before the coming into force of this Order:

(a) the designation by the Order of 2014 of the parking places numbered 10, 11, 12, 13, 14, and 18 in Schedule 1 therein, is hereby revoked; and

---

<sup>a</sup> 1984 c.27

<sup>b</sup> LBS 2014/104

<sup>c</sup> LBS 2016/023

(b) the designation by the Order of 2016 of the parking places numbered 196 and 197 in the Schedule therein, is hereby revoked.

Designation of parking place and application of the Order of 2014 thereto

- 4.1 Each area on a highway comprising the length of carriageway of a street specified in columns (2) and (3) of a Schedule to this Order and bounded on one side of that length by the edge of the carriageway, and having a width throughout of 2 metres, is designated as a parking place.
- 4.2 The provisions of the Order of 2014 (other than Articles 3 and 15) shall apply to each area designated as a parking place by this Order as if in those provisions any reference to a parking place shall include a reference to each area designated as a parking place by this Order and as if any reference to Schedule 1 to the Order of 2014 included a reference to the Schedule to this Order.

Placing of traffic signs etc.

- 5.1 The council shall:-
  - (a) place and maintain traffic signs indicating the limits of each parking place referred to in the Schedule to this Order;
  - (b) place and maintain in or in the vicinity of each parking place referred to in the Schedule to this Order traffic signs indicating that such a parking place may be used during the permitted hours for the leaving only of the vehicles specified in Articles 4.1 and 4.2 of the Order of 2014; and
  - (c) carry out such other works as is reasonably required for the purposes of the satisfactory operation of a parking place.

Dated this xx day of xx 201x



NICKY COSTIN  
Parking and Network Management Business Unit Manager  
Regulatory Services

## SCHEDULE 1 - PERMIT HOLDERS' PARKING PLACES

<i>No. of parking place (1)</i>	<i>Designated parking place (2)</i>	<i>Permitted hours (3)</i>
222.	BALFOUR STREET the north-east side, from a point 9.2 metres south-east of the south-eastern kerb-line buildout of Chatham Street south-eastward for a distance of 11 metres.	8.30 am to 6.30 pm Monday to Friday
223.	BALFOUR STREET the north-east side, from a point 29 metres south-east of the south-eastern kerb-line buildout of Chatham Street south-eastward for a distance of 11 metres.	8.30 am to 6.30 pm Monday to Friday
224.	BALFOUR STREET the south-west side, from directly opposite a point 9.2 metres south-east of the south-eastern kerb-line buildout of Chatham Street south-eastward for a distance of 26.5 metres.	8.30 am to 6.30 pm Monday to Friday
225.	CHATHAM STREET the north-west side, from a point 19 metres north-east of the north-eastern kerb-line of Balfour Street north-eastward for a distance of 21 metres.	8.30 am to 6.30 pm Monday to Friday
226.	HENSHAW STREET the north-west side, from a point 7.6 metres north-east of the north-eastern kerb-line buildout of Balfour Street to the common boundary of Nos. 19 and 21 Henshaw Street.	8.30 am to 6.30 pm Monday to Friday
227.	HENSHAW STREET the south-east side, from a point 6 metres north-east of the north-eastern kerb-line buildout of Balfour Street and a point 2 metres north-east of the common boundary of Nos. 28 and 30 Henshaw Street.	8.30 am to 6.30 pm Monday to Friday

## EXPLANATORY NOTE

*(This note is not part of the Order)*

This Order:-

- (i) splits and removes part of an existing permit holders' parking place on the north-east side and reduces in length an existing permit holders' parking place on the south-west side of Balfour Street;
- (ii) removes some of the existing permit holders' parking place bays on both sides and throughout the length of Balfour Street; and
- (iii) re-defines one permit holders' parking place bay in Chatham Street and two permit holders' parking place bays in Henshaw Street

to accommodate the new kerb-line buildouts throughout Balfour Street in line with the re-development of this area from New Kent Road to Rodney Road, in the London Borough of Southwark.



THE COUNCIL OF THE LONDON BOROUGH OF SOUTHWARK

# TRAFFIC MANAGEMENT ORDER

2018 No. xxx

---

The London Borough of Southwark (Parking places) (London cycle hire scheme)  
(Amendment No. 6) Order 2018

Made: xxxxx 2018

Coming into force: xxxxxx 2018

---

The council of the London Borough of Southwark, after consulting the Commissioner of Police of the Metropolis, in exercise of the powers conferred by sections 6, 45, 49, and 124 of and Part IV of Schedule 9 to the Road Traffic Regulation Act 1984<sup>a</sup> as amended, and of all other powers thereunto enabling, hereby make the following Order:-

## Citation and commencement

- 1.1 This Order may be cited as the London Borough of Southwark (Parking places) (London cycle hire scheme) (Amendment No. 6) Order 2018 and shall come into force on xxxxx 2018.

## Interpretation

- 2.1 In this Order:-

“council” means the council of the London Borough of Southwark;

“cycle docking station parking place” refers to an area of carriageway or footway designated by this Order as a parking place for pedal cycles used for the London cycle hire scheme;

“enactment” means any enactment, whether public general or local, and includes any order, bye-law, rule, regulation, scheme or other instrument having effect by virtue of an enactment;

“London cycle hire scheme” refers to the pedal cycle rental scheme operated by Transport for London and their agents;

“pedal cycle” has the same meaning as in regulation 4 of the Traffic Signs Regulations and General Directions 2002<sup>b</sup>; and

“the Order of 2009” means the London Borough of Southwark (Parking Places) (London Cycle Hire Scheme) Order 2009<sup>c</sup>.

- 2.2 Any reference in this Order to any enactment shall be construed as a reference to that enactment as amended, applied, consolidated, re-enacted by or as having effect by virtue of any subsequent enactment.
- 2.3 Unless the context otherwise requires, any expression used in this Order which is also used in the Order of 2009 shall have the same meaning as in that Order.

---

<sup>a</sup> 1984 c.27

<sup>b</sup> S.I. 2002/3113

<sup>c</sup> LBS 2009/096

Designation of cycle docking station parking places and application of the Order of 2009 thereto

- 3.1 Each area on a street specified in column 2 of the Schedule to this Order is designated as a cycle docking station parking place for the leaving only of pedal cycles used for the London Cycle Hire Scheme.
- 3.2 The provisions of the Order of 2009 shall apply to each area described in the Schedule to this Order as if in those provisions any reference to a cycle docking station parking place shall include a reference to each area designated as a cycle docking station parking place by this Order and as if any reference to Schedule 1 to the Order of 2009 included a reference to the Schedule to this Order.

Placing of traffic signs etc.

- 4.1 The council shall:-
- (a) place and maintain in or in the vicinity of each cycle docking station parking place referred to in the Schedule, traffic signs indicating that such loading bay may be used for the leaving only of pedal cycles used for the London cycle hire scheme; and
  - (b) carry out such other work as is reasonably required for the purposes of the satisfactory operation of a cycle docking station parking place.

Dated this xxxxxxxx day of xxxxx 2018



NICKY COSTIN  
Road Network & Parking Business Unit Manager  
Public Realm



SCHEDULE (see Article 3.2)

AREAS OF CARRIAGEWAY DESIGNATED AS 'CYCLE DOCKING STATION' PARKING PLACES

---

<i>Item No.</i>	<i>Designated cycle docking station parking place</i>
(1)	(2)

---

24.	<b>VICTORY PLACE</b> the north-west side, from a point 18.5 metres south-west of the south-western wall of No. 4 Victory Place south-westward for a distance of 29 metres.
-----	---

---

## EXPLANATORY NOTE

*(This note is not part of the Order)*

This order formalises the introduction of a cycle docking station parking place for use with the London cycle hire scheme, in the carriageway of Victory Place in the London Borough of Southwark.



THE COUNCIL OF THE LONDON BOROUGH OF SOUTHWARK

# TRAFFIC MANAGEMENT ORDER

2018 No. xxx

---

The London Borough of Southwark (Prescribed route) (Victory Place)  
(No. 1) Traffic Order 201\*

Made: XX xxx 2018

Coming into force: XX xxx 2018

---

The council of the London Borough of Southwark, after consulting the Commissioner of Police of the Metropolis, in exercise of the powers conferred by sections 6 and 124 of the Road Traffic Regulation Act 1984<sup>a</sup>, as amended, and of all other powers thereunto enabling, hereby make the following Order:

## Citation and commencement

- 1.1 This Order may be cited as the London Borough of Southwark (Prescribed route) (Victory Place) (No. 1) Traffic Order 2018, shall come into force on xx April 2018.

## Interpretation

- 2.1 In this Order:-

causing includes permitting;

"electronic communications network" has the same meaning as that given in section 32 of the Communications Act 2003<sup>b</sup>;

"enactment" means any enactment, whether public general or local, and includes any order, byelaw, rule, regulation, scheme or other instrument having effect by virtue of an enactment;

"prescribed street", for the purposes of Article 4.1(d) means the part of street referred to in Article 3.1 of this Order;

"motor vehicle" has the same meaning as in section 185(1) of the Road Traffic Act 1988<sup>c</sup> and section 136(1) of the Road Traffic Regulation Act 1984;

"traffic sign" means a sign of any size, type and colour prescribed and authorised under, or having effect as though prescribed or authorised under section 64 of the Road Traffic Regulation Act 1984;

- 2.2 Any reference in this Order to any enactment shall be construed as a reference to that enactment as amended, applied, consolidated, re-enacted by or as having effect by virtue of any subsequent enactment.

---

<sup>a</sup> [1984 c.27](#)

<sup>b</sup> [2003 c.21](#)

<sup>c</sup> [1988 c.52](#)

2.3 Any reference to a named street (or part thereof) shall be construed as a reference to a street which lies within the London Borough of Southwark.

Prescribed route

3.1 No person shall cause any motor vehicle to enter into or proceed in that part of Victory Place which lies between the north-eastern kerb-line of Rodney Road and a point 12.8 metres south-west of the south-eastern wall of No. 4 Victory Place.

Exemptions

4.1 Nothing in Article 3.1 preceding shall apply in relation to:-

- (a) anything done with the permission or at the direction of a police constable in uniform; or
- (b) any vehicle being used for ambulance, fire brigade or police purposes in an emergency; or
- (c) any person who causes any vehicle to proceed in accordance with any restriction or requirement indicated by traffic signs placed on the highway pursuant to section 66 or section 67 of the Road Traffic Regulation Act 1984.
- (d) any vehicle being used in connection with the laying, erection, alteration, or repair in or adjacent to the prescribed street of any sewer, main, pipe or apparatus for the supply of gas, water, electricity, or of any electronic communications network; or the placing, maintenance or removal of any traffic sign, if the vehicle cannot be used for that purpose in any other street or part of that street.

Dated this xxxx day of April 2018



NICKY COSTIN  
Parking and Network Management Business Unit Manager  
Regulatory Services

---

EXPLANATORY NOTE

*(This note is not part of the Order)*

This Order formally prohibits motor vehicles from entering into or proceeding in part of Victory Place in the London Borough of Southwark, as part of a scheme of highway improvements in the area to improve cycle and pedestrian road-safety.



THE COUNCIL OF THE LONDON BOROUGH OF SOUTHWARK

# TRAFFIC MANAGEMENT ORDER

2018 No. xxx

---

The London Borough of Southwark (Prohibition of stopping on entrance markings)  
(Amendment No. 15) Traffic Order 2018

Made: xx

Coming into force: xx

---

The council of the London Borough of Southwark, after consulting the Commissioner of Police of the Metropolis, in exercise of powers conferred by sections 6 and 124 of and Part IV of Schedule 9 to the Road Traffic Regulation Act 1984<sup>a</sup> and of all other enabling powers, hereby make the following Order:-

## Citation and commencement

- 1.1 This Order may be cited as the London Borough of Southwark (Prohibition of stopping on entrance markings) (Amendment No. 15) Traffic Order 2018 and shall come into force on xx xx 2018.

## Interpretation

- 2.1 In this Order:-  
"enactment" means any enactment, whether public general or local, and includes any order, bye-law, rule, regulation, scheme or other instrument having effect by virtue of an enactment; and  
"the Order of 2012" means the London Borough of Southwark (Prohibition of stopping on entrance markings) (No. 1) Traffic Order 2012<sup>b</sup>.
- 2.2 Any reference in this Order to any enactment shall be construed as a reference to that enactment as amended, applied, consolidated, re-enacted by or as having effect by virtue of any subsequent enactment.
- 2.3 Unless the context otherwise requires, any expression used in this Order which is also used in the Order of 2012 shall have the same meaning as in that Order.

---

<sup>a</sup> 1984 c.27

<sup>b</sup> LBS 2012/008

Amendment of the Order of 2012

- 3.1 Without prejudice to the validity of anything done or to any liability incurred in respect of any act or omission before the coming into force of this Order, the Order of 2012 shall have effect as though:-
- (a) the item numbered 160 in Schedule 1 to that Order is substituted for the item similarly numbered and set out in columns 1 and 2 of the Schedule to this Order; and
  - (b) the item numbered 161 in Schedule 1 to that Order is omitted.

Dated this xxx day of xxx 2018

A handwritten signature in black ink, appearing to read "Nicky Costin". The signature is written in a cursive, slightly slanted style.

NICKY COSTIN  
Parking and Network Management Business Unit Manager  
Regulatory Services

SCHEDULE - 'SCHOOL KEEP CLEAR' RESTRICTIONS

*(No stopping on entrance markings 8 am to 5 pm, Monday to Friday)*

---

<i>Item No. (1)</i>	<i>Length of street (2)</i>
160.	VICTORY PLACE the north-west side, from a point 8.7 metres north-east of the north-eastern wall of No. 4 Victory Place south-westward for a distance of 31 metres.

---

## EXPLANATORY NOTE

*(This note is not part of the Order)*

This Order:-

- (i) amends the definition for an existing length of 'school keep clear' restrictions and
- (ii) removes a redundant length of 'school keep clear' restrictions in Victory Place, in the London Borough of Southwark.





THE COUNCIL OF THE LONDON BOROUGH OF SOUTHWARK

# TRAFFIC MANAGEMENT ORDER

2018 No. xxx

---

The London Borough of Southwark (Free parking places) (Disabled persons) (No. xx) Order 2018

Made: xxxx

Coming into force: xxx

---

The council of the London Borough of Southwark, after consulting the Commissioner of Police of the Metropolis, in exercise of the powers conferred by sections 6 and 124 of and Part IV of Schedule 9 to the Road Traffic Regulation Act 1984<sup>a</sup>, as amended, and of all other powers thereunto enabling, hereby make the following Order:

## Citation and commencement

- 1.1 This Order may be cited as the London Borough of Southwark (Free parking places) (Disabled persons) (No. xx) Order 2018 and shall come into force on xx xxxx 2018.

## Interpretation

- 2.1 In this Order:-

"council" means the council of the London Borough of Southwark;

"enactment" means any enactment, whether public general or local, and includes any order, byelaw, rule, regulation, scheme or other instrument having effect by virtue of an enactment;

"the Order of 2013" means The London Borough of Southwark (Free parking places) (Disabled persons) (No. 1) Order 2013<sup>b</sup>, as amended.

- 2.2 Any reference in this Order to any enactment shall be construed as a reference to that enactment as amended, applied, consolidated, re-enacted by or as having effect by virtue of any subsequent enactment.
- 2.3 Unless the context otherwise requires, any expression used in this Order which is also used in the Order of 2013 shall have the same meaning as in that Order.

---

<sup>a</sup> 1984 c.27

<sup>b</sup> LBS 2013/059

### Revocation

- 3.1 Without prejudice to the validity of anything done or to any liability incurred in respect of any act or omission before the coming into force of this Order:-
- (a) the designation by the Order of 2013 of the parking places numbered 291, 425, 837 and 600 in Schedule 1 therein, is hereby revoked; and
  - (b) the designation by the Southwark (Free parking places) (Disabled persons) (No. 6) Order 2014<sup>c</sup> of the parking place numbered 1035 in Schedule 1 therein, is hereby revoked.

### Designation of parking places and application of the Order of 2013 thereto

- 4.1 Each area on a highway comprising the length of carriageway of a street specified in column 2 of the Schedule to this Order is designated as a parking place.
- 4.2 The provisions of the Order of 2013 (other than Articles 3.1 and 14.1) shall apply to each area described in the Schedule to this Order as if in those provisions any reference to a parking place shall include a reference to each area designated as a parking place by this Order and as if any reference to Schedule 1 to the Order of 2013 included a reference to the Schedule to this Order.

### Placing of traffic signs etc.

- 5.1 The council shall:-
- (a) place and maintain traffic signs indicating the limits of each parking place referred to in the Schedule to this Order;
  - (b) place and maintain in or in the vicinity of each parking place referred to in the Schedule to this Order traffic signs indicating that such a parking place may be used during the permitted hours for the leaving only of the vehicles specified in Article 4.1 of the Order of 2013; and
  - (c) carry out such other works as is reasonably required for the purposes of the satisfactory operation of a parking place.

Dated this xxx day of xx 2018



NICKY COSTIN  
Parking and Network Management Business Unit Manager  
Regulatory Services

---

<sup>c</sup> LBS 2014/018

SCHEDULE 1 - UNLIMITED STAY DISABLED PERSONS PARKING PLACES

<i>No. of parking place (1)</i>	<i>Designated parking place (2)</i>	<i>Permitted hours (3)</i>
****.	<b>BALFOUR STREET relocate #1134 from 2014/107</b> <b>the south-west side, from a point 14.5 metres south of the southern kerb-line of Munton Road south-eastward for a distance of 6.6 metres.</b>	<b>At any time</b>

SCHEDULE 2 - LIMITED STAY DISABLED PERSONS PARKING PLACES

<i>No. of parking place (1)</i>	<i>Designated parking place (2)</i>	<i>Permitted hours (3)</i>	<i>Maximum parking period (4)</i>	<i>Minimum return interval (5)</i>
**.	<p><b>RODNEY ROAD <span style="background-color: yellow;">relocate</span> #1326 from 2016/070</b>  <b>the south-west side, from a point 2.8 metres north-west of the common boundary of Nos. 100 and 102 Rodney Road south-eastward for a distance of 6.6 metres.</b></p>	<b>At any time</b>	<b>4 hours</b>	<b>-</b>

## EXPLANATORY NOTE

*(This note is not part of the Order)*

This order:-

- (i) relocates an existing 'unlimited stay' disabled persons parking places in Balfour Street; and
  - (ii) relocates an existing 'limited stay' disabled persons parking places in Rodney Road;
- in the London Borough of Southwark.



THE COUNCIL OF THE LONDON BOROUGH OF SOUTHWARK

# TRAFFIC MANAGEMENT ORDER

2018 No. xxx

---

The London Borough of Southwark (Free parking places) (No. \*) Order 201\*

Made: xx xxx 2018

Coming into force: xx xxx 2018

---

The council of the London Borough of Southwark, after consulting the Commissioner of Police of the Metropolis, in exercise of the powers conferred by sections 6 and 124 of and Part IV of Schedule 9 to the Road Traffic Regulation Act 1984<sup>a</sup>, and of all other powers thereunto enabling, hereby make the following Order:-

## Citation and commencement

- 1.1 This Order may be cited as the London Borough of Southwark (Free parking places) (No. \*) Order 201\* and shall come into force on xx xxx 2018.

## Interpretation

- 2.1 In this Order:-

"council" means the council of the London Borough of Southwark;

"enactment" means any enactment, whether public general or local, and includes any order, bye-law, rule, regulation, scheme or other instrument having effect by virtue of an enactment; and

"the Order of 2015" means the London Borough of Southwark (Free parking places) (No. 1) Order 2015<sup>b</sup>.

- 2.2 Any reference in this Order to any enactment shall be construed as a reference to that enactment as amended, applied, consolidated, re-enacted by or as having effect by virtue of any subsequent enactment.
- 2.3 Unless the context otherwise requires, any expression used in this Order which is also used in the Order of 2015 shall have the same meaning as in that Order.

---

<sup>a</sup> 1984 c.27

<sup>b</sup> LBS 2015/088

### Revocation

- 3.1 Without prejudice to the validity of anything done, or to any liability incurred in respect of any act or omission before the coming into force of this Order, the designation by the Order of 2015 of the parking place numbered 213 (*Rodney Road*) in the Schedule therein is hereby revoked.

### Designation of parking place and application of the Order of 2015 thereto

- 4.1 Each area on a highway comprising the length of carriageway of a street specified in column 2 of the Schedule to this Order and bounded on one side of that length by the edge of the carriageway and having a width throughout of 4.6 metres, is designated as a parking place.
- 4.2 The provisions of the Order of 2015 (other than Articles 3.1 and 13.1) shall apply to each area described in the Schedule to this Order as if in those provisions any reference to a parking place shall include a reference to each area designated as a parking place by this Order and as if any reference to the Schedule to the Order of 2015 included a reference to the Schedule to this Order.

### Placing of traffic signs etc.

- 5.1 The council shall:-
- (a) place and maintain traffic signs indicating the limits of each parking place referred to in the Schedule to this Order;
  - (b) place and maintain in or in the vicinity of each parking place referred to in the Schedule to this Order traffic signs indicating that such a parking place may be used during the permitted hours for the leaving only of the vehicles specified in Article 4.1 of the Order of 2015; and
  - (c) carry out such other works as is reasonably required for the purposes of the satisfactory operation of a parking place.

Dated this xxth day of xxxx 2018



NICKY COSTIN  
Parking and Network Management Business Unit Manager  
Regulatory Services

SCHEDULE - FREE PARKING PLACE

<i>No. of parking place (1)</i>	<i>Designated parking place (2)</i>	<i>Permitted hours (3)</i>	<i>Maximum parking period (4)</i>	<i>Minimum return interval (5)</i>
***.	<p>RODNEY ROAD</p> <p>the south-west side, from a point 2.2 metres north-west of the common boundary of Nos. 102 and 104 Rodney Road south-east for a distance of 20 metres.</p>	<p>8.30 am to 6.30 pm</p> <p>Monday to Friday</p>	30 minutes	2 hours



## EXPLANATORY NOTE

*(This note is not part of the Order)*

This Order revokes and reinstates an existing 'short stay' parking place - reduced in length, to accommodate a new 'zebra' pedestrian crossing - in Rodney Road, in the London Borough of Southwark.



THE COUNCIL OF THE LONDON BOROUGH OF SOUTHWARK

# TRAFFIC MANAGEMENT ORDER

201x No. xxx

---

The London Borough of Southwark (Waiting and loading restrictions)  
(Amendment No. xx) Order 201x

Made: xx xx 201x

Coming into force: xx xx 201x

---

The council of the London Borough of Southwark, after consulting the Commissioner of Police of the Metropolis, in exercise of the powers conferred by sections 6 and 124 of and Part IV of Schedule 9 to the Road Traffic Regulation Act 1984<sup>a</sup>, as amended, and of all other powers thereunto enabling, hereby make the following Order:

## Citation and Commencement

- 1.1 This Order may be cited as the London Borough of Southwark (Waiting and loading restrictions) (Amendment No. xx) Order 201x and shall come into force on xx xx 201x.

## Interpretation

- 2.1 In this Order:-

"council" means the council of the London Borough of Southwark;

"enactment" means any enactment, whether public general or local, and includes any order, bye-law, rule, regulation, scheme or other instrument having effect by virtue of an enactment; and

"the Order of 2015" means the London Borough of Southwark (Waiting and loading restrictions) Consolidation Order 2015<sup>b</sup> - as amended by the London Borough of Southwark (Waiting and loading restrictions) (Amendment No. 16) Order 2016<sup>c</sup>.

- 2.2 Any reference in this Order to any enactment shall be construed as a reference to that enactment as amended, applied, consolidated, re-enacted by or as having effect by virtue of any subsequent enactment.

- 2.3 Unless the context otherwise requires, any expression used in this Order which is also used in the Order of 2015 shall have the same meaning as in that Order.

---

<sup>a</sup> 1984 c.27

<sup>b</sup> LBS 2015/082

<sup>c</sup> LBS 2016/026

Amendment of the Order of 2015

- 3.1 Without prejudice to the validity of anything done, or to any liability incurred in respect of any act or omission before the coming into force of this Order, the Order of 2015 shall have effect as though the items numbered 57, 189, 482, 526, 924, 1028 and 1033 in Schedule 1 to that Order there were substituted the items similarly numbered and set out in columns 1, 2 and 3 of the Schedule to this Order.

Dated this xx day of xx 201x

A handwritten signature in black ink, appearing to read "Nicky Costin". The signature is written in a cursive, slightly slanted style.

NICKY COSTIN  
Parking and Network Management Business Unit Manager  
Regulatory Services

SCHEDULE – WAITING RESTRICTIONS (SUBSTITUTION)

<i>Item No. (1)</i>	<i>Street (2)</i>	<i>Prescribed hours (3)</i>
57.	BALFOUR STREET	
	(a) the east and north-east side	
	(i) between a point 9 metres south of the southern kerb-line of New Kent Road and a point 34 metres south of that kerb-line;	8.30 am to 6.30 pm Monday to Friday
	(ii) <b>between a point 34 metres south of the southern kerb-line of New Kent Road and a point 9 metres south-east of the south-eastern kerb-line buildout of Chatham Street;</b>	<b>At any time</b>
	(iii) <b>between a point 20.4 metres south-east of the south-eastern kerb-line buildout of Chatham Street and a point 28.7 metres south-east of that kerb-line buildout;</b>	<b>At any time</b>
	(iv) <b>between a point 60.2 metres south-east of the south-eastern kerb-line buildout of Chatham Street and the north-eastern kerb-line buildout of Rodney Road;</b>	<b>At any time</b>
	(b) the west and south-west side	
	(i) between a point 9 metres south of the southern kerb-line of New Kent Road and a point 20 metres south of that kerb-line;	8.30 am to 6.30 pm Monday to Friday
	(ii) between a point 44 metres south of the southern kerb-line of New Kent Road and a point 14.6 metres south of the southern kerb-line buildout of Munton Road;	At any time
	(iii) <b>between a point 44.3 metres south of the southern kerb-line buildout of Munton Road and directly opposite a point 9 metres south-east of the south-eastern kerb-line buildout of Chatham Street;</b>	At any time
	(iv) between a point 35.8 metres south-east of a point opposite the south-eastern kerb-line buildout of Chatham Street and the north-eastern kerb-line buildout of Rodney Road.	At any time
189.	CHATHAM STREET	
	(a) the north and north-west side	
	(i) <b>between the north-eastern kerb-line of Balfour Street and a point 19 metres north-east of that kerb-line;</b>	<b>At any time</b>
	(ii) between a point 38 metres north-east of the north-eastern kerb-line of Balfour Street and a point 6 metres north-east of the south-western wall of No. 67 Chatham Street;	At any time

SCHEDULE – WAITING RESTRICTIONS (SUBSTITUTION)

<i>Item No. (1)</i>	<i>Street (2)</i>	<i>Prescribed hours (3)</i>
	(iii) between the common boundary of Nos. 75 and 83 Chatham Street and a point 1 metre south-west of the common boundary of Nos. 89 and 93 Chatham Street;	At any time
	(iv) between a point 3 metres north-east of the common boundary of 105 and 107 Chatham Street and a point 10 metres west of the common boundary of Nos. 119 and 121 Chatham Street;	At any time
	(v) between a point 1 metre east of the common boundary of Nos. 133 and 139 Chatham Street and a point 3.5 metres west of the common boundary of Nos. 139 and 145 Chatham Street;	At any time
	(vi) between a point 3 metres east of the common boundary of Nos. 151 and 157 Chatham Street and the north-western kerb-line of Darwin Street;	At any time
	(b) the south and south-east side	
	(i) between the north-eastern kerb-line of Balfour Street and the common boundary of Nos. 4/8 and 10/14 Chatham Street;	At any time
	(ii) between a point 9 metres south-west of the south-western kerb-line of Salisbury Close and a point 6 metres north-east of the north-eastern kerb-line of Salisbury Close;	At any time
	(iii) between a point 2 metres south-west of the north-eastern wall of No. 1 Hemp Walk and a point 10 metres north-east of that wall;	At any time
	(iv) between a point 3 metres north-east of a point opposite the common boundary of Nos. 105 and 107 Chatham Street and a point 10 metres west of a point opposite the common boundary of Nos. 119 and 121 Chatham Street;	At any time
	(v) between a point 3 metres east of a point opposite the common boundary of Nos. 133 and 139 Chatham Street and a point 4.5 metres west of a point opposite the common boundary of Nos. 139 and 145 Chatham Street;	At any time
	(vi) between a point 10 metres east of a point opposite the common boundary of Nos. 139 and 145 Chatham Street and the north-western kerb-line of Darwin Street;	At any time
	(c) so much else as does not lie within those lengths of street specified in sub-paragraphs (a) and (b) above.	8.30 am to 6.30 pm Monday to Friday
482.	HENSHAW STREET	
	<b>(a) the north-west side, between the north-eastern kerb-line</b>	<b>At any time</b>

SCHEDULE – WAITING RESTRICTIONS (SUBSTITUTION)

<i>Item No. (1)</i>	<i>Street (2)</i>	<i>Prescribed hours (3)</i>
	<b>of Balfour Street and a point 7.5 metres north-east of that kerb-line;</b>	
	<b>(b) the south-east side, between the north-eastern kerb-line of Balfour Street and a point 6 metres north-east of that kerb-line;</b>	<b>At any time</b>
	(c) so much else as does not lie within those lengths of street specified in sub-paragraphs (a) and (b) above.	8.30 am to 6.30 pm Monday to Friday
526.	JOHN MAURICE CLOSE	
	<b>(a) the north-west side, between the western wall of No. 83 Balfour Street and a point 10.5 metres north-east of that wall;</b>	<b>At any time</b>
	<b>(b) the south-east side, from a point directly opposite the western wall of No. 83 Balfour Street north-eastwards for a distance of 9.7 metres;</b>	<b>At any time</b>
	(c) so much else as is public highway as does not lie within those lengths of street specified in sub-paragraphs (a) and (b) above.	8.30 am to 6.30 pm Monday to Friday
924.	STEAD STREET	
	(a) the north-west side	
	(i) between the north-eastern kerb-line of Brandon Street and a point 25 metres north-east of that kerb-line;	At any time
	(ii) between a point 60 metres north-east of the north-eastern kerb-line of Brandon Street and a point 80.5 metres north-east of that kerb-line;	At any time
	<b>(iii) between the south-western kerb-line of Rodney Road and a point 37 metres south-west of that kerb-line;</b>	<b>At any time</b>
	(b) the south-east side	
	(i) between the north-eastern kerb-line of Brandon Street and a point 30 metres north-east of that kerb-line;	At any time
	(ii) between a point 60 metres north-east of the north-eastern kerb-line of Brandon Street and a point 79.5 metres north-east of that kerb-line;	At any time
	(iii) between the south-western kerb-line of Rodney Road and a point 9 metres south-west of the south-western kerb-line of Orb Street;	At any time
	(c) so much else as does not lie within those lengths of street specified in sub-paragraphs (a) and (b) above.	8.30 am to 6.30 pm Monday to Friday

SCHEDULE – WAITING RESTRICTIONS (SUBSTITUTION)

<i>Item No. (1)</i>	<i>Street (2)</i>	<i>Prescribed hours (3)</i>
1028.	VICTORY PLACE  <b>both sides, so much as is public highway.</b>	<b>At any time</b>
1033.	WADDING STREET	
	(a) the north-west side	
	(i) between the north-eastern kerb-line of Brandon Street and a point 5 metres north-east of that kerb-line;	At any time
	(ii) between a point 5 metres south-west of the south-western kerb-line of Content Street and a point 5 metres north-east of the north-eastern kerb-line of Content Street;	At any time
	<b>(iii) between the south-western kerb-line of Rodney Road and a point 18 metres south-west of that kerb-line;</b>	<b>At any time</b>
	(b) the south-east side	
	(i) between the north-eastern kerb-line of Brandon Street and a point 6 metres north-east of that kerb-line;	At any time
	<b>(ii) between the south-western kerb-line of Rodney Road and a point 16.3 metres south-west of that kerb-line;</b>	<b>At any time</b>
	(c) so much else as does not lie within those lengths of street specified in sub-paragraphs (a) and (b) above.	8.30 am to 6.30 pm Monday to Friday

## EXPLANATORY NOTE

*(This note is not part of the Order)*

This Order:-

- (i) introduces new lengths of 'at any time' waiting restrictions in Balfour Street; and
- (ii) amends waiting restriction definitions for Chatham Street, Henshaw Street, John Maurice Close, Stead Street, Victory Place and Wadding Street

to accommodate the new kerb-line buildouts throughout Balfour Street in line with the re-development of this area from New Kent Road to Rodney Road, in the London Borough of Southwark.