

Public notice

Dulwich Streetspace: Calton Avenue area



*The London Borough of Southwark (Prescribed routes) (Calton Avenue area) Traffic Order 202**

*The London Borough of Southwark (Charged-for parking places) (Calton Avenue area) Order 202**

*The London Borough of Southwark (Loading places and Waiting restrictions) (Calton Avenue area) Order 202**

1. Southwark Council hereby GIVES NOTICE that it proposes to make the above Orders under sections 6, 45, 46, 49 and 124 of and Part IV of Schedule 9 to the Road Traffic Regulation Act 1984, as amended ('the 1984 Act').
2. The effect of the Orders would be, on a permanent basis:-
 - (a) to prohibit motor vehicles from entering into or proceeding in: (i) that part of CALTON AVENUE which lies between the north-eastern kerb-line of Dulwich Village and a point 3 metres north-east of the north-eastern wall of No. 1d Calton Avenue; and (ii) that part of COURT LANE which lies between the south-eastern kerb-line of Calton Avenue and a point 1.5 metres south-east of the common boundary of Nos. 1b and 1c Court Lane;
 - (b) to prohibit north-westbound vehicles except pedal cycles in DULWICH VILLAGE from turning right into Calton Avenue, and prohibit south-eastbound vehicles except pedal cycles in DULWICH VILLAGE from turning left into Calton Avenue;
 - (c) in CALTON AVENUE south-east side, relocate an existing car club parking place, 7 metres in length, at the side of No. 1b Court Lane to a location outside Nos. 2-20 Calton Avenue;
 - (d) in CALTON AVENUE north-west side, to provide a loading place, 10 metres in length, extending south-westward from a point 8 metres south-west of the south-western kerb-line of Gilkes Crescent, in which vehicles may load or unload without time limit between the hours of midnight – 7 am, 10 am – 3 pm, and 7 pm – midnight on Monday to Friday, and 'at any time' on Saturday and Sunday; and
 - (e) to provide new or amend existing lengths of 'at any time' waiting restrictions in:- CALTON AVENUE (i) on the north-west side at the north-eastern extent of the closure referred to in 2(a)(i) above, and (ii) on the south-east side between its junctions with Court Lane and Gilkes Crescent; (iii) COURT LANE – on the south-west side opposite its junction with Dekker Road (20 metres); and (iv) GILKES CRESCENT – on both sides on the approach to its junction with Calton Avenue (20 metres).

NOTES: (1) These Orders would supersede similar provisions at the above locations implemented by way of experimental Orders made under section 9 of the 1984 Act (which would be revoked); (2) Exemption to the restrictions described in (a) and (b) preceding would be provided for emergency services vehicles, and in the case of the prohibition of motor vehicles, for vehicles used for road maintenance or cleansing purposes.

3. For more information contact Rachel Gates of the Council's Highways, Transport projects team - highways@southwark.gov.uk .
4. Copies of this Notice, the proposed Orders, and a statement of the Council's reasons for making the Orders together with plans showing the location and effect of the Orders may be either: found online at www.southwark.gov.uk/trafficorders, or inspected by appointment only at: Highways, Southwark Council, Environment and Leisure, 3rd floor hub 2, 160 Tooley Street, London SE1 2QH - from the date of this Notice until the end of a period of six weeks from the date on which the Orders are made. Contact traffic.orders@southwark.gov.uk (or 020 7525 3497) for booking details.
5. Anyone wishing to object to or make any other representations regarding the proposals, may use the form labelled '*Parking - Road traffic and highway schemes - responding to statutory consultation notices*' at www.southwark.gov.uk/statutoryconsultationnotices or send a statement in writing to: the Traffic Orders Officer, Highways, Southwark Council, Environment and Leisure, P.O. Box 64529, London SE1P 5LX or by e-mail to traffic.orders@southwark.gov.uk quoting reference 'TMO2122-015_DS Calton Avenue area' by 11 November 2021. Please note that if you wish to object to this proposal you must state the grounds on which your objection is made.
6. Under requirements of current access to information legislation, any letter or e-mail sent to the Council in response to this Notice may be subject to publication or disclosure, or both, including communication to other persons affected.

Dated 21 October 2021

Dale Foden Head of Service - Highways, Environment and Leisure

Statement of reasons

Dulwich Streetspace: Calton Avenue area



*The London Borough of Southwark (Prescribed routes) (Calton Avenue area) Traffic Order 202**

*The London Borough of Southwark (Charged-for parking places) (Calton Avenue area) Order 202**

*The London Borough of Southwark (Loading places and Waiting restrictions) (Calton Avenue area) Order 202**

The purpose to of these Orders is to implement a permeable road closure at the junction of Calton Avenue, Court Lane and Dulwich Village, amend existing parking, loading and waiting restrictions in Calton Avenue, Court Lane, Dulwich Village and Gilkes Crescent (which accommodate the closure) as permanent following review outcomes of experimental measures introduced in the Dulwich area (Dulwich Village ward), in the London Borough of Southwark.

The permanent closure will include an exemption for emergency services through Dulwich Village, Court Lane and Calton Avenue in addition to retaining all waiting and loading restrictions as per the original trial layout.

These Orders supersede similar provisions at the above location implemented by way of experimental Order made under section 9 of the 1984 Act (which would be revoked). The trial measures were part of the London Streetspace Programme – Dulwich (public notice originally advertised in *the London Gazette* on 18 June 2020¹), of which all parts of the trials will be revoked in full as parts are being proposed as new permanent changes to the Highway.

As part of the Dulwich Streetspace review an extensive public consultation was carried out for a period of 9 weeks. A good response rate was received, area-wide, and was representative of the community. The feedback received from the consultation has informed the proposals.

It is proposed to retain the permeable road closure at Calton Avenue, Court Lane and Dulwich Village to protect vulnerable road users at this junction. Monitoring has shown high-levels of pedestrians at peak times and a consistently high-level of cyclists. The permeable road closure will present the opportunity of enhancing the public realm to support the local economy and further encourage walking and cycling. The permeable road closure will be modified from the experimental trial to allow for access for emergency services following public feedback from the consultation and engagement with the emergency services.

There will be further engagement in 2022 with the community and businesses to redesign the space to meet their needs and aspirations and a comprehensive area-wide review of all the streetspace measures.

Link to decision:

<https://moderngov.southwark.gov.uk/mglIssueHistoryHome.aspx?lId=50027352&Opt=0>

Dated 21 October 2021

For more information contact:-

Rachel Gates

Transport Projects

Highways

Highways@southwark.gov.uk

¹ <https://www.thegazette.co.uk/notice/3579196>

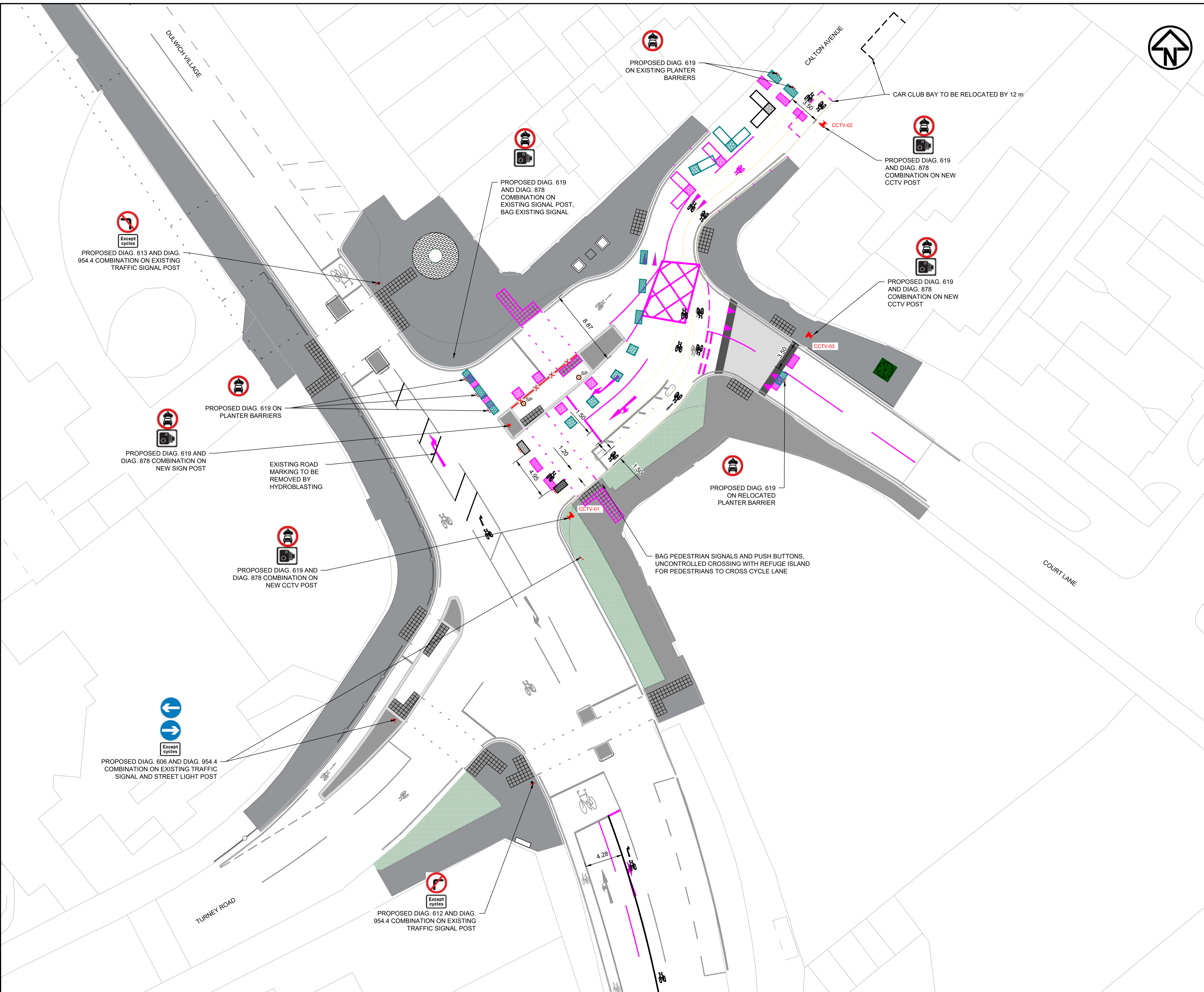

- NOTES:
1. THIS DRAWING SHALL BE READ IN CONJUNCTION WITH ALL MNRP DRAWINGS AND ALL OTHER RELEVANT ARCHITECTS, ENGINEER'S AND LANDSCAPE ARCHITECT'S DRAWINGS AND SPECIFICATIONS.
 2. ALL DIMENSIONS AND LEVELS SHOWN ARE IN METERS UNLESS OTHERWISE STATED.
 3. DO NOT SCALE FROM THIS DRAWING.
 4. REQUIRED ILLUMINATION OF REGULATORY SIGNS TO BE DETERMINED IN DETAILED DESIGN.

- LEGEND:
- EXISTING PLANTER - TO REMAIN
 - EXISTING PLANTER - TO BE RELOCATED
 - EXISTING PLANTER - PROPOSED RELOCATION
 - EXISTING PLANTER BENCH - TO REMAIN
 - EXISTING PLANTER BENCH - TO BE RELOCATED
 - EXISTING PLANTER BENCH - PROPOSED RELOCATION
 - NEW PLANTER
 - ROAD MARKING - EXISTING TO REMAIN
 - ROAD MARKING - EXISTING TO BE REMOVED
 - ROAD MARKING - PROPOSED
 - CCTV - POST AND CAMERA
 - TRAFFIC SIGN - PROPOSED SIGN AND POST
 - TRAFFIC SIGN - PROPOSED SIGN FACE ONLY
 - EXISTING TACTILE PAVING - TO BE REMOVED
 - EXISTING KERB TO BE REMOVED AND REINSTATED WITH ASPHALT
 - TRAFFIC SIGN AND POST - TO BE REMOVED
 - PROPOSED HIGH FRICTION SURFACING - BUFF COLOUR
 - EXISTING TACTILE PAVING TO REMAIN

REV	REV. DATE	PURPOSE OF REVISION	DRAWN	CHKD	APPRVD
F	09/09/2021	REMOVE KERBS ON ISLAND	MP	DD	AG
E	23/08/2021	COURT LANE CAMERA BY REQUEST	TDJ	DD	HM
D	17/08/2021	FOR INFORMATION	MP	DD	HM
C	10/08/2021	FOR INFORMATION	MP	MP	HM
B	05/08/2021	FOR INFORMATION	MP	MP	AG
A	23/07/2021	FOR INFORMATION	TDJ	MP	AGL

MNRP

CLIENT: Southwark Council
southwark.gov.uk

PROJECT: CALTON AVENUE INTERIM CONDITION CONCEPT DESIGN PHASE 1

DRAWING TITLE: GENERAL ARRANGEMENT INTERIM CONDITION

DRAWING STATUS: FOR INFORMATION

SCALE: 1:200 @ A1 DO NOT SCALE

SHEET: 001 OF 001

DRAWING NUMBER: 21116-MNRP-HGN-01-DR-001







REV: F

This drawing is not to be used in whole or part other than for the intended purpose and project as defined on this drawing. Refer to the contract for full terms and conditions.

DULWICH STREETSPACE MEASURES

CALTON AVENUE

KEY

-  Existing planters to be retained / rearranged
-  Proposed sign post
-  Proposed bays requiring permanent traffic orders
-  Restrictions requiring permanent traffic orders
-  Existing road markings to be removed
-  Existing sign and post to be relocated

NOTES

1. Double yellow lines to be installed where currently no restrictions are in place. Any existing on street parking to be suspended to accommodate vehicles turning.
2. Signs to be installed in locations shown to give advance warning of road closures.

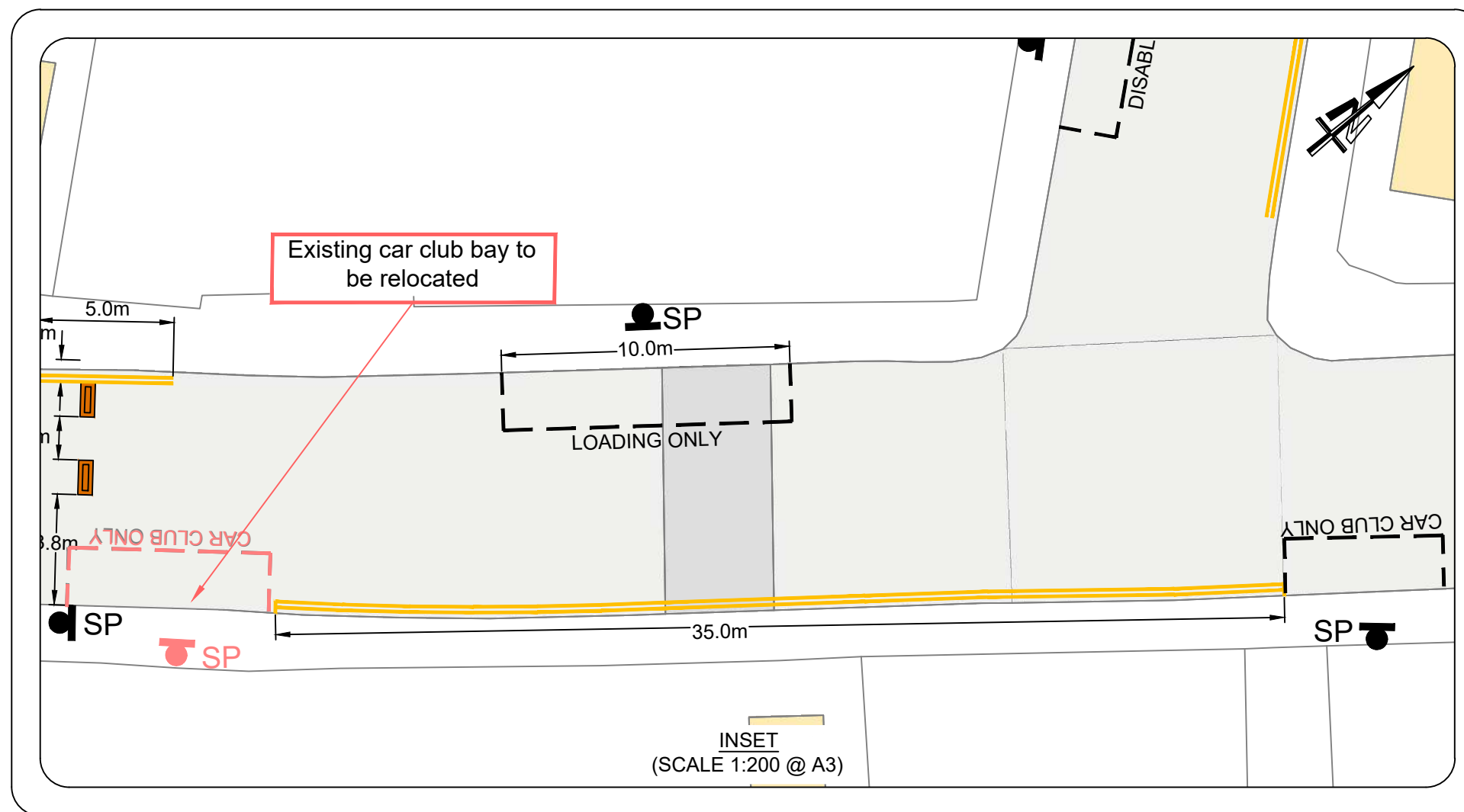
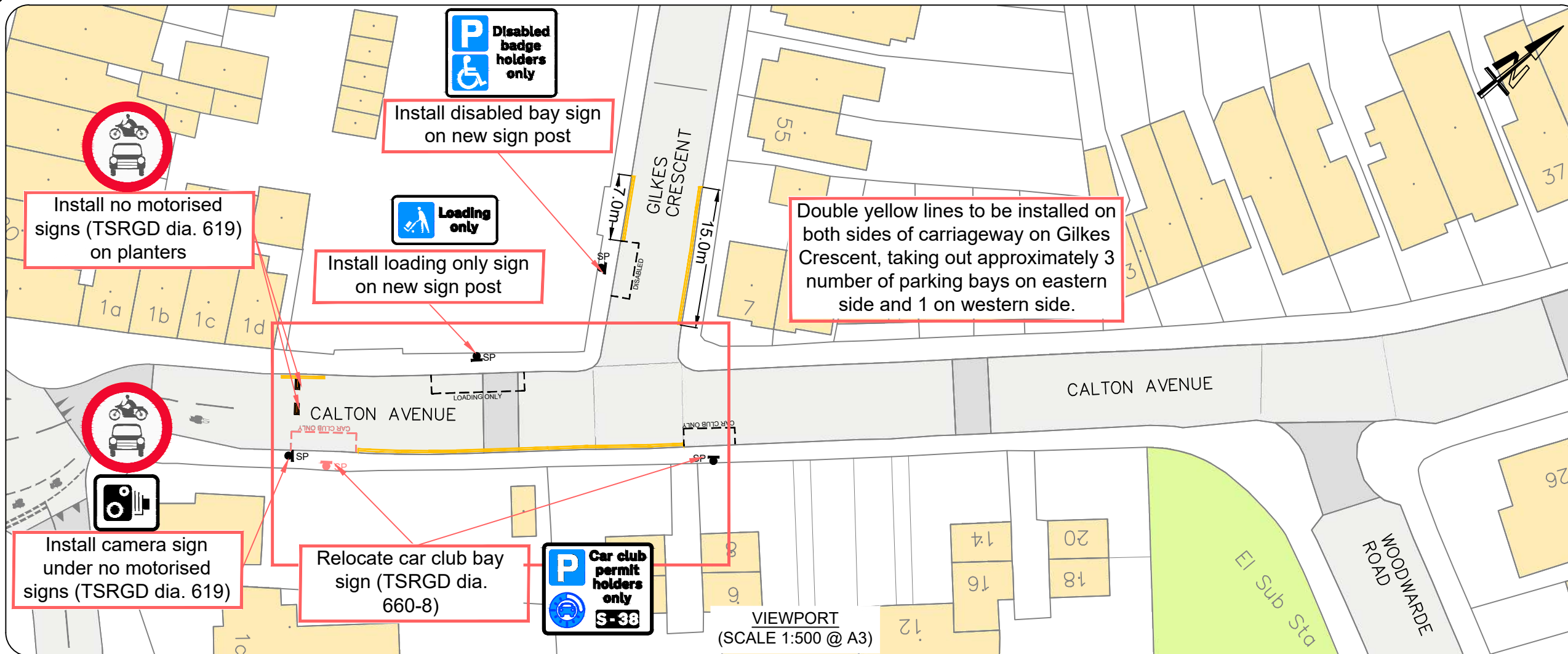



THE COUNCIL OF THE LONDON BOROUGH OF SOUTHWARK

TRAFFIC MANAGEMENT ORDER

202* No. ***

The London Borough of Southwark (Prescribed routes)
(Calton Avenue area) Traffic Order 202*

Made: ** ***** 202*

Coming into force: ** ***** 202*

The Council of the London Borough of Southwark, after consulting the Commissioner of Police of the Metropolis, in exercise of the powers conferred by sections 6 and 124 of and Part IV of Schedule 9 to the Road Traffic Regulation Act 1984^a, as amended, and of all other powers thereunto enabling, hereby make the following Order:

Citation and commencement

- 1.1 This Order may be cited as the London Borough of Southwark (Prescribed routes) (Calton Avenue area) Traffic Order 202* and shall come into force on ** ***** 202*.

Interpretation

- 2.1 In this Order:-

causing includes permitting;

“Council” means the Council of the London Borough of Southwark;

“electronic communications network” has the same meaning as in section 32 of the Communications Act 2003^b;

“enactment” means any enactment, whether public general or local, and includes any order, bye-law, rule, regulation, scheme or other instrument having effect by virtue of an enactment;

“kerb-line” means the imaginary line which is the projection of the line formed by the edge of the carriageway of a street;

“motor vehicle” has the same meaning as in section 136 of the Road Traffic Regulation Act 1984;

“pedal cycle” has the same meaning as in Schedule 1 to the Traffic Signs Regulations and General Directions 2016^c; and

“prescribed street” for the purposes of Article 5.1(d) of this Order means a street or part thereof referred to in either Articles 4.1 or 4.2 of this Order.

^a 1984 c.27

^b 2003 c.21

^c SI 2016/362

- 2.2 Any reference in this Order to any enactment shall be construed as a reference to that enactment as amended, applied, consolidated, re-enacted by or as having effect by virtue of any subsequent enactment.

Revocation

- 3.1 Without prejudice to anything done or any liability incurred in respect of any act or omission before the coming into force of this Order, the London Borough of Southwark (Prescribed routes) (Calton Avenue and Dulwich Village) (No. 1) Experimental Traffic Order 2020^d, and the London Borough of Southwark (Prescribed routes) (Court Lane) (No. 1) Experimental Traffic Order 2020^e, are hereby revoked.

Prescribed routes

- 4.1 No person shall cause any motor vehicle to enter into or proceed in that part of Calton Avenue which lies between the north-eastern kerb-line of Dulwich Village and a point 3 metres north-east of the north-eastern wall of No. 1d Calton Avenue.
- 4.2 No person shall cause any motor vehicle to enter into or proceed in that part of Court Lane which lies between the south-eastern kerb-line of Calton Avenue and a point 1.5 metres south-east of the common boundary of Nos. 1b and 1c Court Lane.
- 4.3 No person causing any vehicle other than a pedal cycle to proceed in a north-westbound direction in Dulwich Village shall, upon reaching its junction with Calton Avenue, cause that vehicle to turn right into Calton Avenue.
- 4.4 No person causing any vehicle other than a pedal cycle to proceed in a south-eastbound direction in Dulwich Village shall, upon reaching its junction with Calton Avenue, cause that vehicle to turn left into Calton Avenue.

Exemptions

- 5.1 Nothing in Articles 4.1, 4.2, 4.3 and 4.4 of this Order shall apply in relation to:-
- (a) any vehicle being used for ambulance, fire brigade or police purposes; or
 - (b) anything done with the permission or at the direction of a police constable in uniform; or
 - (c) any person who causes any vehicle to proceed in accordance with any restriction or requirement indicated by traffic signs placed on the highway pursuant to section 66 or section 67 of the Road Traffic Regulation Act 1984.
- 5.2 Nothing in Articles 4.1 and 4.2 of this Order shall apply in relation to any vehicle being used in connection with the removal of any obstruction to traffic, or the maintenance, improvement, reconstruction, cleansing or lighting of a prescribed street, or the laying, erection, alteration or repair in or adjacent to a prescribed street of any sewer, main, pipe or apparatus for the supply of gas, water, electricity, or of any electronic communications network, or the placing, maintenance or removal of any traffic sign, if the vehicle cannot be used for that purpose in any other street or part thereof.

Dated this ***** day of ***** 202*

[signature here]

DALE FODEN

Head of Service, Highways
Environment and Leisure

^d LBS 2020/052

^e LBS 2020/053

EXPLANATORY NOTE

(This note is not part of the Order)

This Order, on a permanent basis:-

- (a) provides 'no motor vehicles' restrictions in Calton Avenue at its junctions with Court Lane and Dulwich Village, and in Court Lane at its junction with Calton Avenue;
- (b) prohibits north-westbound vehicles other than pedal cycles in Dulwich Village from turning right into Calton Avenue;
- (c) prohibits south-eastbound vehicles other than pedal cycles in Dulwich Village from turning left into Calton Avenue; and
- (d) provides exemptions to all the above restrictions for emergency services vehicles, and in the case of the 'no motor vehicles' restrictions for certain vehicles used for road maintenance or cleansing purposes;

in the London Borough of Southwark.



THE COUNCIL OF THE LONDON BOROUGH OF SOUTHWARK

TRAFFIC MANAGEMENT ORDER

202* No. 0**

The London Borough of Southwark (Charged-for parking places)
(Calton Avenue area) Order 202*

Made: 202*

Coming into force: 202*

The Council of the London Borough of Southwark, after consulting the Commissioner of Police of the Metropolis, in exercise of the powers conferred by sections 45, 46, 49 and 124 of and Part IV of Schedule 9 to the Road Traffic Regulation Act 1984^a, as amended, and of all other powers thereunto enabling, hereby make the following Order:

Citation and commencement

- 1.1 This Order may be cited as the London Borough of Southwark (Charged-for parking places) (Calton Avenue area) Order 202* and shall come into force on 202*.

Interpretation

- 2.1 In this Order:-

“Council” means the Council of the London Borough of Southwark;

“enactment” means any enactment, whether public general or local, and includes any order, bye-law, rule, regulation, scheme or other instrument having effect by virtue of an enactment;

“map-based schedule” means the map attached to and to be read in conjunction with this Order and the Order of 2021, which depicts the parking place designated by this Order, and, in conjunction with the map schedule legend, identifies the type of each particular parking place and, if appropriate, certain of its governing provisions:

Provided that the Council does not accept responsibility for any inaccuracies contained in the Ordnance Survey data relied upon to create the map-based schedule and where a parking place is depicted on the map-based schedule, that parking place will continue to apply irrespective of any subsequent changes that have been made to the underlying Ordnance Survey data.

^a 1984 c.27

“map schedule legend” means the map schedule legend attached to this Order which, when used in conjunction with the map-based schedule, identifies the specific type of parking place designated by this Order and, where appropriate, certain of its governing provisions;

“the Order of 2021” means the London Borough of Southwark (Charged-For Parking Places) (Map-based) Order 2021^b; and

“traffic sign” means a sign of any size, type and colour prescribed or authorised under, or having effect as though prescribed or authorised under, section 64 of the Road Traffic Regulation Act 1984.

- 2.2 Any reference in this Order to any enactment shall be construed as a reference to that enactment as amended, applied, consolidated, re-enacted by or as having effect by virtue of any subsequent enactment.
- 2.3 Unless the context otherwise requires, any expression used in this Order which is also used in the Order of 2021 shall have the same meaning as in that Order.

Amendment of items in the map-based schedule

- 3.1 Without prejudice to the validity of anything done, or to any liability incurred in respect of any act or omission before the coming into force of this Order, the Order of 2021 shall have effect as though:-
 - (a) the existing item indicating the location of a car club parking place in Calton Avenue in the map-based schedule attached to that Order were omitted; and
 - (b) there were added to that map-based schedule the item indicating the location of a car club parking place in Calton Avenue in the map-based schedule attached to this Order.
- 3.2 The amendment referred to in Article 3.1 of this Order of an item in the map-based schedule will have the effect of revoking any provision provided or designated by a previous version of that item in the map-based schedule and not incorporated into the latest version.

Designation of parking place and application of the Order of 2021 thereto

- 4.1 Each area on a street identified the map-based schedule as a parking place and, where applicable, by way of the map schedule legend as an area marked out and signed for the use therein of specified classes of vehicles following the conditions specified in the Order of 2021 in relation to that type of parking place, is designated as a parking place.
- 4.2 Unless otherwise so identified, a parking place shall be bounded on one side of its length by the edge of the carriageway and be an area marked either by a traffic sign or by another method of indicating the extent of a parking place as specified in the Traffic Signs Regulations and General Directions 2016^c.
- 4.3 The provisions of the Order of 2021 (other than Articles 4 and 19) shall apply to the area designated as a parking place by this Order as if in those provisions any reference to a parking place included a reference to an area designated as a parking place by this Order.

Placing of traffic signs, etc

- 5.1 The Council shall:
 - (a) place and maintain traffic signs or other appropriate markings on the surface of the street indicating the limits of the parking place designated by this Order;
 - (b) place and maintain in or in the vicinity of each parking place, traffic signs indicating that such parking place may be used during the permitted hours for the leaving only of the vehicles specified in Articles 5.1 and 5.9 of the Order of 2021; and

^b LBS 2021/035

^c SI 2016/362

- (c) carry out such other work as is reasonably required for the purpose of the satisfactory operation of a parking place.

Dated this ***** day of ***** 202*

[signature here]

DALE FODEN
Head of Service, Highways
Environment and Leisure

EXPLANATORY NOTE

(This note is not part of the Order)

This Order, amends items in the map-based schedule attached to the Order of 2021, so as to permanently relocate a car club parking place in Calton Avenue south-east side, complementary to the closure of Calton Avenue to motor vehicles at its junctions with Court Lane and Dulwich Village, in the London Borough of Southwark.



THE COUNCIL OF THE LONDON BOROUGH OF SOUTHWARK

TRAFFIC MANAGEMENT ORDER

202* No. 0**

The London Borough of Southwark (Loading Places and Waiting restrictions)
(Calton Avenue area) Order 202*

Made: 202*

Coming into force: 202*

The Council of the London Borough of Southwark, after consulting the Commissioner of Police of the Metropolis, in exercise of the powers conferred by sections 6 and 124 of and Part IV of Schedule 9 to the Road Traffic Regulation Act 1984^a, as amended, and of all other powers thereunto enabling, hereby make the following Order:

Citation, commencement and expiry

- 1.1 This Order may be cited as the London Borough of Southwark (Loading Places and Waiting restrictions) (Calton Avenue area) Order 202* and shall come into force on 202*.

Interpretation

- 2.1 In this Order:-

“Council” means the Council of the London Borough of Southwark;

“enactment” means any enactment, whether public general or local, and includes any order, bye-law, rule, regulation, scheme or other instrument having effect by virtue of an enactment;

“map-based schedule” means the map attached to and to be read in conjunction with this Order and the Order of 2021, which depicts the parking place, loading place and waiting restrictions imposed by this Order, and, in conjunction with the map schedule legend, identifies the type of each particular waiting restriction, and, if appropriate, certain of its governing provisions:

Provided that the Council does not accept responsibility for any inaccuracies contained in the Ordnance Survey data relied upon to create the map-based schedule and where a parking place, loading place or waiting restriction is depicted on the map-based schedule, that parking place, loading place or waiting restriction will continue to apply irrespective of any subsequent changes that have been made to the underlying Ordnance Survey data.

^a 1984 c.27

“map schedule legend” means the map schedule legend attached to this Order which, when used in conjunction with the map-based schedule, identifies the specific type of parking place, loading place or waiting restrictions imposed by this Order and, where appropriate, certain of their governing provisions; and

“the Order of 2021” means the London Borough of Southwark (Free Parking Places, Loading Places and Waiting, Loading and Stopping Restrictions) (Map-based) Order 2021^b.

- 2.2 Any reference in this Order to any enactment shall be construed as a reference to that enactment as amended, applied, consolidated, re-enacted by or as having effect by virtue of any subsequent enactment.
- 2.3 Unless the context otherwise requires, any expression used in this Order which is also used in the Order of 2021 shall have the same meaning as in that Order.

Revocation

- 3.1 Without prejudice to anything done or any liability incurred in respect of any act or omission before the coming into force of this Order, the London Borough of Southwark (Loading bays) No. 2) Experimental Traffic Order 2020^c, and the London Borough of Southwark (Waiting and loading restrictions) (Amendment No. 8) Experimental Traffic Order 2020^d, are hereby revoked.

Amendment of items in the map-based schedule

- 3.1 Without prejudice to the validity of anything done, or to any liability incurred in respect of any act or omission before the coming into force of this Order, the Order of 2021 shall have effect as though:-
- (a) there were added to that map-based schedule the item indicating the location of a loading place in Calton Avenue; and
 - (b) there were added to or substituted in, as the case may be, that map-based schedule the items indicating the location of waiting restrictions in Calton Avenue, Court Lane and Gilkes Crescent,
- in the map-based schedule attached to this Order.
- 3.2 The amendments referred to in Article 3.1 of this Order of an item in the map-based schedule will have the effect of revoking any provision provided or designated by a previous version of that item in the map-based schedule and not incorporated into the latest version.

Designation of parking place and loading place and application of the Order of 2021 thereto

- 4.1 Each area on a street identified the map-based schedule as either a parking place or a loading place and, where applicable, by way of the map schedule legend as an area marked out and signed for the use therein of specified classes of vehicles following the conditions specified in the Order of 2021 in relation to that type of parking place or loading place, is designated as a parking place or, as the case may be, a loading place.
- 4.2 Unless otherwise so identified, a parking place or loading place shall be bounded on one side of its length by the edge of the carriageway and be an area marked either by a traffic sign or by another method of indicating the extent of a parking place or loading place as specified in the Traffic Signs Regulations and General Directions 2016^e.
- 4.3 The provisions of the Order of 2021 (other than Articles 4 and 15) shall apply to the area designated as a loading place by this Order as if in those provisions any reference a loading place included a reference to an area designated as a loading place by this Order.

^b LBS 2021/036

^c LBS 2020/055

^d LBS 2020/056

^e SI 2016/362

Waiting restrictions applicable in restricted streets

5.1 Without prejudice to the validity of anything done or to any liability incurred in respect of any act or omission before the coming into operation of this Order, the Order of 2021 shall have effect as though any waiting restriction identified in the map-based schedule and by way of the map schedule legend and marked out and signed as a waiting restriction shall be construed as though it were a restricted street referred to in the Order of 2021.

Placing of traffic signs, etc

6.1 The Council shall:

- (a) place and maintain traffic signs or other appropriate markings on the surface of the street indicating the limits of the loading place designated by this Order;
- (b) place and maintain in or in the vicinity of each loading place, traffic signs indicating that such loading place may be used during the permitted hours for the leaving only of the vehicles specified in Article 5.1(h) of the Order of 2021; and
- (c) carry out such other work as is reasonably required for the purpose of the satisfactory operation of a loading place.

Dated this ***** day of ***** 202*

[signature here]

DALE FODEN

Head of Service, Highways
Environment and Leisure

EXPLANATORY NOTE

(This note is not part of the Order)

This Order, amends items in the map-based schedule attached to the Order of 2021, so as to permanently provide a loading place in Calton Avenue, and add new or amend lengths of 'at any time' waiting restrictions at certain locations in Calton Avenue, Court Lane and Gilkes Crescent, complementary to the closure of Calton Avenue to motor vehicles at its junctions with Court Lane and Dulwich Village, in the London Borough of Southwark.