



# Foreward

This report has been produced for Southwark Council



## Acknowledgements

The team responsible for managing the development and production of this report includes officers of Southwark Council Public Realm Division, Parks and Open Spaces: John Wade, Rebecca Towers and Deborah McKenzie, with substantial input from the Cemeteries and Crematorium Manager (Avril Kirby), Monitoring Officers (Mark Thompson and Candy Edwards), as well as Tree Officer (Rachel Jackson), Henry Thompson (Service Development Manager) and Ecologist (Jon Best). Inputs have also been welcomed from officers within the planning section including Conservation Officer, ( David Lane) and Tree Officer (Oliver Stutter).

Written and produced by Harrison Design Development:



Paul Harrison      Claire Halestrap  
Andy Percival      Stuart Walker

With inputs from:



Alistair Henderson



Ron Dunn



Catherine Bickmore



Julie Rugg

**Conservation Management Plan:  
Camberwell Old Cemetery, Southwark.**

## **Contents**

### **Executive Summary**

<b>Section</b>	<b>1.0</b>	<b>Introduction</b>
	<b>2.0</b>	<b>Understanding the Site</b>
	<b>3.0</b>	<b>Statement of Significance</b>
	<b>4.0</b>	<b>Present Condition, Risks, Opportunities</b>
	<b>5.0</b>	<b>Conservation Management: Aims &amp; Policies</b>
	<b>6.0</b>	<b>Action Plan, and Masterplan</b>
	<b>7.0</b>	<b>Monitoring and Review</b>

## Figures

- 1.1 Location Plan
  
- 2.1 Early Maps (1839 Tithe Map)
- 2.2 Ordnance Survey 1874 1st Edition
- 2.3 1885 Surveyors Plan
- 2.4 Ordnance Survey 1895 2<sup>st</sup> Edition
- 2.5 Ordnance Survey 1912 (Surveyed)
- 2.6 Ordnance Survey 1950 (Surveyed)
- 2.7 Ordnance Survey 2011 (Published) with designations
- 2.8 Historic Plot Overlays
- 2.9 Aerial Photograph Current Day
- 2.10 Historic Images
- 2.11 Significant Monuments / Listed Structures/ Buildings
- 2.12 Phase 1 Habitat Survey Plan
- 2.13 Tree Survey Plan
  
- 3.1 Character Areas and Key Features
  
- 4.1 Photograph Location Plan
- 4.2 Photograph Sheets
  
- 6.1 Masterplan

## Appendices (separately bound)

- 2.1 Listings: Funerary Monuments and Sculptures, Architecture
- 2.2 Nature Conservation Assessment (Catherine Bickmore Associates July 2011)
- 2.3 Tree Preservation Order
- 2.4 Consultation Report: Executive Summary and Survey Results
- 4.1 Lawn Regulations and Leaflet
- 5.1 Parks and Open Spaces -Existing Roles
- 5.2 Heritage Memorial Code
- 5.3 Memorial Panel
- 6.1 Cemetery Strategy – Executive Summary and Figures

# Executive Summary

Southwark Council owns and manages three cemeteries, Nunhead Cemetery, Camberwell Old Cemetery and Camberwell New Cemetery. This Conservation Management Plan (CMP) has been set out to steer the management and the future development of Camberwell Old Cemetery. It has been researched and developed in conjunction with the Southwark Cemetery Strategy (adopted in May 2012). That Strategy sets out in detail how the cemeteries (and in particular Camberwell Old Cemetery and Camberwell New Cemetery) might be managed so as to enable the Council to continue to offer burial space through a wide range of measures including, where appropriate, the re-use and reclamation of older graves. The delivery of that burial space will necessarily involve changes in the management of the cemetery. Ongoing use for burial may also bring sustained revenue which in turn offers opportunities to direct funds toward the restoration, repair and positive management of the cemetery in the future.

This CMP considers the sets out a 'Statement of Significance' outlining where and why Camberwell Old Cemetery is important. Risks and opportunities are also set out along with key management aims. A 'Masterplan' is then proposed which ties in with the proposals set out in the Cemetery Strategy .

The Cemetery Strategy and the proposals have been developed further to input from local people and stakeholders and follows an extensive consultation exercise. The on-going involvement of local people and stakeholders is seen as key to the successful development and management of the Cemetery and, to this end, this CMP suggests a strengthened role for groups such as the Friends of Camberwell Old Cemetery in the future management of the Cemetery.

This CMP sets out the steps that can be taken immediately to manage the cemetery effectively with clear direction and purpose. It also sets out medium and longer term enhancements. With appropriate funding, and taken forward alongside the Southwark Cemetery Strategy, the CMP would assist in reversing the trend of decline and neglect that the cemetery has witnessed over recent decades. This will enable the best and most valuable features and attributes of the cemetery to be protected and restored, and its character enhanced for the benefit of the local communities.

Figure 1.1 Location Plan

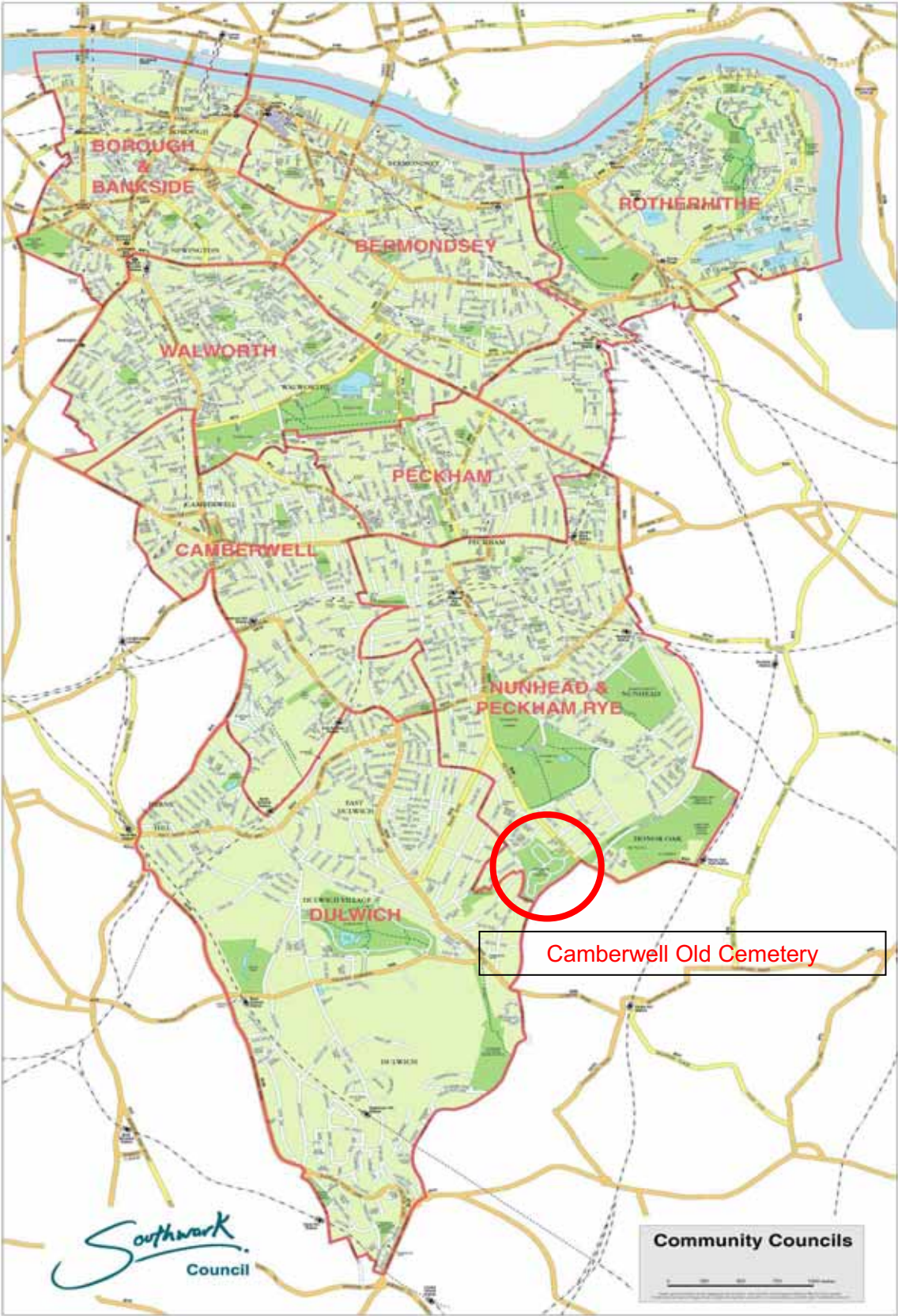

## 1.1 Introduction

- 1.1.1 This Conservation and Management Plan, is intended to guide the future development and management of Camberwell Old Cemetery, Forest Hill, Southwark. Commissioned by Southwark Council (SC), it has been developed under the guidance of Southwark Council Public Realm department , who currently manage the cemetery .
- 1.1.2 The CMP is to be read in conjunction with the *Southwark Cemetery Strategy* (adopted in May 2012 by Southwark Council). That Strategy seeks to provide burial capacity on a sustainable basis within the Southwark cemetery landholdings through a combination of use of unused (virgin or previously derelict) land, mausolea, burial within raised ground over old public burials and through the reclamation and re use of older graves.
- 1.1.3 In developing this Statement the views and contributions of a wide range of stakeholders have been sought as part of a consultation process including.
- 1.1.4 A Masterplan is also included with this document illustrating and describing proposals for the Cemetery that might be developed over the short, mid and long term. The Masterplan is in turn supported by an Action Plan setting out clearly the next steps that need to be followed.

## 1.2 Camberwell Old Cemetery- Location

- 1.2.1 Camberwell Old Cemetery is located in Forest Hill, Southwark, London SE22 0RU. It lies within the Nunhead and Peckham Rye Ward close to the south boundary of the borough. Its main entrance is located off Forest Hill Road. It extends to 11.6 hectares (11.88 ha including the original lodge and garden now within private ownership). It is bounded on its south west and north-west boundaries by Wood Vale, Langton Rise, and Underhill Road respectively. The rear gardens of properties (mainly residences) on Royal Oak Place and Forest Hill Road back onto the cemetery along the west boundary whilst rear gardens of Ryedale back onto the north boundary.
- 1.2.2 The main access for pedestrians and vehicles is through double gate alongside the lodge off Forest Hill Road. In addition there is a pedestrian access gate at the west corner at the junction of Langton Rise and Wood Vale.

1.2.3 The cemetery lies at the very southern limit of the Southwark borough. The borough of Lewisham extends south of Wood Vale immediately adjacent to the site.

### 1.3 Aims of the Conservation Management Plan

1.3.1 Current guidance, *Technical Guidance on the Re-Use and Reclamation of Graves in London Local Authority Cemeteries*, by London Environment Director's Network (2013) advocates that where a cemetery strategy involves the re-use or reclamation of graves, then any such strategy should be supported by a conservation management planning process.

1.3.2 This CMP follows that guidance and is also informed by guidance set out by English Heritage and the Heritage Lottery Fund (HLF) including:

- [Paradise Preserved](#) , [English Heritage](#), (2007)
- [Conservation Management Planning – Integrated plans for conservation, new work, physical access, management and maintenance of heritage sites, Heritage Lottery Fund \(HLF\) \(April 2008\)](#).

1.3.3 The document is designed to be further developed over time. The broad management proposals within it are capable of being developed more fully into a detailed Management Schedules and plans.

1.3.4 In summary the aim of the CMP is to:

- define the important qualities and attributes of the Cemetery by way of a Statement of Significance;
- illustrate by way of a Masterplan, the short, medium and long term development of the Cemetery;
- give guidance on appropriate management of its natural and cultural and historical heritage;
- to integrate these aspects of cemetery management with the proposed continued use of the cemetery for burial as a recreational and amenity asset.



## 1.4 Content of this Report

- 1.4.1 After this introduction and in line with the guidance, the document seeks to explain the significance of the heritage asset of Camberwell Old Cemetery (sections 2.0 and 3.0) its present condition, risks and opportunities (section 4.0)
- 1.4.2 Conservation management aims and detailed policies follow in section 5.0.
- 1.4.3 The Masterplan is illustrated and described in section (6.0) supported by a tables recommending a series of actions and management. Finally guidance of Review and Monitoring is included in Section 7.0.

## 2.1 Introduction- Research and Survey Work

2.1.1 Desk survey and site survey work has been carried out and research has been conducted considering the following aspects:

- Historic Development of the Site, Patterns of Consecration, (sections 2.2).
- Burial Uses, Layouts and Arrangements (sections 2.3).
- Funerary Monuments and Sculptures (sections 2.4).
- Cultural and Biographical Heritage (sections 2.5).
- Landscape Design (sections 2.6).
- Architecture (sections 2.7).
- Nature Conservation (sections 2.8).
- Arboriculture (sections 2.9).
- Amenity and Open Space (sections 2.10).
- Use Surveys and Value (sections 2.11).
- Current Management (sections 2.12).

## 2.2 Historic Development of the Cemetery, Patterns of Consecration

### *History*

2.2.1 The history of the cemetery and its burial patterns has been studied with reference to the burial records (see below), St Giles Vestry Minutes, historic Ordnance Surveys and plans and records held at Southwark Local Studies Library and the Metropolitan Archives. Ron Woollacott in his publications "*Camberwell Old Cemetery – London's' Forgotten Valhalla*" and "*Southwark's Burial Places Past and Present*" comprehensively describe the cemetery history whilst useful reference is also available in "*London Cemeteries An illustrated Guide and Gazetteer*" by Hugh Meller.

2.2.2 In the 1850's, The Camberwell Burial Board was established to solve the problem of Camberwell's burial shortage in its churchyards. In 1855 the board bought 12 hectares of meadow land and established it as the Burial Ground of St Giles, Camberwell, now called the Camberwell Old Cemetery.

2.2.3 Camberwell Old Cemetery was opened in 1856. The original layout included the distinctive central 'butterfly' arrangement of looping carriageways as well as two elongated loops extending north toward Ryedale Road (see Figures 2.2 and 2.3).

- 2.2.4 The cemetery was numbered by way of a grid of 'squares' sequenced from south to north and east to west (No1 lies off Wood Vale running to No 86 alongside Forest Hill Road). The squares are in fact rectangles 44m long by 27m wide. The boundaries of the squares do not co-ordinate with any paths or carriageways or site boundaries, nor are they aligned to north (See figure 2.8).
- 2.2.5 The cemetery was extended toward Langton Rise in the west (squares 87 to 96) and toward Underhill Road in the north west (sections 100-108) after 1874. In some areas it appears that the pathways giving access off the 'butterfly' to the north post 1874 extension were laid out over graves.
- 2.2.6 Original buildings by Sir George Gilbert Scott included an Anglican chapel set within a carriageway loop in the centre of the cemetery and a non-conformist chapel within a loop on the southern side and a Roman Catholic Chapel set adjacent to Wood Vale, all of which have now been demolished. The original Lodge of Forest Hill Road remains, now as a private residence.

### ***Consecrations***

- 2.2.7 From Records of the St Giles Vestry Board and other sources land within the main 'butterfly' arrangement extending to a line approximately from Theraphia Rd to Overhill Road was Consecrated in 1856. Land north of this line to Ryedale Road was consecrated in 1862. Land south and west of the 'butterfly' along Wood Vale and Langton Rise was left un-consecrated. (See figure 2.8).
- 2.2.8 Land within the north-west part of 1874 extension was consecrated in 1913 excepting for a 41' (12.5m) strip along the northern boundary, a 12' (4m strip along the Underhill Rd boundary and squares 105, 106, 107 – land which was left un-consecrated.

## **2.3 Burial Uses, Layouts and Arrangements**

### ***Burial Pattern Private Graves***

- 2.3.1 Private plots were sold mainly facing onto the paths and carriageways. Well-connected and affluent families took plots in sq58 (eg the Horniman family) and selected prominent plots on the corners of the paths carriageways around the Anglican Chapel. These are often sizeable memorials, some have features such as obelisks and statues, and some

are vaults. The majority of early private plots were taken up generally (but not always) in an irregular sequence of uptake, fanning out along the pathways from the central area. However, there was no apparent planning or rationale to this sequence. As the cemetery filled up, successive rows further away from the pathways were taken up and exhausted and eventually the space between first row and pathways were infilled. Finally many of the pathways themselves were infilled, (some of these infilled paths, visible on the burial plans, may in fact have been planned but never implemented).

- 2.3.2 An important consequence of this pattern of development is that the private plots (which were allocated the next number in sequence in the Purchase Register (see below)) could be positioned nearly anywhere in the cemetery, irrespective of date of purchase.
- 2.3.3 Whilst private burials reduced after the opening of Camberwell New, Camberwell Old has continued to receive 2nd 3rd and even 4th interments into historic plots throughout the latter half of the 20th century and into the 21st. Moreover, additional new plots have been located between private plots notably throughout the 1980s. Where depths have been sufficient new burials have also taken place over the top of Public burials (albeit sometimes only to single depth) for instance in sq 4, 5, 95. Recent infilling of paths has also taken place e.g in sq, 17 and sq1.26.
- 2.3.4 Many burial areas were cleared of monuments in the 1950s and again in 1976 and 1977. Other clearances have occurred incrementally. The private burial areas with the northern sections (north of the butterfly) have been left to become overgrown with dense cover of regenerating woodland and scrub enveloping the memorials many of which have fallen. For these reasons it is now very difficult to identify clearly the private plot arrangements in many areas.
- 2.3.5 The approximate outlines of private burial areas have been identified by overlaying the digital scans of Burial Plans (see below) with current Ordnance survey base, and current topographic survey data. The outlines of the private burial areas, as far as they can be deduced from their irregular numbering, has then been traced and highlighted in cyan on the Historic Plot Overlay- (See figure 2.8). . This approach clearly has limitations and inaccuracies (arising from accuracy of the original plotting, the scaling and overlay process and the accuracy of the OS base) but it gives a broad indication of the extent of private burial areas.

***Burial Pattern - Public Graves***

- 2.3.6 Throughout its early history public burials vastly outnumbered private grave sales and proceeded at a very great pace. Woollacott notes that by 1874 30,000 burials had taken place rising to 100,000 burials by 1893 and in 1898 burials were proceeding at a rate of 76 per week with Public graves being dug to accommodate up to 20 bodies each. By the time of the opening of the New Cemetery in 1927 burials in Camberwell Old had reached 279,714.
- 2.3.7 Public grave areas were set back from the pathways behind the Private graves. They were then laid out mostly but not always in rows aligned 'head to toe' and such patterns where evident on the Burial Plan (see below) highlight the Public areas. Given the difficult conditions in which Public graves were dug (tightly spaced, extremely deep, dug by hand often in wet clay) aligning head to toe leaving a gap (mid feather) between rows potentially minimised risk of collapse. Often plot numbering 'jumps' about or alternates in any one area suggesting graves were being dug so as not to be adjacent to one another. Several plots are likely to have been in use in different parts of the cemetery over the same periods of time. Many Public areas were subjected to successive second and even third 'waves' of digging - infilling mid-feathers between previous rows of interments (sometimes termed 'intermediate' arrangements).
- 2.3.8 Some Public burial areas were subsequently land raised and filled again (see areas F, G, below) and retained with low retaining walls. Trial pitting suggests that in these areas there remains around 3' minimum cover.
- 2.3.9 Public graves were allocated numbers within the Purchase Register in blocks of several hundred at a time. There is however no separate 'plot register' (see below) detailing interments within public graves. This means that it is not possible (at present) to readily ascertain the exact age (since last interment) of any public grave. From the records it appears that in June 1926 a batch of plots were the last pre war allocations as Public plots. Then, after the opening of Camberwell New Cemetery in 1927, all Public burials were directed to the New Cemetery.
- 2.3.10 Then in 1949, Camberwell Old started receiving Public burials again. From the records it appears that these burials (within plots numbered higher than 30499) generally lie in squares 2, and 7 and also infilling paths in sq 21,100, and 101 and also in an area in the north west corner of sq 103. Other areas may also have received later Public burials.

- 2.3.11 In addition between 1893 and 1954 9029 still born babies were also buried in Public graves and recorded in separate register. These were buried within the normal plot sequence. Human remains exhumed from other sites including the Quaker Burial Ground in Peckham, and the Lock Burial Ground Newham were also interred in Camberwell Old in the 1960's within public grave graves .
- 2.3.12 Early on Public burials were largely left without memorials although it was Public practice throughout the 1930s, 40s 50s and 60s to make use of a small memorial stone in Southwark's cemeteries . Nearly all of these stones have now been cleared and Public areas are mostly identifiable in that they are clear. In particular the areas between the heavily wooded private graves in the north east of the site are seen as open grassland areas. The approximate outline of the Public areas has been plotted through identifying areas with sequential numbering on the historic plot overlays and are depicted in green (pre 1927) (brown where post 1945).
- 2.3.13 Limitations in respect of the accuracy of these outlines applies as noted above. In addition this approach has relied on recognition of Public areas from the apparent sequencing of numbers on the Burial Plans. In order to verify that all plots are indeed public (and indeed pre 1927 or post 1945 as highlighted) individual areas will need to be checked thoroughly against the records- see below.

### ***Age Structure***

- 2.3.14 Because of the distribution of use across of various parts of the cemetery at any one time, infill burial along path edges and in the paths themselves, as well as 'intermediate' burials and 'created' burial spaces, the age structure (period elapsed since last interment) of the cemetery is 'mixed' with very few areas appearing to have a uniform and clearly apparent age structure. In addition the time elapsed since last interment has been re-set by the 2nd 3rd and 4th (and even 5th ) family burials in any one grave and this renders some areas that appear very old on the face of it, to be younger than they might appear.
- 2.3.15 In essence only a relatively small proportion of the cemetery notably areas immediately north of the main Wood Vale entrance and west of the first fork in the carriageway west of the entrance and appear to have a uniform age structure. These are noted as the Historic Core and Historic Monument character areas in Figure 3.1

## 2.4 Funerary Monuments and Sculptures

2.4.1 Funerary monuments within the cemetery are considered under the headings

- General Style of Memorials.
- Special or Distinctive Memorials.

### ***General Style of Memorials***

#### *Victorian Memorials*

2.4.2 Memorials from the mid and late Victorian period (1856-1901) are generally concentrated in the central and western parts of the cemetery and set back from the footpaths of the looping carriageways in the north of the cemetery. They include:

- i. simple monolith (single headstone) monuments
- ii. simple kerbsets with headplate and with/without chains/railings often gravel filled
- iii. ornate kerbsets with/without chains/railing with ledger slab or raised (4 way weather) ledger slabs
- iv. large ledger slabs with no upright headplate, sculpture or crucifix
- v. a small number of chest monuments on brick corbelled foundations
- vi. a large number of crucifix monuments usually associated with a full kerbset
- vii. a small number of allegorical sculptural monuments usually associated with a full kerbset
- viii. a small number of obelisk monuments

2.4.3 The simpler monoliths and kerbsets ((i) and (ii)) are generally set out as single plots (with standard size kerbset of 2'6" x 6'6" (0.76m x 1.98m)). More ornate types ((iv) to (viii)) are often set out as double or triple widths as a family plot.

2.4.4 Within central areas (see 'Historic Monument' character areas below) there are also a small number of very large family plots with elaborate kerbset tablet and headplate/stele arrangements, including the listed Horniman monument (see below) and a number of plots arranged adjacent to that monument.

2.4.5 Victorian monuments are generally of stone predominantly sandstones and granite but also including white pink and grey marble, portland limestone. Timber, slate, cast metal

and terracotta memorials are not generally evident. Many later Victorian headplates include inlaid lead inscription. Gothic style monuments predominate.

*Early to mid C20th monument*

- 2.4.6 Early to mid C20th monuments (to early 1930s) are generally simpler. These are predominantly found in the northern (overgrown) parts of the cemetery (off the looping carriageways) often as rows that infilled the original verges in front of older memorials/graves that had been set back from the paths.
- 2.4.7 Kerbsets with simple headstone predominate. Gothic and Arts and Crafts style are rare. Edward Classical or Edwardian Baroque styles predominate. Typical detailing includes an angular (usually flat or scroll topped) headplate/stele with stepped shoulders, sometimes tapering, and often with vertical or horizontal panels of embellishment. Arrangements are often asymmetrical. Kerbsets usually comprise four corner post, and four side kerbs infilled with gravel or glass. Often one or other component or side of a headplate or kerbset is of contrasting texture or rusticated. Marble and grey granite are particularly popular. Again kerbsets are of a standard size of 2'6" x 6'6".

*Late C20th and C21st Monuments*

- 2.4.8 Memorials from the 1940's, 50's, 60s and 70's are infrequent with burial having been directed during those decades to Camberwell New Cemetery
- 2.4.9 Black and white marble lawn and monolith memorials are evident, mostly dating from the 1980's. These are generally regular in appearance 75mm thick x 600mm wide x 90mm maximum height, often with symmetrical or asymmetrical curved tops to the headplates, and incised painted or gilded lettering. A smaller number of distinctive portland stone, slate or granite memorials in a variety of styles also date from the 1980's
- 2.4.10 In the C21st alongside the ubiquitous gilded black marble lawn memorial there has been a proliferation of extravagant memorials including large white marble double and triple width memorials, kerbset, and family memorials with paved areas.
- 2.4.11 Historic plots were as small as 2'11" x 6'9" (0.89m x 2.06m), with kerbsets of 2'6" x 6'6" (0.76m x 1.98m) set within them leaving only 6" (150mm) between adjacent kerbsets.



**Special or Distinctive Memorials**

2.4.12 Four funerary monuments within the cemetery are be Listed, as noted in Table 2.1.

These therefore carry statutory protection: Listing may be considered where memorials:

- are the work of a noted architect, sculptor or designer;
- possess special qualities of design and execution;
- are part of a special group, or play a key visual role in the landscape;
- are of interest in their symbolism or iconography;
- have inscriptions of exceptional interest;
- are of interest because of their materials or construction or where these reflect regional specialities;
- commemorate figures of clear national interest (an indicator would be if the individual is included in the Oxford Dictionary of National Biography)

**Table 2.1 Listed Memorials, Camberwell Old**

<b>Name</b>	<b>Sq/ No.</b>	<b>Listed</b>	<b>Description</b>	<b>At risk</b>
<i>Monument to Charles Waters</i>		<i>Grade II</i>	<i>C.1910. Marble group of a seated woman with a book/bible in lap embracing a small child on battered plinth.</i>	<i>Yes - Ground subsidence may cause serious disturbance.</i>
<i>Monument to Members of Public killed by Zeppelin</i>		<i>Grade II</i>	<i>C.1920. Stone weathered obelisk approx 3m high on 2 steps, inscribed on one side with the cross of Lorraine and surmounted with a cross of iron. The worn inscription gives the names of 21 civilians killed by bombing. There are large gold mosaic diamonds set around the inscription and the shaft is left roughly chiselled with smooth inscription stele emerging from it, surrounded by an oak and bay leaf garland.</i>	<i>No</i>
<i>Monument to James John Berkeley</i>			<i>c1865 Stone chest tomb with vermiculated top and 3 steps. Above is a statue of a reclining female with an oval bust.</i>	<i>Yes – Ground subsidence may cause disturbance.</i>
<i>Monument to Rebekah Horniman</i>			<i>c1895. To Rebekah, wife of FJ Horniman, tea merchant and founder of Horniman Museum. Tapering stone stele with moulded curved canopy with bronze tablet with figure of an angel.</i>	<i>Yes – Bronze tablet is missing presumed stolen.</i>

2.4.13 Full Listings are included at appendix 2.1. Listed monuments are shown on Figure 2.11. These memorials have particular local cultural or biographical associations rather than special architectural merit. The Horniman monument is particularly distinctive, albeit now despoiled with its cast bronze frieze having been stolen.

2.4.14 There are also a number of memorials managed by the Commonwealth War Graves Commission (CWGC) sited on the boundary of the cemetery north of the main gates including:

- a World War 1 memorial in the form of a substantial portland stone obelisk
- a portland stone memorial wall forming the boundary of the site inscribed with the names of the fallen of WWII
- a number of standalone memorials alongside the WWII wall.

2.4.15 Hugh Meller in his book *'London Cemeteries – An illustrated Guide and Gazetteer'* confirms that the cemetery does not have an abundance of architecturally significant memorials where he describes that:

*'the few monuments of note are near to the junction of the two main axial paths'*

## 2.5 Cultural and Biographical Heritage

2.5.1 Significant people buried within the cemetery of both local and national importance are documented in Ron Wollacotts book *'Camberwell Old Cemetery – London's' Forgotten Valhalla'*. There are a number of memorials or groups of memorials which have local significance commemorating individuals that are locally noteworthy or connected with a noteworthy event, or a local movement or groups. Full details can be found within Ron Wollacott's book. Graves are identified on Table 2.2 and Figure 2.11.

**Table 2.2** *Culturally or Biographically Significant Burials*

Square No.	Plot No.	Name	Year of Death.
5	8305	William Leonard Dowton JP	1913
5	8890	Arthur George Joseph Ellerthorpe	1909
8	6339	Revd John Chetwode Postans	1905
9	20922	Revd Dr John Holdsworth Morgan LL.D, Ph.D, FRAS	1908
9	7150	Professor James Tennant FGS, FRMS	1881
9	5407	John George Thomspson MA	1877
10	3784	Captain Donald MacDonald DL	1872
10	3784	Lady Ramsay MacDonald	1884
10	3784	General the Honourable Sir Henry Ramsay KCSI, CB	1893
10	4343	Henry William May BA	1878
10	1120	Charles Lee Nichols CBE, FICA, Knight of Grace of the Order of St John of Jerusalem	1922
11	5245	Lady Charlotte Gordon	1876
11	5128	Charles Rivington	1876
11	5128	Emily Rivington nee Myline	1897
11	179	Edward Wilmot Seale	1867
11	5261	George Crispe Whitley MA, MLSB	1918
16	29971	Revd Dr John William Ewing MA, DD	1951
16	137	John Andrew Lyon	1899
16	26127	Sir Frederick Phillips KCMG, CB	1943
16	23185	Harry Quelch	1913
16	29612	Joseph Russell Tomkins JP	1931
17	29501	Revd John Barraclough MA	1927
18	6046	Admiral Andrew Drew RN	1878
19	13171	George William Marsden Senior	1893
19	13171	George William Marsden Junior	1912
19	27168	Gerald James Molony JP	1932
20	3522	Joseph Wells	1871
23	4096	Revd Dr Thomas Ray MA, LL.D	1903
23	22625	Vane Ireton Shaftesbury St John	1911
23	4753	Revd William Pascoe Tiddy	1890
24	24032	John Nisbet JP	1925
24	18003	Arthur Robinson Wright ISO, FSA	1932
24	17859	Revd Edwin Wright	1902
26	20652	Alderman Thomas Coombs	1921
27	25545	George Herbert Kibble	1923
28	14260	Camilla Dufour Crosland	1895
31	19725	Revd Thomas Bradbury	1905
31	7116	James Collinson RBA	1881
31	7807	William Brighty Rands	1882
32	12173	Revd John Penny	1891

## Understanding the Site: Camberwell Old Cemetery

33	7320	Lieutenant-General Alexander Tod Cadell	1885
34	10829	Henry Augustus Corri	1888
34	10829	Ida Ghita Corri	1908
34	21984	Captain Samuel Allan Letts RN	1910
34	2134	John Nicholson	1894
34	18064	Percy Lane Oliver	1944
34	181	Revd Samuel Smith MA	1897
35	2012	Robert Alexander Gray JP, DL	1877
35	5119	Sir John William Kaye KCSI, FRS	1876
35	21585	Rt Hon George Bridges Harley Dennett Rodney DL, JP, Bt, 7th Baron Rodney	1909
35	1535	William Andrew Shields	1878
36	2734	Lt-Colonel James Fynmore RM	1887
36	10221	Alderman William Samuel Tothill Martin	1910
36	9615	Sir Alexander Pedler Kt, FRS, CIE, FCS, FIC	1918
36	4012	Isaac Shortland Shillingford MECS, LSA	1912
37	5122	Edward Clark	1894
37	2327	John Fuller	1865
37	9149	Major-General John Caulfield Hannyngton FRAS, FIA	1885
37	8209	Alexander Frederick Lovejoy	1896
37	5792	Albert Ernest Williams	1899
41	16392	Newton Crosland	1899
41	3976	William Henry James	1873
45	11040	William Armitage Brown Mice	1888
45	22904	Lady Dixon	1936
45	14350	Mary 'Minnie' Frith	1895
45	4774	Sir Edmund Robbins KBE	1922
46	915	Revd William Thomas Maudson BA	1859
46	2778	Nicholas Gibbs Wanostrocht	1895
46	3750	James Waterlow	1876
46	15148	George Henry West	1896
47	1656	James John Berkley Mice	1862
47	30439	Thomas Charles Willis Pullinger CBE, JP	1945
48	6027	Revd Philip Kent	1888
48	240	Samuel Lilley MA	1887
48	29249	Armigill Thomas Turpin OBE	1927
48	1988	Thomas Watts	1885
49	5827	Richard Farris	1878
50	29455	Lady Durrant	1927
51	12528	Revd Thomas Joseph Gaster	1909
51	27484	Ralph Prowde BA	1923
56	23657	Revd John William Munns	1914
57	14165	Frederick John Horniman	1906

## Understanding the Site: Camberwell Old Cemetery

57	20304	Fanny Esther Ann Kinghorne	1930
57	5975	Walter Parker Mynn	1878
57	3395	Charles Waters	1910
58	4048	Robert Bigsby LL.D, FSA, FRS, Knight of St James of Portugal	1873
58	22449	Allan Maxcey Galer	1938
58	22449	Revd Canon Reginald Galer MA	1947
58	5734	Robert Wentworth Little	1878
58	27519	Sir Henry G.Smallman Kt, Commander of the Order of the Redeemer of Greece, Knighthood (1st Class) of the Royal Order of St Olaf of Norway	1923
58	28457	Revd Clarence Charles A'Becket Thacker MA, LL.B, OBE	1946
58	15791	Richard Strong JP	1915
58	22902	Edgar Wiltshire	1912
59	7313	Sir Thomas Pink Kt, FRGS	1926
60	4429	Lt-Col Alderman Sir Archibald Davis Dawnay JP, ARIBA, CE	1919
60	12985	John Cook Reynolds	1893
60	11693	Edward Dresser Rogers Knight Chevalier of the Royal Order of Leopold	1890
60	12987	Mathew Wallace JP, DL	1917
60	11458	William Michael Watson	1889
61	3116	John Radford Young	1885
62	19075	William Stanlock or Stanlake VC, DCM	1904
63	27497	William Newell Logan	1932
67	11124	James Taylor	1889
69	23476	James Ebenezer Boon LRCP, LRCS	1941
69	30886	William Cash	1849
69	18656	James Henderson	1906
69	30886	Charles May FRS, FRAS, Mice	1860
69	5678	Revd David Nimmo	1898
69	27513	Mary Ann Savill	1930
69	22026	Alderman John Somerville	1910
69	4403	Mary Jane Taylor nee Cash	1887
70	24549	Revd Frank Mills Smith	1930
71	17120	William Harnett Blanch FRHisS	1900
72	21513	Alderman John George	1931
72	14174	Charles Robery Lindsay JP, BCS	1895
72	8873	Augustus Mongredien	1888
72	12752	Revd Canon Howard Nixon MA	1936
72	30068	Henry Alfred Wilmot	1933
73	20374	John Richards Manning Mice	1918
73	19710	Major Charles Lisle Watson	1970

82	30036	Revd Henry Atherton	1933
82	22705	Sir William Lane Mitchell JP	1940
83	16978	Revd John T.Dunn	1902
85	19435	The Armenian Martyrs: Tigran Krikorian, Arani Krikorian, Sagatiel Sagouni	
85	14322	Alice Emma Atkinson	1966
85	25538	Albert Edward McKenzie VC, RN	1918
85	25569	Revd Sydney Bicheno Smith BD, AKC	1918
93	30493	Alexander Joseph Dourof	1949
93	29814	William Thomas Kelly JP	1944
93	29634	Liam MacCarthy	1928
93	20692	William Margrie	1960
95	14973	John Adam Markillie JP	1908
106	26294	George Humphrey Burke	1920

2.5.2 Not all of these graves can be identified on site and others are currently hidden in undergrowth. A number have become dilapidated, with memorials removed.

## 2.6 Landscape Design

2.6.1 It is not clear who was responsible for the design of the cemetery, nor whether George Gilbert Scott, who had involvement in the design of its three chapels (see below) had a hand in that design.

2.6.2 In common with many Victorian cemeteries Camberwell Old was laid out with a clear design intent following the informal picturesque style with sweeping drives. This design is captured on the OS 1<sup>st</sup> edition of 1874 (Figure 2.2). There is a hierarchy of paths and carriageways, forming a distinctive central ‘butterfly’ arrangement of looping carriageways as well as two elongated loops extending north toward Ryedale Road with smaller connecting pathways. Trees appeared to be grouped in arbors with planting at key junctions and in front of the chapels. Substantial tree planting is indicated around the boundaries.

2.6.3 As noted above the cemetery was developed in a series of phases whereby:

- the original 1856 layout included the main entrance, the central ‘butterfly’ and the looping northern carriageways;
- the cemetery was then extended west toward Langton Rise and toward Underhill Road in the north west after 1874. Some pathways giving access off the ‘butterfly’ to the north and west were laid out over graves already recorded on the plans.

2.6.4 The original 1856 layout was recorded on the early 1874 OS 1st edition (1874) (Figure 2.2). The extended layout after 1874 was recorded on a ‘Surveyors Plan’ (by William Berriman of Camberwell, thought to be of 1885) and on the 1895 OS 2nd edition (Figures 2.3 and 2.4)

2.5.2 Whilst not recorded on the surveyors layout drawings it is clear from the original burial plans and the evidence of monuments on the ground that:

- significant memorials were to be sited at key junctions along the central carriageway;
- a central area of larger more prestigious family plots located where the carriageways divide just west of the main entrance;
- many carriageways were laid out with plots set back behind wide verges.

### 2.5.3 Of the original features:

- the sweeping layout of main carriageway remain;
- a number of the smaller connecting pathways have been lost, either reverted to become lawn or having become overgrown;
- many smaller paths have been lost having received burials throughout the C20th; and with infilling of a significant original path in the west taking place in 2010/2011;
- the original chapels were demolished in the 1930s and 1940's.

2.5.4 The two 'roundabouts' in front of the chapels have now been planted as rose beds set within close mown ornamental lawn set within low box hedging around the perimeter. At the non conformist chapel the roundabout has been surrounded with a low retaining wall (presumably using material from the demolished chapel) and raised. The actual site of the non conformist chapel has been similarly treated. The site of the Anglican Chapel has been formed into a rectangular car park.

2.5.5 At the main entrance there was until recently a similar arrangement of discontinuous box hedges along the carriageway margin with lawn behind and rose beds behind. Some of the hedging has been removed.

2.5.6 Fundamental changes effecting the original intent of the landscape design include that

- the northern part of the site is now entirely overgrown;
- substantial areas of public graves in the west (Underhill Rd) and north (Ryedale) (sq 100 to 108) have subsequently been subjected to substantial raising of levels through the import of soil;
- public grave areas in the south along Wood Vale and in the north along Ryedale have been marginally raised;
- there has been a proliferation of tree planting throughout the site which is not related to the layout;
- excepting near the main entrance, original open verges have been entirely infilled with plots.



## 2.7 Architecture

2.7.1 Three original buildings, by Sir George Gilbert Scott, were recorded on the OS 1st edition including:

- the *Episcopal Chapel* set in the centre of the cemetery
- the *Mortuary Chapel (Non-Conformist)* set to the south
- the *Lodge* of Forest Hill Road.

2.7.2 In addition to which a third chapel was located off Wood Vale in the north of the cemetery.

2.7.3 The 2nd edition similarly records these as Mortuary Chapels noting them as 'Church of England', 'Non-Conformist' and 'Roman Catholic' respectively. The chapels were located to serve the denominational areas, as reflected in the consecration boundaries (see above).

2.7.4 By 1912 a small building (a set of toilets and a staff room) was built on the left hand side of the main entrance and a small mortuary was established in the west off Langton Rise

2.7.5 Sometime after 1912 the grand gates and pillars and boundary railings along Wood Vale are recorded on the OS plans (although interestingly the matching pillars on the corner of Langton Rise and Wood Vale are not similarly recorded at that time). These boundary features are not listed.

2.7.6 Only the original buildings at Camberwell Old only the Lodge remains, now in private ownership. The Lodge is a listed building. Given its ownership, the Lodge is not technically within the scope of this CMP although the following observations are made:

- The building is divided into the main (residential) Lodge near the entrance – (predominantly in stone and highly decorated), and a series of simpler one and two storey blocks to the rear (south) in brick and render.
- The Lodge has a Gothic style with masonry of square-dressed grey limestone set within ashlar buff sandstone quoins and under a steep pitch slate roof.
- Ornate fenestration to the Lodge is in the form of gothic arches containing a plate tracery with trefoil set over two lancet glazed panels with central mullion. The rose, mullion and frame detailing is all in ashlar dressed sandstone. Bay windows

have simpler single panels but with blind tracery in trefoil pattern set within arched headstones above.

- Rich gothic revival Victorian detailing elsewhere on the Lodge includes ashlar dressed sandstone stringer course at the eaves, plinth courses, and corbelled buttresses.
- The Lodge appears to be in generally good condition and has not been significantly modified, (at least not on its east and north facing facades which overlook Forest Hill Road and the cemetery entrance respectively)
- The Lodge is now surrounded by tall planting and boundary fencing and the functional and visual relationship with the cemetery has been substantively altered.

2.7.7 The early C20th gates and boundary along Forest Hill are an imposing and intact feature, albeit the railings are now backed by a dense, tall leylandii hedge. The bellmouth is surfaced in cobble setts. The detailing includes:

- A main gate set back from the road side behind a wide pavement flanked by double gate pillars either side of the gate.
- An alignment either side of the double gates pillars that curves forward to meet the back-of-pavement line where it joins two further pillars, one each side.
- Ornate pillars with cut ashlar sandstone detailing including quoins, ornate steeply pitching stone copings, four protruding decorative carved faces (one at each corner of the coping), blind tracery relief in a quatrefoil pattern on the front faces, buttress detailing, with panels of squared limestone infill.
- A plinth wall in dressed coping of sandstone with chamfered/weather top over base of square dressed limestone. Steps down at regular intervals with plinth coping detailed to suit.
- Main railing panels with top mid and bottom rails set within posts to co-ordinate with plinth steps. Posts with three dimensional fleur-de-lys cast finial. Alternating full height/half height square section pales with two flattened fleur-de-lys cast finial.
- Wrought iron gates with vertical pales and 7 rails dividing 6 bands of detailing all in light wrought ironwork. Including (from top to bottom) flattened trefoil finials on the full height pales over the top rail, a band of decorated gothic arches, a band of double re-curved (multifoil) arches, a middle row of trefoil finials on the half height pales, a band of circle motifs with trefoil pattern, a second band of double re-curved (multifoil) arches, a bottom band of circle motifs with trefoil pattern.

2.7.8 The gateway on the corner Langton Rise has been recently refurbished and includes a set of contemporary gates, with an interesting curve (on plan) and new York stone surfacing. In 2101 a new footpath is being created in from this entrance on the line of the Green Chain Walk.

## 2.8 Nature Conservation

2.8.1 The Cemetery is a Site of Importance Nature Conservation (SINC) of Borough Importance (Grade 1). The Cemetery has been the subject of a nature conservation assessment (carried out by Catherine Bickmore Associates in July 2011) (Appendix 2.2) That assessment included a Phase 1 Habitat Survey and a broad overview of the whole cemetery, alongside a more detailed surveys of parts of the cemetery being considered at that time for burial. The assessment was cognizant of the detailed proposals for sites in the south of the cemetery and the potential proposals to re-develop areas to continue burials in other parts of the cemetery.

2.8.2 The assessment finds (para 4.29) that the Cemetery as a whole consisted of common and widespread habitats which are easy to re-establish and that the importance of the SINC lies mainly on account of its extent and location in an otherwise built-up area. Habitats types are illustrated on Figure 2.12 and include:

- Amenity grassland
- Species poor semi-improved grassland
- Tall ruderal
- Dense scrub
- Scattered scrub
- Introduced scrub (ornamental planting areas)
- Broad leaved semi mature woodand
- Scattered trees
- Species poor hedgerow

2.8.3 The assessment was made cognizant of the potential options for re-use, being developed at that time. Some of the areas proposed for re-use are characterized as being of 'amenity grassland' or species poor semi improved grassland with a fringe of scrub. It advises that the nature conservation interest of the amenity grassland does not offer a constraint in terms of burial but that habitat connectivity provided by the scrub around the periphery of the site should be retained as far as possible.

2.8.4 Further to this desk and walkover survey, bat surveys were also conducted (relating to particular trees that were proposed to be removed in 2011 and 2012). A number of trees were identified as having 'moderate' or 'high' potential to support bat roots and further emergence surveys were carried out confirming the presence of bats (Common Pipistrelle *Pipistrellus pipistrellus*) in some instances. These surveys along with anecdotal evidence of bat sightings suggest that some older trees within the cemetery may in some cases provide bat roots which in combination with the woodland edge and grassland may provide good foraging/feeding habitat.

## 2.9 Arboriculture

*General Species Composition, General Age Structure.*

2.9.1 An overview survey has been conducted at Camberwell Old Cemetery. A GIS survey provided by Southwark Council proved out of date with numerous inaccurate locations. Tree locations have been studied with reference to the original 1885 survey plan and Ordnance Survey plans (Figure 2.1 to 2.6) and against the burial records to gain an understanding of their likely ages or origins. Trees have been simplistically plotted at figure 2.13 using the aerial photography base. In broad terms the trees include:

- i. a small number of large mature oak, some potentially dating from the original field boundaries or from the original 1856 layout;
- ii. a number of large mature Horse Chestnut sited on public burial areas (and likely to date from the early 20th century having been planted after these areas became 'full');
- iii. a number of large mature Horse Chestnut planted in what may have originally been 'verge' areas now subsequently infilled with graves;
- iv. a small number of over-mature yews in the northern part of the site potentially remaining from the original layout;
- v. a small number of mature cypress around the site of the non-conformist chapel (from photographic evidence appearing to date from the late C19th or early C20th);
- vi. avenues of mature plane and lime around the site of the non conformist chapel (from photographic evidence appearing to date from after the demolition of the chapel in the 1930's /1940's);
- vii. a number of mature Hornbeams in the central part of the site;
- viii. a large number of mature sycamore and ash most likely to have been self seeded widely distributed throughout the cemetery;

- ix. numerous smaller ornamental varieties including pear, cherry, hawthorn, laurel and other ornamental trees distributed across the site;
- x. a mature bay tree north of the site entrance;
- xi. a dense area of regenerated secondary woodland that has regenerated within the areas of private graves in the northern part of the site;
- xii. a less dense area of scrub and scattered trees including mature sycamore and ash on disturbed and embanked ground along the Underhill and Ryedale Road boundaries.

2.9.2 The extensive areas of dense secondary woodland (xi) is mainly of ash and sycamore and elder has developed since the 1970's in the consecrated private burial areas in the north. In many instances this woodland has enveloped and hides some of the more mature tree planting. The areas have seen only limited management in recent years.

2.9.3 All the trees at Camberwell Old are covered by a group Tree Preservation Order (TPO) dating back to 1991 (Appendix 2.3)

*Historic Planting and Design.*

2.9.4 A few trees potentially originate from the original design. These might include some of the large mature oaks and large yew within the northern parts of the cemetery, a large plane and single bay north of the main entrance. The original planting structure, if it was ever realised, is not evident today.

*Special/Distinctive/Veteran/Trees.*

2.9.5 Despite the group Tree Preservation Order there are very few individually special distinctive or veteran trees. Some of the mature large oaks are attractive mature specimens as are the numerous substantial horsechestnut.

*Southwark Tree Management Strategy*

2.9.6 The Southwark tree management strategy sets out a policy framework for the trees owned managed and protected by the Council. The key objective of the strategy is to improve the maintenance and management of the Borough's trees in order to enhance the condition and overall safety of Southwark's tree stock. The strategy recognises that trees have a wide range of environmental, aesthetic, economic, health and biodiversity benefits and should be protected where necessary.

## 2.10 Amenity and Open Space

### *Southwark Open Space Strategy 2011*

2.10.1 The Cemetery was assessed as part of a comprehensive review of open space across the borough - in 2011- 'The Southwark Greenspace Strategy' In total, the Peckham and Nunhead sub area in which the cemeteries are located have a total of 1.18ha of park provision per 1,000 population, which is above the Borough wide average provision of at around 0.91ha / 1,000 open space (a provision which is expected to fall to 0.76ha per 1,000 population by 2026 as the population increases.).

2.10.2 The open space assessment included consideration of 18 Green Flag criteria (or 'dimensions') which could be assessed through a visual appraisal of the site using a scoring range of 1-6 (discounting any 'dimensions' that were not applicable). The 'dimensions' of quality considered were:

- The conservation of natural features.
- The conservation of landscape features.
- The conservation of buildings and structures.
- The provision of educational interpretation facilities.
- Standards of arboriculture and woodland management.
- Whether the space was welcoming.
- The accessibility of a site and the safety of site access.
- How well signposted the space is.
- Whether there is equality of access to and within the space.
- The safety of equipment and facilities
- Levels of personal security within the space.
- Evidence of dog fouling and availability of appropriate provision (designated bins, dog walks).
- The appropriate provision of facilities for the type of space.
- The quality of facilities.
- The cleanliness of a site including litter and waste management arrangements.
- Standards of grounds maintenance and horticulture.
- Standards of building and infrastructure maintenance.
- Standards of equipment maintenance.

2.10.3 The study also looked at Value that open spaces played taking into account :

- The context of the open space, which largely concentrates on the local open space need
- within the vicinity of the space and site access.
- The amenity value of spaces.
- The ecological role performed by spaces.
- The environmental value of spaces.
- The existing educational value of spaces to the community.

- The recreational function performed by the open space.
- The structural role of open space in separating and defining communities.
- The cultural and social value of spaces.

2.10.4 On the basis of this survey Camberwell Old Cemetery scored at 36.1% for Value and 75.3% for Quality – which is above average quality and above average value for open-spaces across the borough as a whole.

2.10.5 This finding contrasts with the findings of a detailed ‘residents survey’ which was also carried out as part of the Southwark Open Space Strategy. That residents survey revealed that, although the perception of quality of open space was in line with the wider borough, the level of satisfaction with open space in general is one of the lowest in the borough (Box 2.1).

**Box 2.1 Residents Survey Open Space Study in Southwark- in 2011**

**Quality Of Spaces**

C.8.15 Those categories rated as being good or very good quality sites are Thames Path (89%), Metropolitan Parks (88%), outdoor sports facilities (78%) and children’s play area (78%).

C.8.16 Categories with a higher proportion of poor or very poor ratings include amenity areas (18%), cemeteries (10%) and smaller local parks (7%).

**Satisfaction And Quality Of Life**

C.8.17 Respondents in the Peckham and Nunhead sub-area recorded the second lowest levels of satisfaction with open space (76%), with only Elephant and Castle scoring lower with 71%.

C.8.18 In terms of the contribution open space plays in respondent’s quality of life, 79% of respondents feel open space contributes a little or a lot to quality of life in the Peckham and Nunhead sub-area which is lower than the sub-areas of Bankside, Camberwell, Canada Water and Dulwich

2.10.6 The Southwark Greenspace Strategy also makes reference to the *Peckham and Nunhead Area Action Plan 2011(AAP)*. A series of objectives within the AAP, of relevance to the management and delivery of open spaces include:

- Theme 2: Community Wellbeing, improving individual life chances: Promoting a network of high quality and easy to access open spaces that serve a range of functions, including recreation and children’s play, sports facilities, nature conservation and food growing.

- Theme 3: Traffic and Transport, improved connections: Making Peckham and Nunhead a more convenient and comfortable place to access and move around by walking and cycling.
- Theme 5: Natural Environment, sustainable use of resources: To protect, maintain and improve the quality, quantity and accessibility of open space. To promote opportunities for wildlife and protect sites of nature conservation value. To reduce the impact of development on the environment and help tackle climate change, air quality, pollution, waste and flood risk.
- Theme 6: Design and Heritage, attractive places full of character: Conserve and enhance the historic environment and use the heritage of places as an asset to promote positive change.

2.10.7 Particular strengths of Camberwell Old Cemetery in meeting these objectives are that:

- the Green Chain Walk , a strategic well-signposted and popular walk passes directly through the Cemetery;
- it has recognised value for wildlife;
- it is a place of character with recognised heritage value including listed structures.

2.10.8 In terms of its amenity and facilities a simple survey of the Cemetery reveals:

- there is no toilet;
- there is no signage nor on site direction to any other web resource or other resource explaining the heritage or nature conservation value;
- there are very few benches;
- there are no high quality horticultural displays;
- within the cemetery dog walking is allowed provided dogs are kept on leads. Dog waste bins are provided;
- there is clear information displayed as to opening times facilities available and contact details at the main entrance.

2.10.9 Opening times are limited generally being 8.30am-5.0pm in the winter month (10.0am - 5.00pm Sunday) and being 8.30am- 7.0pm in the winter month (10.0am -7.00pm Sunday).



## 2.11 Use Surveys and Value

### *Cemetery Consultation 2011*

2.11.1 From 4th July to 30th September 2011, Southwark Council carried out a broad consultation with residents and stakeholders in relation to the future of burial, and of the cemeteries in Southwark. The Council sought peoples' views on the use of the cemeteries and their views on the future of burial in the borough, given the lack of burial space available. 942 responses to a questionnaire were received with 1,000 individual detailed comments. More than 170 people attended consultation meetings that took place in a variety of locations. An Executive Summary is included at Appendix 2.4.

2.11.2 A key issue was whether older graves within the cemeteries (Nunhead, Camberwell Old and Camberwell New) should be re used for burial. One option, also under consideration at the time was that part or all of Honor Oak Park might be used for burial. Strong feelings were expressed by many on the subject, and these were often polarised according to whether people had a preference for burial or cremation:

- the comment that 'Land is for the Living' featuring on several forms submitted;
- many people emphasised their emotional attachment to the borough and felt strongly about being buried in the place in which they had lived all their lives;
- re use of public graves and re use of private graves were the two most popular options expressed for the resolution of the burial capacity issue;
- there was a groundswell of local opinion opposing the use of Honor Oak Recreation Ground for future burial.

2.11.3 The survey also sought information as to how and when people used the cemeteries. This was not cemetery specific. Of the 942 respondents, 52% surveyed visited the cemetery occasionally, 33% visited monthly, 10% weekly and 5% never visited the cemeteries. The largest majority of survey respondents visited the cemeteries for recreation. (65%) This was followed by visiting a relative or friend's grave or memorial plaque with 'other' reasons also being cited.

2.11.4 Usage Survey Report 2011

2.11.5 A detailed usage survey was also carried between April and June 2011 by Alexandra Robb on behalf of the council. This gave a more detailed picture of usage than the broader consultation which considered burial provision and the future of the cemeteries as

a whole. The survey included face to face interviews, survey forms , and head count techniques. Key findings for Camberwell Old include that

- 77% of visitors do so to visit a grave of relative of friend
- Those visiting for recreation (23%) do so to walk the dog or use the cemetery as a convenient access route.

2.11.6 Subsequent observations over many months during the preparation of the Cemetery Strategy and this CMP confirm these initial findings and suggest:

- a large number of people visiting the cemetery for recreation do so to walk a dog;
- a smaller number use the cemetery or to walk/run for exercise;.
- a significant number of people use the Green Chain Walk mostly on foot but also by bicycle to pass between Langton Rise/Wood Vale and Forest Hill Road (where there are shops, pubs restaurants and bus services toward central London);
- on relatively few occasions individuals have been observed sitting /relaxing/ picnicking in the open areas of the site.

2.11.7 Responses to the survey highlighted in Box 2.2 suggest that:

- Most people considered the cemetery to be well laid out with clear paths.
- Maintenance was considered good to fair.
- Signage received a rating of good to fair,
- Most people felt safe in the cemetery,
- Most people found the cemetery welcoming

### **Box 2.2 Usage Survey: Public Response to Aspects of Environment**

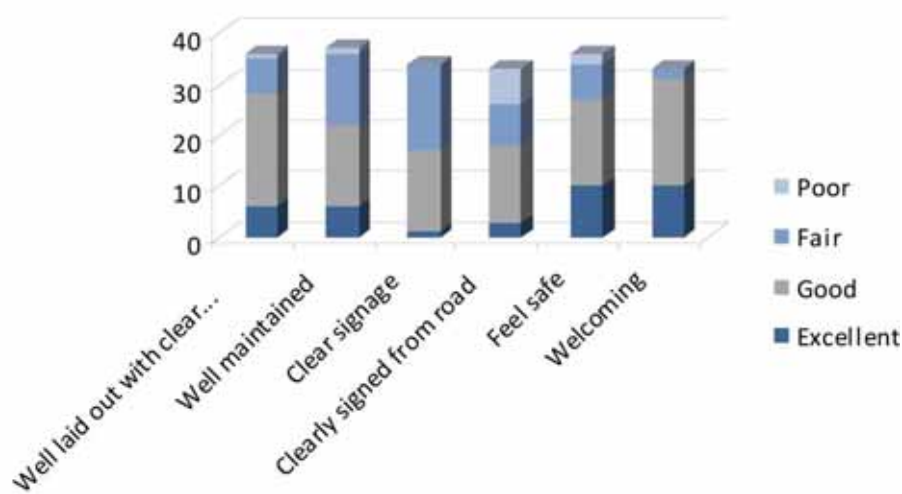

2.11.8 As with the two other Southwark cemeteries the most popular suggestions for improvements (Box 2.3) were the provision of more information on history, trees and wildlife. Improvements to maintenance scored highly as did improved signage. Improved paths and signage from the road scored equally highly. Other suggestions included provision of more taps to assist with the watering of plants at grave sides as well as provision of toilets.

**Box 2.3 Usage Survey: Public Response Areas for Improvement**

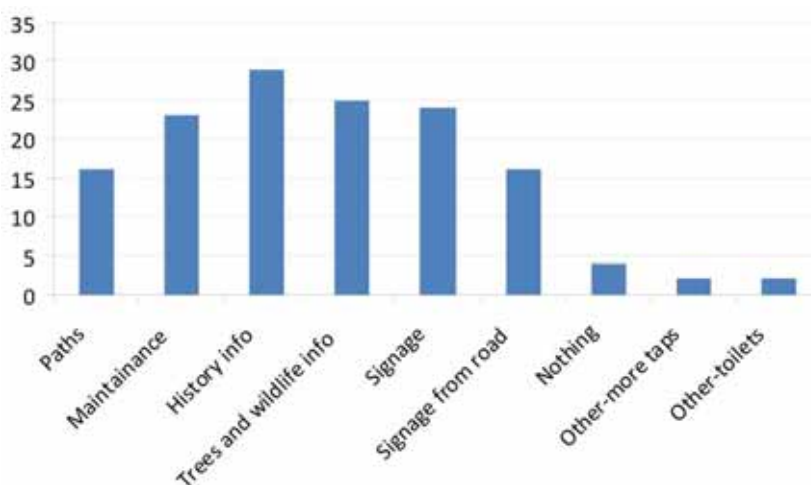

2.11.9 When asked about specific improvements at Camberwell Old Cemetery responses included:

1. Better maintenance
2. Cut grass should be cleared from graves more often
3. Repair and re right stones that are leaning or have fallen
4. Longer opening hours
5. Wild area is not friendly, it should be better managed
6. Some graves and memorials are a bit flashy and not in keeping with feel of the cemetery.
7. Like the new gates, we feel safer
8. Don't like the way people hang things, such as wind chimes on trees near graves.
9. Bins need to be emptied more regularly
10. Cemetery quite untidy a lot of the time.
11. More seating for the public

12. More information about the history of the graves and the cemetery.
13. Guided walks like those at Nunhead
14. Start a Friends Group, like Nunhead.
15. Maps and information made available

## **2.12 Current Management and Maintenance**

- 2.12.1 Camberwell Old cemetery is managed by the Cemeteries and Crematorium Manager with inputs from number of other sections within the council. Some functions appear to overlap.

### *General Maintenance*

- 2.12.2 Maintenance of the site is currently undertaken by a private contractor (Quadron) under a contract that has been tendered and procured by the Service Development Manager (Grounds Maintenance) Lead Contract Manager. That contract is due for renewal in 2014. Works on the ground are monitored by two Monitoring Officers, who work under the direction of the Cemeteries and Crematorium Manager. That maintenance principally includes:
- i. General grass cutting 18x annually (fortnightly in growing season) to 30mm nominal height
  - ii. cutting of spring and/or of summer meadow with a twice (2x) annual cut, rake and removal
  - iii. cutting of conservation grass areas 6x annually to 150mm nominal height
  - iv. ornamental grass cutting, boxed and removed (weekly through growing season)
  - v. maintenance (hand weeding, pruning) of shrub or flower beds on a monthly cycle
  - vi. cutting of formal/informal hedges (up to 1.8m high maximum) on a monthly cycle
  - vii. strimming (or burning ) treatment to weeds arising on surfaces
  - viii. maintenance of 'conservation borders' (native scrub areas) including litter clearance, barrier clearance (encroachment)- not scheduled, carried out 'as and when' deemed required
  - ix. removal of general litter
- 2.12.3 In practice this regime simplifies the picture of what happens on the ground. Most of the central and south part of the site (i.e the main 'butterfly' and not northern wooded area) is mown as if general amenity grass. In fact the more historic areas in the core and south of the site are kerbset (traditional) burial areas and are actually strimmed using petrol driven strimmers, (not apparently as regularly as 18x annually but not as

infrequently as 'conservation grass' maintenance regime). Areas where kerbsets have been removed or where modern lawn burials have been introduced are also strimmed first around headstones before being then mown with larger mowing machines.

- 2.12.4 Elsewhere small ornamental lawn areas either side of the entrance and within the roundabout in front of the site of the CoE Chapel appear to be box cut to a much finer finish.
- 2.12.5 There are limited areas of 'conservation grass' fringing Wood Vale in squares 7/15/23 (and soon to become part of area area F/F1) and also across areas set back from the paths in areas 20/21/28/29. The grassland within the heart of the regenerating woodland (Woodland Glades) is also managed as conservation grass.
- 2.12.6 A Pesticide Reduction Strategy is in place which also extends to herbicides, meaning that chemicals are not used except where absolutely necessary.
- 2.12.7 The Cemeteries and Crematorium Manager maintains oversight of the maintenance contractor through the Monitoring Officers.

#### *Tree and Scrub Management*

- 2.12.8 The following items are not included in the standard maintenance regime:
- x. Control and management of trees/woody scrub/shrubs as and where they regenerate (notably within grave/kerbsets).
  - xi. Management of dense stand of regenerating woodland in the north of the site
  - xii. Removal or pruning of dead, diseased, dying or dangerous trees
  - xiii. Other forms of management of trees to best arboricultural practice through thinning coppicing
- 2.12.9 In respect of (x) above the council ecologist in liaison with the Cemeteries and Crematorium Manager and Monitoring Officers carries out periodic inspections and arranges for coppicing or pollarding or thinning of individual trees or stands of trees within the areas of regenerating woodland in the north of the site.
- 2.12.10 The section Arboricultural Officer also makes periodic inspections of standard trees in high target (high footfall/roadside ) and in conjunction with the Cemeteries and

Crematorium Manager and Monitoring Officers work schedules are agreed which are then carried out by one of a number of shortlisted tree surgeons, thus partly addressing (xi) and (xii) above.

2.12.11 There is no strategic plan for carrying out arboricultural works, either in the woodland areas or of individual trees.

#### *Infrastructure*

2.12.12 The following elements relating to infrastructure are not included in the standard maintenance regime:

- xiv. Inspection, and repair of potholes/cracks/defects in paths and carriageways, resetting of damaged/displaced kerbs
- xv. Cleaning of drainage gullies
- xvi. Inspection and repair of water stand pipes and bib taps
- xvii. Repair/painting of historic railings and gates
- xviii. Inspection, repair pointing and or cleaning of masonry to boundary features

2.12.13 Monitoring Officers carry out periodic inspections commission repairs and maintenance as and when elements need immediate repairs. Historically these repairs have been limited on account of budget. There has historically been no strategic programme for infrastructure repair.

#### *Burials and Plots*

2.12.14 The following works are sometimes included in maintenance contracts for cemeteries but in Southwark they are not.

- xix. Levelling and consolidation of grave mounds and/or removal of excess soil 1-3 months after burial and/or re-turfing of graves after 3 months
- xx. Topping up (with loamy topsoil) of grave plots that have subsided and reseeded or re-turfing.

2.12.15 Arrangements for grave-digging vary widely across the country. In larger municipal cemeteries grave-digging staff are often direct employees managed by the Cemetery/Crematorium Manager (and this is the case at Southwark). Where grave-digging teams are direct employees sometimes the team takes responsibility for

levelling/clearance/consolidation/reseed/re-turfing work in the 'down time' between grave preparation.

2.12.16 This has been the case to some extent at Southwark but the work appears to have been carried out as a low priority and on a reactive basis. Final topping up and re-seeding of plots has been carried out by the maintenance contractor (using loamy topsoil) as and where directed by the Manager.

2.12.17 Recent trials have been undertaken with more comprehensive levelling and consolidation, and re turfing of Area E in Camberwell Old (north of the main gates adjacent to the war memorials), 3 weeks after the last burial in the area.

#### *Memorial Management*

2.12.18 Responsibility for the overall safety within a burial ground lies with the burial authority, which has responsibilities under the Health and Safety at Work Act 1974 and the Occupiers Liability Acts of 1957 and 1984 to ensure that, as far as reasonably practicable, their sites are maintained in a safe condition. Inspections and testing for memorial stability is made on a 5 yearly cycle in accordance with guidance from the Institute of Cemetery and Crematorium Management. Including that:

- All persons involved in the memorial safety inspection are suitably trained in the process.
- All memorials are subject to a visual inspection
- The inspections are fully documented
- All dangerous or unstable memorials (including any that will move and continue to fall to the ground with the exertion of a force of 350 Newtons (circa 35kg) or less).
- All memorials up to 2.5 metres are subjected to a hand test by a trained personnel
- All memorials between 500mm and 1.5m are subject to confirmatory testing with force measuring equipment
- All those below 500mm will be risk assessed to decide on the most suitable type of inspection,
- A risk assessment in accordance with the guidance, mitigation measures
- Signs are placed giving notice of the inspections and of any work necessary to make memorials safe.

- 2.12.19 It is sometimes necessary to take action where memorials become dangerous or dilapidated for instance by:
- i. laying flat, or alternatively re-setting unstable memorials, or alternatively
  - ii. removal of unstable memorials or parts of memorials
  - iii. other form of memorial repair or restoration
  - iv. fencing off memorials
- 2.12.20 There are administrative and legal requirements in respect of removal of memorials which the council must follow. This work is not therefore included in the standard maintenance regime and actions are carried out under the direction of the cemetery manager either directly by grave-digging staff, or through the maintenance contractor, or local stonemasons, as and when required.
- 2.12.21 Occasionally it is necessary to remove unauthorised memorials or materials from graves, which is usually carried out directly by the grave-digging staff following letters of notification.
- 2.12.22 At the last memorial inspection at Camberwell Old a number of monuments were considered potentially unstable and were fenced off with warning signs erected.
- 2.12.23 The growth of the trees and shrubs between memorials in the areas of private graves within dense regenerating woodland in the north of the site at Camberwell Old means that those memorials are more liable to deterioration and to being destabilised. However there are also significant practical difficulties in gaining access to carry out memorial safety inspections on any more frequent basis in this area. Signs have been erected warning the public of potential unstable monuments but this is not an ideal situation.

#### *Advantages and Deficiencies*

- 2.12.24 There are advantages and deficiencies in the current maintenance and management approach, these are assessed along with opportunities for improvement in section 4.0 below.



Figure 2.1 – Tithe Plan (1839 check###)



Figure 2.2 Historic Map Overlays: OS 1874 1<sup>st</sup> Edition

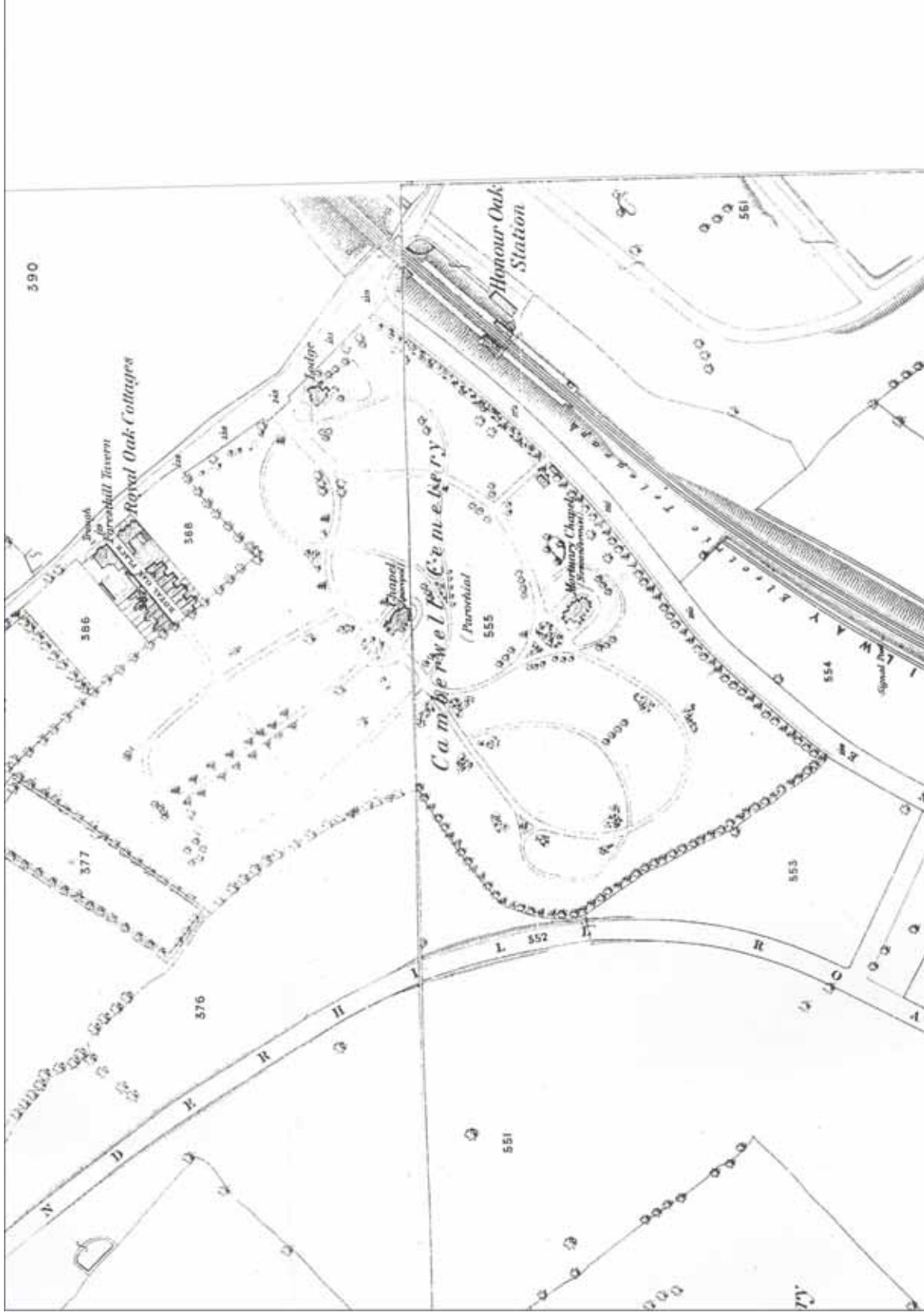

Figure 2.3 Historic Map Overlays: OS 1885 – Surveyors Plan

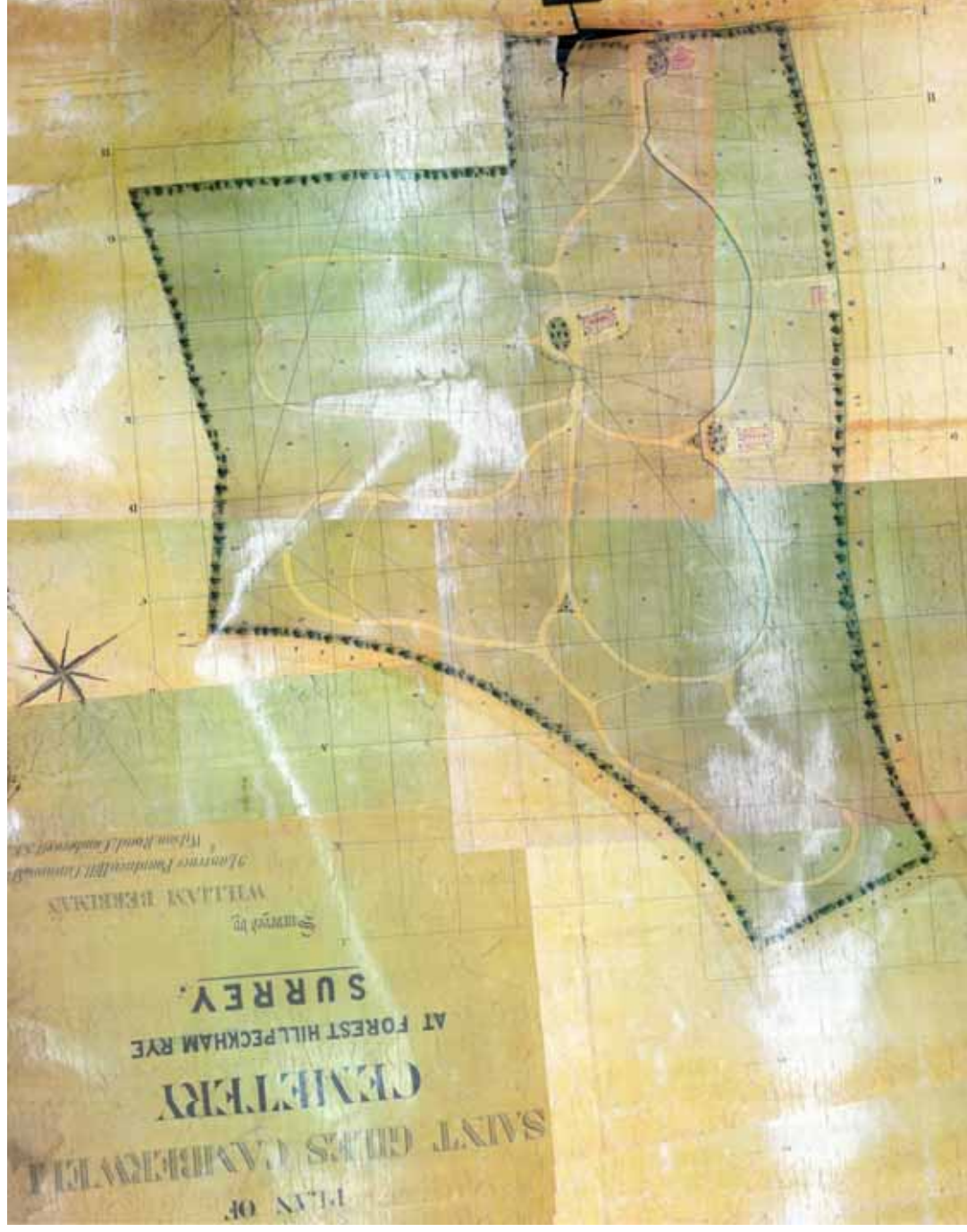

Figure 2.4 Historic Map Overlays: OS 1895 2nd Edition

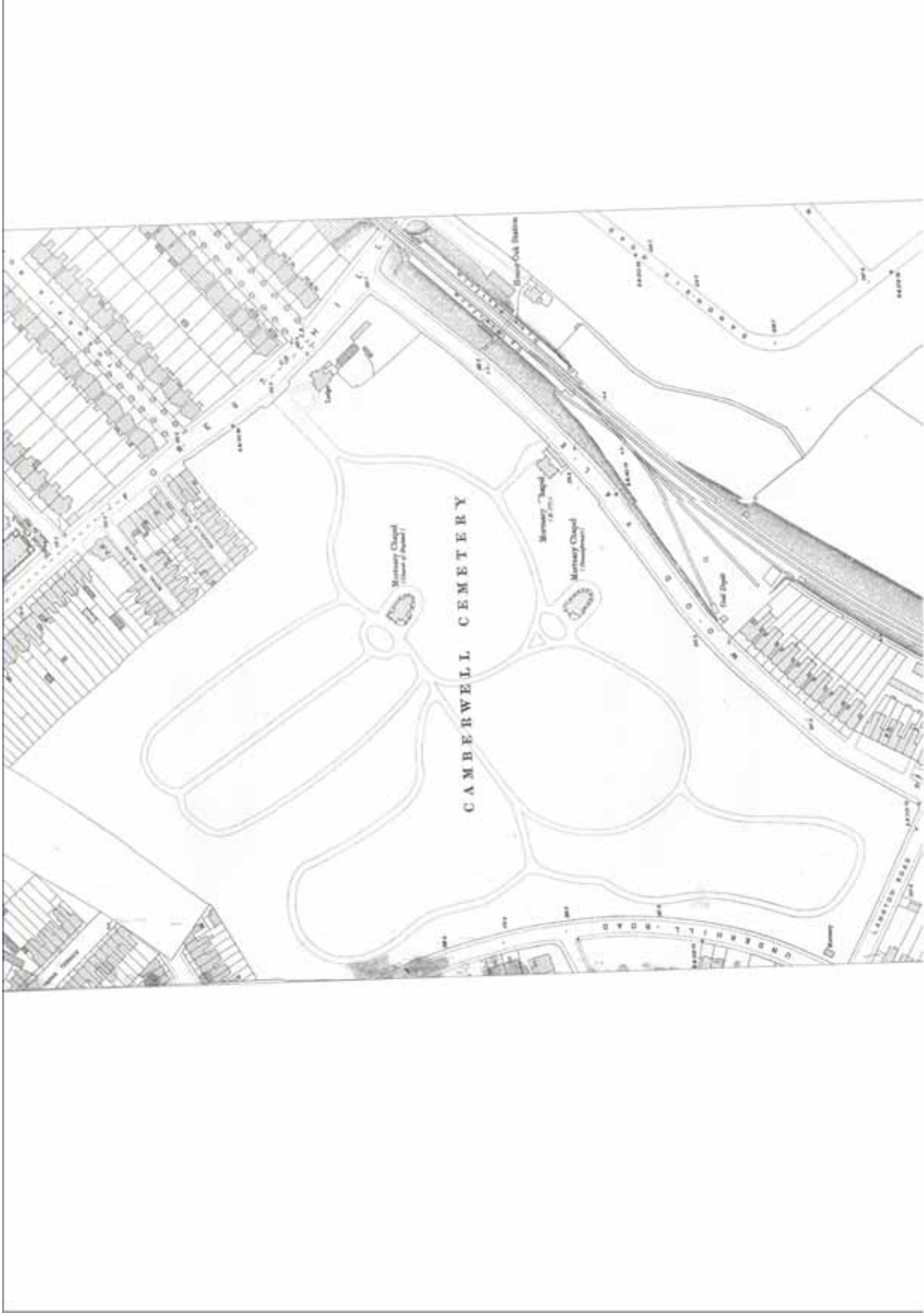

Figure 2.5 Historic Map Overlays: OS 1912

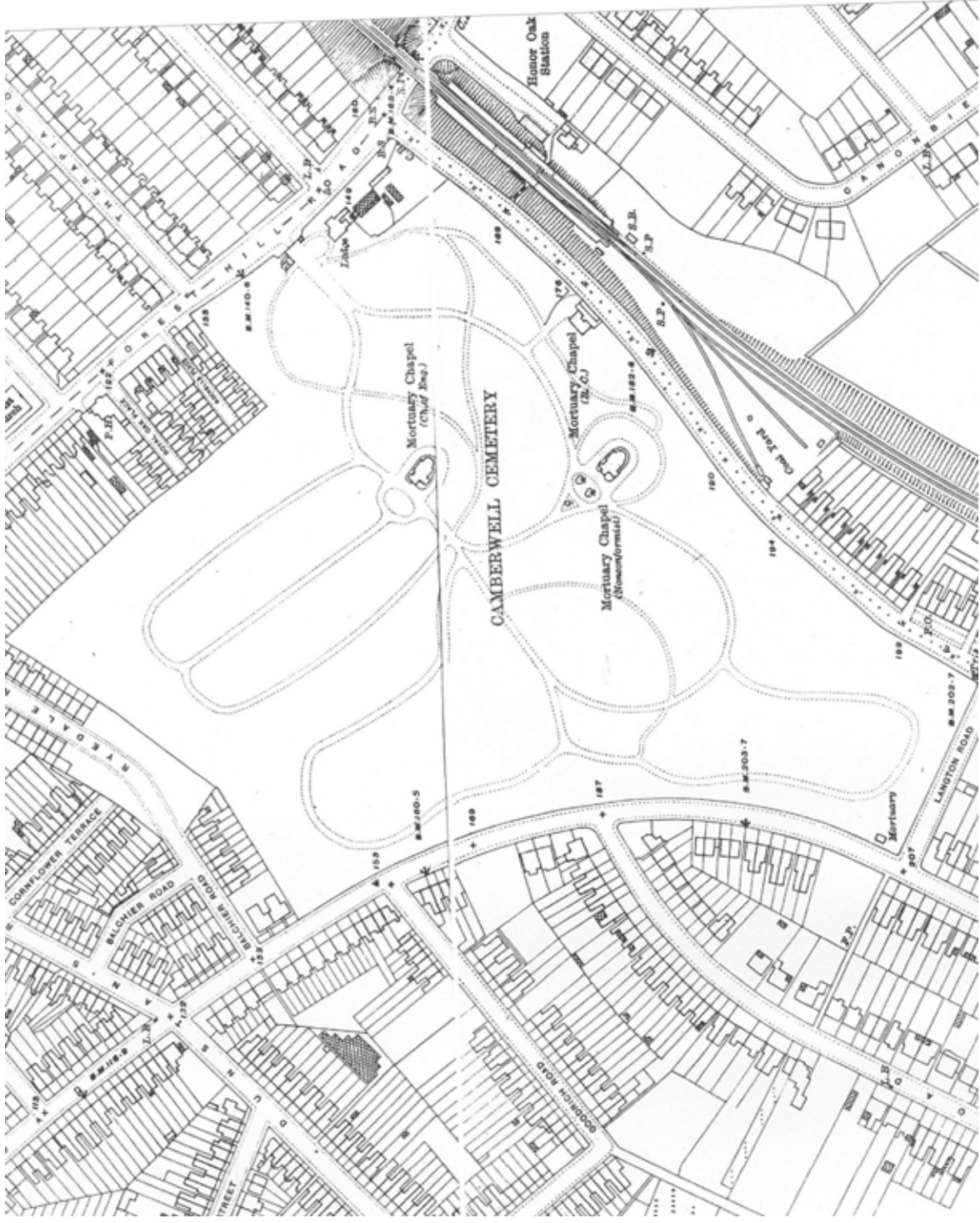

Figure 2.6 Historic Map Overlays: OS 1950

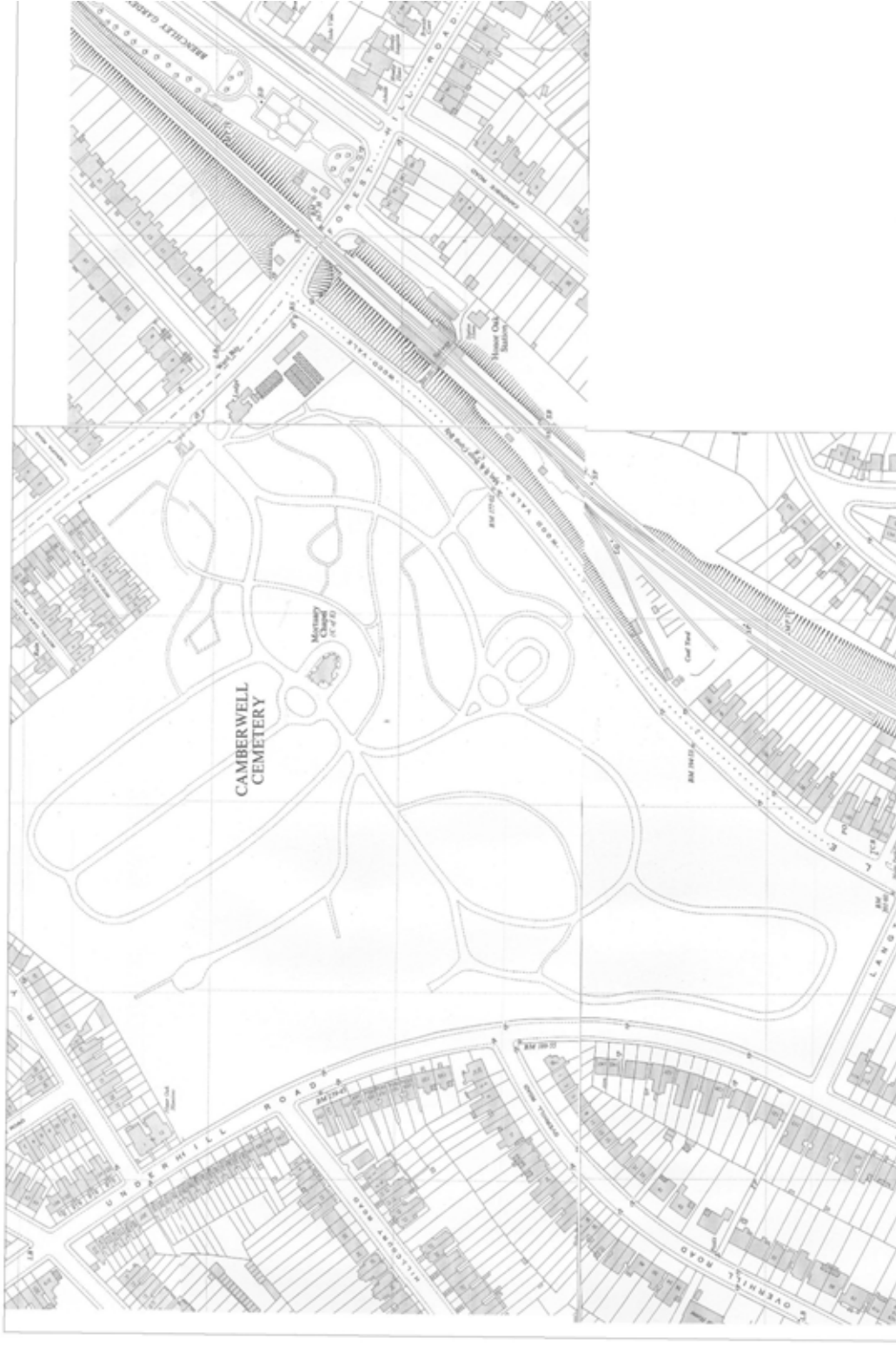

Figure 2.7 Map Overlays: OS 2011 (with designations)

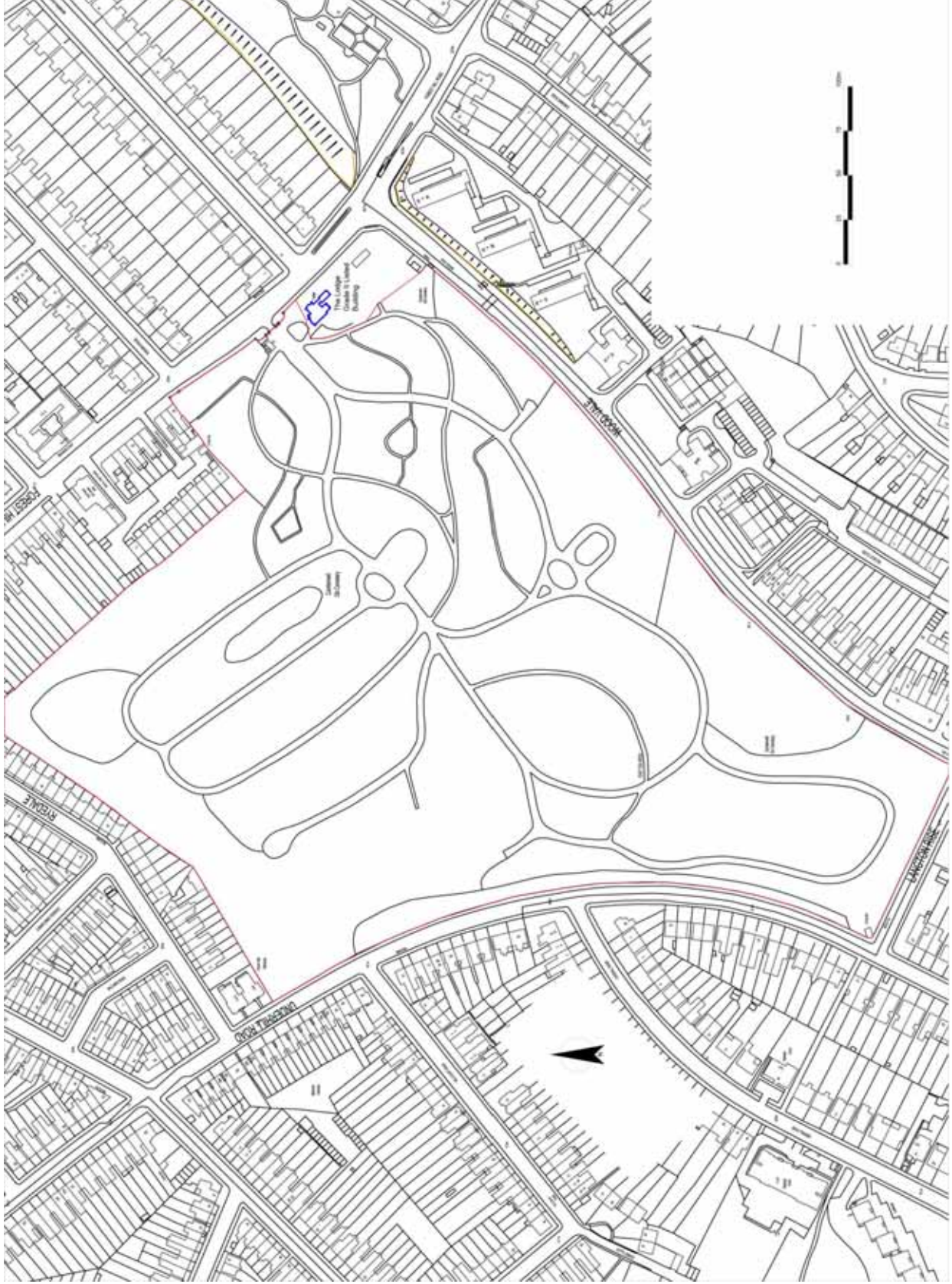

Figure 2.8 Historic Plot Overlays





## 2.0

### Understanding the Site: Camberwell Old Cemetery

Figure 2.9 Aerial Photograph (Current Day)



**Figure 2.10** *Historic Images*

(historical images with thanks to Southwark Local Studies Library)

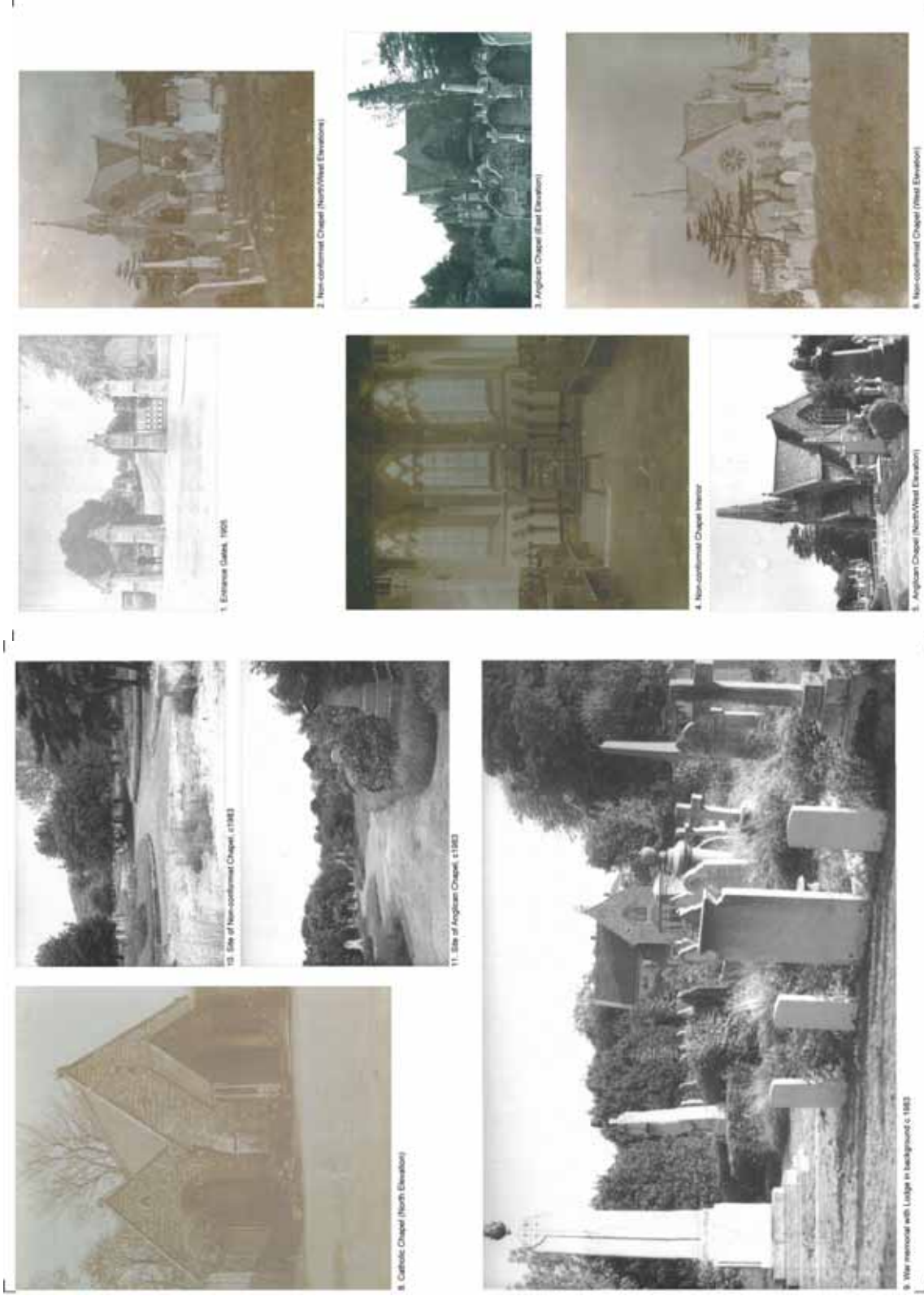

Figure 2.11 Significant Monuments/Listed Structures

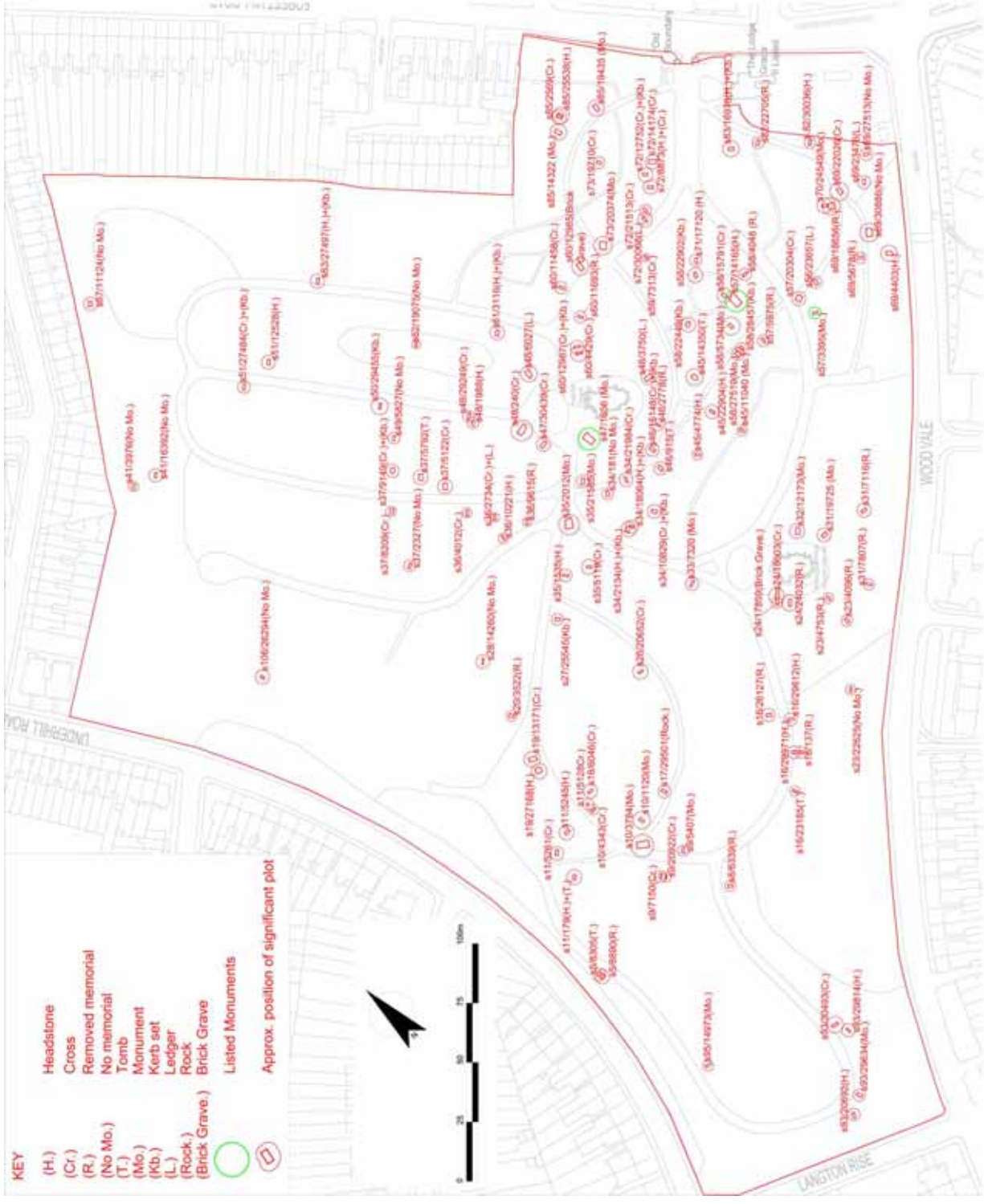

Figure 2.12 Phase 1 Habitat Plan



Figure 2.13 Tree Survey Plan



Figure 3.1 Character Areas and Key Features



### 3.1 Introduction - 'What Matters and Why' within the Cemetery

3.1.1 This Statement of Significance considers heritage value of the cemetery in terms of:

- Character Areas
- Historic Significance Local and National Context, Special or Distinctive Layouts and Arrangements
- Funerary Monuments and Sculptures
- Cultural and Biographical Heritage
- Landscape Design
- Architecture
- Nature Conservation
- Arboriculture
- Amenity and Open Space
- Public Use and Value

### 3.2 Character Areas

3.2.1 The cemetery has been appraised and set out with reference to 12 character types. These 'character types', are found across which are not homogenous and have indistinct boundaries, are shown on Figure 3.1.

#### *Historic Monuments*

3.2.2 At the heart of the site is a looping path where some of the largest and most distinctive monuments are sited within an enclosing hedgerow and set in short strimmed grass . Elsewhere alongside the pathways, either side of the original Anglican Chapel, and on key junctions there are similarly large and locally distinctive historic memorials, including chest tombs, obelisks, ornate crosses and statues. Many of these memorials are in poor condition but together and along with mature trees and peaceful setting they combine to give a fading romantic grandeur character archetypical of the Victorian cemetery.

#### *Historic Core*

3.2.3 The *Historic Monuments* areas are generally set within the *Historic Core*. These areas are found at the heart of and at the western end of the cemetery. In these areas most of the original traditional kerbset layouts remain in place. Many of the kerbsets have large gothic headplates, some ornately carved. Arrangements are often visually distinctive and accentuate the sweeping curves of paths. Kerbsets are again set within short strimmed

grass albeit. Numerous small bushes trees, including some within kerbsets themselves, reduce the sense of openness. The areas have the same faded romantic character as the *Historic Monuments* areas albeit not as grand in scale.

#### *Historic Monuments –Wooded*

- 3.2.4 To the north of the paths immediate north of the original Anglican Chapel many large and ornate monuments and are evident, engulfed in dense woodland. Monuments include traditional kerbsets with statues, crosses, and ornate headplates as well as more ornate monuments (see CMP cover). Access into these densely overgrown areas is difficult. The character is that of abandoned, derelict, Victorian gothic cemetery.

#### *Secondary Historic*

- 3.2.5 Within the main 'butterfly' of land in the south principally bordering onto paths are areas which appear to have been subject to substantial clearances of memorials in the past. There are areas of close mown grass with numerous scattered graves. The regularity of the original layout has been largely lost in many areas on account of the clearances and on account of numerous intermediate (infill) graves dating from the 1980's. Whilst the integrity historic character has been compromised across these areas the character remains distinctive and made more attractive by the large mature trees and the peaceful setting.

#### *Secondary Woodland*

- 3.2.6 These areas merge into the 'Historic Monuments Wooded'. Here there are regimented and very densely set kerbsets extending 4 or 5 rows back from the path within very dense woodland with scrub and bramble. Kerbsets are smaller and less ornate than in other areas, with many of the front rows being early c20th rather than Victorian. The character is that of abandoned derelict, enclosed and wooded cemetery. The occasional large oak honbeam, or yew add a sense of import and maturity. The dense vegetation renders paths through the areas foreboding and insecure for some people.

#### *Woodland Glades*

- 3.2.7 These areas, once public graves with no memorials, are of rough grassland with occasional scrub and occasional large mature trees, enclosed within a perimeter of the dense *Secondary Woodland*. They have an attractive semi-natural woodland glade feel, although again dense vegetation renders the glades foreboding and insecure for some.



*Amenity Grass*

- 3.2.8 Several areas are of close mown grass with occasional mature trees. These are areas of public graves with no monuments. One area has actually been set aside for use as a woodland burial despite its open nature. One area (F/F1) is currently being laid out as lawn burial

*Lawn Burial*

- 3.2.9 One other area (E) has been recently laid out as lawn burial with gravel rafts between neat rows of modern rows of memorial. Here the character is more ordered and neater than other areas within the cemetery but the smaller modern memorials (not kerbsets) laid out head to head maintains an openness that, within a setting of new planting and with retained mature trees, has an attractive mature but well kept feel.

*Recent Kerbset*

- 3.2.10 A third area has been laid out over public graves since the 1990 for burial and makes use of both lawn burial and kerbsets of a variety shapes sizes and colour and a lot of ephemeral memorialisation. The area has occasional small suburban conifer trees, garden and path areas, and memorial benches all making it difficult to mow and giving a slightly unkempt chaotic character that sits uneasily with the character of the surroundings.

*Disturbed areas*

- 3.2.11 The extensive area alongside Underhill Road includes earth mounds, protruding rubble, steep slopes, dense recolonized vegetation (including weeds such as rose bay willow herb and Japanese knotweed), all set amongst semi mature and mature sycamore and oak trees. It has a disturbed unsettled feel of dereliction and abandonment.

*Yard and Operational Areas*

- 3.2.12 There are two operational areas. The site of the old Anglican chapel now is ostensibly used as a car park but also used for the siting of a large waste container. The container is conspicuous in its historic setting and the large area of tarmac incongruous. The second area takes in the masons yard in the south east corner including cabins and workshop. Whilst relatively tucked away and inconspicuous behind hedgerow and fencing and set below mature trees it could be integrated better into the cemetery landscape.

*Garden Verge Areas*

- 3.2.13 The rose gardens set within close mown lawn and with box hedge parterres are found at the entrance and site of the old chapel. Their neatness and colour are a welcome contrast to the informal feel of the remainder of the landscape. At the same time however, the irregular lines the discontinuous gappiness of the hedgerows and the slightly scrappy, thin appearance of the roses gives them a dated tired feel.

*Commonwealth War Graves*

- 3.2.14 The Commonwealth War Graves with its simple well-maintained lawn backed by a unadorned portland stone wall carrying the inscriptions of the fallen and flanked by a handful of servicemens graves, has a simple understated dignity. Its manicured lawn and simple planting sets it apart from the more unkempt areas surrounding it.

### **3.3 Historic Significance Local and National Context, Special or Distinctive Layouts and Arrangements**

- 3.3.1 The layout itself is not known to be by any recognised designer of note. Nor did it follow the most modern principles of thinking in cemetery design at the time, as set out in the work of John Claudius Loudon in his book *On the Laying Out, Planting and Managing of Cemeteries 1843*. That guidance advocated a more regimented approach to layout of paths and avenues coordinated on a grid with the burial layouts. In fact the organic romantic layout at Camberwell Old was based around an C18th picturesque aesthetic and is similar in approach to that seen at the City of London Cemetery designed by Haywood in 1855.
- 3.3.2 Both Camberwell Old and the City of London Cemetery used a grid overlay system to record burial 'squares' (despite the fact that the grids did not coincide with the paths). However, and in contrast to the City of London, after decades of infilling and of poor recording, this of overlaying of the grid and the curvilinear has revealed itself to be an impractical combination at Camberwell Old.

### **3.4 Funerary Monuments and Sculptures**

- 3.4.1 The most valuable and significant funerary monuments are those that are listed. Where they survive (which is not everywhere) and to the extent they can be still read, the memorials on graves of people of local cultural significance are also valuable. The larger memorials in the *Historic Monuments* areas, (even where not listed nor in memory of significant people) also add to the strength of character particularly at the heart of the site.

In the Historic Core the curving intact rows of kerbsets have a particular strength of character.

### **3.5 Cultural and Biographical Heritage**

3.5.1 It is difficult to differentiate between the most and the least significant of all the persons highlighted in section 2.0 above. These people had an impact on local or national or international affairs. Thus whilst not of having the same significance as nationally renowned figures, the presence of graves and memorials to the people noted in Ron Woollacot's popular book add to the cultural and biographical heritage of the site and add particular interest to the cemetery.

### **3.6 Landscape Design**

3.6.1 The curvilinear picturesque layout in combination with the large monuments is of some limited historic interest in its own right, but perhaps more importantly it also generates interesting and attractive vistas. The continually changing lines of sight make the cemetery feel bigger than it is and, in combination with the trees and undulating landform, gives it a particularly attractive feel. This sets it apart from later more geometric cemetery layouts such as based around the Loudon approach.

3.6.2 The wealth of trees and natural shrubs also help in screening the cemetery from its urban surroundings, giving a peaceful feel. A particularly attractive feature of the site is the wealth of autumn colour.

### **3.7 Architecture**

3.7.1 The existence of the Lodge by Sir George Gilbert Scott set fully intact alongside the entrance gates with railings and plinths (all similarly intact and all carrying similar detailing) gives an arrangement that is complete, distinctive, and a particularly valuable heritage asset. This is made all the more valuable given the loss of the two other gothic styled chapels in the 1930's and 1940s.

### **3.8 Nature Conservation.**

3.8.1 The nature conservation value of the site as highlighted in section 2.0 relates primarily to:

- the extent and location of the SINC in an otherwise built-up area
- the connectivity afforded by areas of fringing shrubs and scrub around the perimeter
- the mosaic of different habitats with edges and interfaces between habitats;
- the potential to support roosts and provide feeding grounds for bat populations.

### 3.9 Arboriculture

3.9.1 The most valuable trees and tree groups in Camberwell Old cemetery include:

- the small number of large mature oak potentially pre dating 1856;
- mature planes and limes around the site of the non conformist chapel
- mature Hornbeams in the central part of the site;
- occasional large yew potentially dating from the original laying out
- mature oak and lime around the perimeter of the site some potentially dating from the original layout.

3.9.2 The large mature Horse Chestnuts found throughout the site also currently add significant value to the cemetery however these are blighted, in some instances severely so, and so their potential future value is less than it otherwise might be

3.9.3 The extent and density of tree cover within the cemetery and its contribution to overall tree cover in the locality is significant asset and this is in part recognised by the group TPO status which covers the whole site.

### 3.10 Amenity and Open Space, Public Use and Value

3.10.1 The significance of Camberwell Old Cemetery in terms of its amenity and value are:

- that it is generally considered, with some exceptions, to be a 'well maintained' 'clean' and 'safe' place;
- that the route of the Green Chain Walk passes directly through the Cemetery;
- that as a piece of open space it has particular value for wildlife and has distinctive character with special heritage value.

3.11.1 The principal users of the cemetery visit in connection with burial (ie visiting the graves of friends or family). Recreation is a secondary but very important use. It is significant that the cemetery is able to meet the needs of both these user groups.

## 4.1 Introduction

4.1.1 This section follows the format of the earlier sections in setting out present 'Condition, 'Risks' and 'Opportunities' in terms of:

- Current Condition and Trends
- Funerary Monuments and Sculptures
- Cultural Heritage
- Landscape Design
- Architecture
- Nature Conservation
- Arboriculture
- Amenity and Open Space
- Public Use and Value
- Infrastructure
- Current and Future Management
- Implications of the Cemetery Strategy

4.1.2 Many of the themes and issues addressed in the first eleven aspects come together and inform the last (Implications of the Cemetery Strategy).

## 4.2 Current Condition and Trends

4.2.1 The original character of the cemetery was hugely altered in successive monument clearances in the mid and late C20th. The continued instability, decay and loss of the larger monuments has exacerbated that change. The 'abandonment' of much of the northern area to regenerating trees in the 1970(s) has also irreparably changed the character. From the 1980's a new wave of intermediate burials, infilling between old plots has led to a change in the character of the memorials both in terms of style and arrangement, weakening the historic character. Unfortunately the recent burial crisis in the authority has led to more infilling of pathways.

4.2.2 Without revenue from significant numbers of new burials there has been less revenue to invest in the site. Thus despite the cemetery having remained in use for burial, repairs to the infrastructure have been underfunded. Even with a transition to a more low-key type of managements there has been insufficient funding, leading to an air of neglect, exacerbated by the disturbance of ground in the west and north of the cemeteries.

4.2.3 There have recently been efforts to reverse this underinvestment and this CMP represents part of that effort.

4.2.4 Detailed risks, opportunities and trends in terms of the identified asset recognised in the Statement of Significance (section 3.0 above) are summarised below.

### 4.3 Funerary Monuments and Sculptures

#### *Condition*

- 4.3.1 The general condition of memorials and monuments is poor. In the central and eastern parts (including the historic core and historic monument areas see Figure 3.1):
- i. there are many examples of fallen (or laid down) headplates, sculptures and crucifixes. Railings/chains are generally missing or broken. Self seeded woody plants (notably ash, and elder and sycamore) are becoming established within and adjacent to kerbsets and forcing elements apart;
  - ii. many of the larger tomb chests and ledger slab type monuments have various above ground elements that are displaced or missing, inscriptions that have weathered and foundations that are exposed decaying and unsightly; .
  - iii. many kerbsets have been subject to heave or subsidence with kerbs tablets and headstone elements coming adrift.
- 4.3.2 Similar problems exist in the southern , central and western parts of the cemetery (*Secondary Historic* area) albeit there have been various phases of memorial clearances across these areas leaving only the more robust memorials in place often alongside more recent memorials
- 4.3.3 In the northern half of the cemetery there have not been memorial clearances within private areas. Nearly all of the private burial areas have become densely overgrown with ash, elder and sycamore trees, forming a dense canopy over an under-storey dominated by bramble. These woody plants are increasingly de-stabilising and wrenching apart the memorials which have also subsided in very may cases.
- 4.3.4 Further study and assessment will need to be carried out as integral to the delivery of the Cemetery Strategy and a detailed assessment of all the significant memorials will need to be carried out to ascertain whether individual memorials or monuments are

suitable (or merit) restoration, or re-inscription as part of reclamation or re use. ( See Memorial Panel Process , below)

- 4.3.5 Much of the value of the memorials at Camberwell Old lies in the larger, more ornate monumentation. Given the poor ground conditions these are particularly at risk from subsidence, exposure of foundations and consequent degradation.

*Risk: Stability and Safety*

- 4.3.6 A small number of monuments have been fenced off on account of stability concerns. These include a number of the obelisks and the memorial to Charles Waters.

- 4.3.7 Memorial safety inspections are regularly carried out in accordance with guidance from the Institute of Cemetery and Crematorium Management (ICCM). It is cemetery management policy where memorials fail the 'topple test' to:

- immediately fence off the more substantial monuments
- lay down smaller memorials on the grave/kerbset
- contact the owner/heir to the grave at last known address
- remove parts that may be deemed unsafe if left insitu

- 4.3.8 Signs have been erected warning of potentially unstable memorials . This situation is not ideal and liability associated with unauthorised access could be a concern in the future.

*Risks: Trends in Condition , and Factors Affecting Deterioration.*

- 4.3.9 The continuing growth of young trees bramble and other woody shrubs if left unchecked will continue to exacerbate existing damage to memorials.
- 4.3.10 It will become increasingly difficult to access and conduct stability tests on memorials in the overgrown northern parts of the cemetery, and difficult to gain access to secure memorials to arrest instability. Monuments falling may not only be a safety concern but can also exacerbate damage to other memorials.
- 4.3.11 Wanton vandalism does not seem to be an issue currently, however recent thefts of plaques and other metal elements is a growing concern.

- 4.3.12 The heavy clay ground is also a factor in the poor stability of memorials. In the course of re use and/or reclamation, given the tight plot layout, it will be necessary to re- site memorials over the excavated grave. This poses a continued risk in the long term, of subsidence and instability.

*Opportunities*

- 4.3.13 The Cemetery Strategy as informed by this CMP offers significant opportunities:
- to progress restoration, reversal, and re-inscriptions of monuments in association with the reclamation and or re-use of private graves.
  - restore the more significant monuments (without associated re use or reclamation of the grave) as noted below for culturally significant monuments.

#### **4.4 Cultural Heritage**

*Condition and Risks*

- 4.4.1 A number of the memorials to culturally significant people have already been lost through instability and damage, vandalism and /or clearance. Other cannot be readily to be located within the dense vegetation. As the cultural heritage becomes physically lost or obscured it also becomes more remote and less valued. Without intervention this situation will worsen.

*Opportunities*

- 4.4.2 Opportunities exist to make more of the cultural heritage by:
- locating, and detailed recording of all culturally or architecturally significant memorials;
  - restoration of all culturally or architecturally significant memorials (without associated reclamation or re-use of the graves themselves);
  - development of on-site interpretation, potentially backed up by web based resources to provide information on all culturally an architecturally significant memorials and graves.

#### **4.5 Landscape Design**

*Condition and Risks*

- 4.5.1 Factors affecting the integrity of the original design include that:
- some paths which formed the original curvilinear layout have been lost through deliberate use for burial;



- other paths have been modified or introduced in a way that is entirely out of keeping with the original design;
- the infrastructure has deteriorated such an extent that much of the integrity to the original design has been lost (see below).

4.5.2 There is a risk that without careful design these factors could be exacerbated by the intensification of burial use in the future and that new features, landform, or elements (such as inappropriately designed parking, toilets, or yards) could be introduced in a way that is out of keeping with the original design intent.

4.5.3 Areas of more colourful and ornamental landscape, with finer lawns and hedging often form attractive features at the entrances and at key nodes within parks and cemeteries. Such 'feature' areas exist at Camberwell Old. Whether or not they existed in this form within the original design is not certain, but planted areas were shown at these locations (see above). The contrast between the manicured ornamental landscape and the rambling wild shrubberies is in itself an attractive aspect. A lack of management or investment in these ornamental areas could diminish the appeal of the cemetery to many visitors.

4.5.4 Boundary planting, enclosing the site from the surrounding land uses, has undoubtedly given the cemetery a secluded and peaceful feel in the past, and continues to do so today. With the intensified use for burial envisaged, care needs to be exercised to maintain a buffer around the perimeter in the future.

#### *Opportunities*

4.5.5 The implementation of the Cemetery Strategy CMP offers an opportunity to enhance the feature areas, and protect and strengthen boundary planting. Care will need to be exercised to strike a balance between the order and formality of re-newed burial areas with the informality of the shrubberies and wild woodland.

## **4.6 Architecture**

### *Condition, Risk, Opportunity*

4.6.1 Much of the architectural interest has been lost years ago with the demolition of the chapels. The integrity of the historic arrangement of the Lodge (set behind and to the

side of the main gates) remains a valuable asset. There is always the risk, with the Lodge being outside of the control of the Council, that changes to the boundary treatments or to the fabric of the Lodge could affect this composition. It is understood that there are no plans to take the Lodge back into Council ownership albeit concerns have been raised by the current owners in respect of the intensification of use of the cemetery for burial.

4.6.2 There is currently no toilet facility in the cemetery. As part of the development of the cemetery and the increased use for burial there is a likely requirement for a toilet. The detail siting/provision of a toilet outside the scope of this CMP but options include:

- at the site entrance,
- associated within a new centrally located mausoleum,
- within a replacement building in/close to the existing stonemasons yard.

4.6.3 In the unlikely event that the Lodge came back into Council ownership the siting of toilet and other facilities within its grounds would merit consideration.

4.6.4 As part of the Cemetery Strategy new mausolea are proposed on the sites of the old chapels.

4.6.5 The stonemasons yard and small workshop/building are currently leased from the council by a local stonemasons

4.6.6 There is the risk that any new building/structures could be inappropriately designed or sited so as to detract from the integrity of the original design. On the other hand the provision of new toilet buildings and mausolea could be an opportunity to add to the general appeal of the site if they were sensitively designed .

## 4.7 Nature Conservation

### *Condition and Current Status*

4.7.1 Without detailed recording of species lists year on year it is not possible to be definite as to whether the nature conservation value of the site is improving or deteriorating. Trends are likely to include:

- closure of the canopies within the secondary woodland areas leading to an impoverished understorey;

- impoverished flora and lack of wildflowers within grassland now characterised as being amenity or species poor grassland (Figure 2.12). (despite their current management);
- trees becoming mature/over-mature and deteriorating in condition, many becoming ivy encrusted, so increasing their capacity to provide habitat for insects, birds, and bats (but with implications in terms of safety);
- grassland margins retreating as they become colonised by dense cover of woody bramble and woody scrub and weed (including Japanese knot weed) with consequent diminished diversity.

#### *Risks*

- 4.7.2 There is the risk if low management inputs continue that more of the site become dense shrub or with closed tree canopy. On the other hand there is also a risk that without careful management the proposed intensification of use for burial, increased public use, and more extensive formal landscape treatments, could diminish nature conservation value.

#### *Opportunities*

- 4.7.3 A number of opportunities exist as highlighted in the ecological assessment including
- retention of deadwood where possible or its removal to margins;
  - careful removal of understory;
  - retention of oaks as flagship species with high biodiversity value.
  - planting of native scrub such as hawthorn, hazel and holly;
  - relaxed mowing regime to grassland margins;
  - provision of fruiting scrub;
  - retention of marginal scrub.
- 4.7.4 Mitigation in respect of any areas proposed to be developed for more intensive burial should include:
- removal of trees /shrubs outside nesting season;
  - pre-commencement surveys for bats and or birds;
  - native buffer planting.
- 4.7.5 There is also opportunity to develop and make available information relating to the nature conservation value of the site on site or via web links.

Figure 4.1 Photograph Location Plan

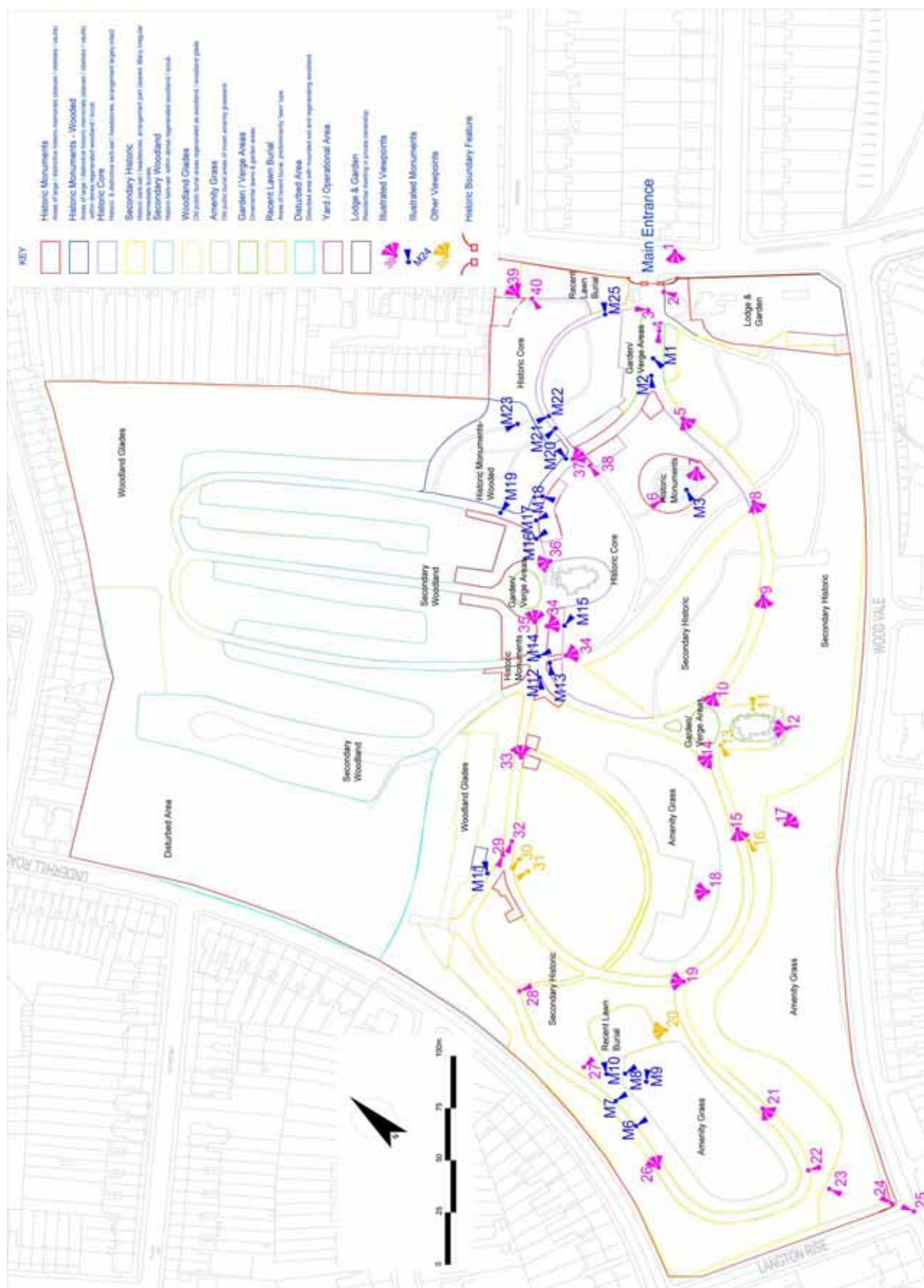

Figure 4.2 Site Photographs

(sheet 1 of 8)



Figure 4.2 Site Photographs

(sheet 2 of 8)

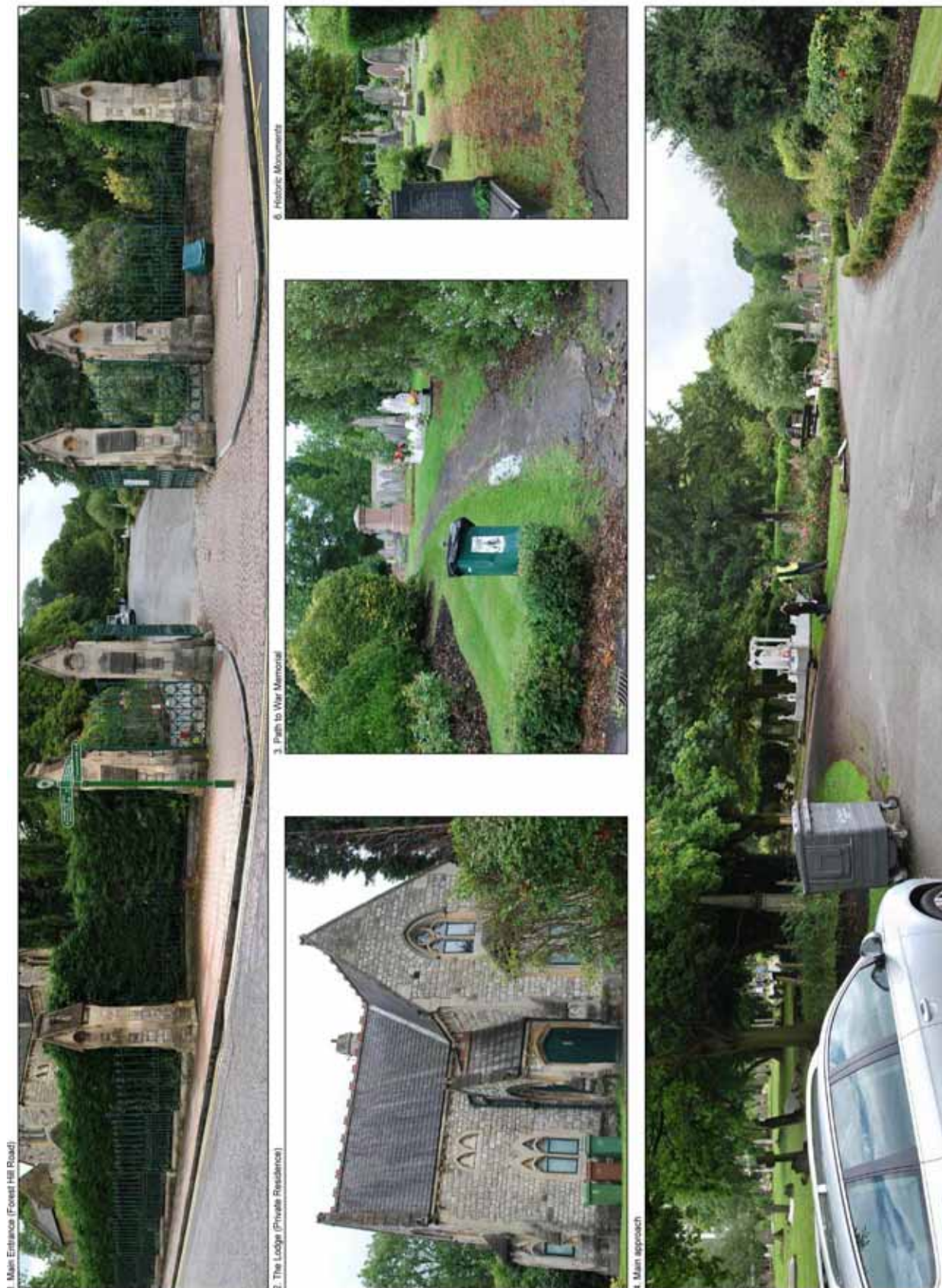

Figure 4.2 Site Photographs

(sheet 3 of 8)



Figure 4.2 Site Photographs

(sheet 4 of 8)





Figure 4.2 Site Photographs

(sheet 5 of 8)



Figure 4.2 Site Photographs

(sheet 6 of 8)



24. Historic Gates - Wood Vale/Langton Rise



23. Area F1



22. Alignment of Green Chain Walk (Area F1)



26. Secondary Historic: Langton Rise boundary (Left)



29. Historic Monuments



28. Secondary Historic: Depressing path



25. Inscription Langton Rise Gates

Figure 4.2 Site Photographs

(sheet 7 of 8)



Figure 4.2 Site Photographs

(sheet 8 of 8)



35. Historic Monuments with Historic Monuments (Woodland) in background near side of Anglican Chapel



38. Historic Monuments at path junctions with Historic Core behind



39. War Memorial CWGC



40. 1st World War Memorial

## 4.8 Arboriculture

*General Condition and General Safety and Management Issues.*

- 4.8.1 A detailed survey of the condition of trees is outside the scope of this study. However as part of the preparatory work for the Cemetery Strategy detailed survey and assessment work was carried out in accordance with BS 5837 for a number of areas including areas F/F1, E and G (see Masterplan, Figure 6.1). ( Current version *BS 5837:2012 Trees in relation to design, demolition and construction – Recommendations*) . This revealed :
- numerous trees in poor or very poor condition with some meriting immediate removal on account of their condition;
  - trees growing in close proximity to one another and leading to specimens of poor form;
  - horsechestnuts suffering from blight and in poor condition;
  - large lombardy poplar in very poor condition;
  - areas of regenerating suckers of diseased elm;
  - numerous trees sited close to recent grave excavations.

*Risks*

- 4.8.2 There are a number of risks to the arboricultural resource:
- risk of loss of branches or even major limbs through decay/disease;
  - windthrow of trees in poor condition exposed to prevailing winds (particularly after clearances);
  - continued formation of poorly formed specimens in an overcrowded setting;
  - continued lack of development of a diverse age structure leading to a lack of trees to provide proper succession;
  - continued damage to trees and their roots through excavations of graves close to their trunks.
- 4.8.3 Under the Occupiers Liability Act(s) of 1957 and 1984 the Council has a duty of care to visitors and staff in respect of any dangerous trees. Currently this is being addressed by reactive inspections. Ideally this inspection regime should be strengthened.
- 4.8.4 Given the poor condition of many trees there is a risk that some trees (next to paths in particular but in all areas accessible to the public) may be subject to emergency pruning or removal on account of health and safety concerns. In the past this work appears to have taken place on a re-active and unplanned basis.

- 4.8.5 A key management risk is that the cemetery is covered by a Group TPO which does not record each and every qualifying tree. Within the cemetery a significant proportion of the trees are within regenerating woodland many of which are in excess of 75mm girth the ordinary qualifying criteria. This appears to make matters unclear as far management proposals are concerned (e.g. thinning, pollarding, felling). Those activities may be best practice for nature conservation, landscape or arboricultural reasons (without being necessary on account of trees being dead, diseased, dying or dangerous). In practice management has not been pro-active enough in the past.
- 4.8.6 A second concern is the Councils approach to planning in respect of TPOs as it applies to the cemetery. For all new developments new trees are sought in replacement of any TPO trees proposed to be felled and the total combined girth of those lost are to be matched by an equivalent combined girth of the replacement trees. Many parts of the site are dense woodland and there is limited room in and around graves in areas proposed for active burial in the future. It will thus be problematic (due to space available in the cemetery) to repeatedly make equivalent girth replacements within the confines of the cemetery without prejudicing proposals for future burial. Trees that are shoe horned in between burials for instance in older parts of the cemetery may themselves be liable to being damaged if reclamation and or re use were to take place nearby at a later date.

#### *Opportunities*

- 4.8.7 As part of the Cemetery Strategy there is an opportunity to prioritise funds to complete a Visual Tree Assessment (VTA) condition survey which would look at the condition and general health and vitality of every significant tree. Basic decay detection tools such as percussion might also be used. Detailed management recommendations, in accordance with BS 3998 2010, would be made with special regard to:
- Safety of people and property.
  - Decision-making criteria for tree work.
  - Wildlife and habitats.
  - Veteran trees.
  - Tree longevity.
  - Value for local amenity, landscape, biodiversity and heritage
  - TPO status

- 4.8.8 A VTA would identify tree works on a 'red' 'amber' 'green' basis according to location/accessibility of the tree and its general health and vigour. Repeat survey work would then be carried out in higher risk areas every 12 months with more substantial resurvey over 5years.
- 4.8.9 The Cemetery Strategy as supported by this CMP also offers the opportunity to develop a prescriptive 25 year Tree Management Plan which may propose selective felling, thinning and or crown lifting/pruning:
- i. within woodland groups to promote diverse age structure and allow better specimens to develop;
  - ii. of trees in poor health or vigour;
  - iii. to make paths safer and lighter and give light to planted areas
- 4.8.10 Within this a detailed plan will need to be drawn up that identifies space (on a strategic basis) for new replacement trees in areas which will not prejudice future burial. This may need to include proposals for trees within landholdings outside of the existing cemetery where within the control of the section and in agreement with tree officers in planning section. .

#### **4.10 Amenity and Open Space, Public Use and Value**

##### *Condition*

- 4.10.1 As can be seen from the amenity and open space assessments and public responses summarised in out in section 2.0 the site currently functions well in providing amenity space of recognised wildlife and heritage value, forming a well-signposted link on the Green Chain Walk and with above average 'Value' and 'Quality' relative to openspaces across the borough as a whole.

##### *Risk*

- 4.10.2 The key risk to this amenity status would be any further deterioration in the conditions of paths (see below), monuments (see above), or trees (see above) any or all of which might lead to more restricted access on account of health and safety concerns.
- 4.10.3 Despite the high quality and value assessment local people are not satisfied with parks/cemeteries in the locality (see above). There is a risk that with a future shift towards a more formal landscape character associated with more widespread use for burial, some

people may perceive there to be an adverse impact on the quality and value of the space. Others may perceive a more managed landscape to be more appealing and safer and therefore more valuable as amenity space.

#### *Opportunities*

- 4.10.4 From usage surveys and suggestions it is clear that there are opportunities to:
- enhance maintenance regimes (see below);
  - better interpret heritage and nature conservation value;
  - introduce better management over new graves (with more careful control/enforcement over the extents and types of items left on graves that can have an adverse impact on the character of the cemetery)
- 4.10.5 The Cemetery Strategy, as informed by this CMP, also bring to opportunity to enhance facilities for users including new toilets, more seating, more standpipes.
- 4.10.6 Some of these activities will contribute toward addressing the Green Flag Criteria including that of being 'A welcoming place', a 'Healthy, safe and secure' place, a 'Clean and well maintained' place. Developing the planned long term burial uses for the site also contributes to the site being 'Sustainable' whilst this CMP should ensure that 'Conservation and Heritage' value is protected and well 'Managed'.
- 4.10.7 That leaves the Green Flag Criteria of 'Community Involvement' and 'Marketing'. These aspects might only be improved by having increased involvement of the fledgling 'Friends' group, better signage and interpretation along with promotional and interpretation initiatives such as nature and heritage walks.

## **4.11 Infrastructure**

- 4.11.1 The condition of the infrastructure is summarised as follows:
- i. paths and carriageways are in poor condition throughout the southern 'butterfly' section. Recent failure of wearing course has led to failure of underlying base and sub-base.
  - ii. surfacing on the paths in the northern woodland loop areas have failed entirely exposing the sub-base and becoming grassed over;



- iii. original drainage (to the extent that any existed) appears to have failed. Re-connection to the original system may be problematic, there is no detailed condition survey as to what carrier drains remain,
- iv. water standpipes are in poor condition and leaking. The condition of the supplies are not known but pressure appears to be available/serviceable;
- v. the historic boundary along Forest Hill is in good condition. Railings and gates have recently been repainted. The basal plinth and pillars all appear in reasonable condition;
- vi. the distinctive stone sett surfacing at the entrance is in deteriorating condition and at some point subsidence will need to be addressed to prevent more serious failure;
- vii. the historic gateway at Langton Rise appears in good condition. New gates and paving have been fitted. The pillars appear in reasonable condition.
- viii. the boundaries along the Wood Vale and Langton Rise are in deteriorating condition. Some remedial works is proposed in 2012, but further investment may be required to maintain the integrity of the site boundary;
- ix. the boundary fence along Underhill Road is poor with materials placed behind and against it, with small areas having collapsed or others are missing;
- x. boundary fencing along the rear of properties on Ryedale, Forest Hill, and Royal Oak Place have been removed or breached. The condition of a substantial wall along the rear of Ryedale (in the west) has not been assessed due to difficulties in gaining access through undergrowth.

#### 4.12 Current and Future Management

##### *Risks*

- 4.12.1 Risks and limitations inherent in the current management regime are that for people visiting graves and the bereaved burial areas may appear too informal and poorly mown. On the other hand, visitors who appreciate the wild un-manicured aspects of the cemetery may find the areas of more intensive management (associated with burial) unattractive. This tension will always exist and needs to be managed. At present the formal 'neat' parts (especially those recently laid as lawn burial- see below) are not particularly formal nor neat, whilst the wilder areas sometimes feel abandoned rather than managed. Given the more intensive and more extensive use of the cemetery for burial in the future, there is need address this, and to adjust and improve maintenance and management in the future.

*Condition: Levelling and Re-turfing of Graves (generally)*

- 4.12.2 The levelling of ground after infilling of a grave can be more difficult in clay soil than on loamy or sandy soils as the clay expands greatly when excavated, and does not then compact easily, and then subsides over time. Traditionally a solution has been to leave large amount of excess soil by way of a mound, initially allow that to settle and if a hollow then forms, top up with soil and seed.
- 4.12.3 In Southwark there is an increasing cultural preference for families (particularly black and Afro Caribbean families) to backfill the graves themselves and then dress the grave (the mound) with flowers and dedication. This results in the mound being larger than ideal, with poor compaction. Optimum grave spacing is lost and there may sensitivities over the subsequent removal of the dressings.
- 4.12.4 It has not been an integral part of the responsibility of the gravedigging teams to undertake levelling and topping up
- 4.12.5 For all these reasons levelling and/or topping up and re-turfing (or reseeding) practice has generally been poor or somewhat ad-hoc leading to areas being uneven and bumpy, difficult to maintain, or maintainable only by strimmer.

*Condition: Lawn Areas*

- 4.13.1 Lawn burials areas have small memorials arranged in lines in lawns. A key advantage of 'lawn burial' areas over traditional kerbset burials is that a high standard of maintenance, can be achieved using for instance large ride-on mowers and mowing of margins with smaller rotary mowers. Bearers or rafts can also be maintainable with low inputs of herbicides and/or regular hoeing. However, in Southwark:
- i. There has traditionally been a lack policy (or a lack of enforcement) of 'no garden area' rules for lawn burial areas and the encroachment of small gardens /kerbsets areas onto the lawns has been allowed. At Camberwell Old this is made particularly difficult on account of the fact that the existing traditional kerbset graves already set a precedent.
  - ii. Historically bearers or memorial rafts have not been used at Camberwell Old, even where lawn burial has been implemented. Moreover new plots have often been shoe-horned in between exiting graves and paths. This has led to a profusion of poorly aligned graves within irregular plots.

- iii. The responsibilities for communicating policy and enforcement, levelling, setting out and use of bearers, and maintenance have fallen to different parties.
- iv. These factors have in combination led to lawn areas being irregular, untidy, cluttered with unregulated memorials leading to areas being difficult to maintain, or maintainable only by strimmer.

4.13.2 Recent efforts to counter this have included clear information to the purchasers of graves (Appendix 4.1).

*Condition: Mowing Regime*

4.13.3 The grass cutting regime currently scheduled at the cemetery whilst it may or may not currently benefit the Council is overly simplistic. Mowing is being carried at a cost (rate) tendered for 'amenity grass' but that does not truly reflect the higher maintenance inputs actually involved in the strimming of traditional kerbset or poorly laid out lawn areas.

4.13.4 Not having separate regimes and cost rates for strimming (and for different frequencies of strimming) may mean that many areas are either not being maintained, or not being maintained to a level that is appropriate.

4.13.5 Where there are kerbsets hidden in grass, particularly where in poor condition, compensation claims may arise from visitors tripping over unseen hazards. On the other hand where kerbset areas are mown close but the kerbsets are in poor condition the bases and broken parts are exposed and this looks unsightly.

*Condition: Shrubs, Hedgerows Scrub Areas*

4.13.6 There are potential limitations in respect of the current maintenance arrangements of shrubs, hedgerows and scrub areas.

- i. The limitation of standard maintenance (cutting) of hedgerow to a max height of 1.8m may have historically caused problems where hedging has outgrown this height and maintenance has become a special item. Some areas such as the boundary hedges may simply have been left of schedules.
- ii. Clearance/barrier clearance (encroachment) of native scrub/shrub areas is left to be carried out 'as and when' required instead of being scheduled and this risks areas becoming overgrown and unmanageable, and in particular developing trees which then become default protected by TPO.

- iii. There may not have been robust arrangements for gapping up ornamental hedgerows.
- iv. The low (or no) herbicide approach is failing to address the problem of woody shrubs which are becoming established within kerbsets and damaging them.

#### *Opportunities*

4.12.6 The Southwark Open Space Strategy 2011 points to a change in the management of open space in Southwark. At paragraph 8.101 the strategy states :

*'It is recommended that the Council considers changing the emphasis of frontline greenspace management from roving maintenance gangs and their replacement with teams responsible for a smaller area and potentially „static“ frontline staff and gardeners who take on a more direct role as “rangers” incorporating gardening (park keeper), security and ranger responsibilities. The benefits of such an approach are:*

- *Improvement in maintenance standards as a result of ownership and familiarity with a site.*
- *Increase in safety and security.*
- *A first point of contact for communication of problems or reporting of damage.'*

4.12.7 The review of management and contracting arrangements of late 2012 a represents an opportunity to improve on current maintenance arrangements.

#### 4.13 Implications of the Cemetery Strategy

4.13.7 The Cemetery Strategy (see Appendix 6.1) will bring about significant further change in the character of the cemetery. In effect burial use will intensify of the short, mid, and long term. Proposals are summarised in section 6.0.

##### *Summary of Risks Constraints and Opportunities*

4.13.1 These changes will necessarily involve the introduction more 'formal' landscape treatments and modern types of memorialisation, and there is a risk that these could appear out of keeping with the historic character of the cemetery.

4.13.2 Set against this is risk of not pursuing the Strategy and there is a 'do nothing' scenario whereby there is continued under-investment a deterioration of the site in terms of its physical and visual accessibility along with a continued deterioration in the condition of its memorials. There would then be a risk that people would not be able physically get to, or see, or would be prevented from appreciating or understanding the value of the site. In that scenario the value of the site would also be diminished.

4.13.3 Under the Strategy there will be areas of older memorials which are currently in a 'romantic' state of abandonment where only limited numbers of memorials will be saved, (and the rest will be removed). It could be said that that represents a 'risk', however the memorials in those same areas, without costly intervention, will certainly become irretrievably lost in any case.

## 5.1 Vision for the Cemetery

- 5.1.1 The management of Camberwell Old Cemetery should aim to achieve an appropriate balance between use of the site for sustainable burial, recreation and amenity, alongside the protection and enhancement of the historic, cultural, arboricultural, and nature conservation values of the site .
- 5.1.2 The Masterplan and management policies detailed below seeks to take these issues fully into account.

## 5.2 Cemetery Strategy and Character Areas

- 5.2.1 The Cemetery Strategy has been informed by and developed around the Character Areas identified in Section 3.0. Thus areas with least heritage, cultural or nature conservation interest are proposed for use for more intensive burial. Areas with more substantial cultural and heritage interest are proposed to be enhanced e.g. through the restoration and reclamation of plots and monuments to enhance their value. Key wildlife and nature conservation features are retained and managed to enhance their habitat value.
- 5.2.2 The progressing of the Strategy with careful design and management, the correct approach to memorialisation, and the retention of the best historic and landscape features, in accordance with this CMP represents an opportunity to:
- enhance and historic character;
  - restore certain parts of the cemetery to close to their original composition;
  - reverse deterioration of infrastructure;
  - record for posterity the general record of burials and memorial, making them available to a wider audience, potentially online;
  - improve physical access across the site;
  - improve the interpretation and accessibility of the heritage of the site;
  - protect and enhance important aspects of the site's bio-diversity and nature conservation;
  - widen the amenity and recreational appeal of the site.

### 5.3 Conservation Management Policies for Features and Character Areas

5.3.1 Detailed policies are set out below according to character area below. All work in terms of existing historic monuments would take place in accordance with a strict plots Memorial Panel process as outlined below (and at Appendix 5.2). Similarly in some areas memorials would only be permitted in accordance with a strict Heritage Code (Appendix 5.3) in order to be in keeping the character of the cemetery.

5.3.2 Management policies for the Historic *Monuments Area* shall be to:

1	stabilise and restore all significant monuments on a progressive basis	5	arrest all regeneration of woody plants/trees
2	undertake selective appropriate reclamation of plots assuming strict preference for restoration and re-inscription of monuments	6	enhance quality of landscape setting hedges and boundary treatments
3	no new plot creation	7	maintain to a high standard- close mown throughout
4	improve facilities for interpretation	8	improve physical accessibility and infrastructure

5.3.3 Management Policy for the *Historic Core* shall be to:

9	stabilise (or record and clear) all unstable monuments in accordance with Memorial Panel process	13	arrest all regeneration of woody plants/trees
10	undertake reclamation of plots in accordance with Memorial Panel process	14	improve facilities for interpretation
11	undertake reclamation of appropriate plots ...	15	enhance quality of landscape setting hedges and boundary treatments
12	assume preference for a) restoration and re-inscription of monuments and then b) use of monolith or kerbset (heritage code) monuments as appropriate to the immediate setting.	16	maintain to a high standard- close mown at margins , intermediate mown away from margins
		17	improve physical accessibility and infrastructure
		18	manage larger trees

5.3.4 Management Policy for the *Historic Monuments Wooded* shall be to:

19	clear regenerated woodland	23	arrest regeneration of woody plants
20	stabilise (or record and clear) all unstable monuments in accordance with Memorial Panel process	24	improve facilities for interpretation
21	undertake reclamation of plots in accordance with Memorial Panel process	25	enhance quality of landscape setting hedges and boundary treatments
22	assume preference for a) restoration and re-inscription of monuments and then b) use of monolith or kerbset (heritage code) monuments as appropriate to the immediate setting.	26	maintain to a high standard- close mown at margins intermediate mown away from margins
		27	improve physical accessibility and infrastructure
		28	positively manage larger veteran/vintage/mature trees
		29	plan for tree succession

5.3.5 Management Policy for the *Secondary Historic* shall be to:

30	stabilise (or record and clear) all unstable monuments in accordance with Memorial Panel process	33	arrest regeneration of woody plants
31	undertake reclamation of plots in accordance with Memorial Panel process	34	improve facilities for interpretation
32	excepting for occasional significant monument assume preference for use of <u>monolith</u> (heritage code) monuments in open lawn arrangements .	35	enhance quality of landscape setting hedges and boundary treatments
		36	maintain to a high standard- close mown at margins intermediate mown away from margins
		37	improve physical accessibility and infrastructure
		38	positively manage larger veteran/vintage/mature trees
		39	plan for tree succession



5.3.6 Management Policy for the *Secondary Woodland* areas shall be to:

40	stabilise (or record and clear) all unstable monuments in accordance with Memorial Panel process	45	improve facilities for interpretation
41	arrest regeneration of woody plants/trees within kerbsets	46	improve physical accessibility and infrastructure
42	progressively thin stem growth within regenerating woodland, select and retain best tree specimens	47	positively manage larger veteran/vintage/mature trees
43	manage all invasive or undesirable weeds	48	enhance nature conservation value - make specific habitat/nesting provisions- e.g log pile/hibernaculum/bat boxes/bird boxes
44	prevent encroachment onto paths, reduce growth of woody scrub/bramble at margins		

5.3.1 Management Policy for the *Woodland Glades* shall be as 'New Lawn Burials' including:

Pending development as lawn burial	54	manage larger veteran/vintage/mature trees where retained
49 Manage as wildflower meadow pending development as lawn burial (from 2022)	Once developed as Lawn Burial ...	
50 arrest regeneration of woody plants/trees around perimeters	55	Manage as back to back arrangement with neat gravel rafts/bearers
51 manage all invasive or undesirable weeds	56	where possible enhance quality of landscape setting including hedges and boundary treatments
52 prevent encroachment onto paths, reduce growth of woody scrub/bramble at margins	57	maintain to a high standard- close mown throughout
53 remove and replace blighted/poor condition trees to co-ordinate with future burial	58	improve physical accessibility and infrastructure
	59	memorials to be lawn or monolith type meeting the heritage code

5.3.1 Management Policy for the *Amenity Grassland Areas* shall be as follows.

- |    |   |
|----|---|
| 60 | Area (F/F1 converted to lawn burials from 2012), and G1/G2 (converted to lawn burials from 2012): manage as 'New Lawn Burial's (See Woodland Glades above). |
| 61 | woodland burial area: manage as wildflower /rough grassland and seek opportunities to enhance floristic diversity   |

5.3.2 Management policy for the existing *Lawn Burial*:

- |    |   |
|----|---|
| 62 | Existing area (E) - manage as 'New Lawn Burial' (see Woodland Glade above).<br>(Use of Heritage Code for memorials has not been specified for Area E) |
|----|---|

5.3.3 Management policy for the existing area of *Recent Kerbset*

- |    |  |
|----|--|
| 63 | maintain to a high standard- close mown throughout                         |
| 64 | enforce a policy of removal of ephemera, unauthorised planting and gardens |

5.3.4 Management policy for the *Disturbed Areas (Area Z)* will depend on the final designs. Ultimately it is likely to be:

- |    |   |
|----|---|
| 65 | managed as Lawn Burials (as for Woodland Glades above). |
|----|---|

5.3.5 Management of *Yard and Operational Areas*: The site of the old Anglican chapel currently used as a car park is planned as a Mausoleum. Being central and conspicuous it should cease to be used for materials/yard activities/containers. The second area takes in the masons yard in the south east corner and this should be considered for use as toilets and for limited storage activities, subject to achieving agreement and alternative premises for the stone mason (potentially in Camberwell New) .

- |    |   |
|----|---|
| 66 | Integrate yard/storage areas well into landscape and present attractive frontages/boundaries. Ensure all significant storage activities take place at Camberwell New. Integrate with toilet facilities if possible. |
|----|---|

5.3.6 Management of *Garden Verge Areas*.

67 Develop a robust and enhanced structure of fine lawn/parterre/rose or herbaceous shrubs/formal hedges. Avoid any use for burial or interment of full or cremated remains. Permit scattering/ strewing into soil behind parterre.

5.3.7 The *Commonwealth War Graves* area is managed by the CWGC to a high standard and this will not change.

68 Maintain peripheral areas to the CWG to a high standard.

#### 5.4 Policy on Use of Bearers/Memorial Rafts

##### *Bearers/Memorial Rafts*

5.4.1 Most new burial areas will be 'lawn burial' arranged head to head (back to back) for ease of maintenance or head to toe (one way facing) where space is a constraint. The preferred arrangement is to use a dedicated memorial bearer or over undisturbed ground at one end of the grave (900mm wide for back to back memorials , 550mm wide for one way facing). The plot should be managed under lawn regulations with no garden areas encroaching (See appendix 4.1). Memorials will generally be lawn memorials 3' high x 2' wide x 3" thickness with headstones secured to a base, 2'6 x 12" x 3", and fitted to the bearer where supplied or fitted into a shoe below a gravel bed in accordance with NAMM guidance .

5.4.2 In Camberwell Old the policy will be for the use of bearers with gravel at the surface which are in keeping with the informal /heritage feel of the area and more able to accommodate the sloping ground. Gravel bearers can also be combined with a drainage function.

#### 5.5 Heritage Memorial Code, Memorial Panel

##### *Heritage Code*

5.5.1 In much of the cemetery it will be necessary to ensure that all new memorials are of a suitable character to complement the adjacent older historic memorials and the general character of the cemetery. This may involve the stipulation that memorials comply with a Heritage Memorial Code. This Code is under development and an example is included at Appendix 5.2. Heritage Memorials will be more constrained in terms of sizes permissible.

A more limited variety of natural stone materials will be permitted and the use of black granite, currently in vogue would not be permitted

5.5.2 In practice and subject to further agreement there may be three types of Heritage Memorial permissible:

- i. Heritage 'Lawn Memorial' types with composite (modern) arrangement of Headplate and Plinth. These would be for general use in new lawn burial areas where previously sited over public burials (monoliths may also be permitted on lawn burials areas-see below).
- ii. Heritage Memorials of the 'Monolith types with simple arrangement of a single monolithic headplate. These would be mandatory for all reclaimed and re-used private graves areas). Also suitable for modern lawn burial areas over old public burials). Monoliths would also be mandatory on all graves/plots where due to plot-size constraints the memorial has to be placed over the excavated grave (monoliths being more resistant to subsidence than lawn memorials )
- iii. Heritage Memorials- Traditional Kerbset : These would be for exceptional use only for reclaimed and re-used private graves areas where, in order to preserve or maintain the character of a row of traditional kerbsets which is otherwise intact, a traditional 2'6"x6'6" kerbset in heritage materials is suitable

#### *Memorial Panel*

5.5.3 As part of re-use and reclamation there is a need to assessment of plots/graves and memorials. Memorials will need to be assessed in detail with regard to their value and suitability for a) restoration b) restoration/reversal and re-inscription c) restoration for re use without original inscription d) recording and removal. This assessment will involve a Memorial Panel Process (see Appendix 5.2).

## **5.6 Consultation, Communication**

5.6.1 In addition to the above it is likely that a series of public meetings will need to be held to consult upon and communicate the various developments proposed in the Cemetery. In certain circumstances it is likely to be useful to combine Friends Liaison Group Meetings with a wider public meeting. It is likely to be useful also to involve the Friends group in the dissemination of information on public meetings and consultations.

## 5.7 Accessibility of the Heritage Asset

- 5.7.1 A key part of increasing accessibility to the cemetery is not only physical accessibility but accessibility of the historical, genealogical, and cultural heritage. Much of this is currently being lost through memorials becoming lost, hidden, damaged, unstable or simply decaying. The Cemetery Strategy as guided by this CMP provides an opportunity to record the detail of memorials, their architectural/sculptural form, and the detail of inscriptions. If and when any memorials are cleared as part of re-use or reclamation the recording of this detail in a register is a legal requirement (see detailed guidance within Technical Guidance on the Re-Use and Reclamation of Graves in London Local Authority Cemeteries', by London Environment Director's Network (2013)) Opportunities should be sought to make this register/information readily available to the public either through the offices of the service, or preferably on-line.
- 5.7.2 The 'Interpretation' of the nature conservation, heritage and cultural values of the site should not be limited to on-site signage. Signs can be damaged, can quickly appear dated, and rarely convey the full interest. They can become out of date as a site changes and as research reveals more interest. Moreover where the site is inherently difficult to physically access a fixed sign approach reaches only a limited market. A better approach is that of linking low key signs on site to a series of leaflets, guided walks and website pages. A modern approach is to use smart phone applications. A Friends group may assist in this albeit the Council should retain some ownership by for instance sponsoring elements of the interpretation package and/or through receiving assistance from the council communications team.

## 5.8 Management and Maintenance

- 5.8.1 A number of issues have been identified in section 4.0 relating to
- Levelling and Re-turfing of Graves (generally)
  - Lawn Areas
  - Mowing Regime
  - Woody Scub
  - Shrubs, Hedgerows Scrub Areas

*Levelling and Re-Turfing of Graves (generally)*

- 5.8.2 In order to resolve management maintenance difficulties it should be policy to achieve a high quality of lawn restoration as soon as possible after interment. Detailed prescriptions might include:
- i. minimise the amount of soil surcharged during the dressing of graves so as to be a small manageable mound
  - ii. set a 3 week date after which the grave will be cleared, the mound consolidated with supplementary soil recycled from site works, dressed with loamy topsoil from site store and turfed.
  - iii. advise all purchasers of graves, at the point of sale , that this action will take place
  - iv. erect site notices to the same effect
  - v. conduct scheduled inspections on a quarterly basis of all burial areas and schedule levelling, topping up and turfing works
- 5.8.3 The Cemetery and Crematorium Operations Manager assisted by the Monitoring Officers should be best placed to take responsibility for inspecting this levelling and topping up. Bulk handling of excavated material, and compaction and replacement should be carried out by the grave-digging team with follow on topsoil and turfing by the team responsible for maintenance.

#### *Lawn Areas*

- 5.8.4 Management should work toward achieving maintenance of lawn areas using only ride on or large rotary mowers, not strimming. Strict enforcement of 'no garden' policy should be the responsibility of the Cemetery and Crematorium Operations Manger assisted by the Monitoring Officers and :
- i. all purchasers of graves should be clearly advised as to which regulations apply (e.g. lawn regulations) using standardised notices (e.g. Appendix 4.1 )
  - ii. edges to bearers should be clearly marked out e.g. using driven copper nail markers /spray paint in advance of grave digging to maintain correct spacing (generally 1.22m (4') plot widths for gravel bearers)
  - iii. where memorial mason are to set memorials in gravel it is their responsibility to replace the weed suppressing membrane below the gravel, and replace and top up disturbed gravel. This should be made clear to them and made part of the conditions for erecting the memorials.
  - iv. practice needs to be established for removing weeds from gravel bearers by a combination of hoeing gravel on a quarterly basis supplemented with occasional

topping up of gravel. Occasional it will be necessary to spray out more pernicious weeds. This should theoretically give rise to lower maintenance inputs relative to strimming.

#### *Mowing Regimes*

5.8.5 It is suggested that it should be policy to follow more clearly differentiated mowing regimes These might for instance include:

- A. *Ornamental Grass* (Ornamental Garden and Verge areas)
- B. *Amenity Grass –Lawn* (all new Lawn Burial Areas, general verges, open/unobstructed burial areas where near full clearance has taken place and where mowing may take place with rotary mowers)
- C. *Amenity Grass –Obstructed* (Grass Areas partially obstructed with Traditional Kerbset where mowing may only take place with by rotary mowers but with strimming around obstacles- applies generally to Secondary Historic areas)
- D. *Close Mown -Strimmed* (areas around all kerbsets within 3m (one grave) back from path edges. Also applicable to entirety of 'Historic Monuments' areas. Assumes monuments are in sound condition with bases, foundations hidden by an even ground level)
- E. *Intermediate Mown -Strimmed* (areas around all kerbsets greater than 3m (one grave) back from path edges. Set cutting intervals to maintain grass height below outer edge of most kerbs (100-150mm) Assumes monuments are in sound condition)
- F. *Summer Meadow* with a twice (2x) annual cut, rake and removal (areas with specific summer meadow floristic diversity set away from paths and clear of unseen obstructions)
- G. *Spring Meadow* with a twice (2x) annual cut, rake and removal (areas with specific spring meadow floristic diversity set away from paths and clear of unseen obstructions)
- H. *Conservation Grass* areas 6x annually to 150mm nominal height ( other areas set away from paths and clear of unseen obstructions)

#### *Woody Scrub*

5.8.6 It is suggested that a policy of preventing woody shrub growth in kerbsets or memorials should be followed. Specific maintenance items should be included for this work.

#### *Shrubs, Hedgerows Scrub Areas*

- 5.8.7 Maintenance regimes for Shrubs, Hedgerows Scrub Areas should be refined to include:
- A. Regular scheduled clearance/barrier clearance/cutting back for all native shrub areas (Outside of bird nesting season)
  - B. Removal of regenerating trees from all native shrub areas.
  - C. Programme for formative cutting and gapping up of ornamental hedgerows.
  - D. Programme for maintaining boundary hedgerow so as to be less than 1.8m year round

## 5.9 Roles and Responsibilities in Maintaining Conservation Standards

- 5.9.1 Currently roles and responsibilities within the Section are as outlined in Appendix 5.1. Ultimately the Cemetery and Crematorium Manager will remain responsible for managing the site, for protecting, conserving and enhancing its various assets. It is understood that a Service Development Manager will specifically be available to work on new project areas delivering the Cemetery Strategy. That officer will need to maintain a good working knowledge of this CMP.

### *Cemetery Working Group*

- 5.9.2 There are complex issues involved in rolling out the Cemetery Strategy, and there is a need to balance potential tensions between the management objectives for nature conservation, arboricultural, and objectives for amenity, or burial. Given these complexities it is likely to be worthwhile to schedule regular Cemetery Working Group meetings for those involved in cemeteries including the:
- Cemetery and Crematorium Manager
  - Service Development Manager- Cemetery Strategy
  - Ecologist
  - Tree Officer
  - Monitoring Officer(s)
  - Cemetery and Crematorium Operations Manager
  - Contracts and Service Manager

### *Friends of Camberwell Old Cemetery'*

- 5.9.3 It will also be useful to continue the work already carried out in developing a properly constituted 'Friends of Camberwell Old Cemetery'. The Friends group should ideally have representatives with interests in all facets of the cemetery including, burial, amenity/recreation, nature conservation, and heritage. A regular (quarterly or twice-



annual) schedule of Friends Liaison Group meetings, co-ordinated to convene around the time of the Cemetery Working Group would then provide a useful forum. The group might be encouraged to

- input and comment on Cemetery Strategy and management projects;
- highlight any other management concerns/issues;
- report vandalism, damage, littering or antisocial behaviour;
- carry out monitoring work eg nature conservation, users/visitors;
- conduct research – e.g. cultural/historical/monument inscriptions;
- fund-raise and develop projects such as interpretation or heritage/nature walks;
- dissemination of information on public meetings and consultations.

#### *Memorial Panel*

5.9.4 This assessment of memorials will involve a Memorial Panel Process (see Appendix 5.2). The Panel itself would ideally be constituted to include:

- Cemetery and Crematorium Manager\* (and /or) Cemetery and Crematorium Operations Manager
- Friends Group Representative
- Diocesan Representative
- Local specialist Stone Mason
- Southwark Council Conservation Officer
- External Consultant\*- e.g. ICCM

5.9.5 In practice once a robust framework for assessment has been formulated the external consultant\* need no longer be involved. Similarly once the framework has been established and the process is running the Cemetery and Crematorium Manager need no longer attend, with the proviso that the Operations Manager or a senior administrative officer is in place to ensure the process is fully recorded.

#### *Cemetery Liaison Group*

5.9.6 As part of the wider management of the cemeteries it is envisaged a Cemetery Liaison Group might be established including:

- Friends Group representatives
- Funeral Directors
- Diocesan Representative/Local Ministers
- Memorial Masons

## **6.1 Masterplan Introduction**

- 6.1.1 This Cemetery Strategy for Southwark Council seeks to address the chronic shortage of burial space in the borough. The Strategy (see Appendix 6.1) focusses on practical options for burial within the current cemetery areas within Southwark but also takes account of potential options for burial outside of those areas. This Masterplan is integrated with the Cemetery Strategy proposals.
- 6.1.2 The Cemetery Strategy proposes range of options addressing short, medium and long term provision of burial space, and is focussed on the Camberwell Old Cemetery and Camberwell New Cemetery. Some 'immediate' options have been considered and are already developed or in development (Area F/F1 and Area E)
- 6.1.3 Short Term options are proposed to 2022 and medium term options thereafter to 2040. There is significant lead in time in developing process for reclamation and re use of private graves, not least a requirement for primary legislation, hence the 2022 start date. Cabinet approved the Strategy with a proviso of re-sequencing Z in advance of H1 (subject to technical appraisal) and this is accounted for in the summary tables below.

## **6.2 Short Term- (prior to 2022)**

- 6.2.1 Table 6.1 sets out Short Term Options included in the Cemetery Strategy. Management policies are given in relation to each area (with reference section 5.0). Table 6.2 sets out other physical works to be implemented in the short term associated with the Masterplan.

Table 6.1 Short Term Options ( prior to 2022)

Site	Target Start Date .	£	Planning and Faculty Requirements	Works/Infrastructure	Management Policies
F & F1 Lawn Burial Soil Top up over Public Graves C'Old	2/2013		Planning	New paths Tree Loss , Replacement Planting Modified alignment to Green Chain Walk Earthworks Gravel memorial rafts (standard (non Heritage Code memorials )	After Layout 55, 56, 57, 58, 59  Memorials to Heritage Code (if alternative non heritage code areas still available elsewhere)
H1 Lawn Burial within previously topped up area Ryedale Rd  Camberwell Old	4/2021		Faculty Planning	Re-surface main access with hammerhead (or form full circulation loop) to vehicular standard Extend access and paths Protect and sign 'overgrown' private grave areas adjacent Protect resident amenity with planting and buffer strip and 'amenity' area Gravel memorial rafts	Prior to layout 49,50,51,52,53  After Layout 55, 56, 57, 58, 59  Memorials to Heritage Code (Lawn/monolith)
Z Remediation of earthworks, possible top up, new burial layout	2/2020 To be Brought Forward subject to technical appraisal		Faculty Planning	Proposals subject to investigations Soil remediation/amelioration/regarding/top up Tree Loss and tree replacement Boundary Planting Boundary fencing Extend access and paths  Gravel/concrete memorial rafts	After Layout 55, 56, 57, 58, 59  Memorials to Heritage Code (Lawn/monolith)

Table 6.2 Other Infrastructure and Management in Short Term (prior to 2022)

Site	Target Start Date .	£	Planning and Faculty Requirements	Works	Management Policies
Secondary Woodland Areas	From 2013		Planning (TPO)	Thin, coppice, stabilise and record monuments.	40, 41, 42, 43, 44, , 47,, 48
Historic Monuments, Historic Monuments Wooded Historic Core	From 2013		Faculty Planning (TPO)	Stabilise and restore key monuments	19,20,23,25,28
Repairs main 'Butterfly' Carriageway	2013		No	Localised/targeted repairs to all areas failing	Inspections, repeat work to prevent deterioration
Refurbishment main 'Butterfly' Carriageway	2018 (or with Z)		No	Comprehensive repairs. Full new wearing course	Inspections
Garden Verge Areas	From 2013		No	Enhance planting, lawn parterre hedging, structural hedges	67
Toilets and Yard	From 2013		Faculty Planning	(Subject to detailed investigations/agreements) New Toilet Facility Potentially integrate with new small storage facility. Location to be investigated (potentially site on Masons yard)	66  Lock out of hours.  Strict management of type/quantity/movements of materials
Benches	From 2013		No	Limited number of location options (either side of the entrance, and or off the Greenchain walk). Fix high quality traditional benches	All new benches may be sponsored by the bereaved but must subject to strict lease period not in excess of 10 years. Limit numbers
Interpretation	From 2013		No	Site panels supported with leaflets/web material	4,14, and section 5.7
Water Supply	From 2013		No	Investigate and schedule repairs. Upgrade fitting types.	Inspections

### 6.3 Medium Term-( after 2022)

6.2.2 Table 6.3 sets out Medium Term Options included in the Cemetery Strategy.

Management policies are given in relation to each area (with reference section 5.0).

Table 6.4 sets out other physical works to be implemented in the short term associated with the Masterplan.

**Table 6.3 Medium Term Options (after 2022)**

Site	Target Start Date .	£	Planning and Faculty Requirements	Works	Management Policies
G1 G2 Lawn Burial within previously topped up area on Consecrated Ground	10/2022		Faculty	New Paths Gravel memorial rafts Limited Tree Loss Tree Replacement	Prior to layout 49,50,51,52,53  After Layout 55, 56, 57, 58, 59  Memorials to Heritage Code (Lawn/monolith)
Woodland Glade H2, H3 New Lawn Burial Through Re Use under Faculty	1/2027		Faculty P	Uses re-surfaced main access implemented with H1 Extend access and paths through private grave areas adjacent Protect and sign 'overgrown' private grave areas adjacent Protect resident amenity with planting and buffer strip and 'amenity' area Gravel memorial rafts	As above
Woodland Glade J, K, L New Lawn Burial Through Re Use under Faculty	4/2029		Faculty	As above	As Above
Secondary Historic R1,R2,T Q1,Q2,Q3,Q4 Reclaim/Re-use of Private Graves	2022		Faculty	Re-claim of unused grave space . +/- Re-use under 2007 act (but only subject to change in law or legal clarification)	30,31,32,33,34,35,36,37, 38,39 Memorials to Heritage Code (monolith (or kerbset in exceptional cases))
Mausoleum Sites Chapel Sites I.1, I.2)	2022		Planning Faculty	Sensitively designed Mausolea.	Seek to legal advice on long term sustainability/ reuse of the niches

**Table 6.4 Other Infrastructure and Management in Medium Term (after 2022)**

Site	Target Start Date .	£	Planning and Faculty Requirements	Works	Management Policies
Historic Monuments, Historic Monuments Wooded Historic Core	Continue after 2022		Planning (TPO) Faculty	Stabilise and restore key monuments	1, 5, 8, 19,20,23,25,28 Prepare for reclamation and or re-use
Garden Verge Areas	Continue after 2022			Enhance planting, lawn parterre hedging, structural hedges	67
Secondary Woodland Areas	Continue after 2022		Planning (TPO)	Thin, coppice, stabilise and record monuments.	40, 41, 42, 43, 44, , 47,, 48

## 6.4 Long Term- (after 2040)

6.4.1 In the long term (after 2040) and subject to legal factors it is envisaged that continued but more limited reclamation of older graves (and or re-use of older private graves) will take place in some parts of the Historic Monuments and Historic Core areas subject to a strict Memorial Panel Process with associated restoration of monuments and subject to the detailed policies (section 5.3) numbered 1 to 18.

## 6.5 Action Plan

6.5.1 Immediate actions necessary to implement robust management are set out in Table 6.5. These are over and above measures set out in the Cemetery Strategy and those set out in Tables 6.1, 6.2, 6.3, and 6.4 above.

**Table 6.5 Other Management Measures for the Short Term (from 2013)**

Topic	CMP Ref	Areas Applicable	Detail
Memorial Stability	S4.3	All Areas	Review existing stability assessments/surveys Identify key areas of concern under Risk Assessment process Follow ICCM guidance . Initiate programme for action for key monuments
Cultural Assets	S4.4	All Areas	Review research, locate, photograph, record all culturally significant graves and monuments. Potentially involve Friends/Civic /Local History societies
Garden and Verge Area - Enhancements	S4.5	Garden and Verge Area	Review and detail enhancements to garden/verge areas
Detailed Review of Toilet/Yards Options	S4.6	All Areas	Conduct more detailed Review of Toilet/Yard Options Consider future options for Stonemasons Yards
Management Work Schedules- Nature Conservation	S4.7	All Areas	Develop detailed management work schedules – Nature Conservation
Tree Survey and Risk Assessment, Work Schedules	S4.8	All Areas	Conduct more detailed Tree Survey (VTA) and Risk Assessment, develop Work Schedules
Cemetery Liaison Group	S5.9	All Areas	Constituting Liaison Group
Friends Group	S5.9	All Areas	Assist in constituting Fiend Group
Memorial Panel	S5.9	All areas	Establish Memorial Panel Establish Assessment Process and Framework Establish Admin sytem
Heritage Memorial Code	S5.5	As table 6.1, 6.3	Develop and adopt Heritage Memorial Code to be applied to (new) Lawn Memorials / Monolith Memorials/ Kerbsset Memorials
Levelling and Turfing	s5.8	All areas receiving new Burials	Develop Formal system for Levelling and Turfing
Review Mowing regimes	s5.8	All areas except Secondary Woodland Historic Monuments-wooded Disturbed Areas (Z)	Review current mowing regimes Map out new regimes Include as part of Maintenance Review
Scrub, Shrub, Hedgerow Management	s5.8	All Areas	Review current mowing regimes Map out new regimes Include as part of Maintenance Review
Bearers	s5.8	All Lawn Burial Areas	Develop and adopt regime for maintenance

***Illustration: Completed Lawn Burial Areas : Area E***



Figure 6.1 Masterplan







## 7.1 Monitoring and Review

- 7.1.1 Over time developments within the cemetery and works on the ground will render some of the recommendations within this CMP out of date and in need of revision.
- 7.1.2 This CMP should therefore be considered a 'working document'. Sections should be expanded, added, and revised periodically.
- 7.1.3 The CMP should be reviewed on an annual basis and/or upon the implementation of each key burial area developed out under the Cemetery Strategy
- 7.1.4 This monitoring, review and revision should be carried out under the direction/ownership of the Cemetery and Crematorium Manger and subject to review by the Parks and Open Spaces Manager. Changes should be 'tracked' at each revision.

## 7.2 Adoption

- 7.2.1 Adoption of a CMP as 'formal policy' by the Council can assist in giving it validity. In order for this happen it would first have needed to be subject to consultation and scrutiny. However, given the CMP is essentially a working document and constantly under review formal adoption in this way can present difficulties. As an alternative the formal approval of the CMP at annual or special meetings of Friends and Liaison Groups may assist in giving weight to the document, and in so doing assure the Council that its management approach and actions are in order.

## 7.3 Review

- 7.2.2 The CMP should be more thoroughly reviewed every 3-5 years with key stages at 2017 and 2020 (this to co-ordinate with the review period for the Cemetery Strategy).