

- GENERAL NOTES**
1. THIS DRAWING SHOULD NOT BE REPRODUCED IN WHOLE OR PART WITHOUT THE WRITTEN CONSENT OF LINK ENGINEERING.
 2. DO NOT SCALE FROM THIS DRAWING. UNITS ARE IN METRES UNLESS OTHERWISE SPECIFIED.
 3. THE CONTRACTOR IS TO CHECK ALL INFORMATION PROVIDED PRIOR TO COMMENCING WORKS AND SEEK CLARIFICATION FROM THE ENGINEER IN RESPECT TO ANY AMBIGUITIES FOUND.
 4. THIS DRAWING SHOULD BE READ IN CONJUNCTION WITH ALL OTHER SCHEME SPECIFIC DRAWINGS.

GENERAL KEY:

LAND TO BE STOPPED UP

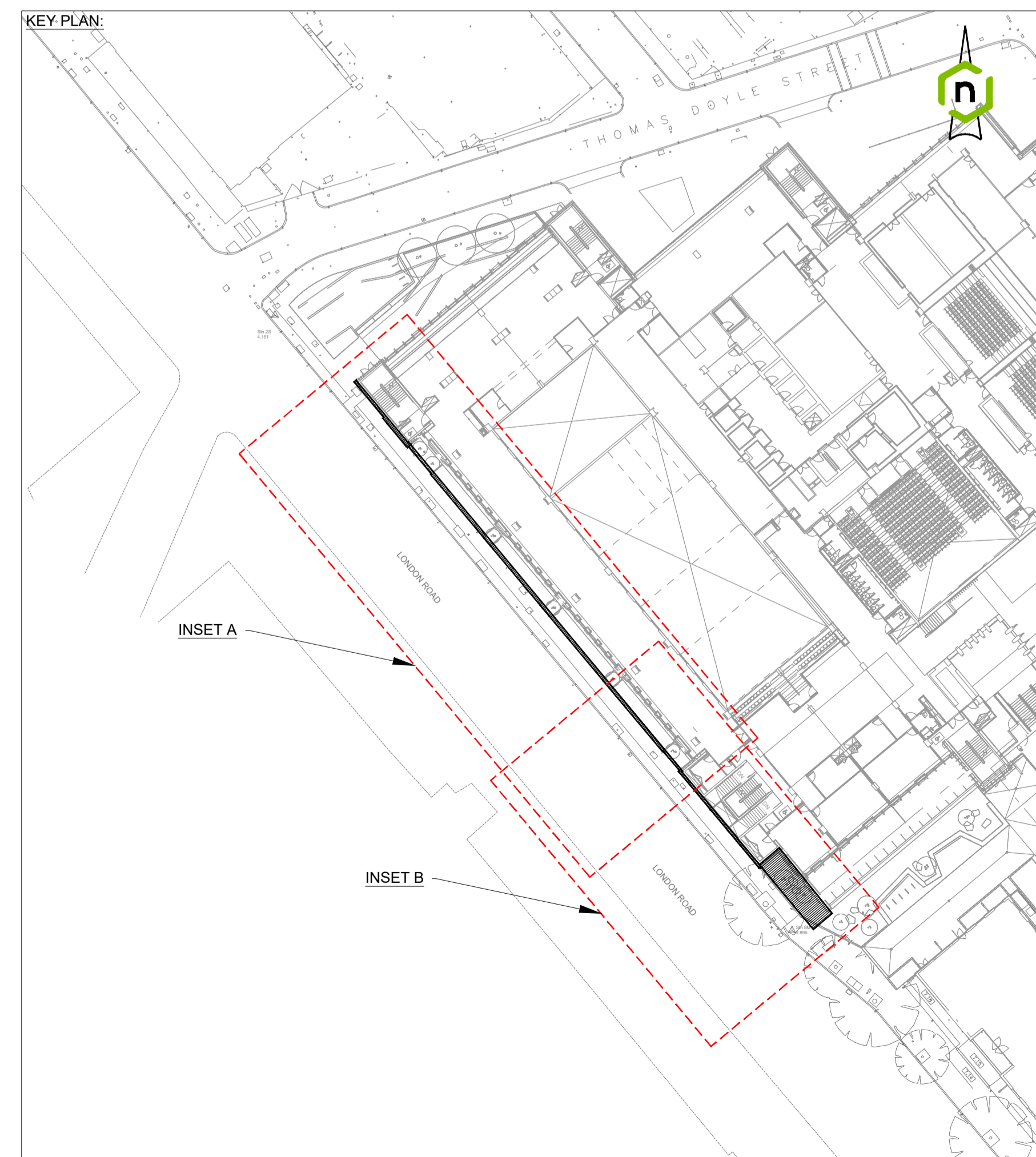
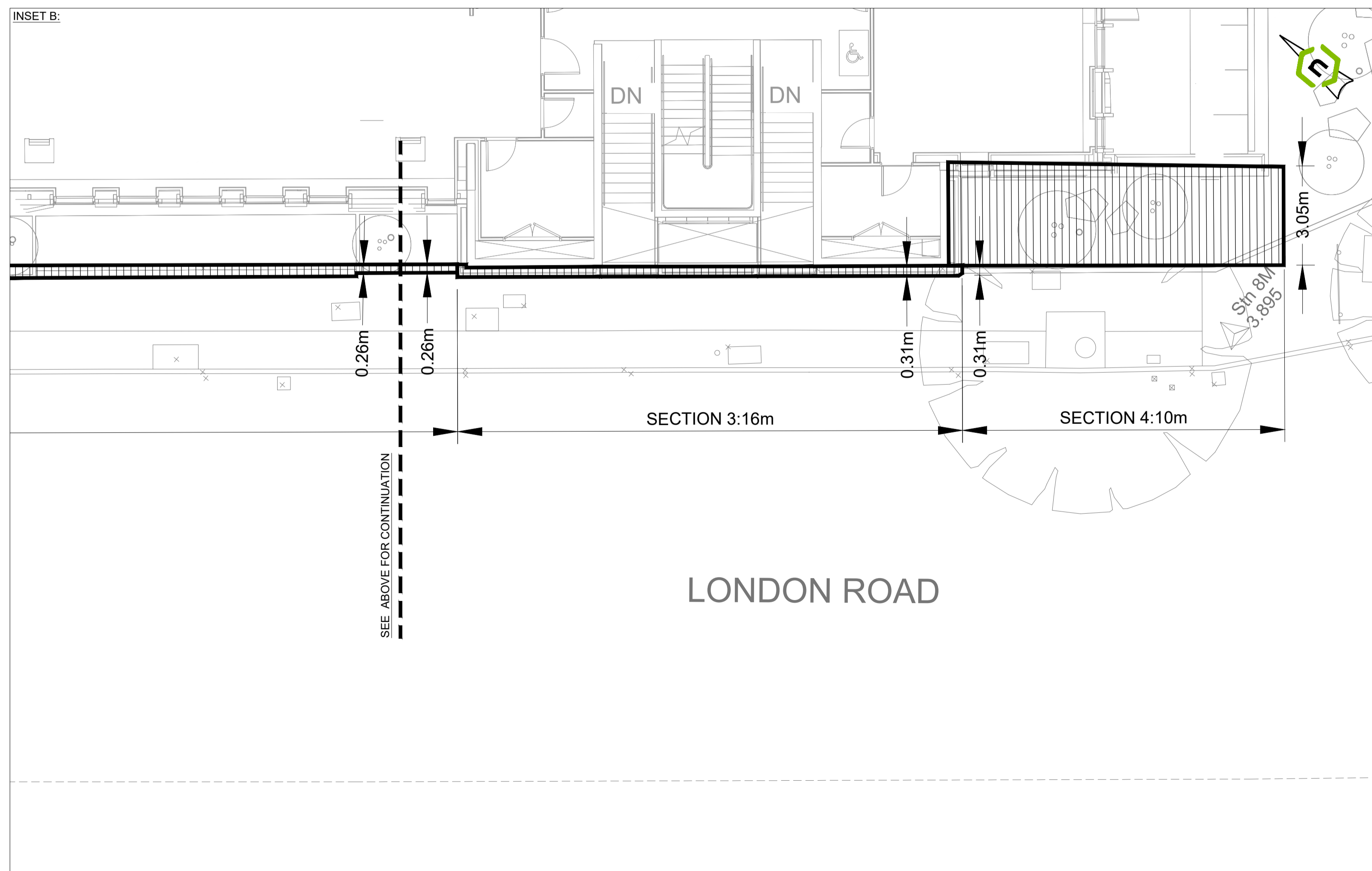

Rev.	Amendments	Date	By
A	ADDITIONAL GEOMETRY POINTS ADDED	04.09.20	RCG
A	REVISED BASED ON AUTHORITY COMMENTS	24.06.20	JWM
-	INITIAL ISSUE:	24.04.20	JWM

Revisions

Client

London South Bank University

Link ENGINEERING

Project
LE20191 - LSBU, LONDON ROAD

Drawing
S247 - STOPPING UP PROPOSALS

Scale @ A1
1:100

Drawn
JWM

Checked
RCG

Rev
B

PUBS:TS:LE-GEN-XX-DR-CE-001\INFORMATION (S2)