

Public notice (section 90G)

Denmark Hill raised crossing

1. Southwark Council hereby GIVES NOTICE under sections 90A to 90I of the Highways Act 1980¹ and in accordance with the provisions of the Highways (Traffic calming) Regulations 1999³, of the implementation of a speed table of flat-top construction, having a maximum height of 100 millimetres and covering the entire width of the carriageway in DENMARK HILL from a point 5 metres south of its junction with Champion Hill extending southward for a distance of 8 metres.
2. For more information about this notice please contact Southwark Council's Highways team by e-mail Highways@southwark.gov.uk
3. Copies of this notice and plans may be found online at www.southwark.gov.uk/trafficorders, paper copies may be obtained from or viewed at Highways, Southwark Council, Environment and Leisure, 3rd floor hub 2, 160 Tooley Street, London SE1 2QH – by appointment only. Please email traffic.orders@southwark.gov.uk or call 020 7525 3497, for details.

Dated 18 June 2020

Nicky Costin - Parking and Network Management Business Unit Manager, Regulatory Services

¹ 1980 c.66

² S.I. 1999/1065

³ S.I. 1999/1026

Public notice (section 90G)

Denmark Hill raised crossing



This project is part of the Route Modernisation Plan programme - aimed at improving bus journey times as well as pedestrian and cycling facilities throughout.

This scheme proposes changes to Denmark Hill between its junction with Champion Hill and its junction with Sunray Avenue (within the Champion Hill ward of the London Borough of Southwark) and complimentary to those on the London Borough of Lambeth side.

The proposed scheme provides the implementation of:

- widening of various sections of the bus lane along Denmark Hill
- the provision of dropped kerbs at the existing informal crossing by Deepdene Road
- removal of the informal crossing by Blanchedowne
- replacing the staggered crossing by Champion Hill with a straight crossing on a raised table

Link to the decision:

<http://moderngov.southwark.gov.uk/mgDecisionDetails.aspx?Id=50022075&Opt=1>

Dated 18 June 2020

For more information contact:

Lola Olanlokun
Transport Projects
Highways

Highways@southwark.gov.uk

LAYOUT A

LEGEND CONTINUED

- Tree pit construction. Refer to Series 1100.
- Existing tree to remain.
- Existing gully to remain.

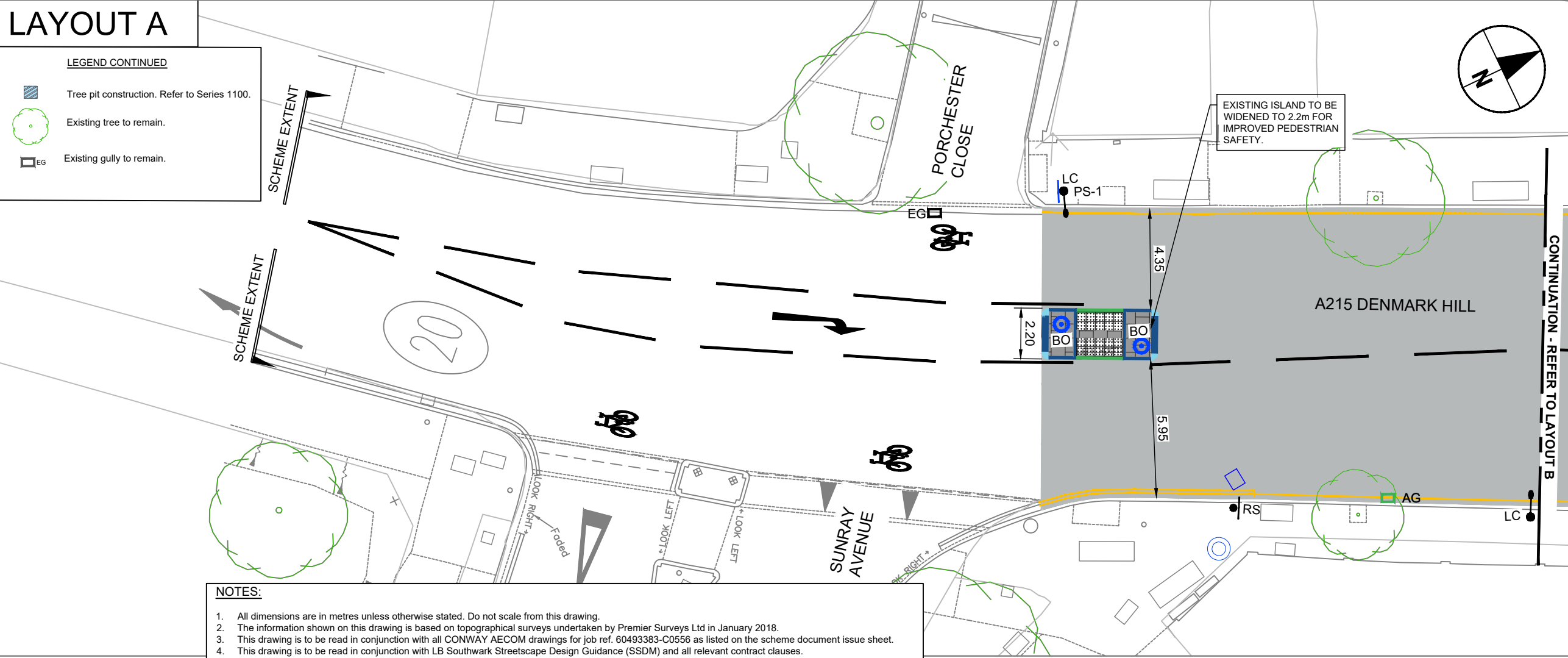

NOTES:

- All dimensions are in metres unless otherwise stated. Do not scale from this drawing.
- The information shown on this drawing is based on topographical surveys undertaken by Premier Surveys Ltd in January 2018.
- This drawing is to be read in conjunction with all CONWAY AECOM drawings for job ref. 60493383-C0556 as listed on the scheme document issue sheet.
- This drawing is to be read in conjunction with LB Southwark Streetscape Design Guidance (SSDM) and all relevant contract clauses.
- Traffic management is to be in accordance with Chapter 8 of the Traffic Signs Manual and Safety at Street Works and Road Works.
- Contractor to scan for services prior to excavation and refer to utility records.
- Contractor to maintain access to all properties and businesses at all times and agree alternative access arrangements with stakeholders.
- Tactile paving to be laid with a maximum gradient of 1:12.
- Damaged slabs, blocks or kerbs as part of the adjacent construction works to be reinstated to match existing.
- Drawing to be printed in A3 for clarity.

LEGEND

- Carriageway resurfacing (40mm inlay). Refer to Series 1100.
- Carriageway resurfacing (100mm inlay). Refer to Series 1100.
- Bound footway construction (precast concrete slabs). Refer to Series 1100
- Unbound footway construction (precast concrete slabs). Refer to Series 1100.
- Existing utility cover to be adjusted to proposed levels.
- Existing lamp column to remain
- Proposed location of sign mounted on existing lamp column. Refer to Series 1200.
- Existing road sign to remain.
- Existing gully to be adjusted to proposed levels. Refer to Series 500.
- Existing bus shelter to remain.
- Blister tactile paving construction precast concrete paving flags. Refer to Series 1100.
- Proposed TMP bollard. Refer to Series 1100.
- Proposed position for relocated bin.
- Proposed road markings. Refer to Series 1200.
- Proposed granite full height kerb (150mm wide). Refer to Series 1100.
- Proposed granite full height kerb (300mm wide). Refer to Series 1100.
- Proposed granite flush kerb (150mm wide). Refer to Series 1100.

LOCATION PLAN

LAYOUT B

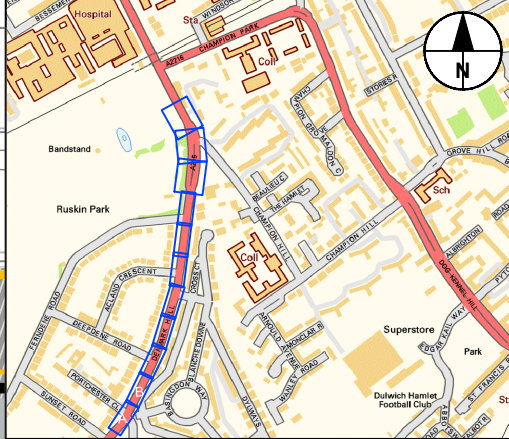
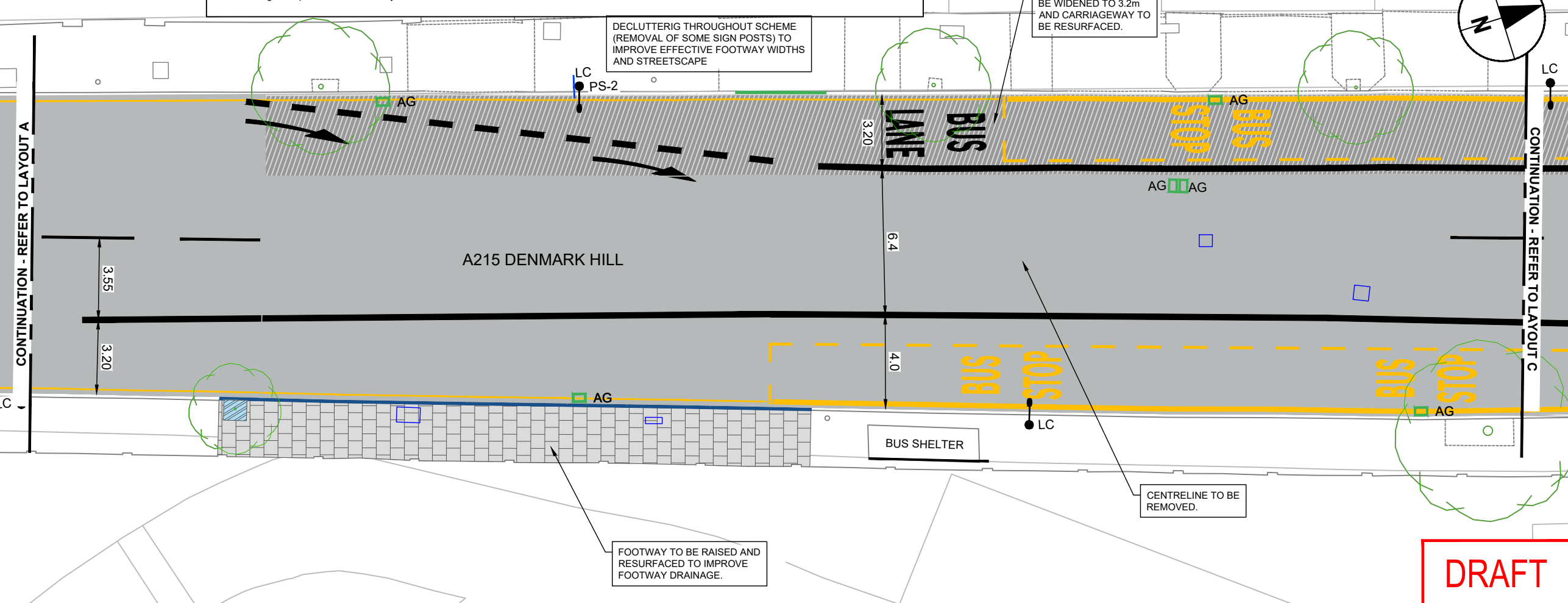

REV	DATE	REVISION DESCRIPTION / DETAILS	DRN BY	CHKD BY	APPRVD BY
A	30/03/20	AMENDMENTS FOLLOWING BUILDABILITY REVIEW	TTE	YW	SIA
0	28/02/20	FIRST ISSUE	CM	YW	AGB



PROJECT: DENMARK HILL DETAILED DESIGN

TITLE: SERIES 100: GENERAL ARRANGEMENT SHEET 1 OF 7

CONTRACT NO:	60493382-C0556	DRAWN	TTE
SCALE:	1:200 @ A3	DESIGNED	TTE
DRAWING NO:	60493382-C0556-100-01	CHECKED	YW
DATE DRAWN:	MARCH 2020	APPROVED	SIA
DATE ISSUED:	30 MARCH 2020	REV:	A

DRAFT

LAYOUT C

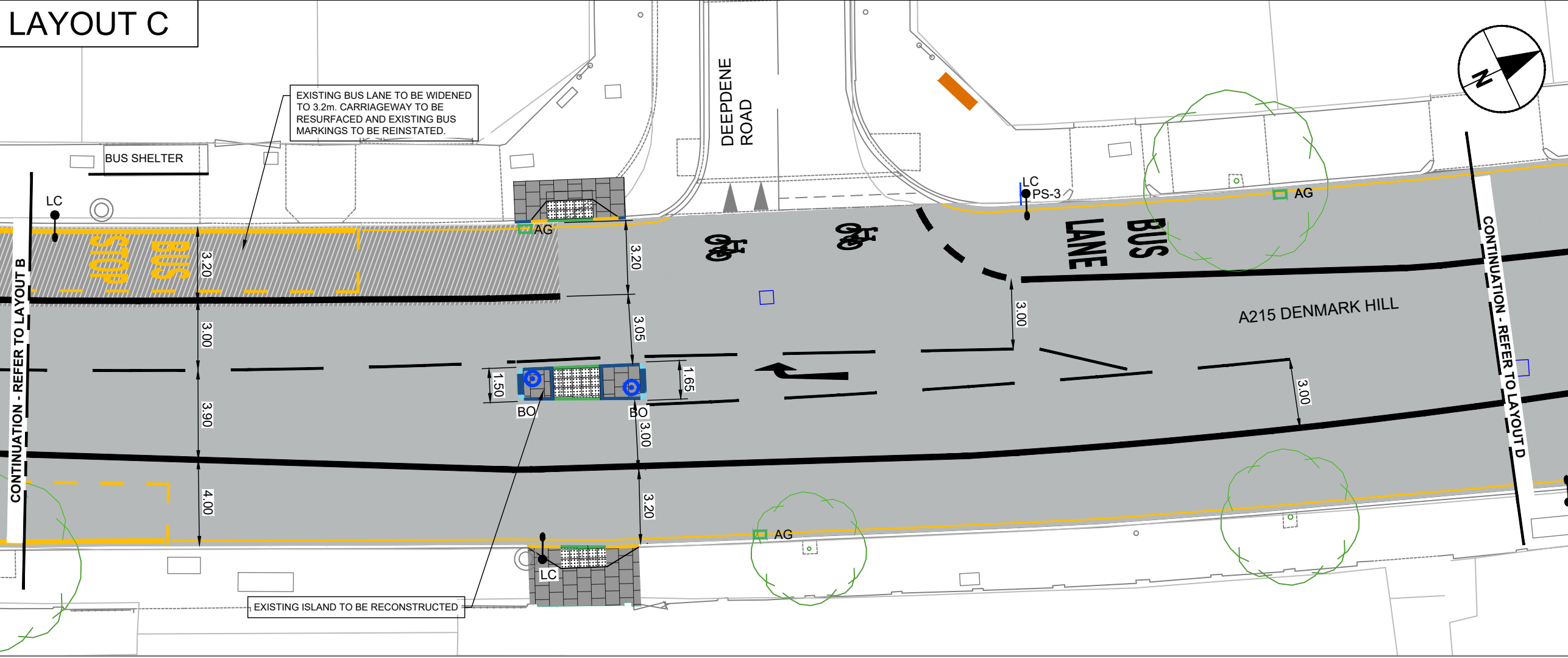

- ### LEGEND
- Carriageway resurfacing (40mm inlay). Refer to Series 1100.
 - Carriageway resurfacing (100mm inlay). Refer to Series 1100.
 - Bound footway construction (precast concrete slabs). Refer to Series 1100
 - Existing utility cover to be adjusted to proposed levels.
 - Existing lamp column to remain
 - Proposed location of sign mounted on existing lamp column. Refer to Series 1200.
 - Existing sign post to remain.
 - Existing gully to be adjusted to proposed levels. Refer to Series 500.
 - Existing bus shelter to remain.
 - Proposed TMP bollard. Refer to Series 1100.
 - Existing bin to remain.
 - Proposed road markings. Refer to Series 1200.
 - Proposed granite full height kerb (150mm wide). Refer to Series 1100.
 - Proposed granite full height kerb (300mm wide). Refer to Series 1100.
 - Proposed granite flush kerb (150mm wide). Refer to Series 1100.
 - Proposed granite transition kerb (150mm wide). Refer to Series 1100.
 - Blister tactile paving construction precast concrete paving flags. Refer to Series 1100.

LAYOUT D

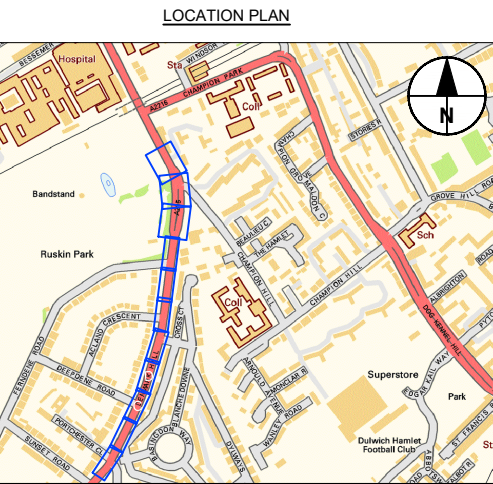
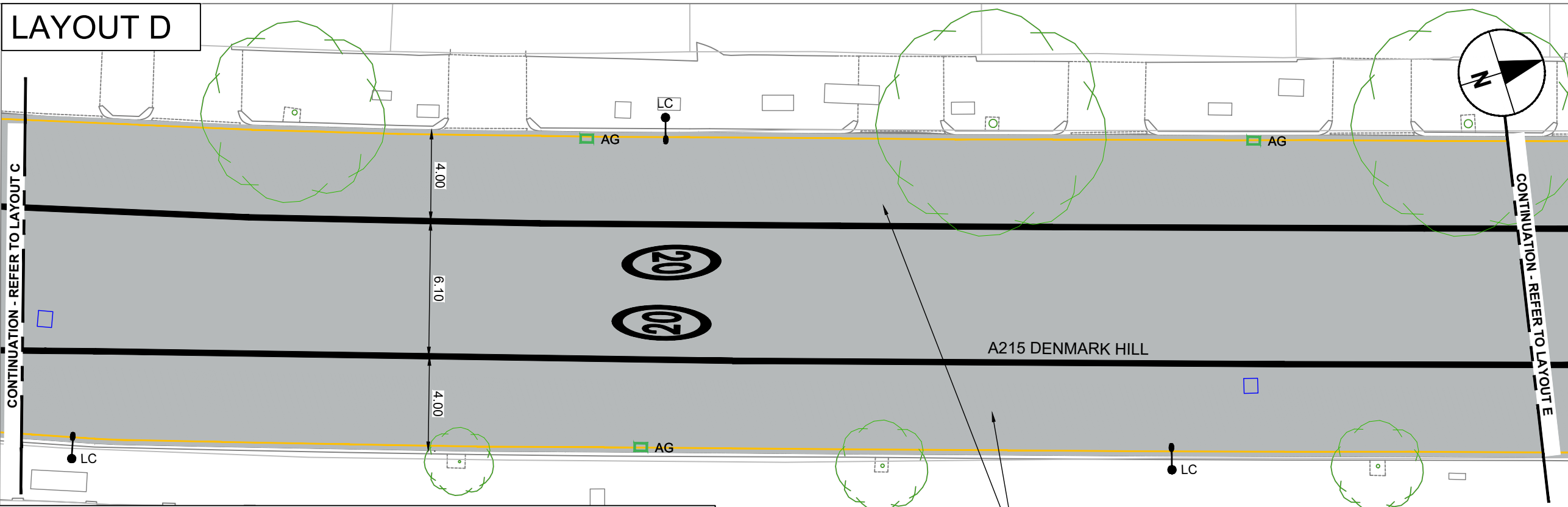

- ### NOTES
1. All dimensions are in metres unless otherwise stated. Do not scale from this drawing.
 2. The information shown on this drawing is based on topographical surveys undertaken by Premier Surveys Ltd in January 2018.
 3. This drawing is to be read in conjunction with all CONWAY AECOM drawings for job ref. 60493383-C0556 as listed on the scheme document issue sheet.
 4. This drawing is to be read in conjunction with LB Southwark Streetscape Design Guidance (SSDM) and all relevant contract clauses.
 5. Traffic management is to be in accordance with Chapter 8 of the Traffic Signs Manual and Safety at Street Works and Road Works.
 6. Contractor to scan for services prior to excavation and refer to utility records.
 7. Contractor to maintain access to all properties and businesses at all times and agree alternative access arrangements with stakeholders.
 8. Tactile paving to be laid with a maximum gradient of 1:12.
 9. Damaged slabs, blocks or kerbs as part of the adjacent construction works to be reinstated to match existing.
 10. Drawing to be printed in A3 for clarity.

- ### LEGEND CONTINUED
- Proposed location of new bench. Refer to series 1100.
 - Existing tree to remain.

EXISTING BUS LANES TO BE WIDENED TO 4m AND CENTRELINE AND HATCHING REMOVED. CARRIAGEWAY TO BE RESURFACED.

DRAFT

REV	DATE	REVISION DESCRIPTION / DETAILS	DRN BY	CHKD BY	APPRVD BY
A	30/03/20	AMENDMENTS FOLLOWING BUILDABILITY REVIEW	TTE	YW	SIA
0	28/02/20	FIRST ISSUE	CM	YW	AGB

PROJECT: DENMARK HILL DETAILED DESIGN

TITLE: SERIES 100: GENERAL ARRANGEMENT SHEET 2 OF 7

CONTRACT NO:	60493382-C0556	DRAWN:	TTE
SCALE:	1 : 200 @ A3	DESIGNED:	TTE
DRAWING NO:	60493382-C0556-100-03	CHECKED:	YW
DATE DRAWN:	MARCH 2020	APPROVED:	SIA
DATE ISSUED:	30 MARCH 2020	REV:	A

LAYOUT E

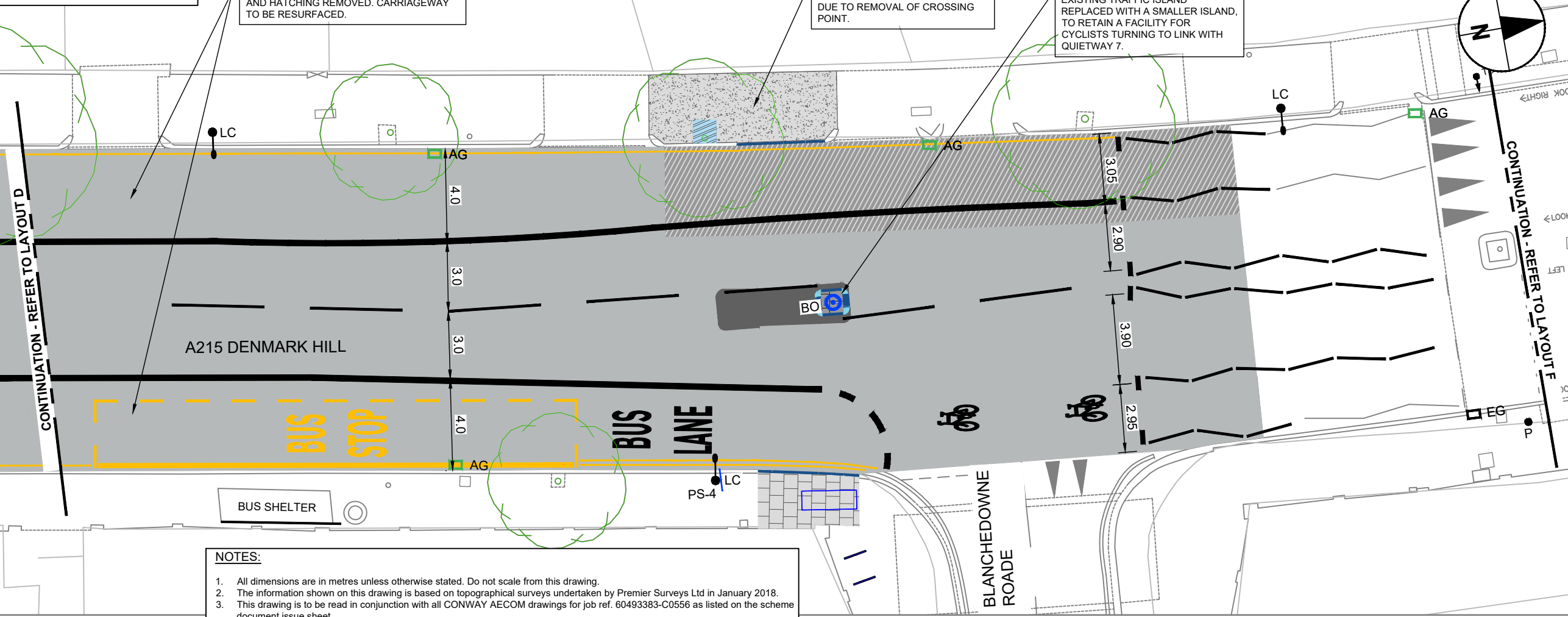

- NOTES:**
- All dimensions are in metres unless otherwise stated. Do not scale from this drawing.
 - The information shown on this drawing is based on topographical surveys undertaken by Premier Surveys Ltd in January 2018.
 - This drawing is to be read in conjunction with all CONWAY AECOM drawings for job ref. 60493383-C0556 as listed on the scheme document issue sheet.
 - This drawing is to be read in conjunction with LB Southwark Streetscape Design Guidance (SSDM) and all relevant contract clauses.
 - Traffic management is to be in accordance with Chapter 8 of the Traffic Signs Manual and Safety at Street Works and Road Works.
 - Contractor to scan for services prior to excavation and refer to utility records.
 - Contractor to maintain access to all properties and businesses at all times and agree alternative access arrangements with stakeholders.
 - Tactile paving to be laid with a maximum gradient of 1:12.
 - Damaged slabs, blocks or kerbs as part of the adjacent construction works to be reinstated to match existing.
 - Drawing to be printed in A3 for clarity.

- LEGEND**
- Carriageway resurfacing (40mm inlay). Refer to Series 1100.
 - Carriageway resurfacing (100mm inlay). Refer to Series 1100.
 - Full carriageway reconstruction. Refer to Series 1100.
 - Unbound footway construction (precast concrete slabs). Refer to Series 1100.
 - Bound footway construction (precast concrete slabs). Refer to Series 1100.
 - Asphalt footway resurfacing. Refer Series 1100.
 - Existing utility cover to be adjusted to proposed levels.
 - Existing lamp column to remain.
 - Proposed location of sign mounted on existing lamp column. Refer to Series 1200.
 - Existing post to remain.
 - Existing gully to remain.
 - Existing gully to be adjusted to proposed levels. Refer to Series 500.
 - Proposed gully. Refer to Series 500.
 - Existing bus shelter to remain.
 - Existing bin to remain.
 - Proposed road markings. Refer to Series 1200.
 - Proposed granite full height kerb (150 mm wide). Refer to Series 1100.
 - Tree pit construction. Refer to Series 1100.

LAYOUT F

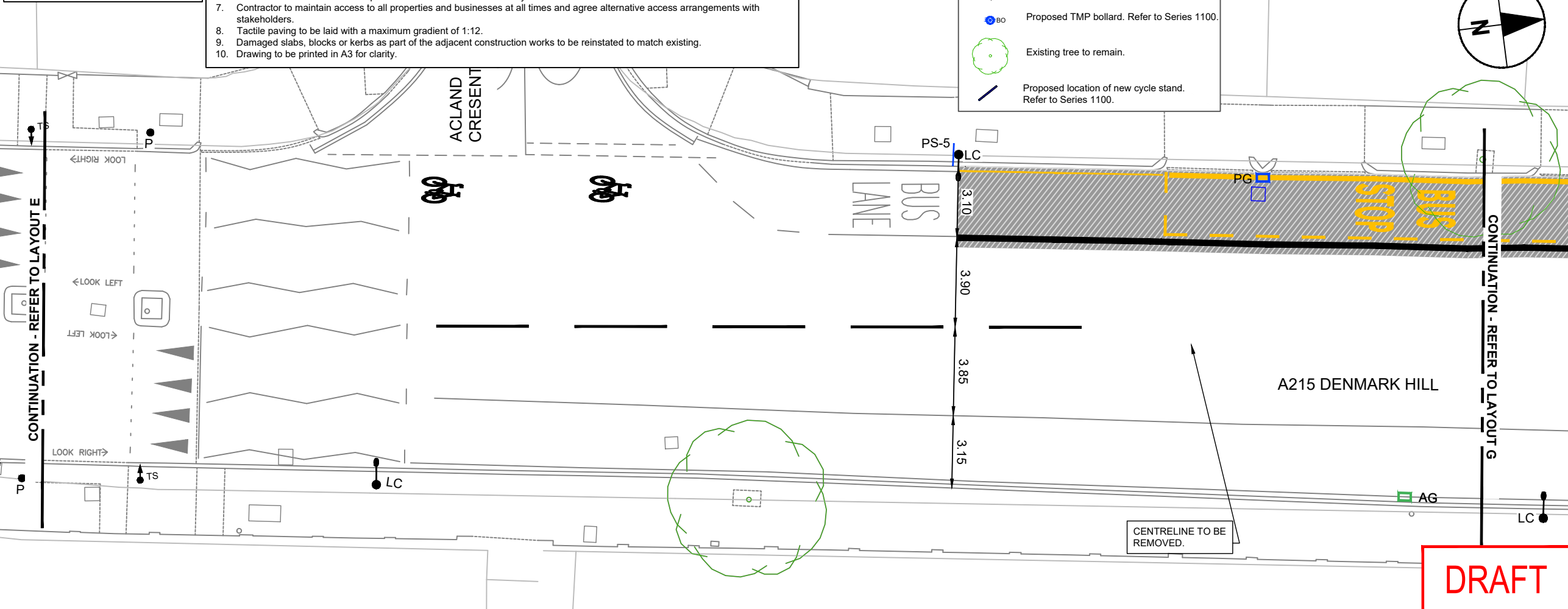

- LEGEND CONTINUED**
- Existing traffic signal to remain.
 - Proposed TMP bollard. Refer to Series 1100.
 - Existing tree to remain.
 - Proposed location of new cycle stand. Refer to Series 1100.

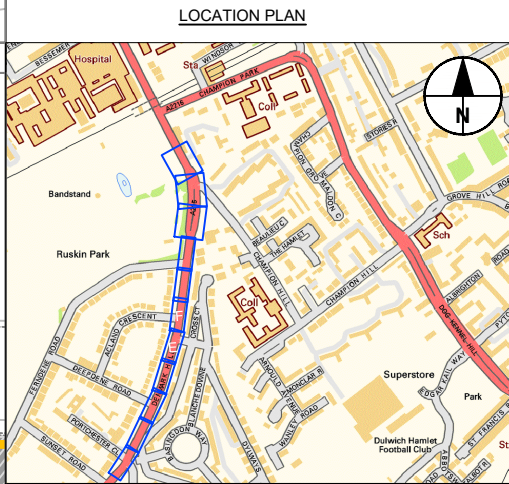

REV	DATE	REVISION DESCRIPTION / DETAILS	DRN BY	CHKD BY	APRVD BY
A	30/03/20	AMENDMENTS FOLLOWING BUILDABILITY REVIEW	TTE	YW	SIA
0	28/02/20	FIRST ISSUE	CM	YW	AGB



PROJECT: DENMARK HILL DETAILED DESIGN

TITLE: SERIES 100: GENERAL ARRANGEMENT SHEET 3 OF 7

CONTRACT NO:	60493382-C0556	DRAWN:	TTE
SCALE:	1 : 200 @ A3	DESIGNED:	TTE
DRAWING NO:	60493382-C0556-100-03	CHECKED:	YW
DATE DRAWN:	MARCH 2020	APPROVED:	SIA
DATE ISSUED:	MARCH 2020	REV:	A

DRAFT

LAYOUT G

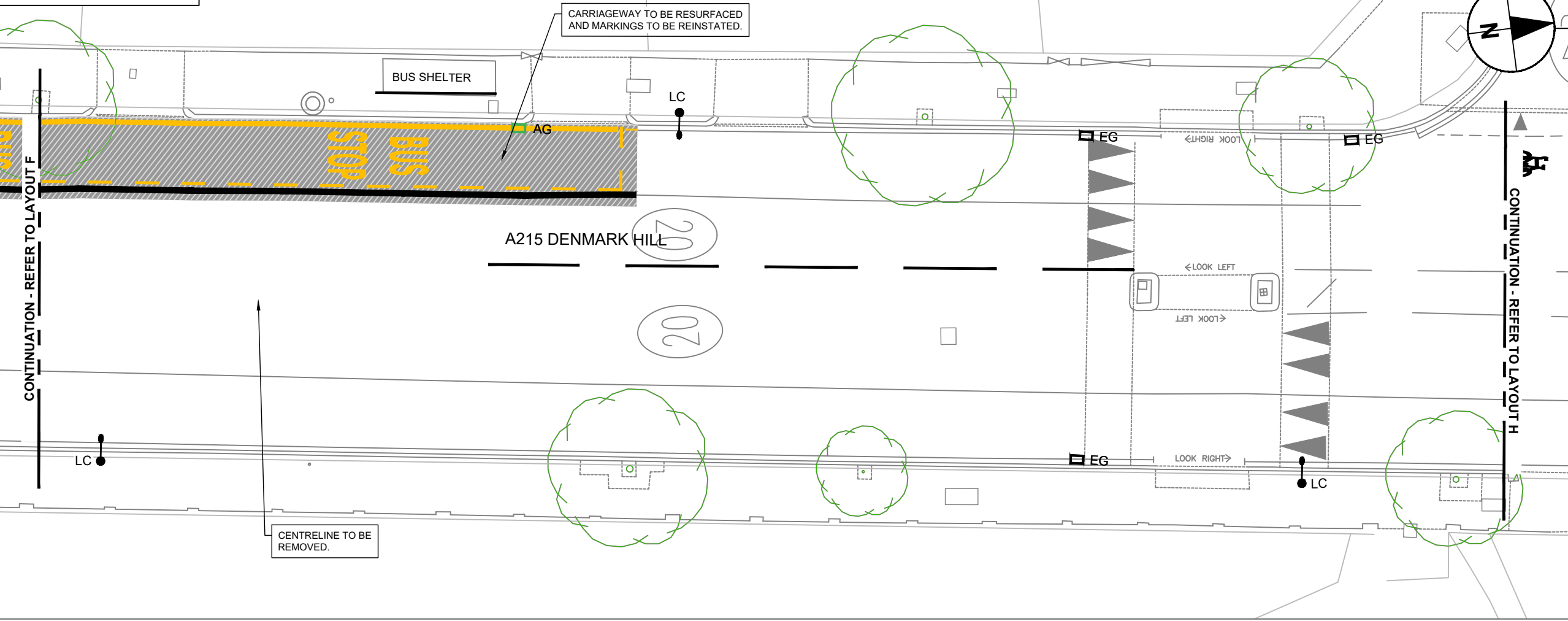

LEGEND

- Carriageway resurfacing (100mm inlay). Refer to Series 1100.
- Existing lamp column to remain
- Proposed location of sign mounted on existing lamp column. Refer to Series 1200.
- Existing gully to remain.
- Existing gully to be adjusted to proposed levels. Refer to Series 500.
- Existing bus shelter to remain.
- Existing bin to remain.
- Proposed road markings. Refer to Series 1200.
- Existing tree to remain.

NOTES

1. All dimensions are in metres unless otherwise stated. Do not scale from this drawing.
2. The information shown on this drawing is based on topographical surveys undertaken by Premier Surveys Ltd in January 2018.
3. This drawing is to be read in conjunction with all CONWAY AECOM drawings for job ref. 60493383-C0556 as listed on the scheme document issue sheet.
4. This drawing is to be read in conjunction with LB Southwark Streetscape Design Guidance (SSDM) and all relevant contract clauses.
5. Traffic management is to be in accordance with Chapter 8 of the Traffic Signs Manual and Safety at Street Works and Road Works.
6. Contractor to scan for services prior to excavation and refer to utility records.
7. Contractor to maintain access to all properties and businesses at all times and agree alternative access arrangements with stakeholders.
8. Tactile paving to be laid with a maximum gradient of 1:12.
9. Damaged slabs, blocks or kerbs as part of the adjacent construction works to be reinstated to match existing.
10. Drawing to be printed in A3 for clarity.

LOCATION PLAN

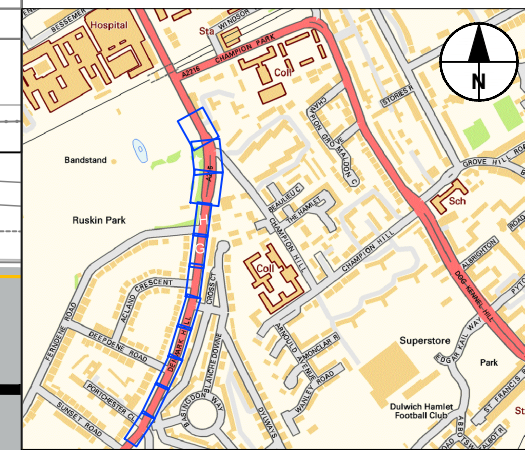

LAYOUT H

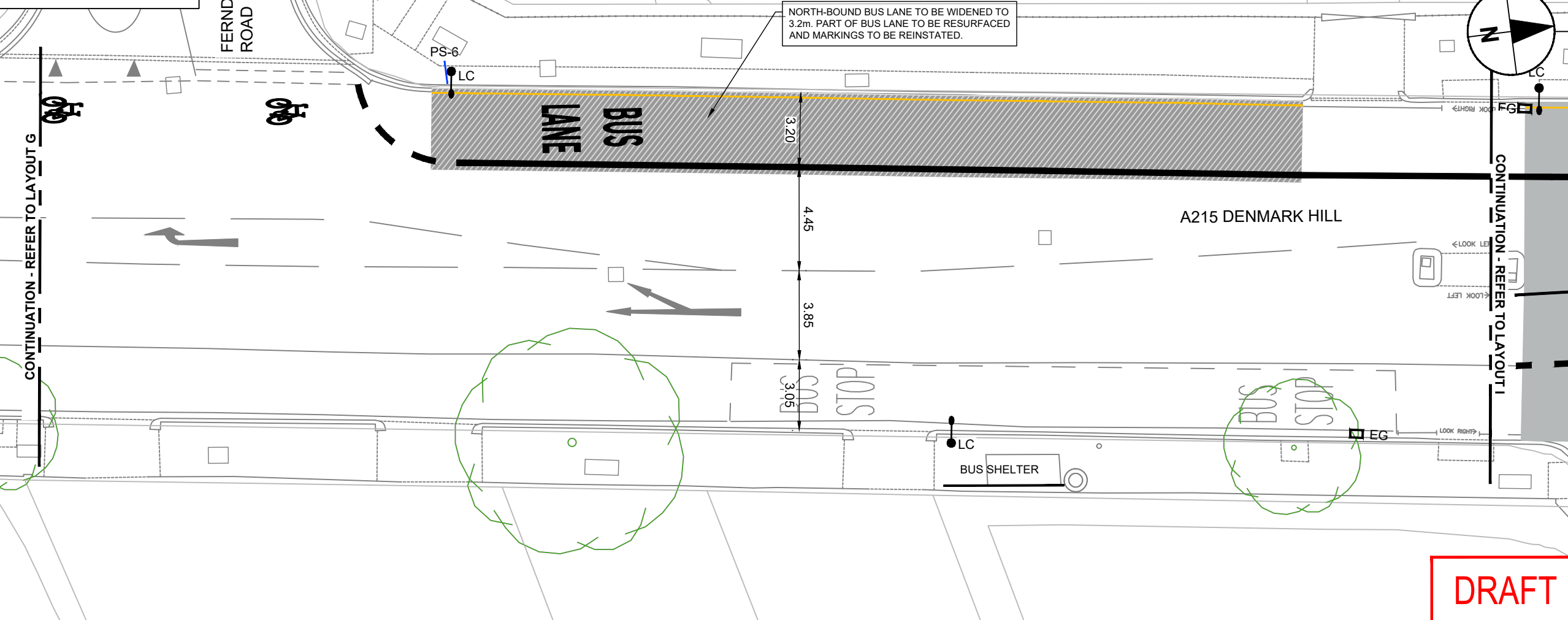

REV	DATE	REVISION DESCRIPTION / DETAILS	DRN BY	CHKD BY	APPRVD BY
A	30/03/20	AMENDMENTS FOLLOWING BUILDABILITY REVIEW	TTE	YW	SIA
0	28/02/20	FIRST ISSUE	CM	YW	AGB



PROJECT: DENMARK HILL DETAILED DESIGN

TITLE: SERIES 100: GENERAL ARRANGEMENT SHEET 4 OF 7







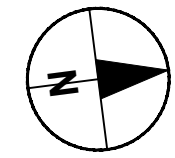





CONTRACT NO:	60493382-C0556	DRAWN:	TTE
SCALE:	1:200 @ A3	CHECKED:	YV
DRAWING NO:	60493382-C0556-100-04	APPROVED:	SIA
DATE DRAWN:	MARCH 2020	DATE ISSUED:	30 MARCH 2020

DRAFT

LAYOUT I



LEGEND

-  Carriageway resurfacing (40mm inlay). Refer to Series 1100.
-  Full carriageway construction. Refer to Series 1100.
-  Set footway construction. Refer to Series 1100.
-  Existing lamp column to remain
-  Proposed lamp column. Liaison with LBS Street Lighting team required.
-  Existing gully to be adjusted to proposed levels. Refer to Series 500.
-  Existing bus shelter to remain.
-  Proposed road markings. Refer to Series 1200.
-  Existing tree to remain.
-  Proposed granite full height kerb (150mm wide). Refer to Series 1100.
-  Proposed gully. Refer to Series 500
-  Existing gully to remain
-  Redundant gully to be converted into inspection chamber. Refer to Series 500.

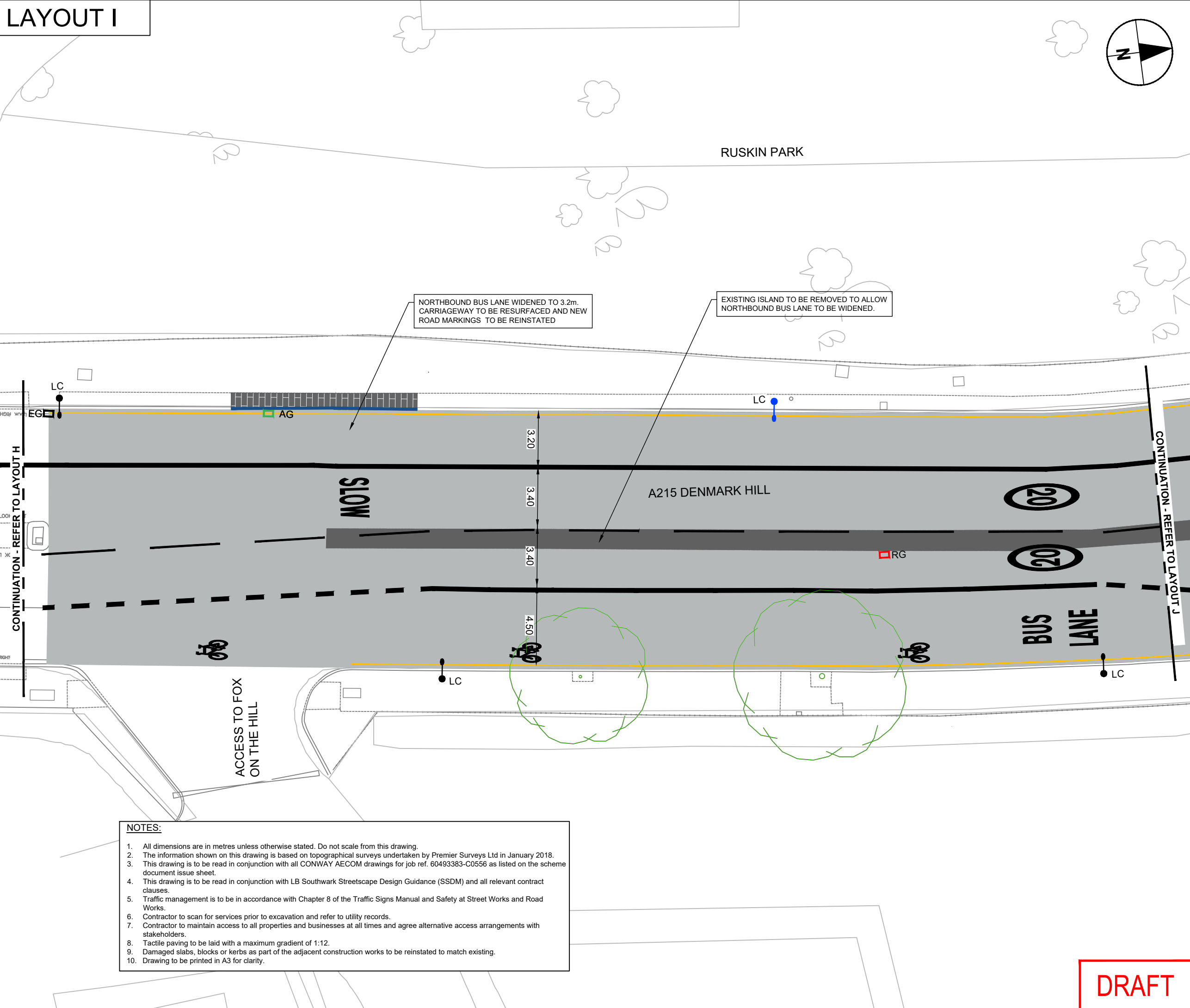

LOCATION PLAN

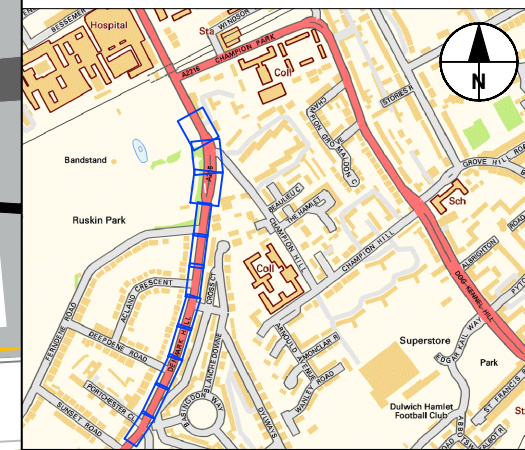

NOTES:

1. All dimensions are in metres unless otherwise stated. Do not scale from this drawing.
2. The information shown on this drawing is based on topographical surveys undertaken by Premier Surveys Ltd in January 2018.
3. This drawing is to be read in conjunction with all CONWAY AECOM drawings for job ref. 60493383-C0556 as listed on the scheme document issue sheet.
4. This drawing is to be read in conjunction with LB Southwark Streetscape Design Guidance (SSDM) and all relevant contract clauses.
5. Traffic management is to be in accordance with Chapter 8 of the Traffic Signs Manual and Safety at Street Works and Road Works.
6. Contractor to scan for services prior to excavation and refer to utility records.
7. Contractor to maintain access to all properties and businesses at all times and agree alternative access arrangements with stakeholders.
8. Tactile paving to be laid with a maximum gradient of 1:12.
9. Damaged slabs, blocks or kerbs as part of the adjacent construction works to be reinstated to match existing.
10. Drawing to be printed in A3 for clarity.

REV	DATE	REVISION DESCRIPTION / DETAILS	DRN BY	CHKD BY	APPRVD BY
A	30/03/20	AMENDMENTS FOLLOWING BUILDABILITY REVIEW	TTE	YW	SIA
0	28/02/20	FIRST ISSUE	CM	YW	AGB



Shaping Southwark's Highways

160 TOOLEY STREET LONDON SE1P 5LX

PROJECT:
DENMARK HILL DETAILED DESIGN

TITLE:
**SERIES 100: GENERAL ARRANGEMENT
SHEET 5 OF 7**

CONTRACT NO:	60493382-C0556	DRAWN	TTE
SCALE:	1 : 200 @ A3	DESIGNED	TTE
DRAWING NO:	60493382-C0556-100-05	CHECKED	YW
DATE DRAWN:	MARCH 2020	APPROVED	SIA
DATE ISSUED:	30 MARCH 2020	REV:	A

DRAFT

LAYOUT J

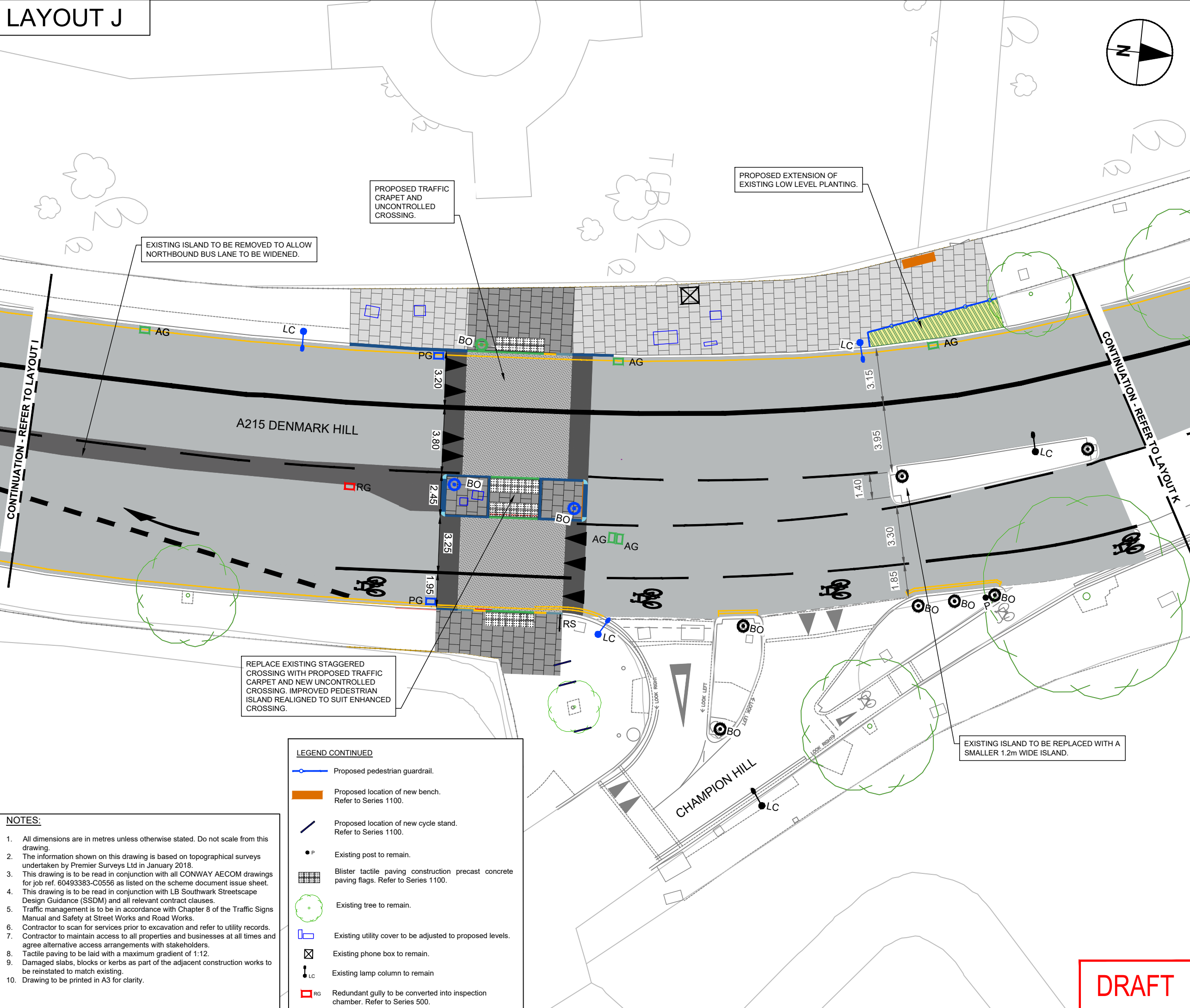
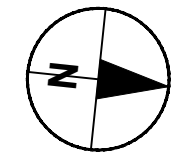

- ### LEGEND
- Carriageway resurfacing (40mm inlay). Refer to Series 1100.
 - Full carriageway construction. Refer to Series 1100.
 - Bound footway construction (precast concrete slabs). Refer to Series 1100.
 - Unbound footway construction (precast concrete slabs). Refer to Series 1100.
 - Proposed location of new low level planting. Refer to Series 1100.
 - Proposed asphalt traffic carpet. Refer to Series 900.
 - LC Proposed lamp column. Liaison with LBS Street Lighting team required.
 - AG Existing gully to be adjusted to proposed levels. Refer to Series 500.
 - PG Proposed gully. Refer to Series 500
 - BO Existing bollard to remain
 - BO Proposed TMP bollard. Refer to Series 1100.
 - BO Proposed Manchester bollard. Refer to Series 1100.
 - Proposed road markings. Refer to Series 1200.
 - Proposed granite full height kerb (150mm wide). Refer to Series 1100.
 - Proposed granite full height kerb (300mm wide). Refer to Series 1100.
 - Proposed granite 60mm upstand kerb (150mm wide). Refer to Series 1100.
 - Proposed granite flush kerb (150mm wide). Refer to Series 1100.
 - Proposed granite transition kerb (150mm wide). Refer to Series 1100.

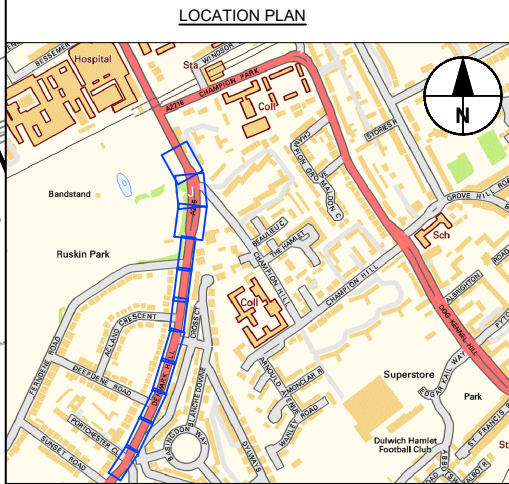

- ### NOTES:
1. All dimensions are in metres unless otherwise stated. Do not scale from this drawing.
 2. The information shown on this drawing is based on topographical surveys undertaken by Premier Surveys Ltd in January 2018.
 3. This drawing is to be read in conjunction with all CONWAY AECOM drawings for job ref. 60493383-C0556 as listed on the scheme document issue sheet.
 4. This drawing is to be read in conjunction with LB Southwark Streetscape Design Guidance (SSDM) and all relevant contract clauses.
 5. Traffic management is to be in accordance with Chapter 8 of the Traffic Signs Manual and Safety at Street Works and Road Works.
 6. Contractor to scan for services prior to excavation and refer to utility records.
 7. Contractor to maintain access to all properties and businesses at all times and agree alternative access arrangements with stakeholders.
 8. Tactile paving to be laid with a maximum gradient of 1:12.
 9. Damaged slabs, blocks or kerbs as part of the adjacent construction works to be reinstated to match existing.
 10. Drawing to be printed in A3 for clarity.

- ### LEGEND CONTINUED
- Proposed pedestrian guardrail.
 - Proposed location of new bench. Refer to Series 1100.
 - Proposed location of new cycle stand. Refer to Series 1100.
 - P Existing post to remain.
 - Blister tactile paving construction precast concrete paving flags. Refer to Series 1100.
 - Existing tree to remain.
 - Existing utility cover to be adjusted to proposed levels.
 - Existing phone box to remain.
 - LC Existing lamp column to remain
 - RG Redundant gully to be converted into inspection chamber. Refer to Series 500.

REV	DATE	REVISION DESCRIPTION / DETAILS	DRN BY	CHKD BY	APRVD BY
A	30/03/20	AMENDMENTS FOLLOWING BUILDABILITY REVIEW	TTE	YW	SIA
0	28/02/20	FIRST ISSUE	CM	YW	AGB



PROJECT: DENMARK HILL DETAILED DESIGN

TITLE: SERIES 100: GENERAL ARRANGEMENT SHEET 6 OF 7

CONTRACT NO:	60493382-C0556	DRAWN:	TTE
SCALE:	1 : 200 @ A3	DESIGNED:	TTE
DRAWING NO:	60493382-C0556-100-06	CHECKED:	YW
DATE DRAWN:	MARCH 2020	APPROVED:	SIA
DATE ISSUED:	30 MARCH 2020	REV:	A

DRAFT

LAYOUT K

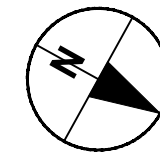

LEGEND

- Carriageway resurfacing (40mm inlay). Refer to Series 1100.
- LC Existing lamp column to remain
- EG Existing gully to remain
- RS Existing road sign to remain
- Proposed road markings. Refer to Series 1200.
- Existing tree to remain.

NOTES

1. All dimensions are in metres unless otherwise stated. Do not scale from this drawing.
2. The information shown on this drawing is based on topographical surveys undertaken by Premier Surveys Ltd in January 2018.
3. This drawing is to be read in conjunction with all CONWAY AECOM drawings for job ref. 60493383-C0556 as listed on the scheme document issue sheet.
4. This drawing is to be read in conjunction with LB Southwark Streetscape Design Guidance (SSDM) and all relevant contract clauses.
5. Traffic management is to be in accordance with Chapter 8 of the Traffic Signs Manual and Safety at Street Works and Road Works.
6. Contractor to scan for services prior to excavation and refer to utility records.
7. Contractor to maintain access to all properties and businesses at all times and agree alternative access arrangements with stakeholders.
8. Tactile paving to be laid with a maximum gradient of 1:12.
9. Damaged slabs, blocks or kerbs as part of the adjacent construction works to be reinstated to match existing.
10. Drawing to be printed in A3 for clarity.

LOCATION PLAN

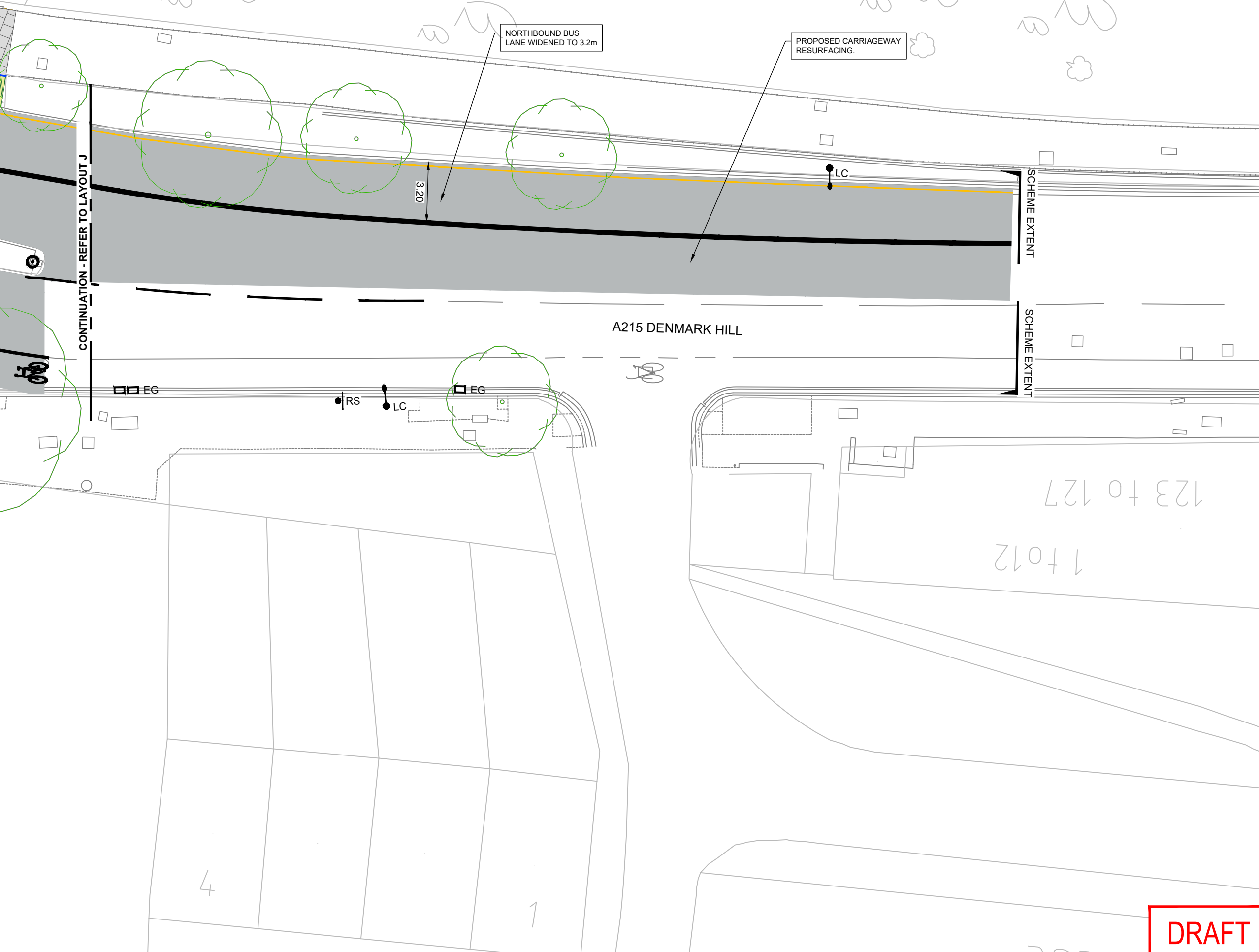
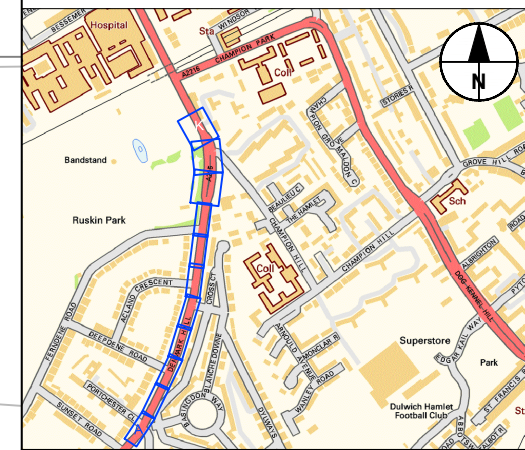

CONTINUATION - REFER TO LAYOUT J

SCHEME EXTENT

SCHEME EXTENT

NORTHBOUND BUS LANE WIDENED TO 3.2m

PROPOSED CARRIAGEWAY RESURFACING.

3.20

A215 DENMARK HILL

123 to 127

1 to 12

4

1

REV	DATE	REVISION DESCRIPTION / DETAILS	DRN BY	CHKD BY	APPRVD BY
A	30/03/20	AMENDMENTS FOLLOWING BUILDABILITY REVIEW	TTE	YW	SIA
0	28/02/20	FIRST ISSUE	CM	YW	AGB



PROJECT: DENMARK HILL DETAILED DESIGN

TITLE: SERIES 100: GENERAL ARRANGEMENT SHEET 7 OF 7

CONTRACT NO:	60493382-C0556	DRAWN	TTE
SCALE:	1 : 200 @ A3	DESIGNED	TTE
DRAWING NO:	60493382-C0556-100-07	CHECKED	YW
DATE DRAWN:	MARCH 2020	APPROVED	SIA
DATE ISSUED:	30 MARCH 2020	REV:	A

DRAFT

C:\USERS\TERESA.TERRON\DESKTOP\50 CAD\28 SHEET\50C0556-SHT-50-100-A.DWG