

LEGEND

	Carriageway resurfacing.
	Bound footway construction (granite paving flags).
	Unbound footway construction (granite paving flags).
	Traffic carpet construction (anti-slip blocks).
	Uncontrolled blister tactile paving construction (granite paving flags).
	Proposed granite full height kerb.
	Proposed granite transition kerb.
	Proposed granite dropped kerb.
	Proposed granite kerb (60-80mm upstand).
	Proposed granite cross kerb.
	Proposed granite transition kerb (150mm wide into 300mm wide).
	Existing gully grating to be adjusted to new carriageway levels and replaced with cycle friendly grate. Refer to series 500.
	Existing utility covers and frames to be adjusted to match new carriageway/footway levels.
	Proposed road markings - Refer to series 1200.
	Tree pit construction.
	Existing lamp column.
	Proposed footway channel. Refer to series 1100.

REV	DATE	DESCRIPTION/DETAILS	DRN	CHKD	APPRVD	BY
B	22/03/19	FINAL DETAILED DESIGN PACKAGE	ACC	AMC	AGB	BT
A	23/10/18	CHANGES FOLLOWING DOW AND BUILDABILITY REVIEW	AM	AMC	AGB	BT
D	01/08/18	FIRST REVISION	ACC	AMC	AGB	BT

LOCATION PLAN

PROJECT: SOUTHWARK SPINE PACKAGE 2
TITLE: SERIES 100 GENERAL ARRANGEMENT SHEET 2 OF 4
CONTRACT NO.: 60493383-C0449
SCALE: 1 : 200 @ A3
PURPOSE: CONSTRUCTION
DRAWING NO.: 60493383-C0449-P2-100-02
DATE DRAWN: JULY 2018
DATE ISSUED: 22 MARCH 2019

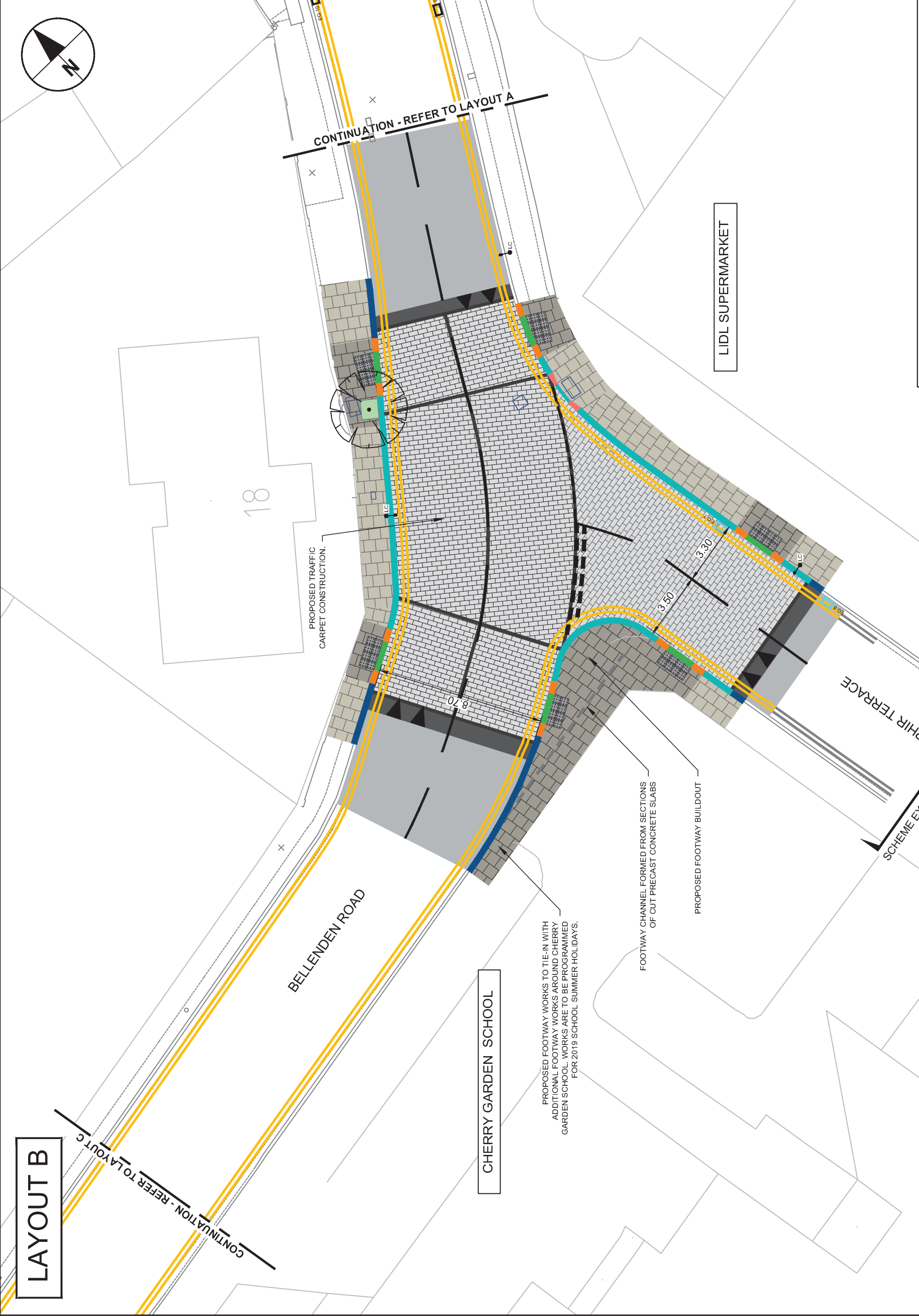

- NOTES**
- All dimensions are in metres unless otherwise stated. Do not scale from this drawing.
 - All items shown in grey are existing and are to remain unless stated otherwise.
 - The information shown on this drawing is based on topographical surveys undertaken by 'David J. Webb Surveys' in November 2015.
 - This drawing is to be read in conjunction with all CONWAY AECOM drawings for job ref. 60493383-C0449-P2 as listed on the scheme drawing contents table.
 - This drawing is to be read in conjunction with LB Southwark Streetscape Design Guidance (SSDM) and all relevant contract clauses.
 - Traffic management is to be in accordance with Chapter 8 of the Traffic Signs Manual and Safety at Street Works and Road Works.
 - Contractor to maintain access to all properties and businesses at all times and agree alternative access arrangements with stakeholders.
 - All road markings and signs are to be in accordance with the Traffic Signs Regulations & General Directions (TSRGD) 2016.
 - All proportions and form of letters, numerals and other characters are to be in accordance with Schedule 17 of the TSRGD 2016.
 - Double yellow lines to be offset a minimum of 250mm from edge of the kerb.

KEY	LEGEND
	Carriageway resurfacing.
	Bound footway construction (granite paving flags).
	Unbound footway construction (granite paving flags).
	Traffic carpet construction (anti-slip blocks).
	Vehicle crossover construction (granite sets precast concrete blocks).
	Uncontrolled blister tactile paving construction (granite paving flags).
	Sinusoidal speed hump construction.
	Proposed granite full height kerb.
	Proposed granite transition kerb.
	Proposed granite dropped kerb.
	Proposed granite kerb (60-80mm upstand).
	Proposed granite flushed kerb.
	Proposed granite cross kerb.
	Existing gully grating to be adjusted to new carriageway levels and replaced with cycle friendly grate. Refer to series 500.
	Existing gully grating to be replaced with cycle friendly grate. Refer to series 500.
	Proposed gully - Refer to series 500.
	Existing utility covers and frames to be adjusted to match new carriageway/footway levels.
	Proposed road markings - Refer to series 1200.
	Existing bollards to be retained.
	Existing lamp column.

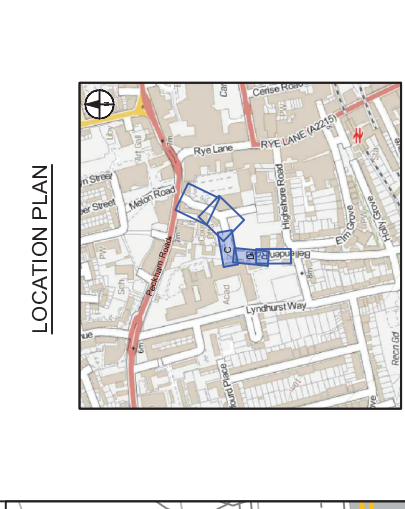
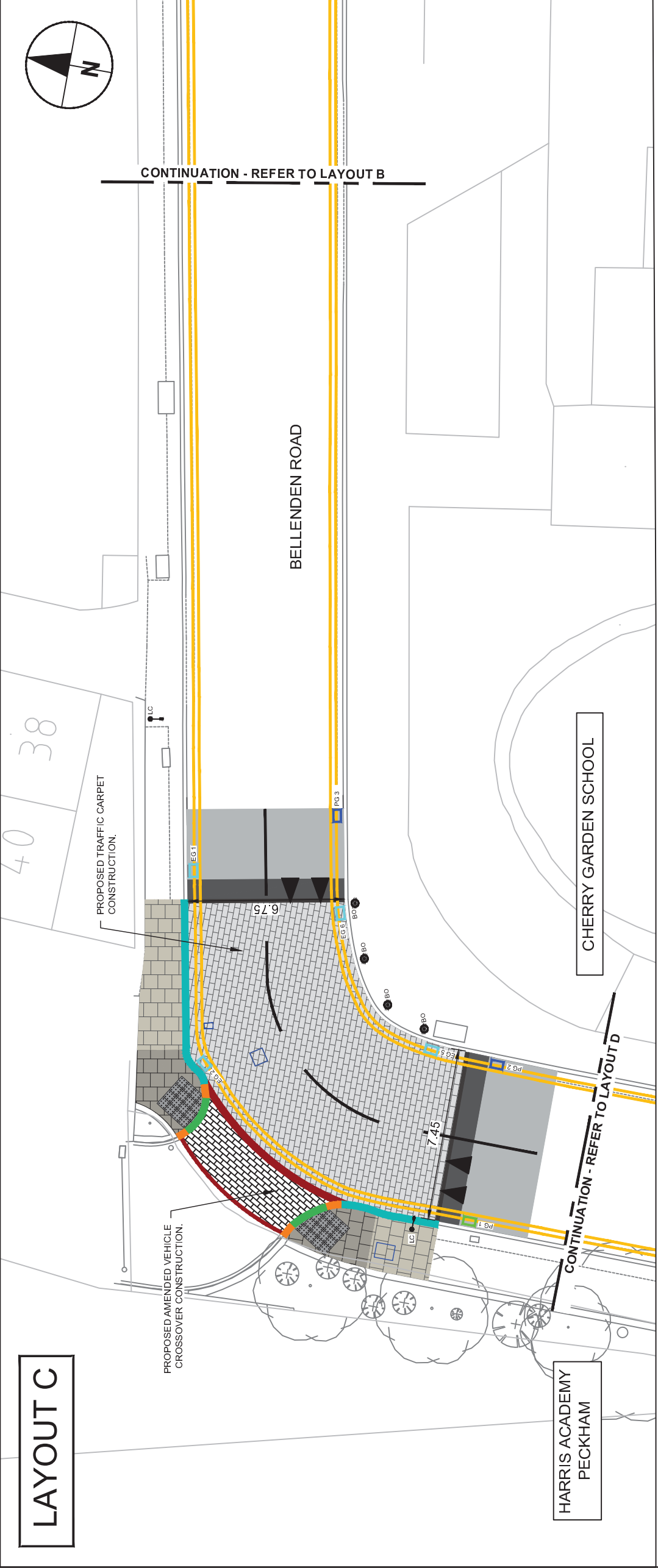

REV	DATE	DESCRIPTION / DETAILS	DRN	CHKD	APPRVD	BY
B	22/03/19	FINAL DETAILED DESIGN PACKAGE	ACC	AMC	AGB	BT
A	23/10/18	CHANGES FOLLOWING DOW AND BUILDABILITY REVIEW	AM	AMC	AGB	BT
0	01/08/18	FIRST REVISION	ACC	AMC	AGB	BT

Shaping Southwark's Highways

 160 TOOLEY STREET LONDON SE1P 5LX

PROJECT:		SOUTHWARK SPINE PACKAGE 2
TITLE:		SERIES 100 GENERAL ARRANGEMENT SHEET 3 OF 4
CONTRACT NO:	60493383-C0449	
SCALE:	1 : 200 @ A3	PURPOSE: CONSTRUCTION
DRAWING NO:	60493383-C0449-P2-100-03	REV: B
DATE DRAWN:	JULY 2018	DATE ISSUED: 22 MARCH 2019

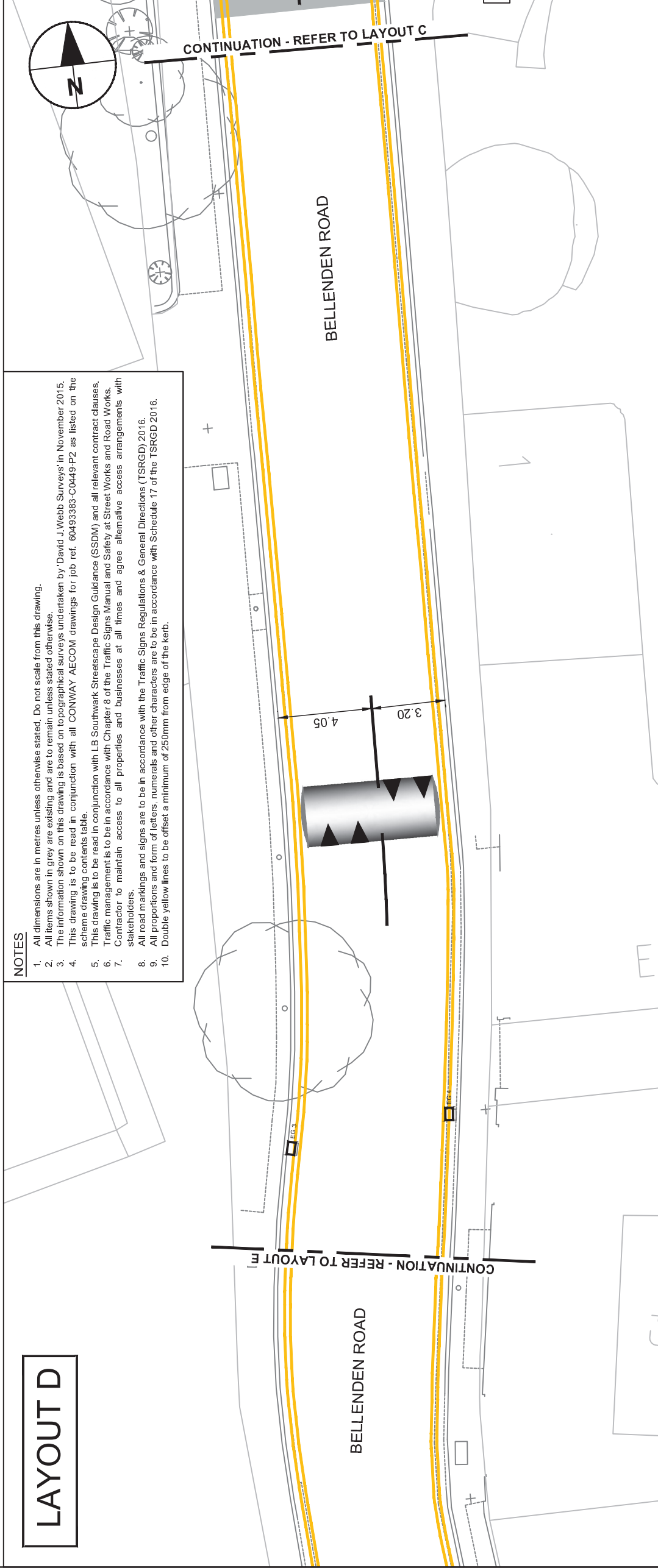

NOTES

- All dimensions are in metres unless otherwise stated. Do not scale from this drawing.
- All items shown in grey are existing and are to remain unless stated otherwise.
- The information shown on this drawing is based on topographical surveys undertaken by David J. Webb Surveys in November 2015.
- This drawing is to be read in conjunction with all CONWAY AECOM drawings for job ref. 60493383-C0449-P2 as listed on the scheme drawing contents table.
- This drawing is to be read in conjunction with LB Southwark Streetscape Design Guidance (SSDM) and all relevant contract clauses.
- Traffic management is to be in accordance with Chapter 8 of the Traffic Signs Manual and Safety at Street Works and Road Works.
- Contractor to maintain access to all properties and businesses at all times and agree alternative access arrangements with stakeholders.
- All road markings and signs are to be in accordance with the Traffic Signs Regulations & General Directions (TSRGD) 2016.
- All proportions and form of letters, numerals and other characters are to be in accordance with Schedule 17 of the TSRGD 2016.
- Double yellow lines to be offset a minimum of 250mm from edge of the kerb.

LEGEND

Existing gully grating to be replaced with cycle friendly grate. Refer to series 500.

Proposed road markings - Refer to series 1200.



- NOTES**
- All dimensions are in metres unless otherwise stated. Do not scale from this drawing.
 - All items shown in grey are existing and are to remain unless stated otherwise.
 - The information shown on this drawing is based on topographical surveys undertaken by 'David J. Webb Surveys' in November 2015.
 - This drawing is to be read in conjunction with all CONWAY AECOM drawings for job ref. 60493383-C0449-P2 as listed on the scheme drawing contents table.
 - This drawing is to be read in conjunction with LB Southwark Streetscape Design Guidance (SSDM) and all relevant contract clauses.
 - Traffic management is to be in accordance with Chapter 8 of the Traffic Signs Manual and Safety at Street Works and Road Works.
 - Contractor to maintain access to all properties and businesses at all times and agree alternative access arrangements with stakeholders.
 - All road markings and signs are to be in accordance with the Traffic Signs Regulations & General Directions (TSRGD) 2016.
 - All proportions and form of letters, numerals and other characters are to be in accordance with Schedule 17 of the TSRGD 2016.
 - Double yellow lines to be offset a minimum of 250mm from edge of the kerb.

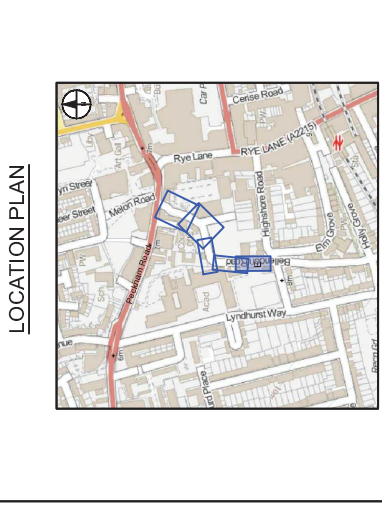

REV	DATE	DRN	CHKD	APPRVD	BY																								
B	22/03/19																												
A	23/10/18																												
D	01/08/18																												
<table border="1"> <tr> <td>FINAL DETAILED DESIGN PACKAGE</td> <td>ACC</td> <td>AMC</td> <td>AGB</td> <td>AGB</td> <td>AGB</td> </tr> <tr> <td>CHANGES FOLLOWING DOW AND BUILDABILITY REVIEW</td> <td>AM</td> <td>AMC</td> <td>AGB</td> <td>AGB</td> <td>AGB</td> </tr> <tr> <td>FIRST REVISION</td> <td>ACC</td> <td>AMC</td> <td>AGB</td> <td>AGB</td> <td>AGB</td> </tr> <tr> <td>REVISION DESCRIPTION / DETAILS</td> <td>DRN</td> <td>CHKD</td> <td>APPRVD</td> <td>BY</td> <td>BY</td> </tr> </table>						FINAL DETAILED DESIGN PACKAGE	ACC	AMC	AGB	AGB	AGB	CHANGES FOLLOWING DOW AND BUILDABILITY REVIEW	AM	AMC	AGB	AGB	AGB	FIRST REVISION	ACC	AMC	AGB	AGB	AGB	REVISION DESCRIPTION / DETAILS	DRN	CHKD	APPRVD	BY	BY
FINAL DETAILED DESIGN PACKAGE	ACC	AMC	AGB	AGB	AGB																								
CHANGES FOLLOWING DOW AND BUILDABILITY REVIEW	AM	AMC	AGB	AGB	AGB																								
FIRST REVISION	ACC	AMC	AGB	AGB	AGB																								
REVISION DESCRIPTION / DETAILS	DRN	CHKD	APPRVD	BY	BY																								

CONWAY ACCOM
 Shaping Southwark's Highways
 160 TOOLEY STREET LONDON SE1P 5LX

PROJECT: SOUTHWARK SPINE PACKAGE 2

TITLE: SERIES 100 GENERAL ARRANGEMENT SHEET 4 OF 4

CONTRACT NO:	60493383-C0449	DRAWN:	ACC
SCALE:	1 : 200 @ A3	CHECKED:	ACC
PURPOSE:	CONSTRUCTION	APPROVED:	AGB
DRAWING NO:	60493383-C0449-P2-100-04	REV:	B
DATE DRAWN:	JULY 2018	DATE ISSUED:	22 MARCH 2019

LEFT INTENTIONALLY BLANK