

### Ground to 4th Floor

- KEY:
- Boundary Line
  - ┌ Steel Hanger
  - Sheer Wall & Jacket
  - New Floor Area

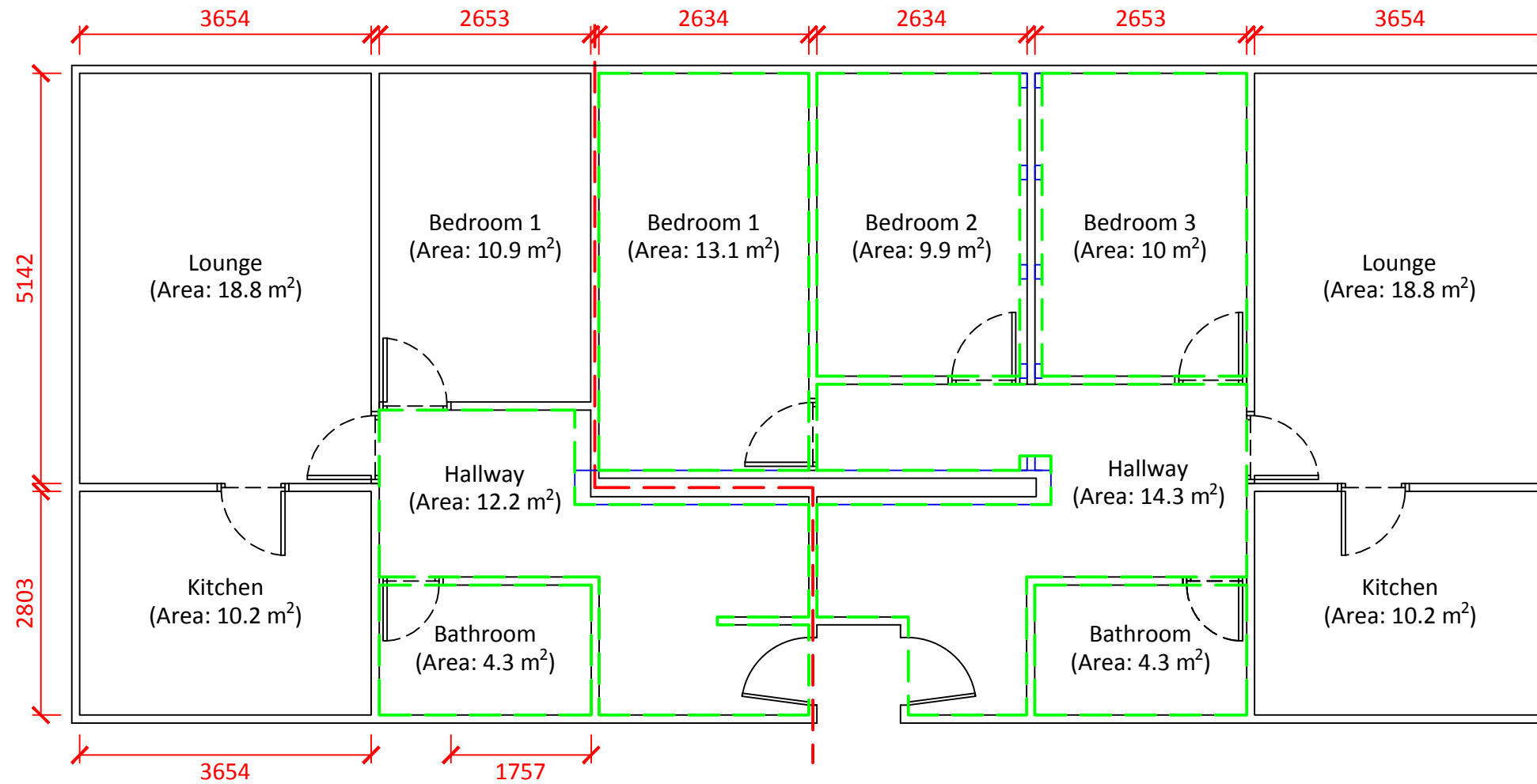

**One Bedroom Flat:  
(Area: 56.4 m<sup>2</sup>)**

**Three Bedroom Flat:  
(Area: 80.6 m<sup>2</sup>)**



Client  
**London Borough of Southwark Council**  
 Project  
**Ledbury Refurbishment Project**  
 Title  
**Bromyard House Indicative Proposed Floor Plan**

Scale	Date	Drawn By	Checked By	Project No:	Drawing No:	Revision
NTS	28/11/19	DyS	CH	K180809	BS005	

St Johns House 1A Knoll Rise Orpington Kent BR6 0JX  
 01689 888222 orpington@calfordseaden.com  
 calfordseaden LLP is a Limited Liability Partnership Registered in England & Wales number OC315838

ORPINGTON | LONDON | BIRMINGHAM | CAMBRIDGE | SOUTHEND-ON-SEA | WINCHESTER

[calfordseaden.com](http://calfordseaden.com)

REV	DESCRIPTION	DATE	INIT	CHKD