

Ground to 4th Floor

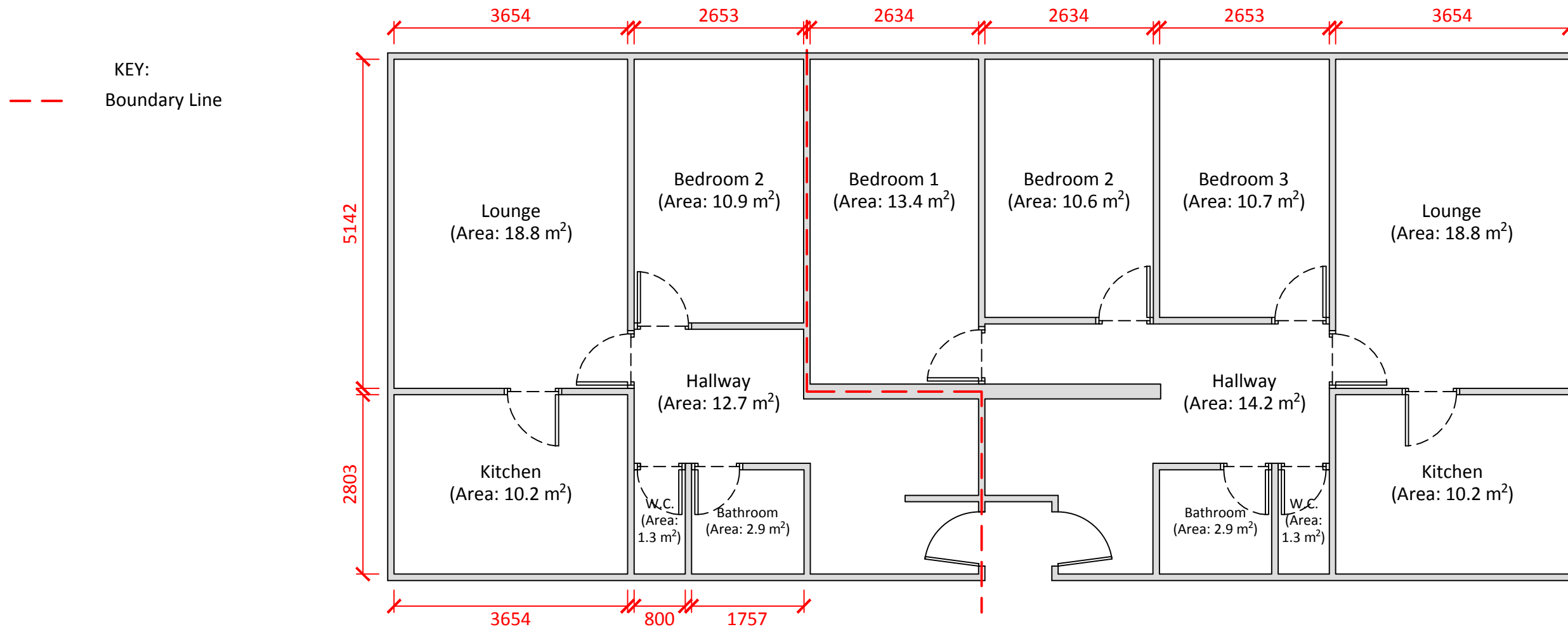

**One Bedroom Flat:
(Area: 56.8 m²)**

**Three Bedroom Flat:
(Area: 82.1 m²)**



Client
London Borough of Southwark Council
Project
Ledbury Refurbishment Project
Title
Bromyard House Indicative Existing Floor Plan

Scale: NTS Date: 28/11/19 Drawn By: DyS Checked By: CH Project No: K180809 Drawing No: BS001 Revision

St Johns House 1A Knoll Rise Orpington Kent BR6 0JX
01689 888222 orpington@calfordseaden.com
calfordseaden LLP is a Limited Liability Partnership Registered in England & Wales number OC315838

ORPINGTON | LONDON | BIRMINGHAM | CAMBRIDGE | SOUTHEND-ON-SEA | WINCHESTER

calfordseaden.com

REV	DESCRIPTION	DATE	INIT	CHKD