

Public notice

Manor Place area improvements

*The London Borough of Southwark (Loading bays) (No. *) Traffic Order 201**

*The London Borough of Southwark (Parking places) (CPZ 'E') (No. *) Order 201**

*The London Borough of Southwark (Parking places) (CPZ 'J') (No. *) Order 201**

*The London Borough of Southwark (Waiting and loading restrictions) (Amendment No. *) Order 201**

1. Southwark Council hereby GIVES NOTICE that it proposes to make the above orders under powers of the Road Traffic Regulation Act 1984¹, as amended.
2. The effect of the orders would be, in:-
 - (a) MANOR PLACE the south-east side within CPZ 'E', to remove two 'permit holders only' parking places and one pay parking place (total approx. 105 metres in length) outside Nos. 17 to 21 and 33 Manor Place replacing the places with 'at any time' (double yellow lines) waiting restrictions;
 - (b) OCCUPATION ROAD the south-west side, to introduce a new loading only bay which would operate at any time (max stay 40 mins, and no return within 2 hours) and to amend the existing 'at any time' waiting restrictions (double yellow lines) to accommodate the new loading bay; and
 - (c) PENROSE STREET the north-west side within CPZ 'J', to remove an underused 'doctor's only' parking place and replacing the place with 'at any time' (double yellow lines) waiting restrictions.
3. Southwark Council hereby GIVES FURTHER NOTICE under sections 90A to 90I of the Highways Act 1980² and in accordance with the provisions of the Highways (Traffic calming) Regulations 1999³, propose to construct speed tables of flat-top construction having a maximum height of 100 millimetres and covering the entire width of the carriageway, at the following location:- OCCUPATION ROAD from the south-eastern kerb-line of Manor Place extending south-eastward for a distance of 4.5 metres.
4. For more information contact the council's Highways – Highway Development team Highways@southwark.gov.uk .
5. Copies of this notice, the proposed orders, a statement of the council's reasons for making the orders, and a plan of the proposals may be found online at www.southwark.gov.uk/trafficorders, paper copies may be obtained from or viewed at Highways, Environment and Leisure, 3rd floor hub 2, 160 Tooley Street, London SE1 2QH. Email traffic.orders@southwark.gov.uk (or call 020 7525 3497) for details.
6. Anyone wishing to object to or make any other representations regarding the proposal, may use the form labelled '*Parking - Road traffic and highway schemes - responding to statutory consultation notices*' at www.southwark.gov.uk/statutoryconsultationnotices or send a statement in writing to: the Traffic Orders Officer, Highways, Southwark Council, Environment and Leisure, P.O. Box 64529, London SE1P 5LX or by e-mail to traffic.orders@southwark.gov.uk quoting reference '*TMO1920-019 Manor Place*' by 13 September 2019. Please note that if you wish to object to this proposal you must state the grounds on which your objection is made.
7. When making an objection or representation, please be aware that this may be communicated to other people who may be affected. Information provided in response to this consultation, including in some circumstances personal information, may also be subject to publication or disclosure under the requirements of current access to information legislation.

Dated 22 August 2019

Nicky Costin - Parking and Network Management Business Unit Manager, Regulatory Services

¹ 1984 c.27

² 1980 c.66

³ S.I. 1999/1026

Statement of reasons

Manor Place area improvements

*The London Borough of Southwark (Loading bays) (No. *) Traffic Order 201**

*The London Borough of Southwark (Parking places) (CPZ 'E') (No. *) Order 201**

*The London Borough of Southwark (Parking places) (CPZ 'J') (No. *) Order 201**

*The London Borough of Southwark (Waiting and loading restrictions) (Amendment No. *) Order 201**

These implementations will make improvements to the area surrounding new developments in Newington ward, in the London Borough of Southwark.

The redevelopment of Manor Place Depot was approved on 31/03/2016 under planning permission no 15/AP/1062. Redevelopment to provide 270 residential units within new buildings ranging from 2 to 7 storeys, a refurbished 33 Manor Place and 17-21 Manor Place and within 9 refurbished railway viaduct arches within the refurbished Pool House and Wash House with associated works including disabled car parking spaces, cycle parking, landscaping and access improvements.

Highway works include the installation of a new loading bay on Occupation Road to accommodate servicing and deliveries to the site. The loading only bay will be 7 metres in length, for use of vehicles loading or unloading only, operating at any time (maximum stay 40 mins and no return within 2 hours).

It will also be necessary to remove some permit holder and pay parking places on Manor Place, within CPZ 'E' and one doctor's parking place on Penrose Street, in CPZ 'J'; and amend existing double yellow lines ('at any time' waiting restrictions) in the area surrounding the new development.

Dated 22 August 2019

For more information on the design of the scheme, please contact:-

Network Development

Highways

Highways@southwark.gov.uk

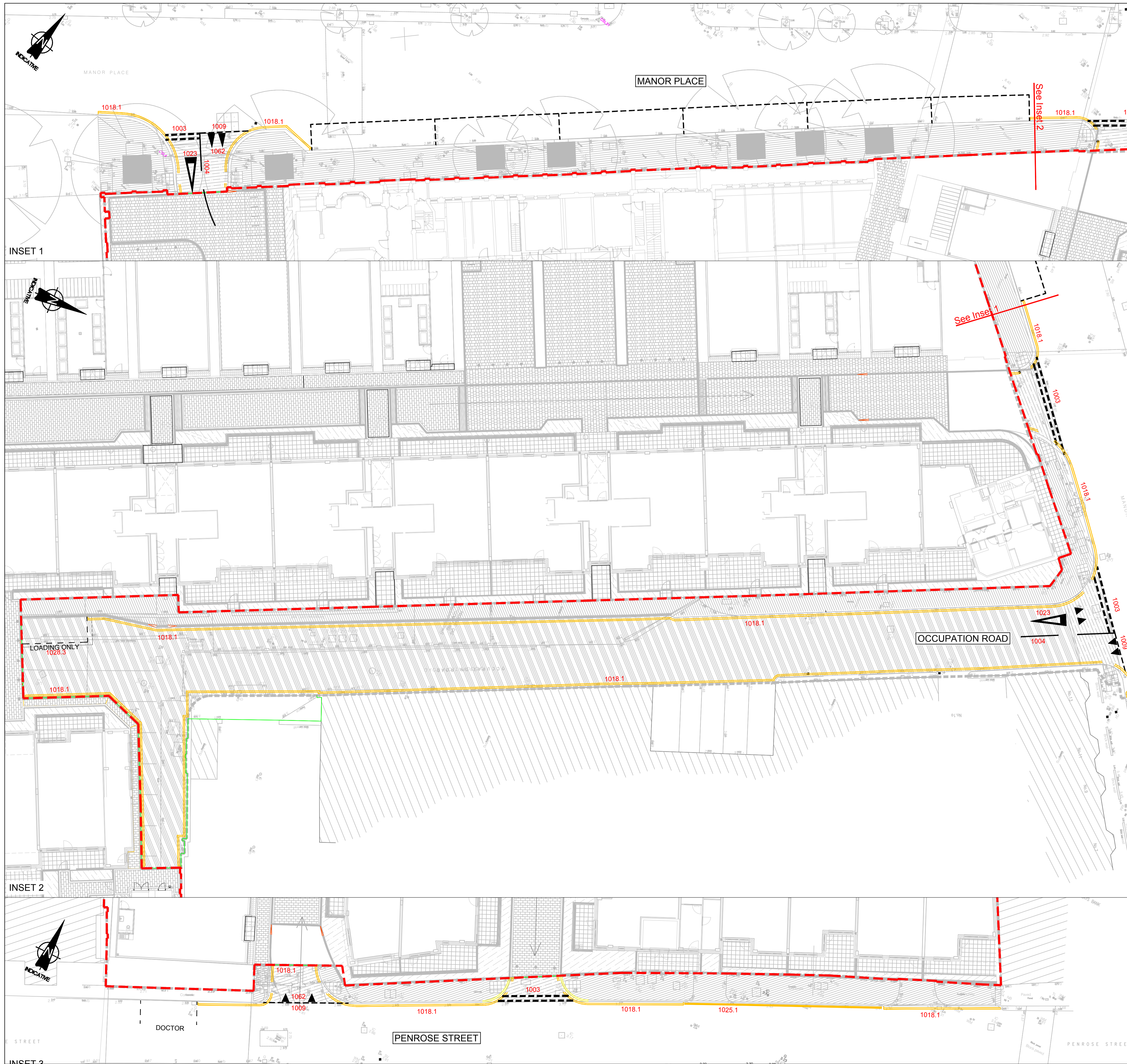

NOTES

1. THIS DRAWING TO BE READ IN CONJUNCTION WITH ALL RELEVANT ENGINEERS DRAWINGS.
2. ALL DETAILS TO BE CHECKED ON SITE BY THE SUPERVISOR.
3. THE CONTRACTOR IS TO CHECK ALL SETTING OUT INFORMATION PRIOR TO COMMENCEMENT OF WORKS. ANY DISCREPANCIES TO BE REPORTED TO THE SUPERVISOR IMMEDIATELY.
4. ALL DIMENSIONS ARE IN METRES UNLESS OTHERWISE STATED.
5. FOR STREET LIGHTING DESIGN REFER TO LBS DESIGN INFO.

KEY

- - - Site Boundary
- Proposed Road Markings and TSRGD Reference
- Existing Lighting Column to be retained unless otherwise stated by L.B Southwark.
- Lighting Column to be relocated as specified by L.B Southwark



AECOM House
63-77 Victoria Street
St Albans, Herts
AL1 3ER
+44 (0)1727 535000
www.aecom.com

PROJECT

**Manor Place Depot,
Southwark**

CLIENT



LOCATION PLAN

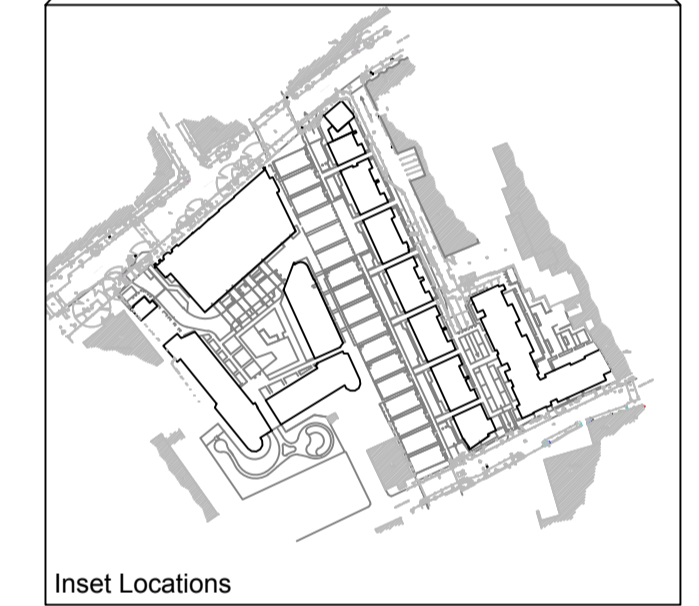
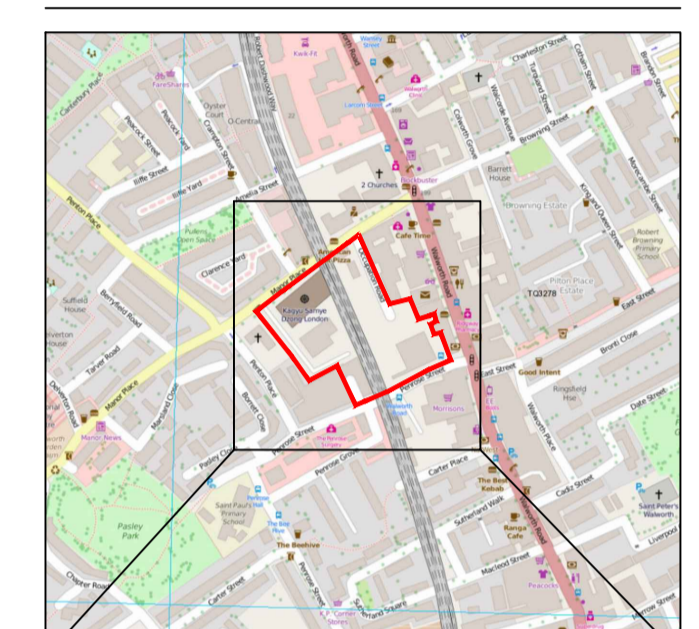

Reproduced from Ordnance Survey digital map data
© Crown copyright 2017. All rights reserved.
Licence number 0100031673

ISSUE/REVISION

NO	DATE	DESIGN	DRAWN	CHK'D	APP'D
E	03/11/17	DJ	DJ	JOM	YS
E	21/09/17	DJ	DJ	JOM	YS
D	31/08/17	MM	RK	JOM	YS
C	03/08/17	MM	MM	RK	YS
B	04/05/17	MM	MM	RK	YS
A	16/09/16	MM	FM	YS	SP
-	13/08/15	MM	FM	YS	SP
I/R	DATE	DESIGN	DRAWN	CHK'D	APP'D

PROJECT NUMBER

60326905

SHEET TITLE

SIGNING AND LINING

SHEET 1 OF 1, SCALE 1:500 @ A1

SHEET NUMBER

60326905-SHT-C-1201-E

APPROVAL

This drawing has been prepared for the use of AECOM's client. It may not be used, modified, reproduced or relied upon by third parties, except as agreed by AECOM or as required by law. AECOM accepts no responsibility, and denies any liability, whatsoever, to any party that uses or relies on this drawing without AECOM's express written consent. Do not scale this document. All measurements must be obtained from the stated dimensions.



THE COUNCIL OF THE LONDON BOROUGH OF SOUTHWARK

TRAFFIC MANAGEMENT ORDER

201* No. ***

The London Borough of Southwark (Parking places) (CPZ 'E') (No. *) Order 201*

Made: xx xxxxxx 201*

Coming into force: xx xxxxxx 201*

The council of the London Borough of Southwark, after consulting the Commissioner of Police of the Metropolis, in exercise of the powers conferred by sections 45, 46, 49 and 124 of and Part IV of Schedule 9 to the Road Traffic Regulation Act 1984¹, as amended, and of all other powers thereunto enabling, hereby make the following Order:

Citation and commencement

- 1.1 This Order may be cited as The London Borough of Southwark (Parking places) (CPZ 'E') (No. *) Order 201* and shall come into force on xx xxxxxx 201*.

Interpretation

- 2.1 In this Order:-

"council" means the council of the London Borough of Southwark;

"enactment" means any enactment, whether public general or local, and includes any order, bye-law, rule, regulation, scheme or other instrument having effect by virtue of an enactment; and

"the Order of 2010" means the London Borough of Southwark (Parking places) (CPZ 'E') Order 2010².

- 2.2 Any reference in this Order to any enactment shall be construed as a reference to that enactment as amended, applied, consolidated, re-enacted by or as having effect by virtue of any subsequent enactment.
- 2.3 Unless the context otherwise requires, any expression used in this Order which is also used in the Order of 2010 shall have the same meaning as in that Order.

¹ 1984 c.27

² LBS 2010/065

Revocation

- 3.1 Without prejudice to the validity of anything done or to any liability incurred in respect of any act or omission before the coming into force of this Order, the designation by: -
- (a) the Order of 2010 of the parking place numbered 115 in Schedule 1, and the parking place numbered 19 in Schedule 3 therein are hereby revoked; and
 - (b) the London Borough of Southwark (Parking places) (CPZ 'E') (No. 5) Order 2011³ of the parking places numbered 180 in Schedule 2 therein is hereby revoked.

Dated this xxxxxxxx day of xxxxxxx 201*

[signature here]

NICKY COSTIN
Parking and Network Management Business Unit Manager
Regulatory Services

³ LBS 2011/100

EXPLANATORY NOTE

(This note is not part of the Order)

This Order revokes two permit holders' parking places and one pay parking place in Manor Place, in the London Borough of Southwark.



THE COUNCIL OF THE LONDON BOROUGH OF SOUTHWARK

TRAFFIC MANAGEMENT ORDER

201* No. ***

The London Borough of Southwark (Parking places) (CPZ 'J') (No. *) Order 201*

Made: xx xxxxxx 201*

Coming into force: xx xxxxxx 201*

The council of the London Borough of Southwark, after consulting the Commissioner of Police of the Metropolis, in exercise of the powers conferred by sections 45, 46, 49 and 124 of and Part IV of Schedule 9 to the Road Traffic Regulation Act 1984¹, as amended, and of all other powers thereunto enabling, hereby make the following Order:

Citation and commencement

- 1.1 This Order may be cited as The London Borough of Southwark (Parking places) (CPZ 'J') (No. *) Order 201* and shall come into force on xx xxxxxx 201*.

Interpretation

- 2.1 In this Order:-

"council" means the council of the London Borough of Southwark;

"enactment" means any enactment, whether public general or local, and includes any order, bye-law, rule, regulation, scheme or other instrument having effect by virtue of an enactment; and

"the Order of 2011" means The London Borough of Southwark (Parking places) (CPZ 'J') (No. 1) Order 2011².

- 2.2 Any reference in this Order to any enactment shall be construed as a reference to that enactment as amended, applied, consolidated, re-enacted by or as having effect by virtue of any subsequent enactment.
- 2.3 Unless the context otherwise requires, any expression used in this Order which is also used in the Order of 2011 shall have the same meaning as in that Order.

¹ 1984 c.27

² LBS 2011/058

Revocation

- 3.1 Without prejudice to the validity of anything done or to any liability incurred in respect of any act or omission before the coming into force of this Order, the designation by the London Borough of Southwark (Parking places) (CPZ 'J') (No. 3) Order 2013³ of the parking place numbered 1 in Schedule 2 therein is hereby revoked.

Dated this xxxxxxxx day of xxxxxxx 201*

[signature here]

NICKY COSTIN
Parking and Network Management Business Unit Manager
Regulatory Services

³ LBS 2013/055

EXPLANATORY NOTE

(This note is not part of the Order)

This Order revokes a doctors' parking place in Penrose Street, in the London Borough of Southwark.



THE COUNCIL OF THE LONDON BOROUGH OF SOUTHWARK

TRAFFIC MANAGEMENT ORDER

201* No. 0xx

The London Borough of Southwark (Loading bays) (No. *) Order 201*

Made: xx xxxxxx 201*

Coming into force: xx xxxxxx 201*

The council of the London Borough of Southwark, after consulting the Commissioner of Police of the Metropolis, in exercise of the powers conferred by sections 6 and 124 of and Part IV of Schedule 9 to the Road Traffic Regulation Act 1984^a, as amended, and of all other powers thereunto enabling, hereby make the following Order:

Citation and commencement

- 1.1 This Order may be cited as The London Borough of Southwark (Loading bays) (No. *) Order 201* and shall come into force on xx xxxxxx 201*.

Interpretation

- 2.1 In this Order:-

"council" means the council of the London Borough of Southwark;

"enactment" means any enactment, whether public general or local, and includes any order, bye-law, rule, regulation, scheme or other instrument having effect by virtue of an enactment; and

"the Order of 2016" means the London Borough of Southwark (Loading bays) (No. 1) Order 2016^b.

- 2.2 Any reference in this Order to any enactment shall be construed as a reference to that enactment as amended, applied, consolidated, re-enacted by or as having effect by virtue of any subsequent enactment.
- 2.3 Unless the context otherwise requires, any expression used in this Order which is also used in the Order of 2016 shall have the same meaning as in that Order.

^a 1984 c.27

^b LBS 2016/005

Designation of loading bay and application of the Order of 2016 thereto

- 3.1 Each area on a highway comprising the length of carriageway of a street specified in column 2 of the Schedule to this Order and bounded on one side of that length by the edge of the carriageway, is designated as a loading bay.
- 3.2 The provisions of the Order of 2016 (other than Articles 3.1 and 12.1) shall apply to each area designated as a loading bay by this Order as if in those provisions any reference to a loading bay shall include a reference to each area designated as a loading bay by this Order and as if any reference to Schedule 1 to the Order of 2016 included a reference to the Schedule to this Order.

Placing of traffic signs etc.

4.1 The council shall:-

- (a) place and maintain traffic signs indicating the limits of each loading bay referred to in the Schedule to this Order;
- (b) place and maintain in or in the vicinity of each loading bay referred to in the Schedule to this Order, traffic signs indicating that such a loading bay may be used during the permitted hours for the leaving only of the vehicles referred to in Article 4.1 of the Order of 2016; and
- (c) carry out such other work as is reasonably required for the purposes of the satisfactory operation of a loading bay.

Dated this xxxxxxxx day of xxxxxxxx 201*

[signature here]

NICKY COSTIN
Parking and Network Management Business Unit Manager
Regulatory Services

SCHEDULE - LOADING BAYS

<i>No. of loading bay (1)</i>	<i>Designated loading bay (2)</i>	<i>Permitted hours (3)</i>	<i>Maximum loading period (4)</i>	<i>Minimum return interval (5)</i>
***.	<p>OCCUPATION ROAD</p> <p>the south-west side of its north-west to south-east arm, from a point 5 metres south-east of the point opposite the south-eastern kerb-line of the north-east to south-west arm of Occupation Road eastward for a distance of 7 metres.</p>	At any time	40 mins	2 hours

EXPLANATORY NOTE

(This note is not part of the Order)

This Order introduces a new loading bay in Occupation Road, in the London Borough of Southwark.



THE COUNCIL OF THE LONDON BOROUGH OF SOUTHWARK

TRAFFIC MANAGEMENT ORDER

201* No. ***

London Borough of Southwark (Waiting and loading restrictions)
(Amendment No. **) Order 201*

Made: xx xxxx 201*

Coming into force: xx xxxx 201*

The council of the London Borough of Southwark, after consulting the Commissioner of Police of the Metropolis, in exercise of the powers conferred by sections 6 and 124 of and Part IV of Schedule 9 to the Road Traffic Regulation Act 1984^a, as amended, and of all other powers thereunto enabling, hereby make the following Order:

Citation and commencement

- 1.1 This Order may be cited as The London Borough of Southwark (Waiting and loading restrictions) (Amendment No. *) Order 201* and shall come into force on xx xxxx 201*.

Interpretation

- 2.1 In this Order:-

"council" means the council of the London Borough of Southwark;

"enactment" means any enactment, whether public general or local, and includes any order, bye-law, rule, regulation, scheme or other instrument having effect by virtue of an enactment; and

"the Order of 2015" means the London Borough of Southwark (Waiting and loading restrictions) Consolidation Order 2015^b, as amended;

- 2.2 Any reference in this Order to any enactment shall be construed as a reference to that enactment as amended, applied, consolidated, re-enacted by or as having effect by virtue of any subsequent enactment.
- 2.3 Unless the context otherwise requires, any expression used in this Order which is also used in the Order of 2015 shall have the same meaning as in that Order.

^a 1984 c.27

^b LBS 2015/082

Amendment of the Order of 2015

- 3.1 Without prejudice to the validity of anything done, or to any liability incurred in respect of any act or omission before the coming into force of this Order, the Order of 2015 shall have effect as though the items numbered 633, 721 and 769 in Schedule 1 to that Order are substituted the items similarly numbered and set out in columns 1, 2 and 3 of the Schedule to this Order.

Dated this xxxxxxxxx day of xxxxxxxx 201*

[signature here]

NICKY COSTIN
Parking and Network Management Business Unit Manager
Regulatory Services

SCHEDULE – WAITING RESTRICTIONS (SUBSTITUTION)

<i>Item No. (1)</i>	<i>Street (2)</i>	<i>Prescribed hours (3)</i>
633.	MANOR PLACE	
	(a) the north-west side	
	(i) between the south-western kerb-line of Walworth Road and a point 25 metres south-west of that kerb-line;	At any time
	(ii) between a point 5.5 metres north-east of the north-eastern kerb-line of Crampton Street and a point 5 metres south-west of the south-western kerb-line of Crampton Street;	At any time
	(iii) between a point 1.5 metres north-east of the common boundary of Nos. 150 and 152 Manor Place and the north-eastern kerb-line of Berryfield Road;	At any time
	(b) the south-east side	
	(i) between the south-western kerb-line of Walworth Road and a point 38.5 metres south-west of that kerb-line;	At any time
	(ii) between a point 5 metres north-east of the north-eastern kerb-line of Occupation Road and a point 37 metres south-west of the south-western kerb-line build-out of Penton Place;	At any time
	(iii) between a point 44 metres south-west of the south-western kerb-line build-out of Penton Place and a point 13 metres north-east of the south-western wall of Nos. 109-127 Manor Place;	At any time
	(iv) between the eastern kerb-line of Chapter Road and the south-western kerb-line of the access road off Manor Place leading to Pasley Park (adjacent to No. 179 Manor Place);	At any time
	(c) the access road off Manor Place leading to Pasley Park (adjacent to No. 179 Manor Place), the south-west side, between the south-eastern kerb-line of Manor Place and a point 11.5 metres south-east of that kerb-line;	At any time
	(d) so much else as does not lie within those lengths of street specified in sub-paragraphs (a), (b) and (c) above.	8.30 am to 6.30 pm Monday to Friday
721.	OCCUPATION ROAD	
	1. north-west to south-east arm	
	(a) the north-east side, so much as is public highway;	At any time
	(b) the south-west side, between the south-eastern kerb-line of Manor Place and a point 5 metres south-east of the point opposite the south-eastern kerb-line of the north-east to south-west arm of Occupation Road;	At any time
	2. north-east to south-west arm, the north-west and south-east sides.	At any time

SCHEDULE – WAITING RESTRICTIONS (SUBSTITUTION)

<i>Item No.</i> (1)	<i>Street</i> (2)	<i>Prescribed hours</i> (3)
769.	PENROSE STREET	
	(a) the north-west, west and south-west side	
	(i) between the south-western kerb-line of Walworth Road and a point 10 metres north-east of the north-eastern wall of No. 36-38 Penrose Street;	At any time
	(ii) between a point 5 metres north-east of the south-western wall of No. 36-38 Penrose Street and a point 1 metre south-west of the common boundary of Nos. 40 and 42 Penrose Street;	At any time
	(iii) between the common boundary of Nos. 62 and 64 Penrose Street and a point 12 metres south-west of the south-western kerb-line of Penton Place;	At any time
	(iv) between a point 10 metres north-east of the north-eastern kerb-line of the vehicular entrance to Borrett Close, Pasley Estate and a point 12.5 metres north-west of a point opposite the north-western kerb-line of Penrose Grove;	At any time
	(v) between a point 6 metres north-west of the north-western kerb-line of Carter Street and a point 8.5 metres south-east of the south-eastern kerb-line of Carter Street;	At any time
	(b) the south-east, east and north-east side	
	(i) between the south-western kerb-line of Walworth Road and a point 13.5 metres south-west of that kerb-line.	At any time
	(ii) between a point 23.5 metres south-west of the south-western kerb-line of Walworth Road and a point 20 metres north-west of the north-western kerb-line of Penrose Grove;	At any time
	(iii) between a point 10 metres north-west of the north-western kerb-line of Penrose Grove and a point 30 metres south-east of the south-eastern kerb-line of Penrose Grove;	At any time
	(c) so much else as does not lie within those lengths of street specified in sub-paragraphs (a) and (b) above.	8.30 am to 6.30 pm Monday to Friday

EXPLANATORY NOTE

(This note is not part of the Order)

This Order amends existing 'at any time' waiting restrictions in Manor Place, Occupation Road and Penrose Street, in the London Borough of Southwark.